



**VIVIANNIA**

*Vidhura* Estates is promoted by young and enthusiastic

entrepreneurs backed with rich experience of over two decades in property development.

Our logo symbolizes the implementation of our way of delivering to our clients; a symbol of immense strength of valuing your dreams and help you in building your vision.

Our mission is not narrowed down by traditional real estate boundaries when it comes to buying, selling or renting, instead we are finding new and innovative ways to our clients.

With positive, enthusiastic and vibrant spirit, we encourage flexibility and innovative approach to our work; strive to exceed the expectation of our clients by understanding and responding appropriately to their needs.





VIVIANA

Entrance

*Viviana*

is beautifully situated at a location that gives it the unique advantage of being closely linked to the excellent connectivity to IT hub, World class Healthcare Centers, Educational Institutions, Star Hotels and major shopping malls among others while being tucked around cosy fresh air, lush greenery, soothing sunlight and a plush, breath-taking view.

When you buy a piece of earth at Viviana, you get awed to the chirping of the birds and fresh air from the green reserve.

Get a chance to enjoy the amenities that a Viviana project comes with and have that ample amount of leisure that you had always looked for.

Nature reveals the key to a happy and prospering neighbourhood.

Choose your piece of earth from a range of 40 x 60, 40 x 50', 30 x 53'.4" and 30 x 50'.

Layout designed for quality personal space, homes that welcome the natural bounties of fresh air and warm sunlight with their thoughtful architecture.

# Project Highlights



Grand entry portal with 24 hour security



Peripheral Compound Wall



Wide asphalted roads



Tiled pathways



Decorative Streetlights



Underground Drainage System



Underground Electrical Power



Gravity Water Supply System



Provision of underground TV and Telephone lines



Kids Play Area



Senior Citizens Park



Rainwater Harvesting System

“Live in the Green Space  
On Every Moment Of Joy  
It's your Journey.  
We're Here to Help.”

# Master Layout

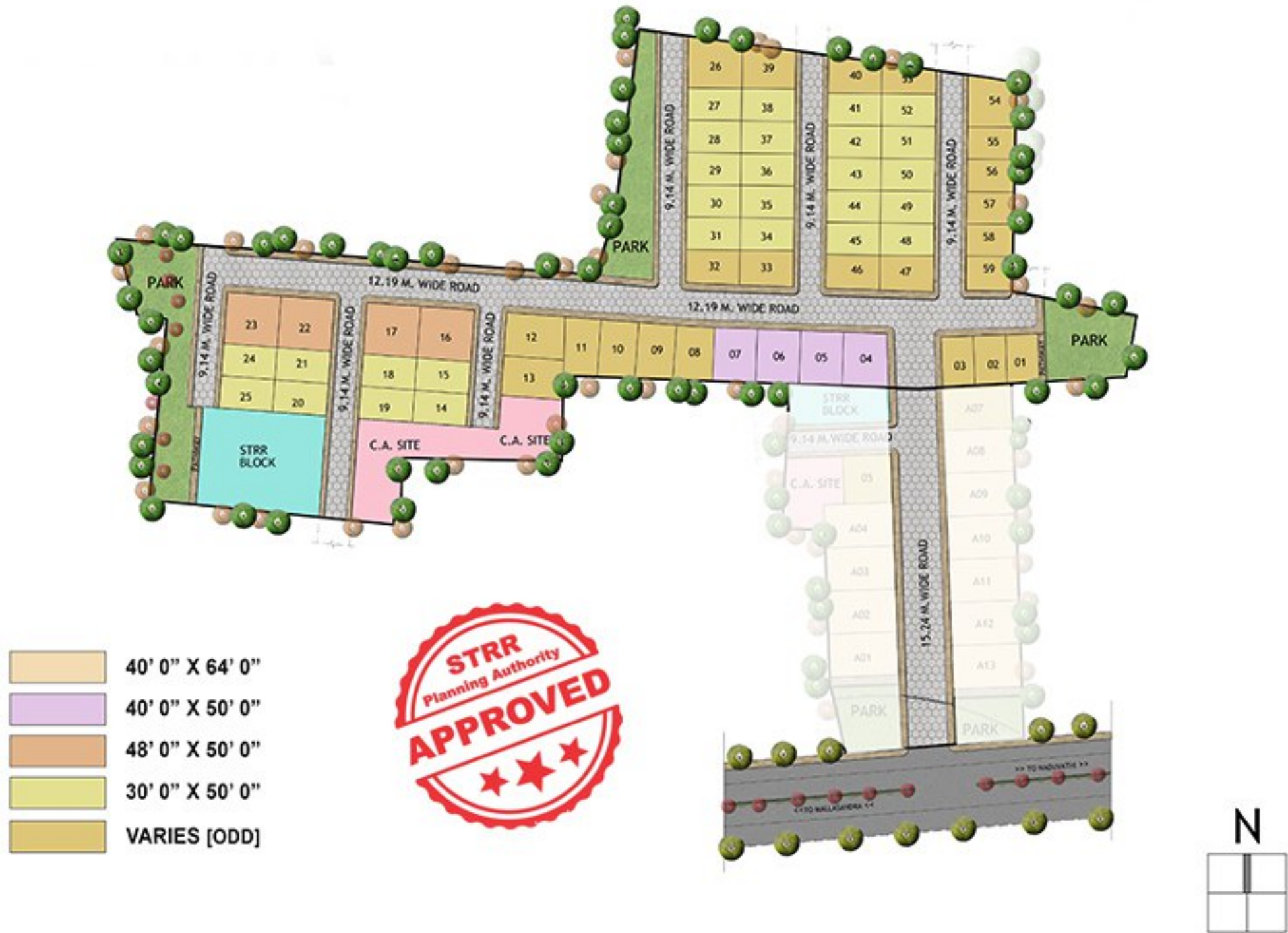

# Location Advantage

- Proximity to Forum Mall, Phoenix Mall, Inorbit and many more
- Proximity to Star Hotels like Marriot, Taj Vivanta, Sheraton, Zuri and many more
- Proximity to world class healthcare centers like Columbia Asia, Vydehi, Sri Sathya Sai Super Speciality, Apollo and many more
- Connectivity to Marathalli, Sarjapur, Hoskote and Old Madras road
- Delhi Public School is less than 1 km from the layout
- Under Construction Namma Metro Line just 15 mins drive
- NH 648 new (old NH 207) is the expressway connecting the important cities which passes close to the layout
- Whitefield is the place for tranquility and the happening place
- Sri Sathya Sai Ashram is about 5 km from the layout
- Just 15 mins drive to ITPL

## Location Map

