



N E S T A I R A

Think Value Think Land

Wake up to bird songs.  
Get your hearts fill of pure oxygen.  
Walk along tree lined boulevards, savor natural aromas of flowers & fruits.  
Let your children run on soft green grass  
Or chase that bright butterfly.  
An oasis in the concrete jungle.

- 9 acres of man-made mini forest offered as plots.
- Located on the high growth Doddaballapur main road.
- High appreciation on land value.



# Layout Map

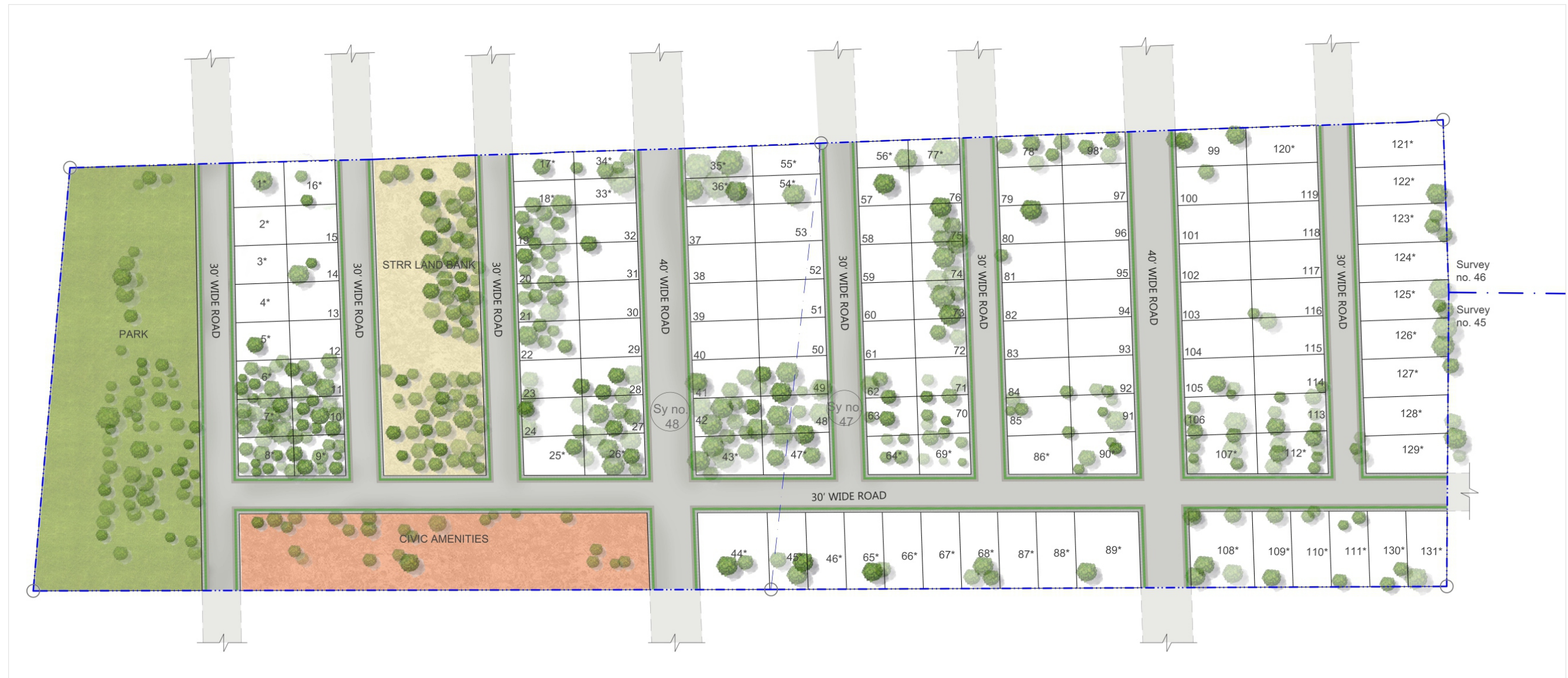

## Project Highlight

1. State of the art infrastructure.
2. Large green open space and parks.
3. Well planned network of drainage, rain water harvesting, sewage treatment.
4. Underground cabling of power and internet.
5. Well Maintained tall trees, flora and fauna.
6. Plots sizes starting from 1200 sft.

# Location Map



NESTA IRA

Think Value Think Land

Contact Us:

- 📍 NESTA IRA REG. OFFICE  
: Nest Ira Estates LLP Ground Floor, NO 42, 2nd CROSS,  
Ex-Servicemen Colony, R T Nagar Bangalore, Urban,  
Karnataka, 560032
- 📍 SITE ADDRESS  
: Doddaballapur Main Road, Lakshmipura village,  
in close vicinity to PC Parklane,  
Century Seasons and Godrej Reserve.
- 🌐 : [www.nestaira.com](http://www.nestaira.com),
- ✉ : [sales@nestaira.com](mailto:sales@nestaira.com), [nestairaestates@gmail.com](mailto:nestairaestates@gmail.com)
- ☎ : +91 9964213612, +91 9916419513