



**BRIGADE**

Building Positive Experiences

Gallium block at Brigade El Dorado RERA Registration No:  
PRM/KA/RERA/1251/472/PR/190427/002540

Available at <https://rera.karnataka.gov.in/>

— **#StrikeGold** —

**BRIGADE**

**EL DORADO**

— AEROSPACE PARK, BANGALORE NORTH —



## INTRODUCING BRIGADE EL DORADO

THE CITY OF GOLD, FOUND!

Since centuries, man's desire for riches has inspired numerous bold expeditions. Chasing legends, explorers undertook perilous missions in search of the mysterious El Dorado - the fabled city of gold.

With **Brigade El Dorado**, it has become easier than ever to #StrikeGold and revel in a life of good taste and comfort. No challenging expeditions, absolutely no risks but a highly rewarding experience of living in one of the finest properties crafted by Brigade.



# GOLDEN LOCATION



A Brigade home is always one of the wisest investments you can make. A home in North Bangalore, just 15 minutes before the International airport, is nothing short of striking gold. Situated within the Aerospace Park, just minutes away from prominent commercial establishments like Shell Technology Centre, proposed Boeing and Rolls Royce offices, IT Parks and many more, the location is known for its clean wide roads, scenic greenery and impeccable infrastructure.

The future is here and you are invited.

# LOCATION ADVANTAGE



Map not to scale



Scan to Strike Gold



# GOLDEN LIFESTYLE



Gold reigns as the supreme symbol of wealth and opulence and opens doors to a luxurious lifestyle that we all aspire for.

With **Brigade El Dorado**, the bar has been further raised, and you are invited to a lifestyle that can well be described as the Gold standard of Community Living!



# PROJECT AMENITIES



10 acre  
Central Park



Swimming  
Pools



Two  
Clubhouses



Kids' Play  
Area

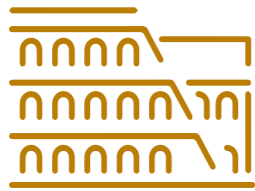

Open-air  
Amphitheatre



Football  
Field



Community  
Gardening

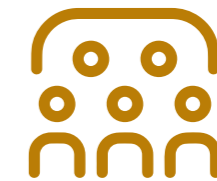

Multipurpose  
Hall



Creche



Cricket  
Ground



Conveninece  
Store



Gym

And many more...



**PROJECT  
VIEWS**





Artist's impression

**PROJECT  
ELEVATION**



**GOLDEN  
LIFESTYLE**



Artist's impression

**RETENTION  
POND**



Artist's impression

# OPEN AIR AMPHITHEATER



**UNIT  
PLANS**

**2 BHK**

---

**799 SFT**

**795 SFT**

**3 BHK**

---

**1068 SFT**

**1043 SFT**

# UNIT DISTRIBUTION PLAN

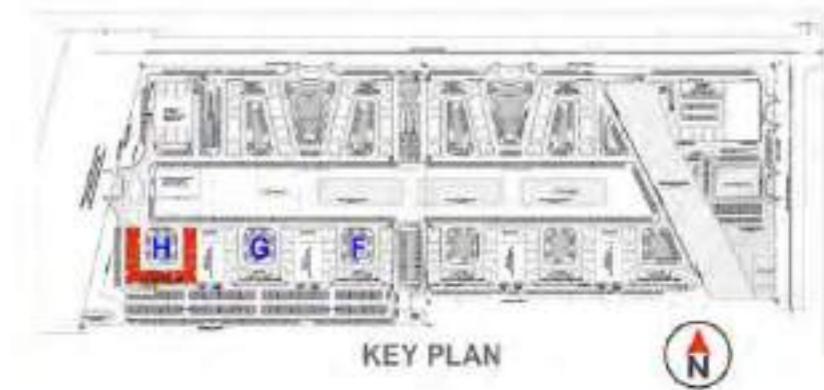
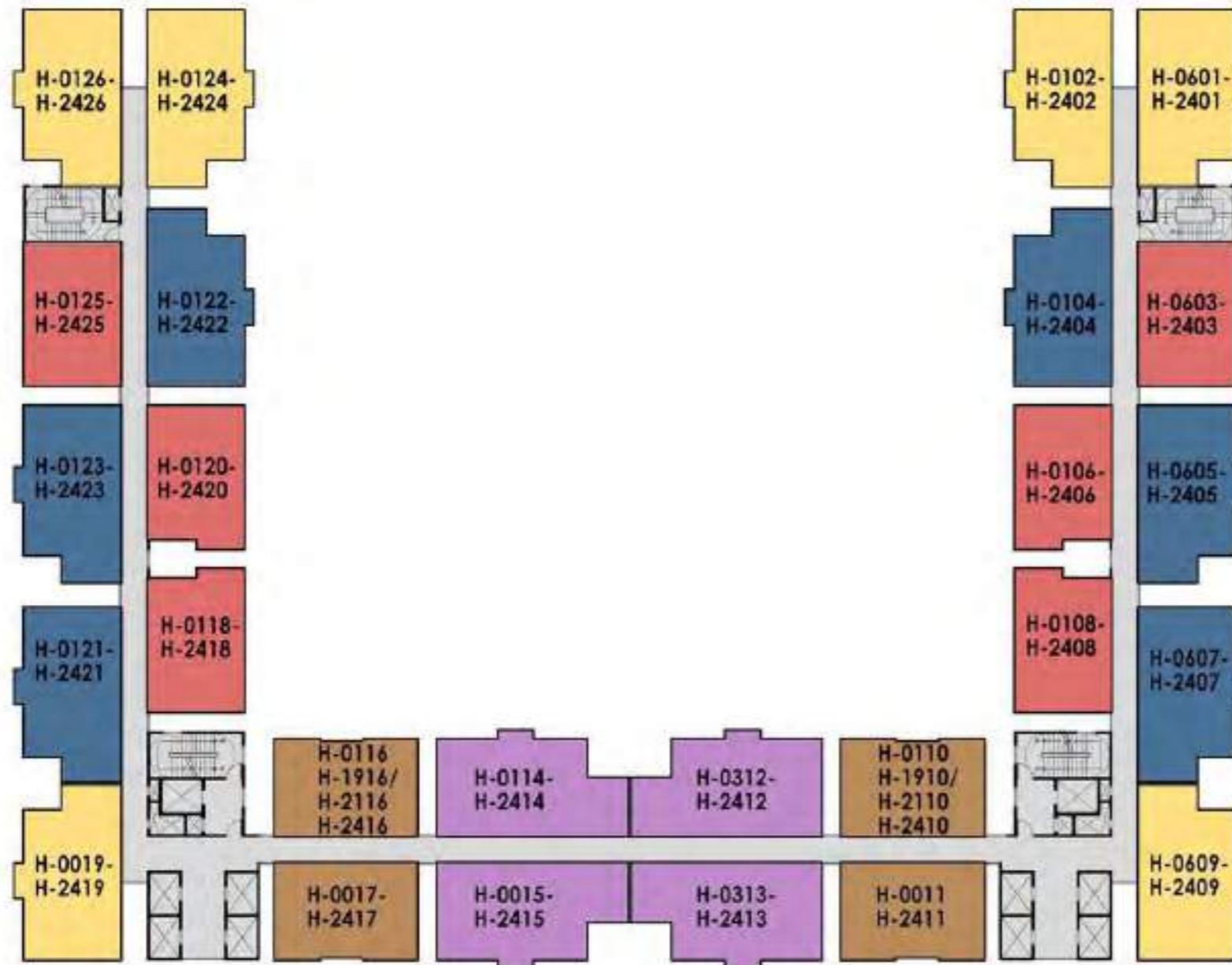

## LEGEND

- TYPE - A 3 BHK UNIT
- TYPE - A1 3 BHK UNIT
- TYPE - A2 3 BHK UNIT
- TYPE - B 2 BHK UNIT
- TYPE - B1 2 BHK UNIT

The information depicted herein viz., master plans, floor plans, furniture layout, fittings, illustrations, specifications, designs, dimensions, rendered views, colours, amenities and facilities etc., are subject to change without notifications as may be required by the relevant authorities or the developer's architect, and cannot form part of an offer or contract. Whilst every care is taken in providing this information, the Developer cannot be held liable for variations. All illustrations and pictures are artist's impression only. The information are subject to variations, additions, deletions, substitutions and modifications as may be recommended by the company's architect and/or the relevant approving authorities. The Developer is wholly exempt from any liability on account of any claim in this regard. (1 square metre = 10.764 square feet). E & OE.

# 2 BEDROOM UNIT - (TYPE - B)

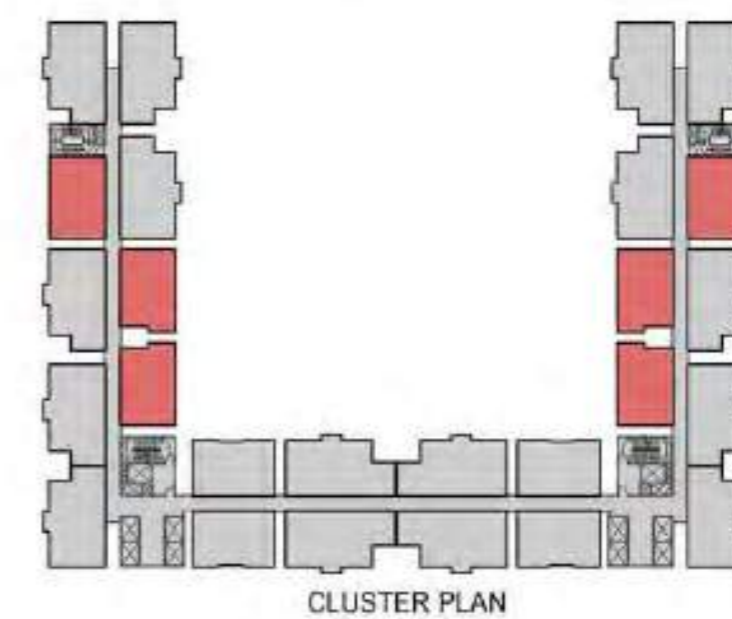
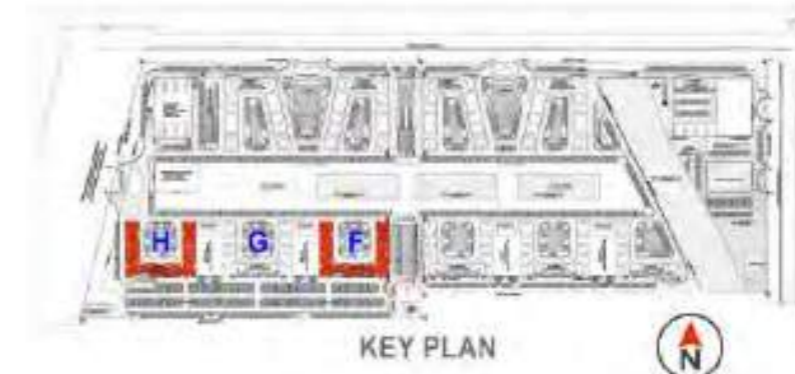

SUPER BUILT-UP AREA	CARPET AREA	BALCONY
795 Sq.ft / 73.86 Sq.m.	466 Sq.ft / 43.32 Sq.m	16 Sq.ft / 1.512 Sqm

TYPE - B	CLUSTER - F	CLUSTER - H
	F0003 - F2403	H0603 - H2403
	F0106 - F2406	H0106 - H2406
	F0108 - F2408	H0108 - H2408
	F0118 - F2418	H0118 - H2418
	F0120 - F2420	H0120 - H2420
F0625 - F2425	H0125 - H2425	

The information depicted herein viz., master plans, floor plans, furniture layout, fittings, illustrations, specifications, designs, dimensions, rendered views, colours, amenities and facilities etc., are subject to change without notifications as may be required by the relevant authorities or the developer's architect, and cannot form part of an offer or contract. Whilst every care is taken in providing this information, the Developer cannot be held liable for variations. All illustrations and pictures are artist's impression only. The information are subject to variations, additions, deletions, substitutions and modifications as may be recommended by the company's architect and/or the relevant approving authorities. The Developer is wholly exempt from any liability on account of any claim in this regard. (1 square metre = 10.764 square feet). E & OE.



# 2 BEDROOM UNIT - (TYPE - B1)



SUPER BUILT-UP AREA	CARPET AREA	BALCONY
799 Sq.ft / 74.23 Sq.m.	471 Sq.ft / 43.72 Sq.m	12 Sq.ft / 1.1 Sqm

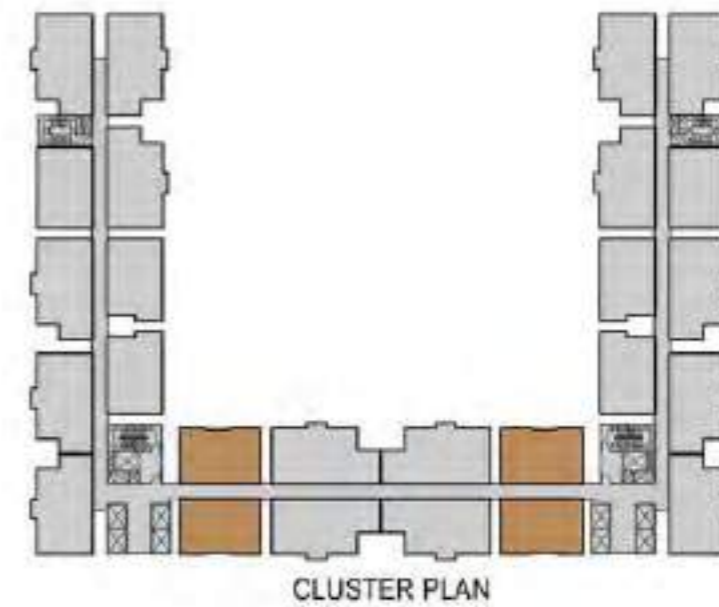

	CLUSTER - F	CLUSTER - H
TYPE - B1	F0110 - 1910/2110-2410	H0110 - 1910/2110-2410
	F0011 - F2411	H0011-2411
	F0116 - 1916 / F2116 - F2416	H0116-1916/2116-2416
	F0017 - F2417	H0017 - 2417

The information depicted herein viz., master plans, floor plans, furniture layout, fittings, illustrations, specifications, designs, dimensions, rendered views, colours, amenities and facilities etc., are subject to change without notifications as may be required by the relevant authorities or the developer's architect, and cannot form part of an offer or contract. Whilst every care is taken in providing this information, the Developer cannot be held liable for variations. All illustrations and pictures are artist's impression only. The information are subject to variations, additions, deletions, substitutions and modifications as may be recommended by the company's architect and/or the relevant approving authorities. The Developer is wholly exempt from any liability on account of any claim in this regard. (1 square metre = 10.764 square feet). E & OE.

# 3 BEDROOM UNIT - (TYPE - A)

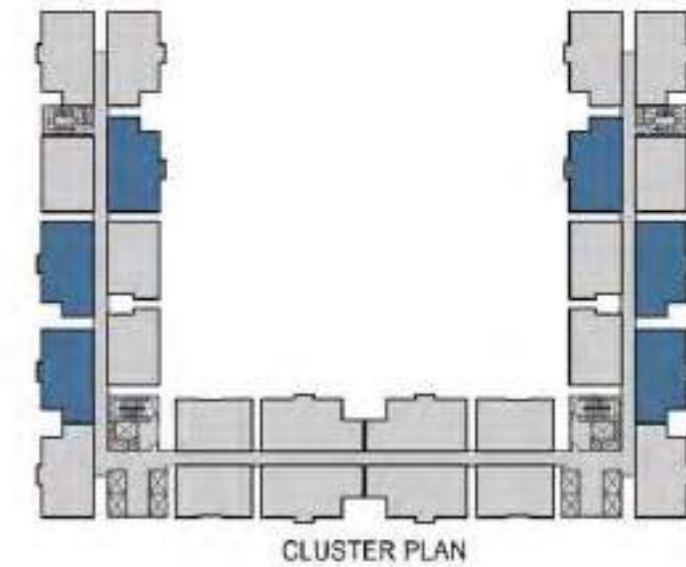

SUPER BUILT-UP AREA	CARPET AREA	BALCONY
1043 Sq.ft / 96.90 Sq.m.	628 Sq.ft / 58.31 Sq.m	11 Sq.ft / 1.05 Sqm

TYPE - A	CLUSTER - F	CLUSTER - H
	F0104 - F2404	H0104 - H2404
	F0005 - F2405	H0605 - H2405
	F0007 - F2407	H0607 - H2407
	F0122 - F2422	H0122 - H2422
	F0623 - F2423	H0123 - H2423
F0621 - F2421	H0121 - H2421	

The information depicted herein viz., master plans, floor plans, furniture layout, fittings, illustrations, specifications, designs, dimensions, rendered views, colours, amenities and facilities etc., are subject to change without notifications as may be required by the relevant authorities or the developer's architect, and cannot form part of an offer or contract. Whilst every care is taken in providing this information, the Developer cannot be held liable for variations. All illustrations and pictures are artist's impression only. The information are subject to variations, additions, deletions, substitutions and modifications as may be recommended by the company's architect and/or the relevant approving authorities. The Developer is wholly exempt from any liability on account of any claim in this regard. (1 square metre = 10.764 square feet). E & OE.

# 3 BEDROOM UNIT - (TYPE - A1)

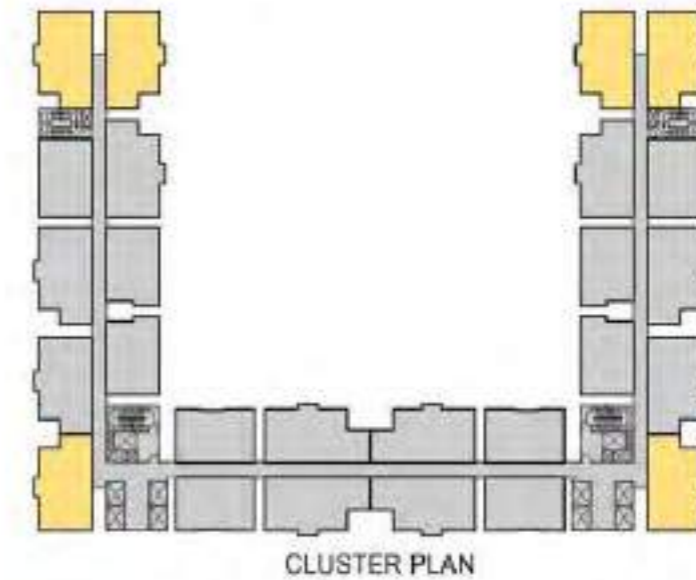

SUPER BUILT-UP AREA	CARPET AREA	BALCONY
1043 Sq.ft / 96.90 Sq.m.	628 Sq.ft / 58.31 Sq.m	11 Sq.ft / 1.05 Sqm

TYPE - A1	CLUSTER - F	CLUSTER - H
	F0001 - F2401	H0601 - H2401
	F0102 - F2402	H0102 - H2402
	F0009 - F2409	H0609 - H2409
	F0124 - F2424	H0124 - H2424
	F0626 - F2426	H0126 - H2426
F0619 - F2419	H0019 - H2419	

The information depicted herein viz., master plans, floor plans, furniture layout, fittings, illustrations, specifications, designs, dimensions, rendered views, colours, amenities and facilities etc., are subject to change without notifications as may be required by the relevant authorities or the developer's architect, and cannot form part of an offer or contract. Whilst every care is taken in providing this information, the Developer cannot be held liable for variations. All illustrations and pictures are artist's impression only. The information are subject to variations, additions, deletions, substitutions and modifications as may be recommended by the company's architect and/or the relevant approving authorities. The Developer is wholly exempt from any liability on account of any claim in this regard. (1 square metre = 10.764 square feet). E & OE.

# 3 BEDROOM UNIT - (TYPE - A2)

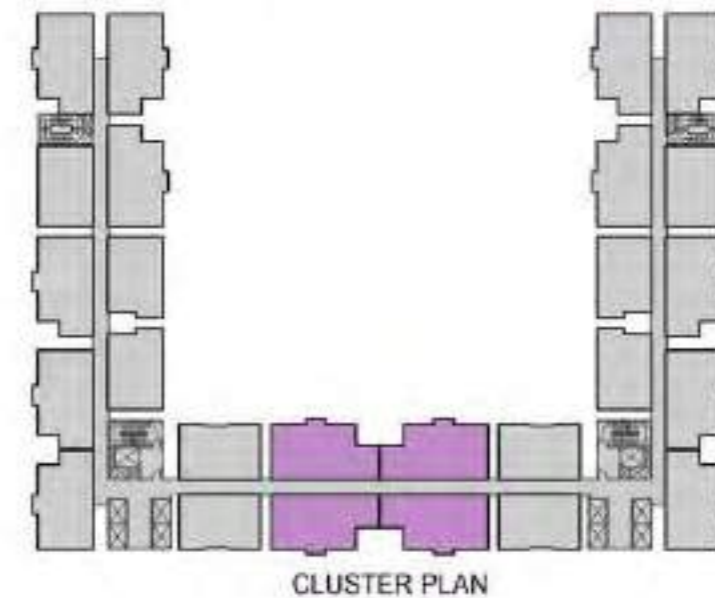
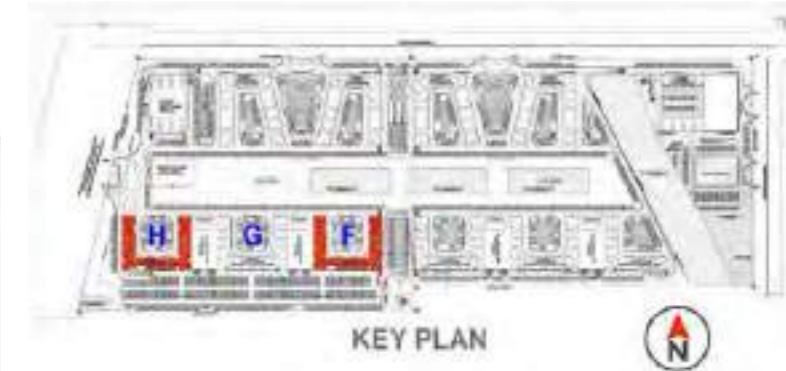

SUPER BUILT-UP AREA	CARPET AREA	BALCONY
1068 Sq.ft / 99.22 Sq.m.	643 Sq.ft / 59.69 Sq.m	11 Sq.ft / 1.05 Sqm

TYPE - A2	CLUSTER - F	CLUSTER - H
	F0312 - F2412	H0312 - H2412
	F0313 - F2413	H0313 - H2413
	F0114 - F2414	H0114 - H2414
	F0015 - F2415	H0015 - H2415

The information depicted herein viz., master plans, floor plans, furniture layout, fittings, illustrations, specifications, designs, dimensions, rendered views, colours, amenities and facilities etc., are subject to change without notifications as may be required by the relevant authorities or the developer's architect, and cannot form part of an offer or contract. Whilst every care is taken in providing this information, the Developer cannot be held liable for variations. All illustrations and pictures are artist's impression only. The information are subject to variations, additions, deletions, substitutions and modifications as may be recommended by the company's architect and/or the relevant approving authorities. The Developer is wholly exempt from any liability on account of any claim in this regard. (1 square metre = 10.764 square feet). E & OE.



# SPECIFICATIONS

## STRUCTURE

RCC Framed structure using Aluminium Form Work

## COMMON AREA - FLOORING

**Waiting lounge, reception, GF lobby & lift lobby:** Marble, Granite & Vitrified Tiles

**Staircases:** Concrete step tiles, Vitrified tiles & Epoxy coating for stairs (from 1st floor)

**Other lift lobby and corridors (upper):** Vitrified tiles (Matt Finish)

## APARTMENT UNITS - FLOORING

**Living, Dining, Family & Foyer:** Vitrified tiles

**Master Bedroom, Other Bedrooms & Kitchenette:** Vitrified tiles

**Balcony / deck:** Matt finish tiles

**Master Bedroom Toilet & Common Toilet:** Anti-skid ceramic tiles

## WALL DADO

**Master Bedroom Toilet & Common Toilet:** Ceramic tile cladding up to false ceiling height

## KITCHEN

**Counter:** Provision for modular kitchen

**Plumbing & Electrical:** Plumbing point provision for water purifier, washing machine. Electrical points provision for water purifier, refrigerator, hob, chimney, mixer/grinder, Microwave Oven & Washing Machine

## WINDOWS

UPVC / Anodised Aluminium with mosquito mesh provision

## DOORS

**Main entry door - to unit:** Flush shutter with both side Laminate and architrave

**Bedroom doors:** Engineered & Treated Hard wood frame & particle board with hdf skin and architrave

**Toilet door:** Engineered & Treated Hard wood frame, Shutter laminated both sides and architrave

**Balcony door:** UPVC / Aluminium with bug screen 2 track with one side fixed panel

**Shaft door:** MS door frame with mild sheet shutter

## TOILETS

**CP Fittings:** Jaquar / Ess Ess / Essco or equivalent

**Sanitary fixtures:** Floor mounted white EWC (Hindware/Parryware/ Cera or equivalent) with exposed flush tank of standard make including health faucet

**Accessories:** Towel rod

**False Ceiling:** Grid ceiling Calcium silicate or equivalent

## PAINTING & FINISHES

**Accessories:** Combination of External texture paint with external grade emulsion

**Internal ceilings & common area:** Oil Bound Distemper or Emulsion

**Unit ceiling:** Acrylic emulsion paint

**Internal walls, common area & lift Lobby:** Emulsion paint

**Staircase, utility area and service area:** Oil bound distemper

**Basement:** Cement paint

**Unit walls:** Acrylic emulsion paint

**Steel works:** Synthetic enamel paint

**Woodwork:** Enamel paint

## ELECTRICAL

**3 Bedroom Apartment:** 5 KW

**2 Bedroom Apartment:** 4 KW

**Modular switches:** Anchor or equivalent make

## DG BACKUP

**3 Bedroom Apartment:** 2 KW

**2 Bedroom Apartment:** 1.5 KW

## VERTICAL TRANSPORTATION

Lifts: OTIS / Kone or Equivalent

## SECURITY SYSTEM & AUTOMATIONS

Provision for Intercom Facility & CCTV as per design

## SUSTAINABILITY

Organic waste converter, Ground water recharging Rain water storage, Street light, STP & Solar water heater (provided only for top 2 floors)



**Great Place To Work 2018**

Brigade has been recognised for being amongst India's Best Workplaces in Real Estate, at the 'Great Place To Work For 2018 Awards'

**Brigade Group**

Won the 'Real Estate Luminary Award' for Exemplary contribution to Real Estate at the Times Business Awards 2018

Brigade was recognised as one of India's Top Builders at the Construction World Architects & Builders Award 2018

Brigade was recognised as one of Bengaluru's Hot 50 Brands at the Brand Summit & Hot Brands 2018 by Paul Writer

**Brigade Orchards**

Won the 'Smart Township Project of the Year' Award at the 6<sup>th</sup> Annual Siliconindia Bengaluru Real Estate Awards 2018

Won the 'Integrated Township of the Year' award at the Realty Plus Excellence Awards South 2018

**Brigade Exotica**

Won the Best Residential Project at the CIA World Construction & Infra Awards 2018

**Brigade Palmgrove, Mysuru**

Won the Premium Villa Project of the Year at the NDTV Property Awards 2018

Won in the 'Villas & Row Houses' category at the CREDAI Karnataka's CARE Awards 2017

MULTIPLE DOMAINS.  
SINGLE-MINDED COMMITMENT.

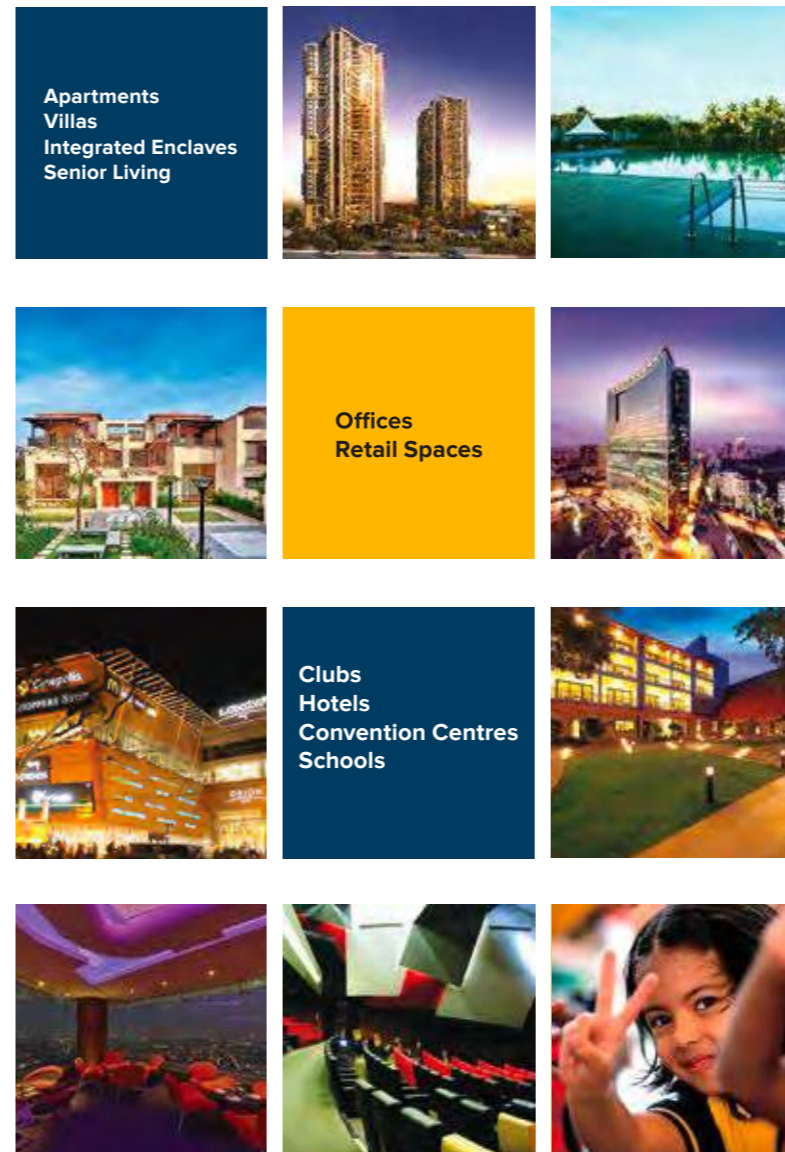

Brigade is one of India's leading developers with over three decades of experience in building positive experiences and also transforming the skyline of cities in South India namely Bangalore, Mysore, Mangalore, Hyderabad, Chennai and Kochi with its developments across Residential, Office, Retail, Hospitality and Education sectors.

Brigade's residential portfolio includes penthouses, villas, premium residences, luxury apartments, value homes, independent living for seniors and award winning fully integrated lifestyle enclaves & townships. Brigade is among the few developers who also enjoy a reputation of developing Grade A commercial properties. The World Trade Center Bangalore and Kochi, Software and IT parks, SEZs and stand-alone offices have top international clients operating from them. Brigade's retail projects include Orion Mall at Brigade Gateway, Orion East Mall at Banaswadi and the upcoming Orion Mall at OMR. Brigade's hospitality offerings include star hotels across South India, recreational clubs and convention centres, Celebrations Catering and Events and The Baking Company, a unique patisserie focusing on freshly baked healthy products in Bangalore. Brigade has completed over 250 buildings amounting to 40 million Sq.ft. in residential, office, retail and hospitality sectors across 7 cities.

The Group has been socially responsible and has vastly contributed to society by redeveloping the Sangolli Rayanna Park and the Shri Nadaprabhu Kempegowda Playground in Malleswaram, Bangalore, constructing a Skywalk across Dr. Rajkumar Road, rejuvenation of Sitharampalya Lake in Whitefield etc. This responsible attitude and innovative mindset combined with uncompromising quality of the projects over the years has made us a reputed brand.

The Group has also been consistently ranked among the 100 Best Places to Work in India for 8 years in a row. The awards and recognition received by the Group across various categories serve as a testimony to Brigade as a proven brand, well established and trustworthy coupled with excellent customer service and impeccable build quality.



**BRIGADE**

Building Positive Experiences

---

**UPGRADE TO BRIGADE, reach us on 1800 102 9977 • email: [salesenquiry@brigadegroup.com](mailto:salesenquiry@brigadegroup.com)**

---

**Marketing Office:**

Experience Centre,  
WTC Bangalore @ Brigade Gateway Campus,  
Dr. Rajkumar Road, Malleswaram-Rajajinagar,  
Bengaluru 560 055

**Registered & Corporate Office:**

29th & 30th Floor,  
WTC Bangalore@Brigade Gateway Campus,  
Dr. Rajkumar Road, Malleswaram-Rajajinagar,  
Bengaluru 560 055  
**Ph: +91-80-41379200 • Fax: +91-80-22210784**

**Dubai:**

Brigade Enterprises Ltd.,  
708, Atrium Centre, Bank Street, Bur Dubai  
Ph: +971 4 355 5504 | Fax: +971 4 355 5541  
[dubaisales@brigadegroup.com](mailto:dubaisales@brigadegroup.com)

**Offices also at: CHENNAI • CHIKMAGALURU • HYDERABAD • MANGALURU • MYSURU**