

CIVITECH SANTONI

GREATER NOIDA WEST



ARCHITECT
HAFEEZ
CONTRACTOR

Site Location



Perspective View 1 (from 130 M. Wide Road)



Perspective View 2 (from 130 M. Wide Road)



Perspective View 3 (from 24 M. Wide Road)



Lower Ground Floor Plan



Note : All designs & layouts are only indicative and some of these can be changed at the discretion of the builder/architect/authority.

PROJECT : **CIVITECH SANTONI**
GREATER NOIDA WEST

FLOOR PLATE : **LOWER GROUND FLOOR PLAN**

DATE : **04.11.2023**



ARCHITECTS :

SHOP - DRY

SHOP - PROVISION OF WET POINT ONLY

SHOP - PROVISION OF WET POINT & EXHAUST

Architect
Hafeez
Contractor

Ground Floor Plan



Note : All designs & layouts are only indicative and some of these can be changed at the discretion of the builder/architect/authority.

PROJECT :

CIVITECH SANTONI
GREATER NOIDA WEST

FLOOR PLATE :

GROUND FLOOR PLAN

DATE :

04.11.2023



ARCHITECTS :

↑ ↓
WET OUT PROVISION OF WET POINT & EXHAUST

SHOP - DRY

Architect
Hafeez
Contractor

First Floor Plan

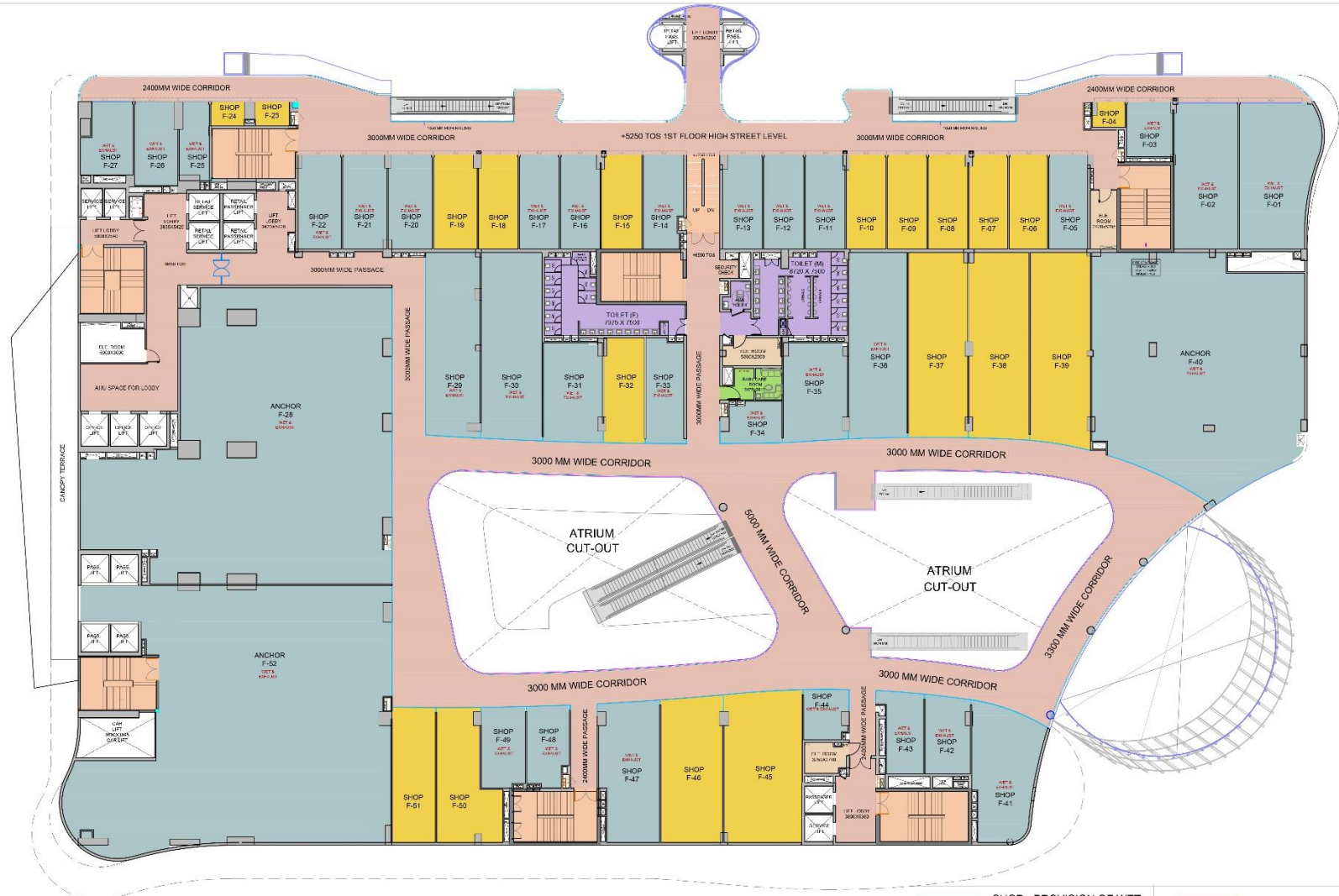

Note : All designs & layouts are only indicative and some of these can be changed at the discretion of the builder/architect/authority.

SHOP - PROVISION OF WET POINT & EXHAUST
 SHOP - DRY

Second Floor Plan

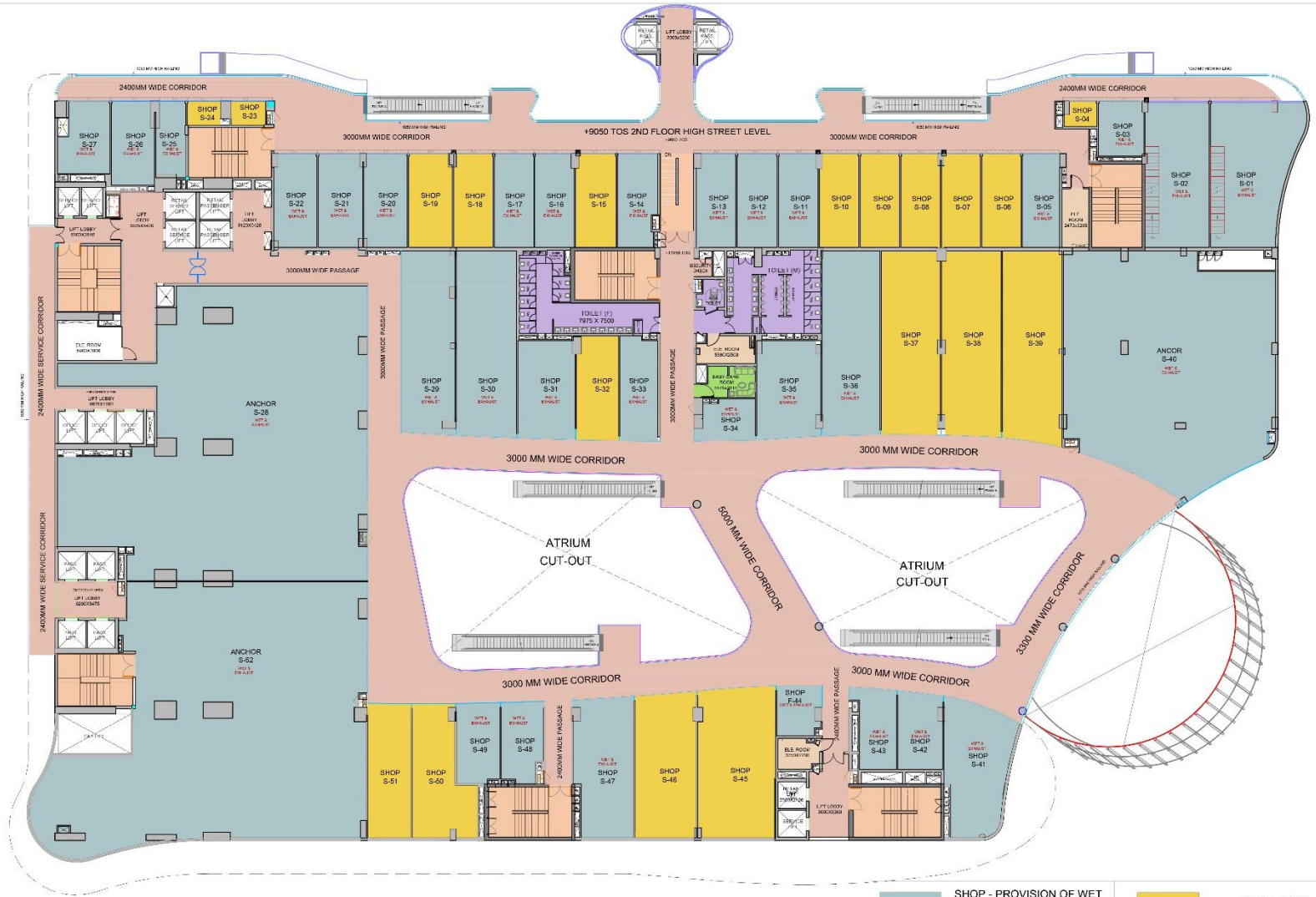

Note : All designs & layouts are only indicative and some of these can be changed at the discretion of the builder/architect/authority.

PROJECT : CIVITECH SANTONI
 GREATER NOIDA WEST

FLOOR PLATE : SECOND FLOOR PLAN

DATE : 04.11.2023



SHOP - PROVISION OF WET POINT & EXHAUST (light blue)

SHOP - DRY (yellow)

ARCHITECTS : Architect Hafeez Contractor

Third Floor Plan

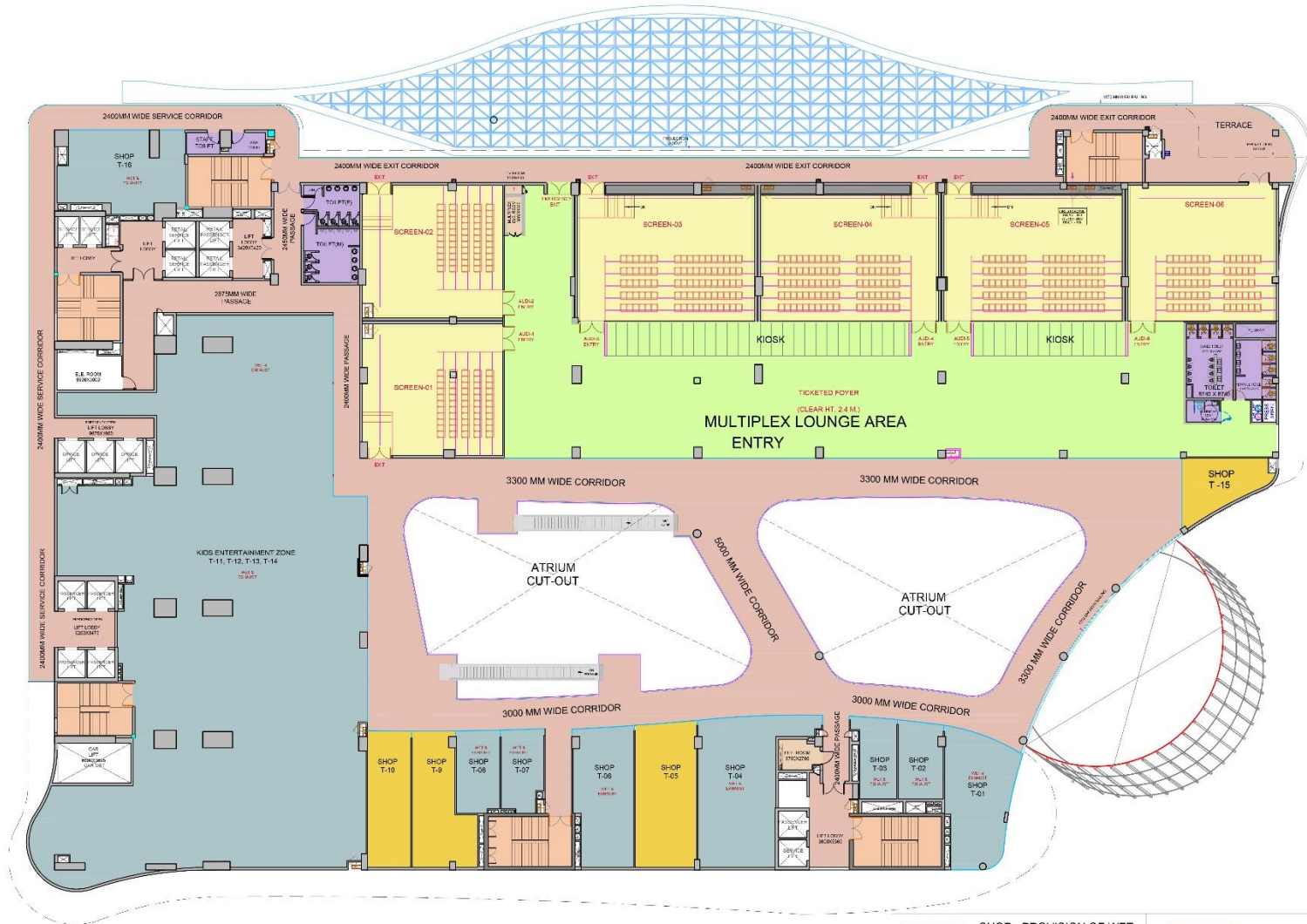

Note : All designs & layouts are only indicative and some of these can be changed at the discretion of the builder/architect/authority.

SHOP - PROVISION OF WET POINT & EXHAUST (Blue color)
 SHOP - DRY (Yellow color)

PROJECT :	FLOOR PLATE :	DATE :	ARCHITECTS :
CIVITECH SANTONI GREATER NOIDA WEST	THIRD FLOOR PLAN	04.11.2023	Architect Hafeez Contractor

Fourth Floor Plan

Food Court
 Counters = 22 Nos.
 Kiosks = 13 Nos.
 Sitting = 294 P. (Approx.)

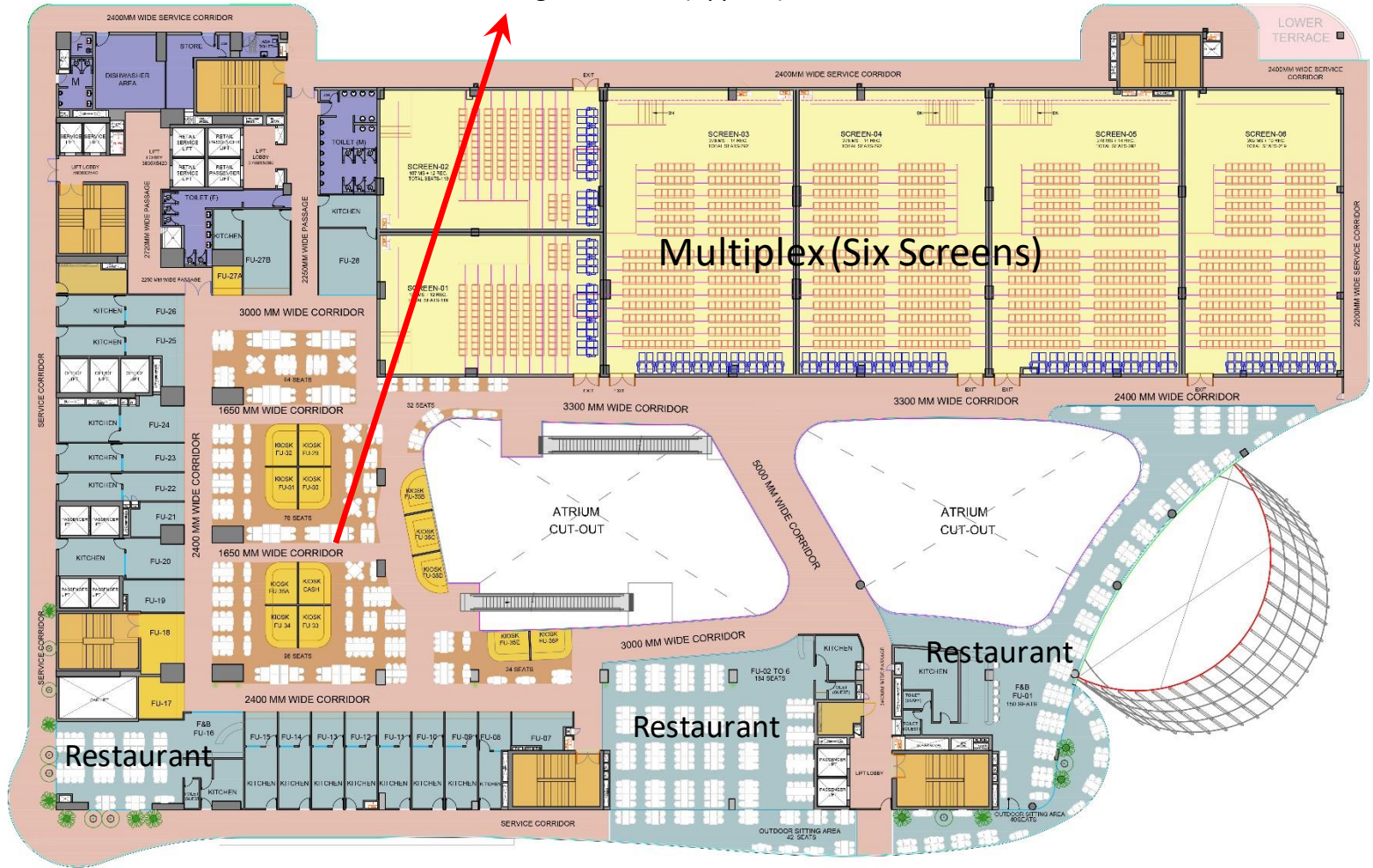

Note : All designs & layouts are only indicative and some of these can be changed at the discretion of the builder/architect/authority.

SHOP - PROVISION OF WET POINT & EXHAUST (Blue shaded area)
 SHOP - DRY (Yellow shaded area)

THE END