



*For a better quality of life,
upgrade to Brigade*

Bangalore:

Brigade Enterprises Limited, Experience Centre, Ground Level,
World Trade Center, Brigade Gateway Campus,
26/1, Dr Rajkumar Road, Malleswaram-Rajajinagar, Bangalore 560 055.

Dubai:

Brigade Enterprises Limited, P.O. Box No. 49191,
708, Atrium Center, Bank Street, Bur Dubai, Dubai.
Tel: +971-04-3555504. Mobile +971-50-1888604.

U.S.A.:

Legion Real Estate - Accredited Agent of Brigade Group,
883 Santa Cruz Avenue, Suite 200, Menlo Park, CA 94025.
Tel: + 1(650) 494 4975

Toll Free Number (India): 1800 102 9977
E-Mail: salesenquiry@brigadegroup.com | BrigadeAltamont.com

BRIGADE
ALTAMONT
OFF HENNUR ROAD

*smart***itecture**

smart + architecture = *smart*itecture

We believe there is more to architecture than buildings. It is thoughtful design of spaces.

Everywhere around us, we see structures embodying thought. Some thoughts stand tall and take our breath away, some cradle us in a familiar air of comfort, while others simply make life more convenient.

At **Brigade Altamont**, thought is the soul of design, ushering you into a new realm of architecture.

Or as we call it, *smart*itecture.

BRIGADE
ALTAMONT
OFF HENNUR ROAD



The unique structure of **Brigade Altamont** is the perfect example of how form and function complement each other to accommodate all the necessities of modern living, while ensuring the efficient use of space.

design + efficiency =
*smart***itecture**

BRIGADE ALTAMONT

AN OVER 3-ACRE DEVELOPMENT

189 SMARTLY DESIGNED
2 & 3-BEDROOM APARTMENTS

1260 - 1830 SQ.FT.

'If it doesn't enhance human life in some way,
then it may as well not exist'.

Every living space at **Brigade Altamont** has been
thoughtfully planned to make you instantly fall in love
with the space and elevate the quality of your life.

These smartly laid out homes, together with
the unique structure of the building, ensure an
abundance of natural light and ventilation.

light + air =
*smart*itecture



Different people have different tastes, but one thing is certain.
At **Brigade Altamont**, you will have room for a healthy lifestyle.
Equipped with a modern kitchen and ample storage spaces, it has
all the ingredients to enable a wholesome and happy lifestyle.

modern + spacious =
*smart*itecture





There is no greater joy in life than relaxing in the most comforting space of your home. The master bedroom has been designed to bring about an atmosphere of ease and relaxation.

The ample light and the soothing colour tones add up to create a personal space that strikes the perfect balance between warmth and privacy.

warmth + privacy =
*smart*itecture

Growing up has to be the best years of a child's life.

The cheerful and friendly spaces at **Brigade Altamont** provide a colourful and vibrant environment, that encourage children to discover, learn and enjoy the joys of childhood.

fun + learning =
*smart*itecture





Clubhouse with
Gymnasium



Swimming Pool



Indoor Games
Zone



Basketball &
Badminton Courts



Children's
Play Area



Amphitheatre

Relaxation and recreation are luxuries available to everyone at **Brigade Altamont**.

With a range of lifestyle amenities, everyone in the family has options to unwind and rejuvenate.

relaxation + recreation =
*smart***itecture**

location map

Located off Hennur Road, **Brigade Altamont** is conveniently connected to all the key landmarks in one of Bangalore's fastest growing corridors.



master plan

- LEGEND
- 1. ENTRANCE GATEWAY
 - 2. ENTRANCE PLAZA
 - 3. SECURITY KIOSK
 - 4. CAR PARKING
 - 5. SWIMMING POOL
 - 6. KIDS' POOL
 - 7. CHILDREN'S PLAY AREA
 - 8. BADMINTON COURT
 - 9. PAVILION
 - 10. BASKETBALL COURT
 - 11. AMPHITHEATRE



key plan

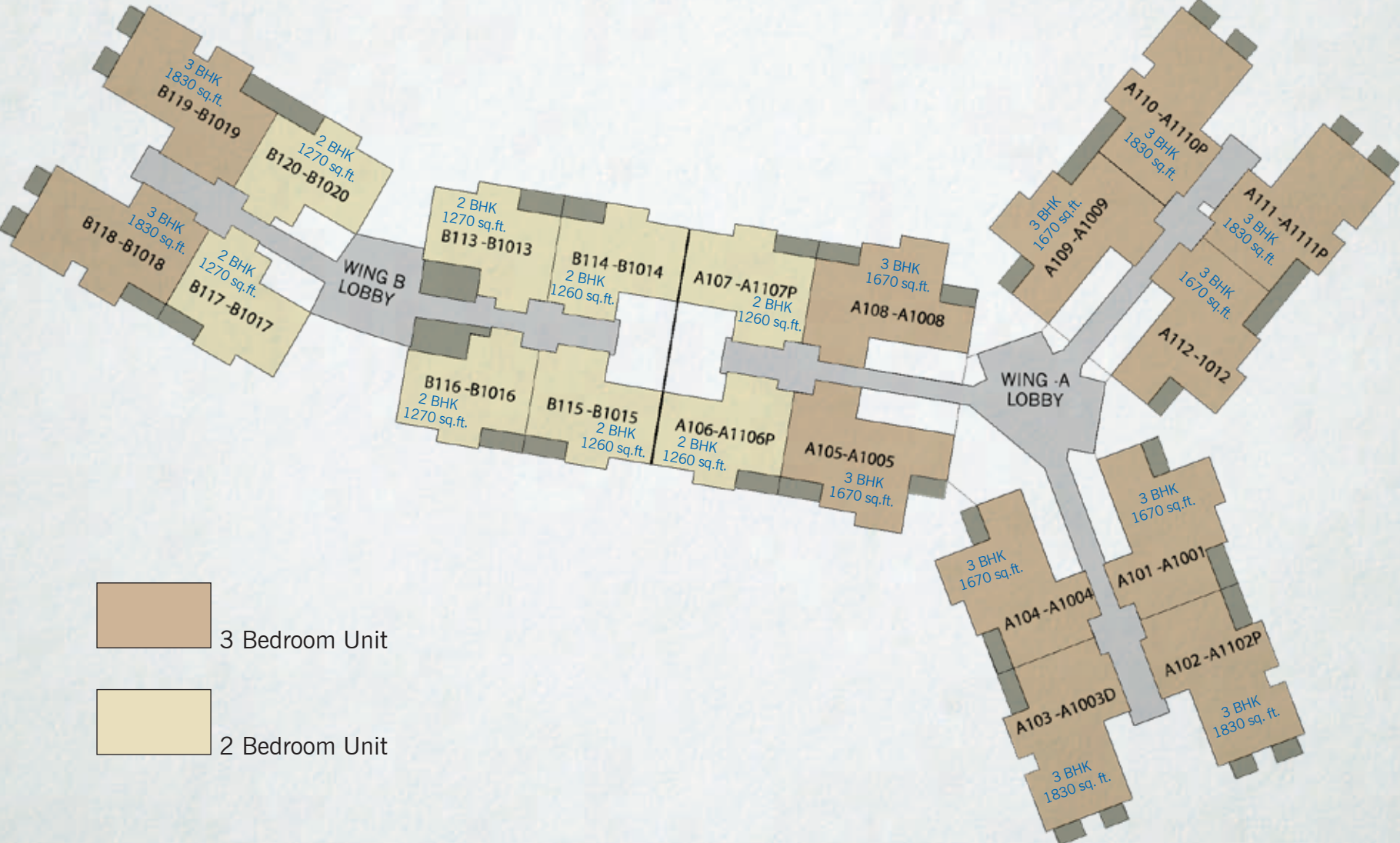

- 3 Bedroom Unit
- 2 Bedroom Unit

typical unit plans

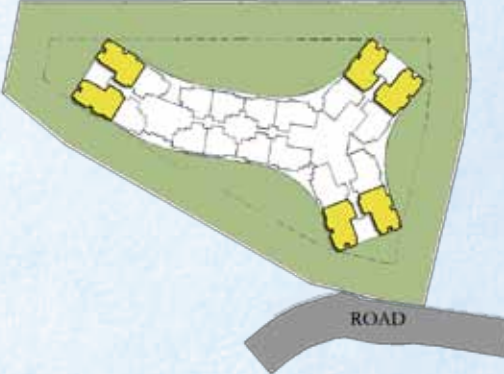

3 Bedroom | 1830 sq.ft.



3 Bedroom | 1670 sq.ft.



2 Bedroom | 1260 sq.ft.



2 Bedroom | 1270 sq.ft.

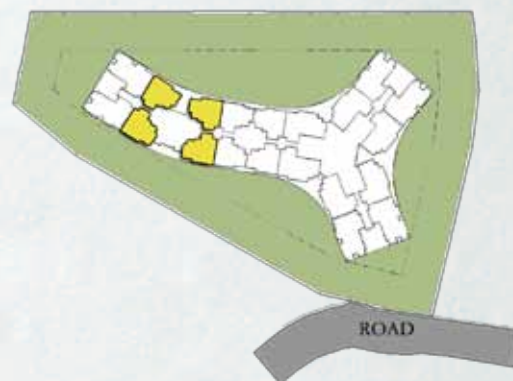

specifications

FLOORING

COMMON AREA:

- Lifts / Lobbies & Corridors : Marble / granite flooring in ground floor
Vitrified tile flooring in upper floors
- Staircases: Vitrified tile flooring

APARTMENTS:

- Living / Dining / Foyer: Vitrified tile flooring
- Master Bedroom: Laminated wooden flooring
- Other Bedrooms: Vitrified tile flooring
- Balcony / Utility: Ceramic tile flooring

KITCHEN:

- Vitrified tile flooring
- Provision for modular kitchen

BATHROOMS:

- Anti-skid ceramic tile flooring
- CP Fittings: Jaquar / equivalent
- Sanitary Ware: Hindustan / Parryware or equivalent

DOORS & WINDOWS

- Apartment Main Door: Solid wood frame with BSTV (Both Side Teak Veneer) / Masonite skin shutter with melamine polishing on both sides
- Bedroom Doors : Solid core flush door & Masonite skin with hardwood frame
- Windows & Ventilators : UPVC / Anodised aluminum windows with sliding shutters and safety grill with provision for bug screen

ELECTRICAL

- Concealed PVC conduit with copper wiring
- Modular switches of Anchor Roma or equivalent

PAINT

- Exterior finish of long lasting texture paint
- Internal walls in plastic emulsion & ceiling with oil bound distemper
- Steel & wood works in synthetic enamel paint
- Common areas in acrylic emulsion paint / oil bound distemper

POWER SUPPLY

- 4 kW for a 2-bedroom apartment
- 6 kW for a 3-bedroom apartment

STANDBY POWER

- 100 % DG back up for emergency power for lifts, pumps & common lighting
- Apartments - DG back up:
 - 2 kW for a 2-bedroom apartment
 - 3 kW for a 3-bedroom apartment

LIFTS

- Wing A: 3 passenger lifts and 1 service lift
- Wing B: 2 passenger lifts and 1 service lift

Fire protection system as per Karnataka Fire Force requirement.

Car parking at basement level and stilt level on ownership basis only.

Sewage Treatment Plant designed as per load.

Borewell with sump and pump.

Cable TV connection, internet & intercom facility.

Clubhouse with gymnasium, indoor games room, party area.

Swimming pool, badminton court, basketball court, amphitheatre, children's play area.

Well designed landscaped areas for recreation and children's play.

Brigade Group

Brigade Group commenced operations in 1986, and over the last 26 years has evolved into a brand that is synonymous with Innovation, Quality, Trust and Customer Satisfaction.

Headquartered in Bangalore, Brigade Group has a network of offices across South India, an office in Dubai, and is represented in the USA by an accredited agent, Legion Real Estate. Brigade Group's portfolio includes residential, offices, retail, hospitality and education.

With over 20 million square feet of developed real estate, across 100 projects, Brigade Group has emerged as one of India's leading property developers, and is constantly setting new benchmarks in the real estate industry.

BrigadeGroup.com

Multiple Domains. Single-minded Commitment.





awards & accolades

An award-winning brand, **Brigade Group** has developed premium residences, luxury apartments, office buildings, software parks, malls, clubs, spas, hotels. serviced residences and SEZs.

Brigade Gateway

Winner of 4 awards at the CNBC AWAAZ Real Estate Awards 2012.

Brigade Group was conferred the
‘Platinum Award of Excellence’

by Construction World in 2012, for being recognized
as India’s Top Ten Builders for 5 consecutive years (2007 - 2011).

World Trade Center Bangalore

“The Best Commercial Space of the Year”

- CREDAI Real Estate Awards 2012

Brigade Gateway

“The Best Theme Based Township of the Year”

- CREDAI Real Estate Awards 2012

“Developer of the Year - Commercial in South India” - 2012

- Realty Plus

Brigade Gateway

“Integrated Township of the Year in South India” - 2012

- Realty Plus

Commendation Certificate for Business Excellence

- The Indian Merchants’ Chamber

Ramakrishna Bajaj National Quality Award Trust (RBNQA)

Forbes **“200 Best Under a Billion Dollar”**

list of 2008 for Asia Pacific

BrigadeAltamont.com

The information herein, i.e. design specifications, illustrations etc. are subject to change without notification, as may be required by the relevant authorities or the Developer's Architect and cannot form part of an offer or contract. Whilst every care is being taken in providing this information, the developers and managers cannot be held liable for variations. All illustrations are artist's impressions only, and do not form part of the standard offering. The plans & specifications are subject to variations, modifications and substitutions by the company's Architect and/ or relevant approving authorities. E&OE.