



PANCHSHEEL
PREMIUM
24
Where Luxury Meets Bliss

Brace yourself for a premium living
at the most premium destination.
Presenting Panchsheel Premium 24,
near 23rd Milestone on Main NH 24, Ghaziabad.

Welcome to Panchsheel Premium 24, a supreme residential complex encompassing sophisticated lifestyle amenities within a cocoon of natural greenery. It's like a breath of fresh air where every corner has been aesthetically designed to enhance every aspect of your life.

Located strategically on Main NH 24, Ghaziabad. Panchsheel Premium 24, comprising 2/3 BHK apartments enjoys great proximity to Noida, Greater Noida, New Delhi and other government offices and commercial complexes. What's more, there's a proposed 6-lane highway and new metro station in the pipeline too. Moreover, the area also brims with lush green surroundings and pollution-free environment, thus offering you a peaceful lifestyle.



Spread across 20 acres • Escalation free prices • Guaranteed timely possession with penalty clause • Freehold property • Vaastu & Eco friendly design of the project • Earthquake resistant RCC structure • 100% power back-up facility for lifts and common areas • Water softening plant installed • Party hall • Clubhouse with gymnasium and swimming pool • Fire fighting system installed on all floors • Round the clock security system • 3 high speed elevators in each block • Jogging track with children's play area

Features

Site Plan

LEGENDS

- MIG I (2 BHK + 2 Toilets) - 1037 sq. ft.
- MIG-II (2 BHK + 2 Toilets) - 1077 sq. ft.
- Mini HIG (2 BHK + Study + 2 Toilets)- 1347 sq. ft.
- HIG (3 BHK + 3 Toilets) - 1697 sq. ft.



Cluster Plan

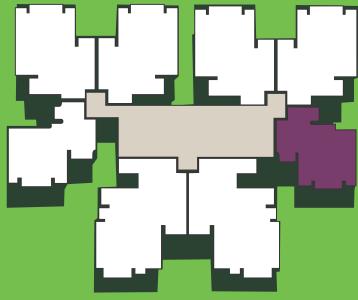

MIG-I

Super Area: 1037 sq.ft.

- 2 Bedrooms
- Living Area
- Dining Area
- Kitchen
- 2 Toilets
- 3 Balconies

Cluster Plan

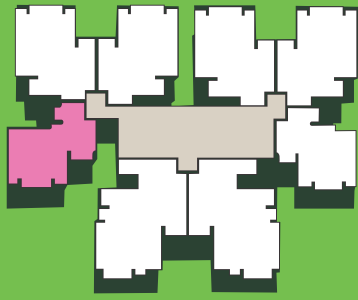

MIG-II

Super Area: 1077 sq.ft.

- 2 Bedrooms
- Living Area
- Dining Area
- Kitchen
- 2 Toilets
- 3 Balconies

Floor Plan

Cluster Plan

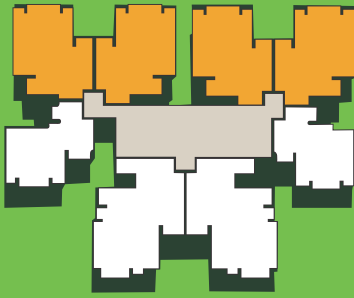

Mini HIG

Super Area: 1347 sq.ft.

- 2 Bedrooms
- Living Area
- Dining Area
- Study
- Kitchen
- 2 Toilets
- 3 Balconies

Cluster Plan

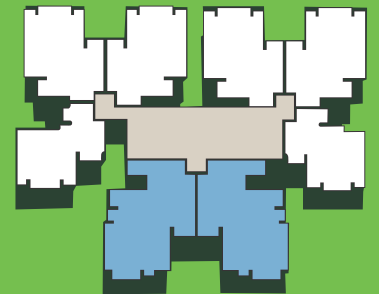

HIG

Super Area: 1697 sq.ft.

- 3 Bedrooms
- Living Area
- Dining Area
- Kitchen
- 3 Toilets
- 4 Balconies

Specifications



STRUCTURE: Earthquake resistant R.C.C. framed structure certified by IIT/Jamia Millia Islamia



FLOORING: Vitrified tiles flooring



DOORS/WINDOWS: All external doors and windows frames in aluminium • Decorative doors with hard wood at main entrance and rest decorative flush doors duly polished



KITCHEN: Granite working platform with 2 ft. high glazed ceramic tiles above it with stainless steel sink



WATER SUPPLY: Underground and overhead water tanks with pumps for 24 hours uninterrupted water supply



TOILETS: Provision for Hot & Cold water system. Glazed tiles in pleasing colours on walls up to door level. European W.C.s • Washbasins & cisterns in white shade • Chrome plated fittings



INTERNAL FINISH: All internal walls plastered & painted in off white shade of oil bound distemper • Plaster of Paris cornices in drawing/dining room and bedrooms



EXTERNAL FINISH: Most Modern & Elegant permanent outer finish with high quality texture paint



ELECTRICAL: ISI copper wiring in P.V.C. concealed conduit • Provision for adequate light and power points as well as telephone & TV outlets with protective M.C.B.s



HARDWARE: All fittings with aluminum powder coated materials

Location map



Location Benefits:

- 1 km from Lal Kuan, Ghaziabad • 10 kms from Noida & Indirapuram • 5 kms from Ghaziabad Railway Station • 2 kms from Reputed Educational Centres • Walking distance from Multispeciality Hospital
- Proposed Metro Station in close proximity