

OM
Residency

3 BHK Residential Apartments

E-175, Ramesh Marg, C-Scheme, Jaipur



Projects by

PARANI
BUILD CON

Own your dream home in a Dream location

The thoughtful selection of three major areas in the heart of Jaipur, i.e., **Vaishali Nagar, C-scheme and Bapu Nagar**.

Parwani Buildcon offers you a great opportunity to own a premium residential apartment. Flourished with lavish amenities, abundant space, perfect connectivity to all parts of the city and a lot of charm, making our apartments an ideal place to start weaving sweet memories.

Our intelligently designed apartments exudes a feeling of grandeur and excess, unparalleled comfort and ensures sufficient sunlight and ventilation. All the three projects enjoy an exceptional location making your commute an easy task and provides you all the necessities within your reach. Experience good living in three luxurious apartments, i.e., **Mohan Heights, Om Residency & Radhey Nivas** and enjoy the world around.



Experience the classic living

RERA No. : RAJ/P/2021/1524
www.rera.rajasthan.gov.in

Residency
3 BHK Residential Apartments

E-175, Ramesh Marg,
C-Scheme, Jaipur



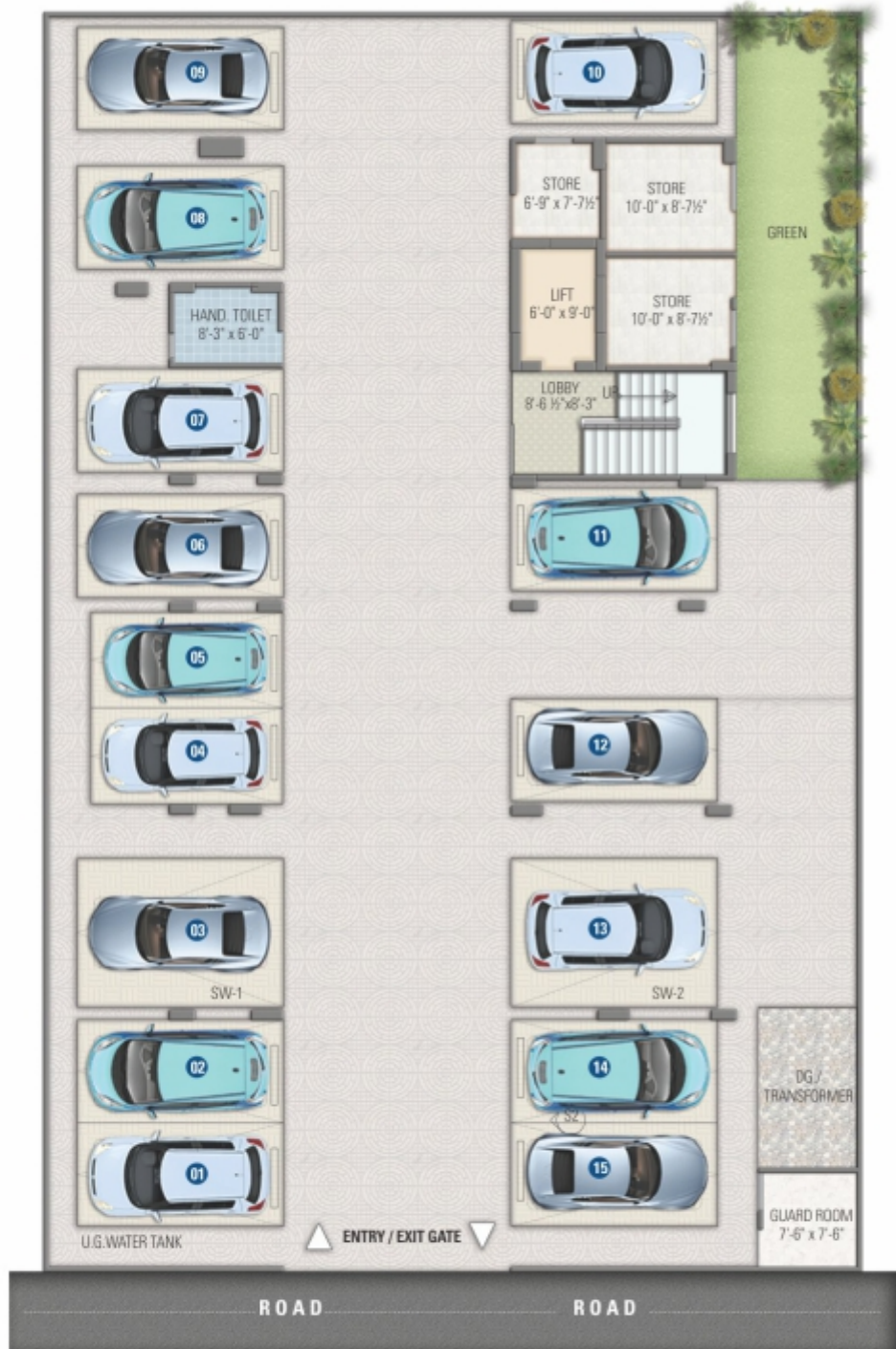

STILT FLOOR PLAN



TYPICAL FLOOR PLAN

| Flat No. | Built-up Area | Super Built-up Area |
|----------|---------------|---------------------|
| 01 | 1234 Sq.ft. | 1645 Sq.ft. |
| 02 | 1234 Sq.ft. | 1645 Sq.ft. |
| 03 | 1252 Sq.ft. | 1669 Sq.ft. |

Flat No.
01, 02
 1645
 Sq.ft.



Flat No.
03
1669
 Sq.ft.



M
 Residency
 3 BHK Residential Apartments

Structure

- Earthquake resistant framed structure design as per Seismic Zone II.

Apartment Features:

- Premium Class flooring of Vitrified Tiles.
- POP finish on wall & ceiling.
- Plastic paint on wall & ceiling.
- Doors & windows.

• Wood Work:

- Windows having Glass panels/wire mesh panels
- Tough ISI mark flush doors.
- Well designed main door.
- Fitting of good quality on doors & windows.

Kitchen:

- Granite working counters, SS sink.
- 2' tiles above the counter.
- Modular Kitchen.
- Concealed tubing for Gas line to nearest balcony.

Toilet:

- Designer tile in toilet.
- Premium C.P. Fitting of Jaquar, Marc, Equivalent Continental Range.

- Ceramic tiles in toilet
- Anti-skid ceramic tiles on flooring.
- Jet in all Toilets.

Security System

- EPBX system.
- Well managed Security Service.

Electrical:

- Modern electrical system with concealed Copper Wiring.
- Premium quality Switches & Accessories.
- TV/Telephone/A.C./Cooler point in all the rooms at appropriate places.
- Power backup (Silent D.G. Set) for common service.
- Fan, Exhaust & Tubelite provided.
- Decorative light in Drawing & Dining.

General Features:

- Well designed Entrance foyer & Lobby area.
- 1 Lifts for fast & easy commuting.
- 24 hour security system
- Rain water harvesting system.

and much more...



Specifications...



Manoj Parwani
Director

PARWANI
BUILDCON

The Group

Parwani Buildcon is one of the emerging developer of Real Estate in Rajasthan with more than 10yrs of dynamic presence in residential growth. Their mission is to provide luxurious and comfortable homes at prestigious locations. Currently they are developing more than 2 lakh sq ft of residential and commercial space with more projects on their way. The aesthetic design & unparalleled comfort of the residential apartments in the heart of Jaipur - Vaishali Nagar, C Scheme and Bapu Nagar makes u feel right at home.

Few of our previous projects



Kripa Residency, Adharsh Nagar, Jaipur



Vasundhara, Civil lines, Jaipur



Chandraprabha, C-scheme, Jaipur



Om Enclave, Janta Colony, Jaipur



**Mohan
HEIGHTS**
2 / 3 BHK Residential Apartments
Plot No. 141, Scheme
Nemi Nagar, Near Vaishali
Nagar Jaipur.

**M
Residency**
3 BHK Residential Apartments
E-175, C-Scheme, Jaipur

**Radhey
Niwas**
3 BHK Residential Apartments
C-27, Piyush Path,
Bapu Nagar, Jaipur

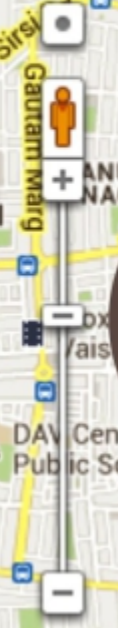



Parwani Buildcon Pvt. Ltd.

S-9 Mohan Nagar Gopalpura Jaipur-302018 Mobile : +91 9982994111
Email : parwanibuildcon@gmail.com | Web : www.Parwanibuildcon.com

Architect **SPACE GRID** Ph: 93149-18766, 93145-10603

Disclaimer: This Brochure is purely conceptual and not a legal offering. Further the Promoters/Architect reserve the right to add/delete/ modify any details/specifications/elevation mentioned here in.