

## Joint Venture



## Design & Development Satyadeep Infrastructure LLP

### Site

Satyadeep Heights, B/s. Palm Greens, Nr. Prahladnagar-Makarba Crossing,  
Opp. Torrent Power Station, Prahladnagar Ext., Ahmedabad - 380051

Contact No.: **079 65252590**

### Corporate Office

Deep Group of Companies  
10th, floor, "President House", Opp. C.N. Vidyalaya,  
Ambawadi, Ahmedabad-380 006. Gujarat  
Contact No.: 079 26446232/33

[www.deepgroup1980.com](http://www.deepgroup1980.com)



**SATYADEEP**  
HEIGHTS





Go Ahead, Live Your Dreams

Welcome to the abodes of **2 & 3 BHK Lifestyle Apartments**  
provided with abundant and comfortable amenities in its premises.





Go ahead  
with an origination of  
positive vibes in life

The Glorifying Gateway  of Satyadeep Heights  
avails you with a delightful welcome to your own  
exclusively spacious facility oriented community. Features of  
Security Cabin  and School Drop-Off Zone   
will assure yours and your dear ones safety. Your guests will be  
charmed with the convenience of Visitors Parking   
and an eye-pleasing Water Body. 



Enjoyable Club House

## Go ahead with a commencing of precise curriculum in life

In the personalized zone of yours, you can relax and freshen up with the excitements of the fun filled **Indoor Games**, stretch up in fully equipped **Gymnasium**, enjoy family moments at the **Home Theatre**, rejuvenate in the serene environment and lighten up with some yoga exercises on the **Yoga Deck**. Satyadeep Heights is not just your home, but a complete package to rejoice and flourish with your family.



SATYADEEP  
HEIGHTS



Exciting Games & Sports

Go ahead  
with a beginning of  
sparkling carnivals in life

Your love for sports & partying with family and friends will be taken care off at Satyadeep Heights for an everyday best experience. Tighten up your body to avail fitness sports like **Tennis**  and the newly added **Basket Ball**,  all this with the extra fun of separate **Children's Play Area**  for kids and extra leisure of **Seating Area**, 



Entertainment Arrangements







Compelling Features



**SATYADEEP**  
HEIGHTS

Go ahead with an initiation  
of mesmeric sights in life

Moments of celebration can be rejoiced with the capacious Party Lawn  provided with Gazebos  and seating at Satyadeep Heights.

The ambience of festivals can be made eternal with cheerfulness and happiness; celebrated with great enthusiasm in the Amphitheatre  and commodious Landscaped Garden. 

# Site Plan



## Legends

- 01) Entrance Gate
- 02) Security Cabin
- 03) Drop Off Zone
- 04) Water Body
- 05) Landscaped Island
- 06) Amphitheater
- 07) Party Lawn
- 08) Ramp
- 09) Children Play Area
- 10) Club House
- 11) Basket Ball
- 12) Jogging Track
- 13) Multipurpose Court
- 14) Sit-out
- 15) Pergola Seating
- 16) Reserved Parking
- 17) Visitor Parking
- 18) Electric S.S



18.00 MTS WIDE T.P.S. ROAD

12.00 MTS WIDE T.P.S. ROAD

ENTRY



# 2BHK

Unit Floor Plan

Block - A, B, C

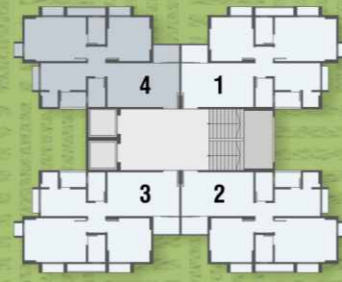

# 3BHK

Unit Floor Plan

Block - D, E, F

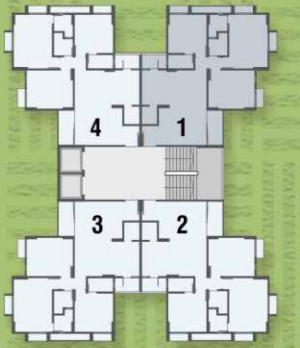

## Specification

### WALL FINISH

External double coated sand faced plaster with tex / acrylic paint.  
Internal single coat finished plaster with cement based lapi finish.

### FLOORING

Vitrified tiles flooring. Wooden flooring in master bedroom.

### ELECTRIFICATION

Concealed three phase electrification with adequate points. Smart home with Video door phone. A. C. points in all bedrooms. MCB board. T. V. and Telephone points in drawing and master bedroom.

### DOORS

Masonite skin polished panel doors with frame and stone jambs.

### WINDOWS

Anodized Aluminum windows with MS child safety grill and stone jambs.

### BATHROOMS

Glazed tiles flooring and dado up to 6'6" level. Standard quality C. P. fitting and sanitary ware. Shower panel in the Master Bedroom.

### KITCHEN

Granite platform with 4" glazed tiles dado. Glazed tiles under platform D. P. Polish Kota stone shelves and glazed tiles dado in store room and in wash area.

### WATER SUPPLY

Common tube well with underground water tank and overhead water tank for 24 X 7 water supply.

### ROADS

Internal roads with interlock blocks or concrete road and street lights.

### COMMON PLOT

Well developed common plot, club house, children play area, parking, landscaping, water bodies and fountains.

### TREATMENTS

Anti-termite treatment at parking level and water proofing treatment at terrace level.

### ELEVATORS

Each block is provided with 2 Automatic Elevators.

### PARKING

One car parking space per apartment on ground level or basement.

## Rules and Regulations

- Right of any changes in dimension design & specification reserved with the project consultant, which shall be binding to all members.
- All applicable Govt. taxes as stamp duty, Registration fees, Service tax, VAT, any additional liabilities due to changes in Govt. local authorities by laws prior, during or after the completion of the scheme will be also borne by the members as per prevailing law.
- External changes shall not be allowed any time.
- Only fixed internal changes shall be allowed with prior permission and shall be charged extra.
- Dimensions are unfinished wall to wall and approximation of 3 inches.
- Torrent power charges, Legal charges, AMC charges deposits and other Govt. charges shall be paid separately.
- Maintenance advance and initial period maintenance expense should be paid separately

### Notes

- Every care has been taken in preparation of particulars in this brochure. Agreement for allotment shall be final and binding to purchaser. • Plans, Elevations, 3D Pictures, Layout, and Specifications shown in the brochure are indicatives only. The real development may differ due to local regulations other policy of constant improvement, and/or other circumstances.

## LOCATION PLAN

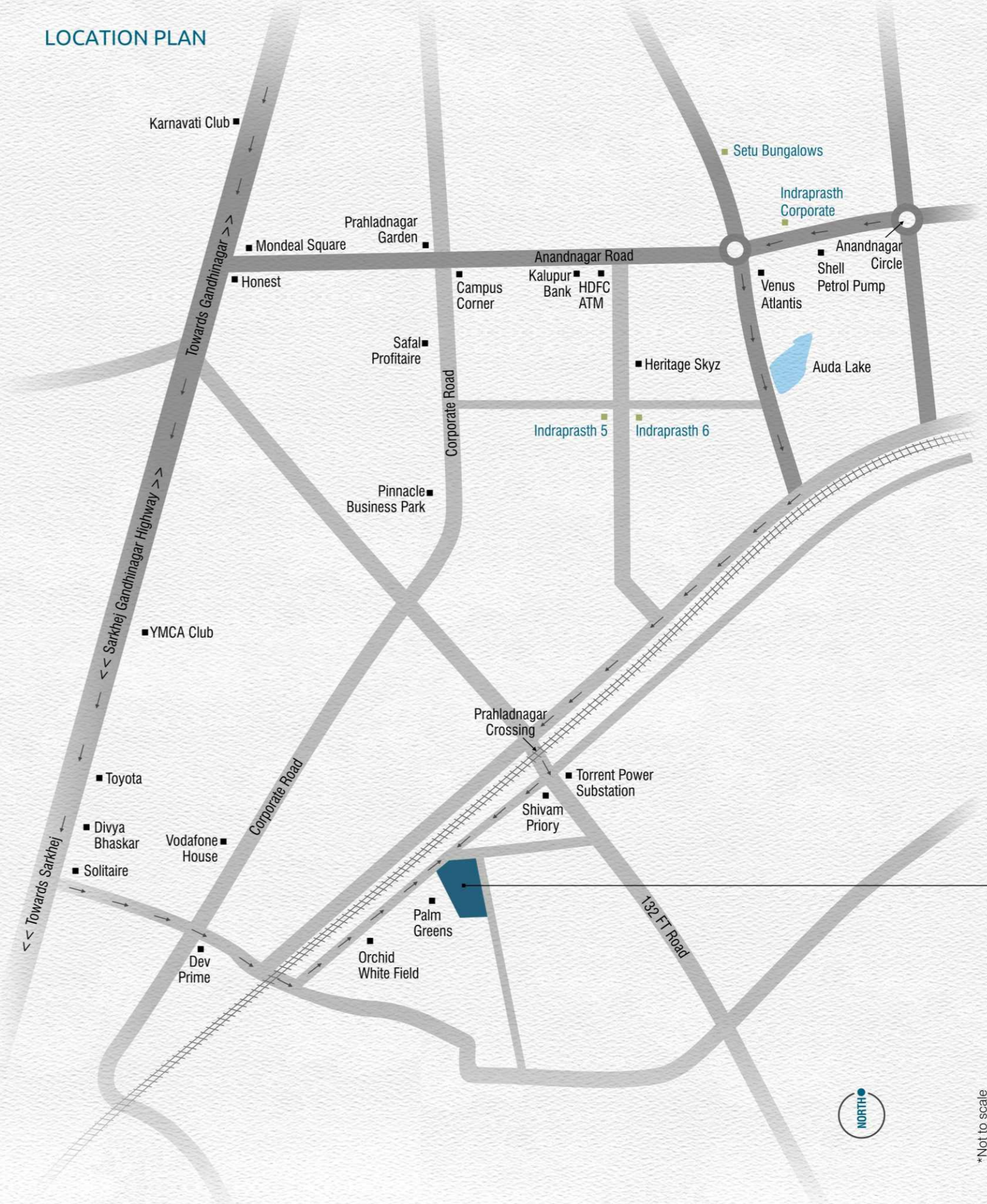

\*Not to scale

Proud  
Association



CREDAI  
GUJARAT



SATYADEEP  
HEIGHTS