



Site address : Madhusudan Retreat, Village Patgaon, Karjat
Murbad Highway, Taluka Murbad, District Thane

Corporate Office: 2nd Floor, Lake City Centre, Kapurbawdi
Circle, Thane (W) - 400 607.

www.madhusudan.com

Contact : 7695 992 992 / 9702782222





Rejuvenate

Any nature home - modest or luxurious, means good ambience: fresh air, sprawling greens, scenic landscapes, serene climate or abundant flora and fauna. All these add to the overall quality of life. The mere thought of such an environment is rejuvenating enough. At Retreat Terraces, you'll experience such harmonious blend of modernity and nature.



Recreate

It's a prerequisite to building bonds. Many hopes and expectations - especially those of your family - rest on the choice of a Nature homes. Today, there's hardly any room for children to explore or enjoy the outdoors - least of all a dedicated area for the families to sit together and reminisce "the good old times".



Reconnect

One of the components of urban chaos is commuting time between home and places. This kills quality time which could well have been utilised by spending it with loved ones. Retreat Terraces has considerably reduced this 'negative' space created by sheer distances with it's superb connectivity.



Rejoice

In the pursuit of the materialistic, today's hectic and stressful existence has taken away the joy of living a healthy life. A healthy body helps overcome the daily stress we subject ourselves to, thereby improving the quality of life. Retreat Terraces has created such zones that brings back the positive energy in you, After all health is wealth.



Retreat yourself

We have thoughtfully created homes keeping the specific needs of a family in mind. With the best utilisation of space for everyone. Each space is personal and cultivates a sense of belonging. And says something about yourself.



Presenting



RETREAT
TERRACES
BY MADHUSUDAN GROUP

Retreat Terraces by Madhusudan group, a collection of 2 and 3 bhk row houses @ karjat murbad highway your next weekend home destination situated conveniently for easy commuting, these luxury Row Houses are for those who seek solace from the rush of the city. With private gardens, lavish terrace, and much more to offer. A unique project of row House, Reterat Terrace is set amidst the tranquillity of nature.





Conveniences all around

A home is incomplete without a community to belong to man being a social animal, yearns to be a part of a neighbourhood and interact with other co-habitants. There must be 'common' spaces where such networking can take place. Retreat Terraces ensures there's plentiful opportunity to make your life more convenient and easy.





Relive

When we planned Retreat Terraces, we incorporated human use of space and its effect on behaviour, communication and social interaction. We were convinced that directly or indirectly, space is the most important aspect that determines quality of life.

In view of the above we, at Retreat Terraces, were determined to fill the missing positive spaces in peoples' lives. Our team then identified such spaces and meticulously set out to make sure we provided them to our prospective buyers.



life zones

LIVING ZONE

ROW HOUSES
COMMERCIAL SHOPS
RESTAURANT

RECREATIONAL ZONE

10000 SQ.FT. CLUB HOUSE
INDOOR SWIMMING POOL
GYMNASIUM
YOGA & MEDITATION ZONE
MULTIPURPOSE AREA
RESTAURANT

NATURE ZONE

MOUNTAINS
LAKES
WATERFALL

A summary of happy lifestyle

Of all the amenities that constitute in a real estate project, the most important one is obviously clubhouse. As the title points to, the clubhouse is not a luxury, but it summarizes how a happy and healthy lifestyle should be. But, in most of the luxury Rowhouses, the clubhouse is a mandatory element these days, yet it is not just a sign of luxury.





Experience a grand resort life

If the home at the Retreat Terraces will envelope you in the comfort zone, it's the recreational facilities like our indoor swimming pool, that will make you feel rejuvenated. Have the time of your life by indulging in a host of facilities that will peel-off all your concerns to make your weekends better and weekdays, greater.



Live active

Whenever you'll decide to take a break from the chaos of the world, the Breeze will always welcome you to enjoy a plethora of sporting activities that will make you to revisit active living. With a well appointed clubhouse along with a fully equipped state-of-the-art gym, and a multi-games facilities zone, you'll breathe in a new life and breathe out the city stress.

- Gymnasium
- Indoor games
- Yoga / Meditation



Dampen your taste buds

Once at the resort, you'll be overwhelmed by its overall ambience and warm hospitality. But other zones that'll entice you is the restaurants offering Variety of cuisines. Take your pick - a tough decision that - given the elaborate spread of delicacies from various regions.

Just dig into the subtle flavours and eat to your hearts content. After all you are what you eat!



Celebrate wholeheartedly

Play the perfect host with space as big as your heart. If you want to invite your guests for a very special occasion, don't hesitate out of embarrassment. If you have the heart we have the space to accommodate all those you consider very special at our party lawn.

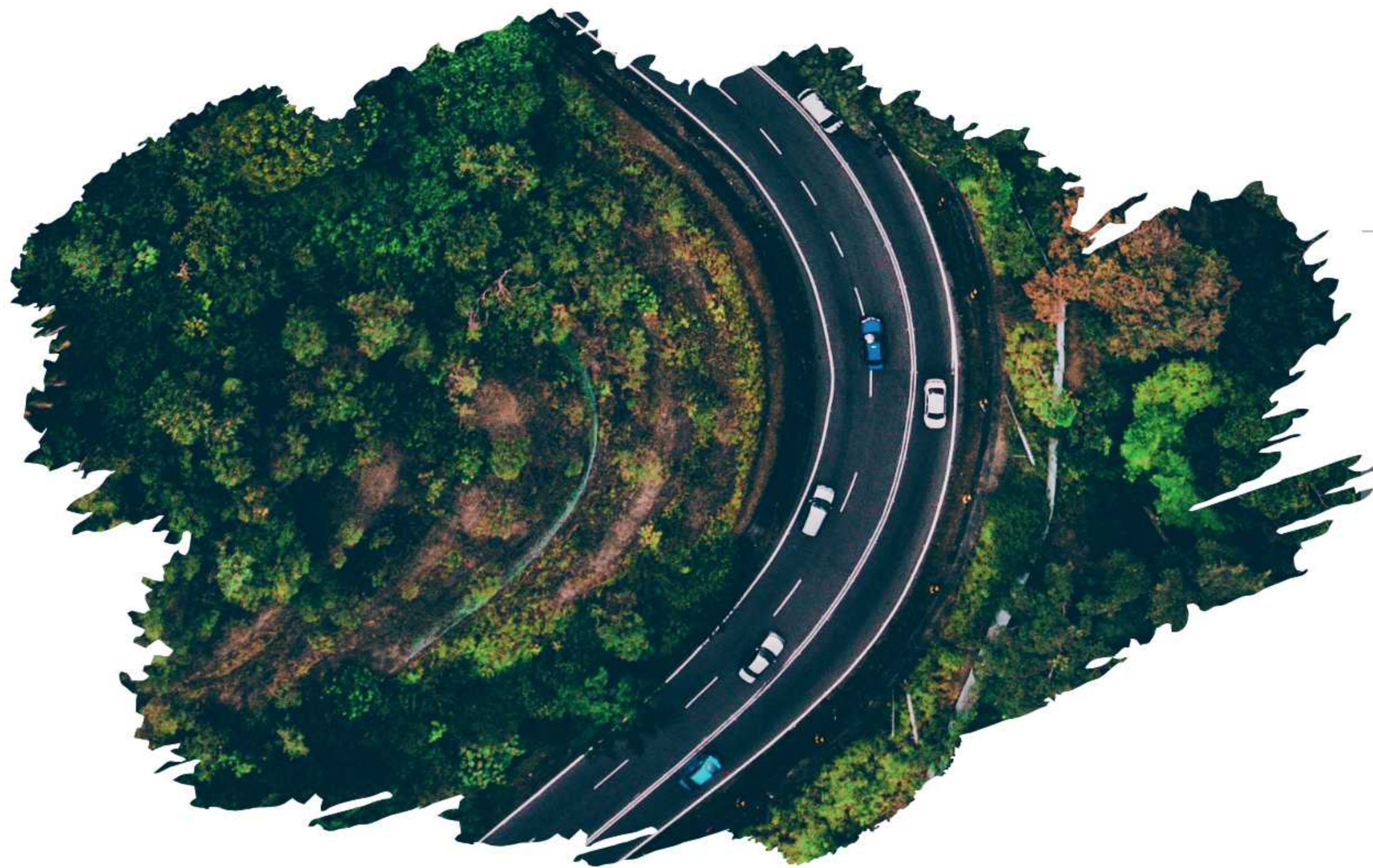

Close to nature closer to bliss

Retreat Terrace is located at KARJAT - MURBAD highway a green residential expanse making it a pollution-free area. There again you are amidst vast and open green spaces which are not only soothing to the eyes but beneficial to your health too.

Places any destination would love to have around

BAHIRI CAVE: It is a special traveller destination and Trekker's paradise

ND STUDIO: Experience Bollywood at ND studio

KONDANA CAVES: Kondana Caves are a formation made by cutting rock and are located on the bottom of a waterfall.

KOTHALIGAD FORT: Located in the Matheran range, this fort is surrounded by lush green and seasonal flora and fauna.

ULHAS VALLEY: This valley is dotted with many waterfalls best for hiking, trekking, camping and river rafting.

GORAKHGAD: It attracts trekkers due to its inviting pinnacles, This region has a dense forest cover.

KARJAT : Karjat is a little hill station near Mumbai. The town is famous for its incredibly Ulhas Valley, breathtaking views, caves and the sacred Kondeshwar temple.

MATHERAN: It is the smallest hill station of India. People love exploring the place by walking on foot. A no vehicle zone having pleasant climate and pure air.

MALSHEJ GHAT : It is a popular hill station having numerous lakes, waterfalls, mountains, and verdant flora and fauna,

VISHNUBAAUG ENVIRONMENT THEME PARK. AMUSEMENT & THEME PARKS: The Ambience Vishnubaug is nestled in picturesque 10 acres of land on the bank of perennial Ulhas River, at the foothills of Matherran ranges



Pune-Expressway - **60 mins**

Malshej Ghat - **45 mins**

Mumbai Domestic Airport - **90 mins**

International Airport - **90 mins**

Pune - **75 mins**

Vangani - **9 mins**

Panvel - **60 mins**

Lonavala - **45 mins**

Murbad - **10 mins**

Mumbai - **90 mins**

Badlapur - **30 mins**

Neral - **15 mins**

Karjat - **30 mins**

Thane - **60 mins**

Matheran - **30 mins**

3D PLANS - BLDG. 1

UNIT 001 (2 BHK)
BUILT-UP AREA - 1476 SQ. FT.
RERA CARPET AREA - 1382 SQ. FT.



3D PLANS - BLDG. 1

UNIT 002(3 BHK)
BUILT-UP AREA - 1446 SQ .FT.
RERA CARPET AREA - 1352 SQ.FT.



GROUND FLOOR PLAN



FIRST FLOOR PLAN



SECOND FLOOR PLAN

3D PLANS - BLDG. 1

UNIT 003(3 BHK)
BUILT-UP AREA - 1509 SQ .FT.
RERA CARPET AREA - 1383 SQ.FT.



GROUND FLOOR PLAN



FIRST FLOOR PLAN

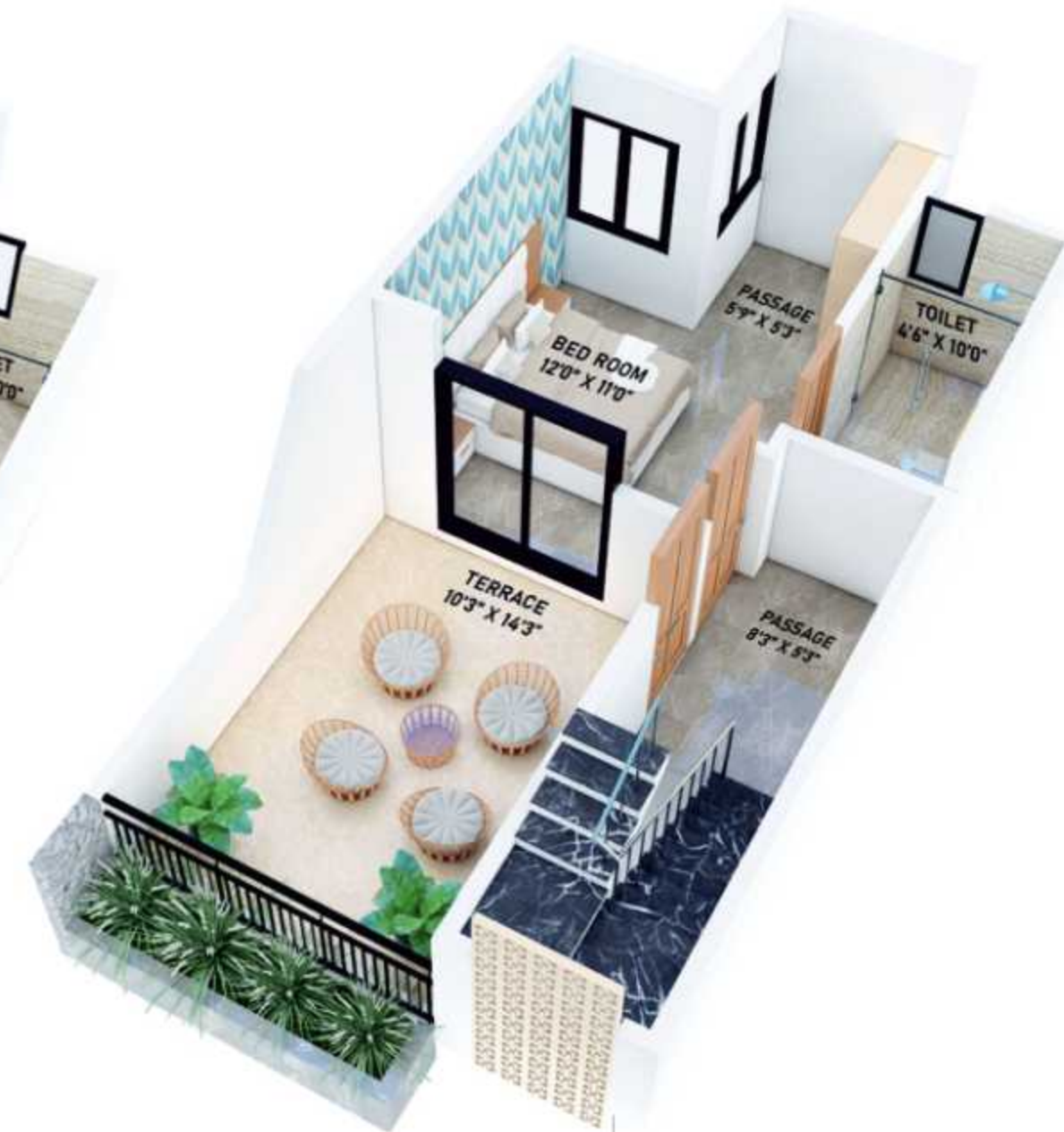

SECOND FLOOR PLAN

3D PLANS - BLDG. 1

UNIT 004(2 BHK)
BUILT-UP AREA - 1476 SQ .FT.
RERA CARPET AREA - 1382 SQ.FT.



GROUND FLOOR PLAN



FIRST FLOOR PLAN



SECOND FLOOR PLAN

3D PLANS - BLDG. 1

UNIT 005(3 BHK)
BUILT-UP AREA - 1446 SQ .FT.
RERA CARPET AREA - 1352 SQ.FT.



GROUND FLOOR PLAN



FIRST FLOOR PLAN



SECOND FLOOR PLAN

3D PLANS - BLDG. 1

UNIT 006(2 BHK)
BUILT-UP AREA - 1262 SQ .FT.
RERA CARPET AREA - 1155 SQ.FT.



GROUND FLOOR PLAN



FIRST FLOOR PLAN



SECOND FLOOR PLAN

3D PLANS - BLDG. 2

UNIT 001 (2 BHK)
BUILT-UP AREA - 1335 SQ. FT.
RERA CARPET AREA - 1243 SQ. FT.



GROUND FLOOR PLAN



FIRST FLOOR PLAN



SECOND FLOOR PLAN

3D PLANS - BLDG. 2

UNIT 002(3 BHK)
BUILT-UP AREA - 1446 SQ .FT.
RERA CARPET AREA - 1349 SQ.FT.



GROUND FLOOR PLAN



FIRST FLOOR PLAN



SECOND FLOOR PLAN

3D PLANS - BLDG. 2

UNIT 003(3 BHK)
BUILT-UP AREA - 1446 SQ .FT.
RERA CARPET AREA - 1349 SQ.FT.



GROUND FLOOR PLAN



FIRST FLOOR PLAN



SECOND FLOOR PLAN

3D PLANS - BLDG. 2

UNIT 004(3 BHK)
BUILT-UP AREA - 1763 SQ .FT.
RERA CARPET AREA - 1645 SQ.FT.



GROUND FLOOR PLAN



FIRST FLOOR PLAN



SECOND FLOOR PLAN

3D PLANS - BLDG. 2

UNIT 005(2 BHK)
BUILT-UP AREA - 1335 SQ .FT.
RERA CARPET AREA - 1243 SQ.FT.



GROUND FLOOR PLAN



FIRST FLOOR PLAN



SECOND FLOOR PLAN

3D PLANS - BLDG. 2

UNIT 006(3 BHK)
BUILT-UP AREA - 1446 SQ .FT.
RERA CARPET AREA - 1349 SQ.FT.



GROUND FLOOR PLAN



FIRST FLOOR PLAN



SECOND FLOOR PLAN

3D PLANS - BLDG. 2

UNIT 007(3 BHK)
BUILT-UP AREA - 1446 SQ .FT.
RERA CARPET AREA - 1349 SQ.FT.



GROUND FLOOR PLAN



FIRST FLOOR PLAN



SECOND FLOOR PLAN

3D PLANS - BLDG. 2

UNIT 008(2 BHK)
BUILT-UP AREA - 12996 SQ .FT.
RERA CARPET AREA - 1126 SQ.FT.



GROUND FLOOR PLAN



FIRST FLOOR PLAN



SECOND FLOOR PLAN

3D PLANS - BLDG. 3

UNIT 001 (2 BHK)
BUILT-UP AREA - 1334 SQ. FT.
RERA CARPET AREA - 1243 SQ. FT.



GROUND FLOOR PLAN

FIRST FLOOR PLAN

SECOND FLOOR PLAN

3D PLANS - BLDG. 3

UNIT 002(3 BHK)
BUILT-UP AREA - 1446 SQ .FT.
RERA CARPET AREA - 1349 SQ.FT.



GROUND FLOOR PLAN



FIRST FLOOR PLAN



SECOND FLOOR PLAN

3D PLANS - BLDG. 3

UNIT 003(3 BHK)
BUILT-UP AREA - 1446 SQ .FT.
RERA CARPET AREA - 1349 SQ.FT.

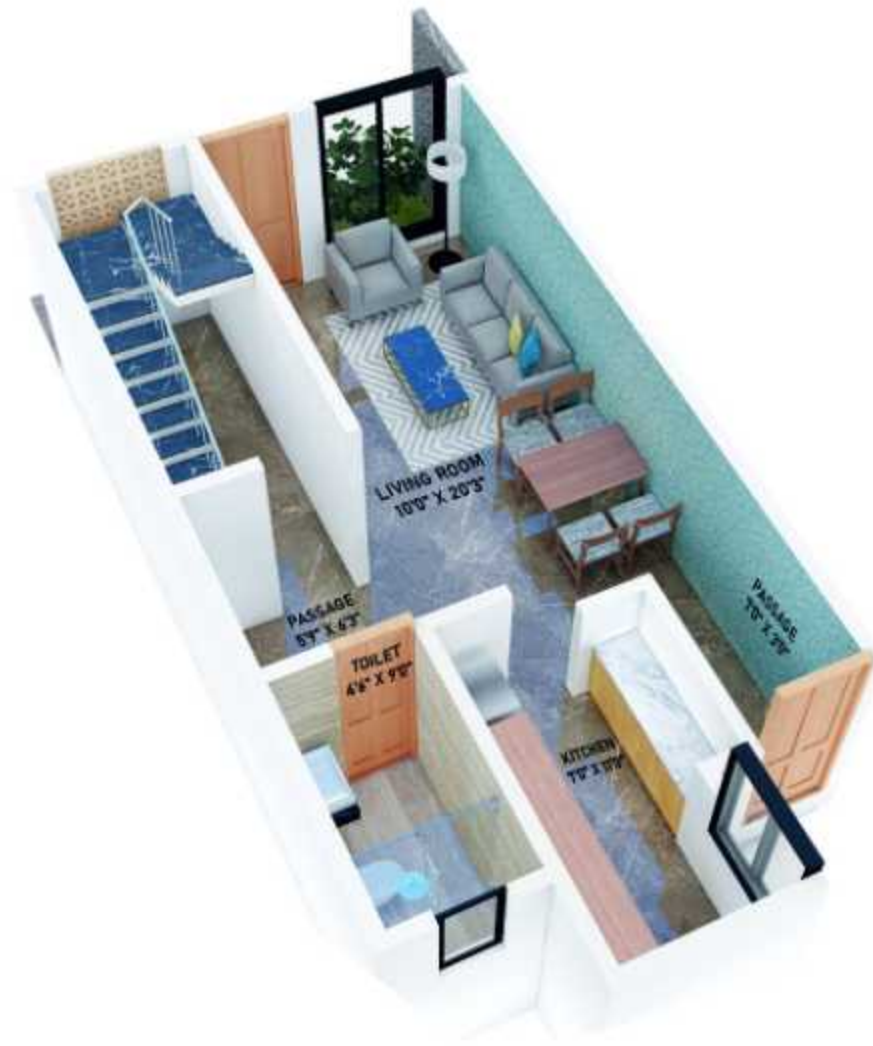

GROUND FLOOR PLAN



FIRST FLOOR PLAN



SECOND FLOOR PLAN

3D PLANS - BLDG. 3

UNIT 004(3 BHK)
BUILT-UP AREA - 1446 SQ .FT.
RERA CARPET AREA - 1349 SQ.FT.



GROUND FLOOR PLAN



FIRST FLOOR PLAN



SECOND FLOOR PLAN

3D PLANS - BLDG. 3

UNIT 005(3 BHK)
BUILT-UP AREA - 1364 SQ .FT.
RERA CARPET AREA - 1250 SQ.FT.



GROUND FLOOR PLAN



FIRST FLOOR PLAN



SECOND FLOOR PLAN

3D PLANS - BLDG. 3

UNIT 006(3 BHK)
BUILT-UP AREA - 1334 SQ .FT.
RERA CARPET AREA - 1243 SQ.FT.



GROUND FLOOR PLAN



FIRST FLOOR PLAN



SECOND FLOOR PLAN

3D PLANS - BLDG. 3

UNIT 007(3 BHK)
BUILT-UP AREA - 1446 SQ .FT.
RERA CARPET AREA - 1349 SQ.FT.



GROUND FLOOR PLAN



FIRST FLOOR PLAN



SECOND FLOOR PLAN

3D PLANS - BLDG. 3

UNIT 008(3 BHK)
BUILT-UP AREA - 1446 SQ. FT.
RERA CARPET AREA - 1349 SQ. FT.



GROUND FLOOR PLAN



FIRST FLOOR PLAN



SECOND FLOOR PLAN

3D PLANS - BLDG. 3

UNIT 009(3 BHK)
BUILT-UP AREA - 1446 SQ .FT.
RERA CARPET AREA - 1349 SQ.FT.



GROUND FLOOR PLAN



FIRST FLOOR PLAN



SECOND FLOOR PLAN

3D PLANS - BLDG. 3

UNIT 010(3 BHK)
BUILT-UP AREA - 1469 SQ. FT.
RERA CARPET AREA - 1348 SQ. FT.



GROUND FLOOR PLAN



FIRST FLOOR PLAN



SECOND FLOOR PLAN