

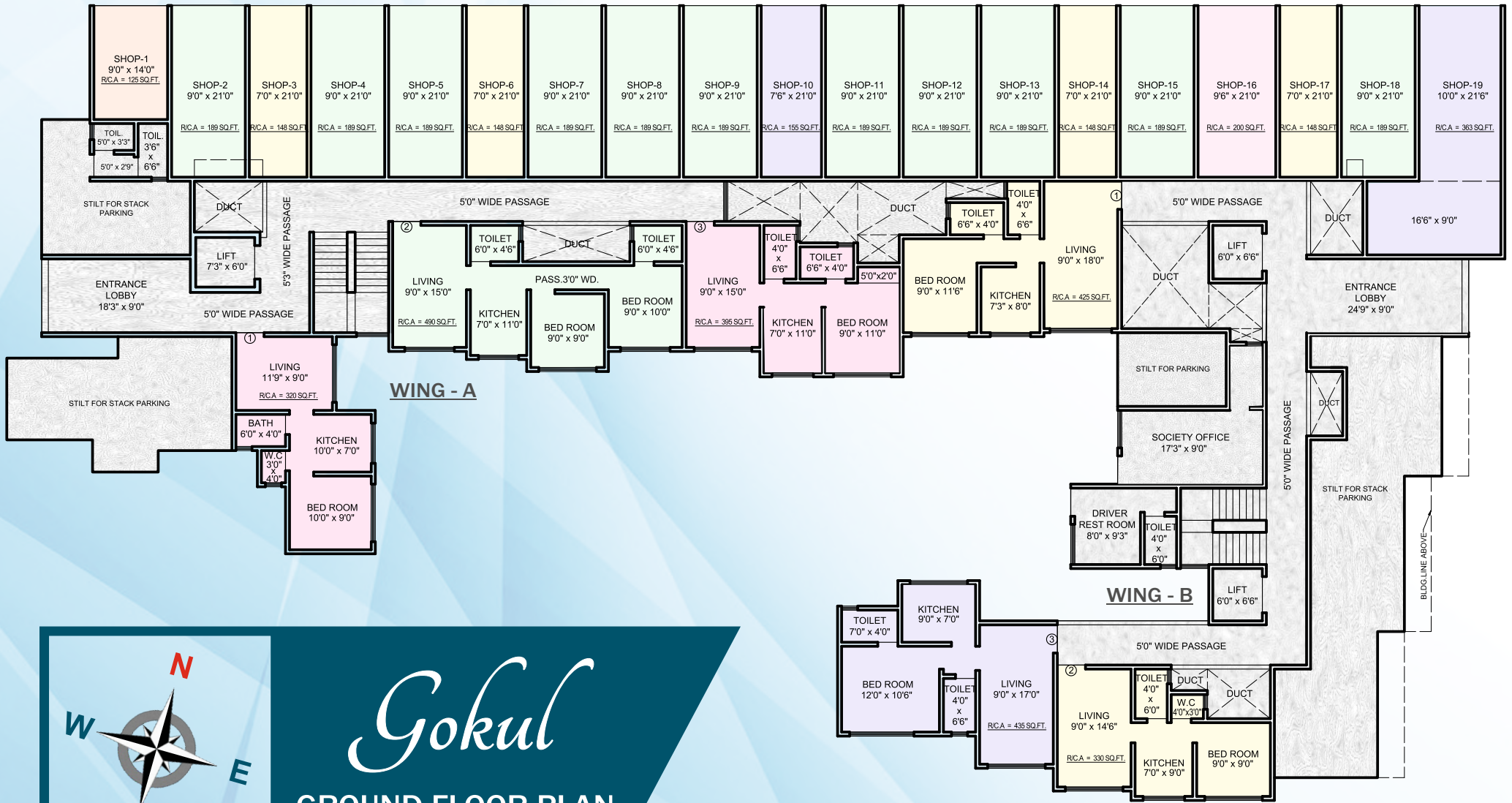

*Gokul & Raghukul*

*Gokul*





# Gokul

## GROUND FLOOR PLAN

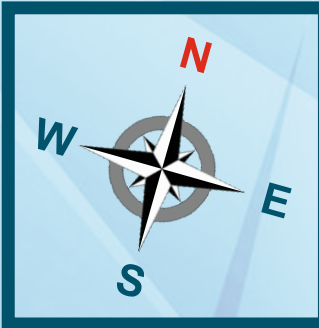
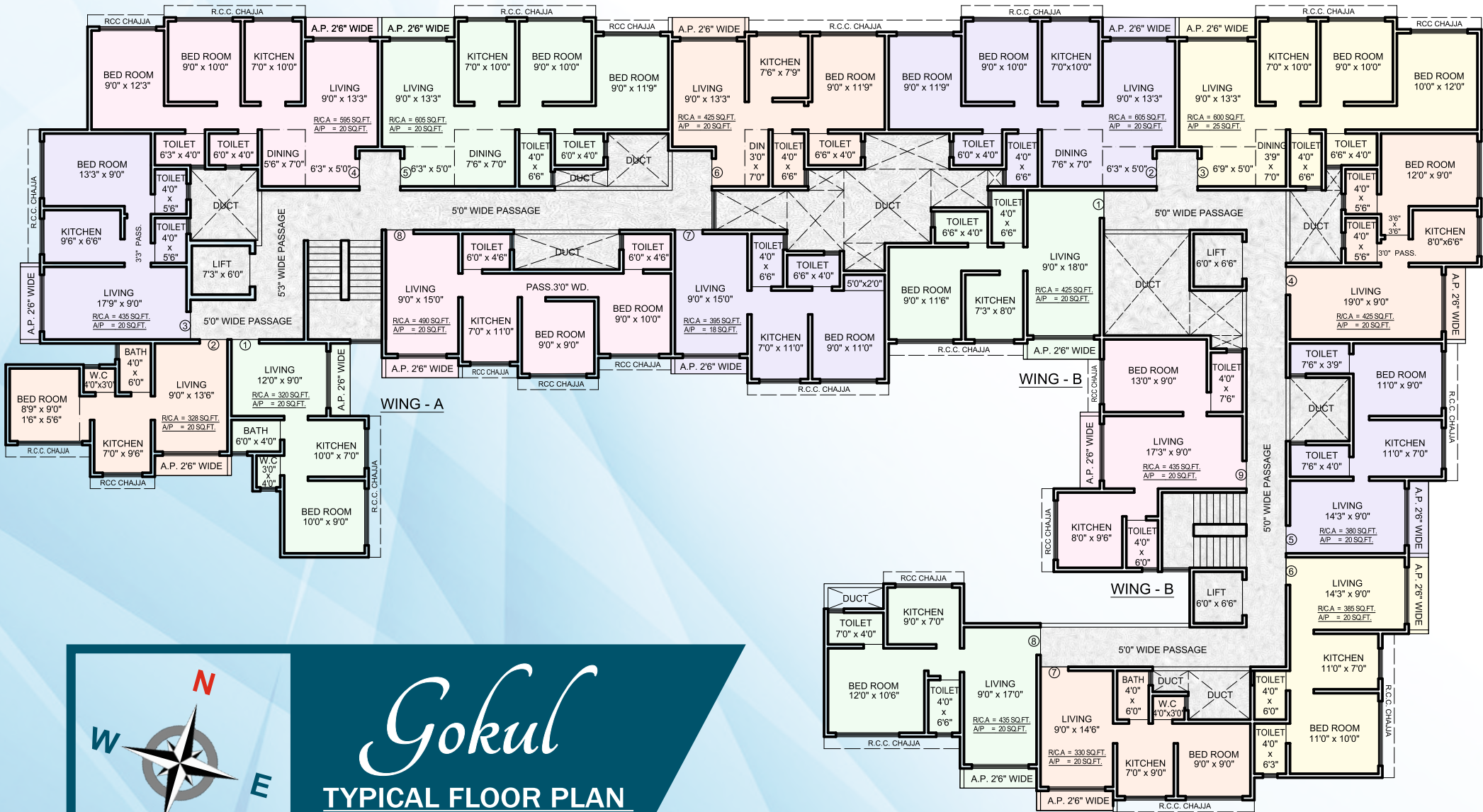

*Gokul*  
**TYPICAL FLOOR PLAN**  
**(2ND TO 7TH)**

# Raghukul



# Raghukul GROUND FLOOR PLAN

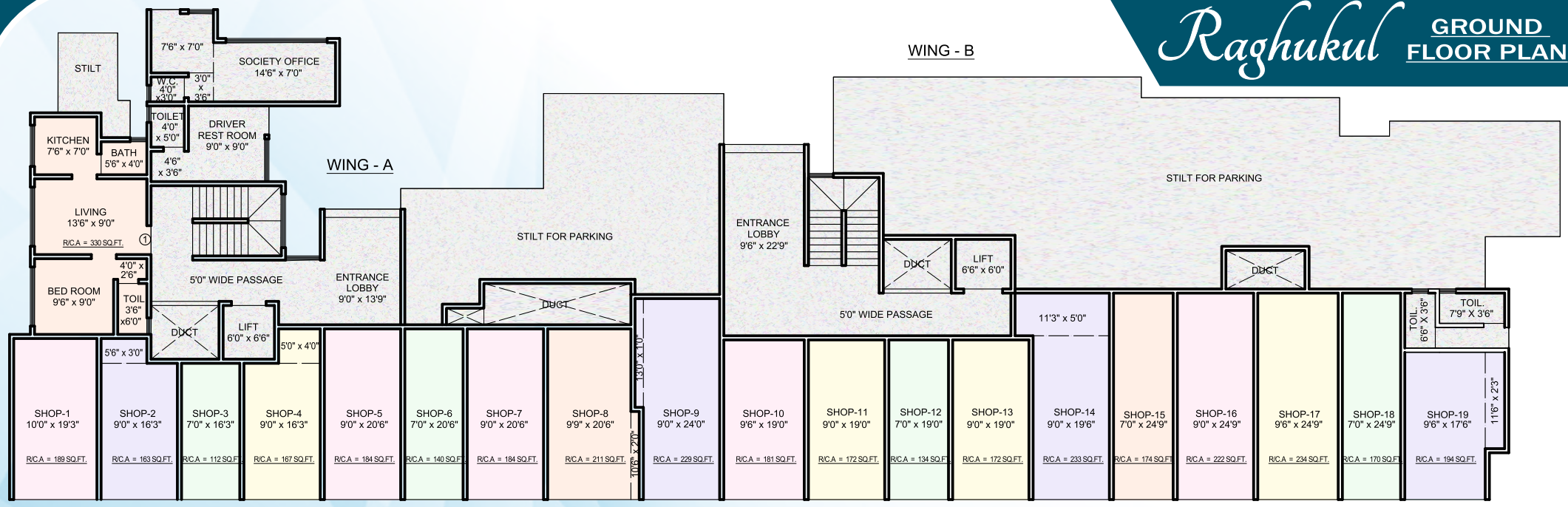

# Raghukul TYPICAL FLOOR PLAN (2ND TO 7TH)

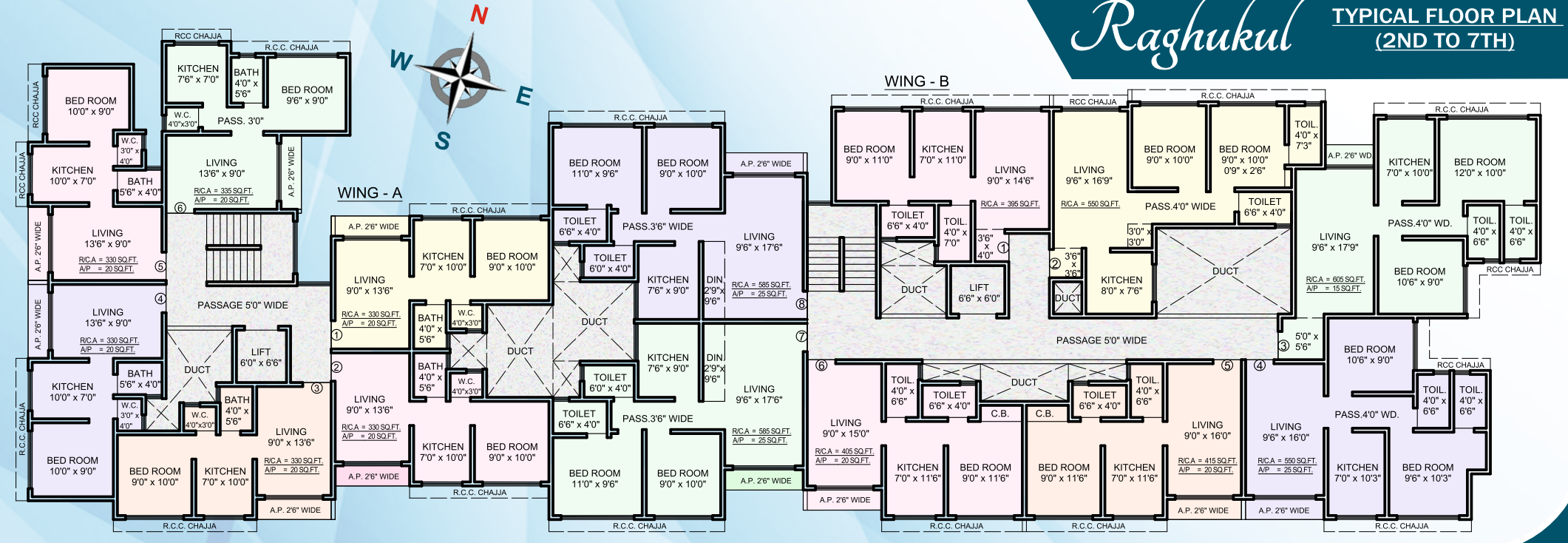



## PROJECT HIGHLIGHTS

- Reputed generator back up for lift
- Decorative entrance lobby
- Decorative main door with quality brass fittings
- Powder coated aluminium sliding windows
- Granite kitchen platform with stainless steel sink
- Designer kitchen trolley with wooden panel
- Water storage tank in loft with wooden panel
- Full glazed tiles in W.C. & bath with concealed plumbing
- Modern brass fittings with quality sanitary wares
- Concealed copper electric wire fitting with essential points
- Acrylic distemper finish for entire flat
- POP fall ceiling in living room
- Designer floor tiles for flooring
- Loan facilities from all leading institutions
- G + 7 storied Residential & Shoplevel Building
- Full CC Received
- VVCMC & MAHARERA Approved Project
- Lifts of a reputed brand
- Fire Fighting System
- Rain Water Harvesting System
- Professionally managed 24 X 7 security
- 24 X 7 CCTV Camera in building premises

Project by...



Maha RERA Reg. No. P99000054786

Details Available on <https://maharera.mahaonline.gov.in>

### Architect

#### ONE SOURCE

MR. DIPESH K. VANMALI

A-1/203, Philips HSG Complex, Near Dattani Square Mall, Vasai (West) : 401202.

Contact : 9850687815 • Email : dipeshvanmali0307@gmail.com

### RCC Consultant

#### GR CONSULTANTS

MR. MOHAMMAD SHOEB BHATI

303, Patil & Pawar Building, Opp. SBI, Station Road, Vasai (West) : 401202.

Contact : 9004854257 • Email : grconsultants1050@gmail.com

### Advocate

#### DHURI & ASSOCIATES

MR. SHEKHAR RAJARAM DHURI

A/2 Chandresh Vandan, Shree Sai Dutt Mandir Marg, Achole Road, Nallasopara (E) : 401209.

Contact : 7768807444 • Email : dhuri\_shekhar@rediffmail.com

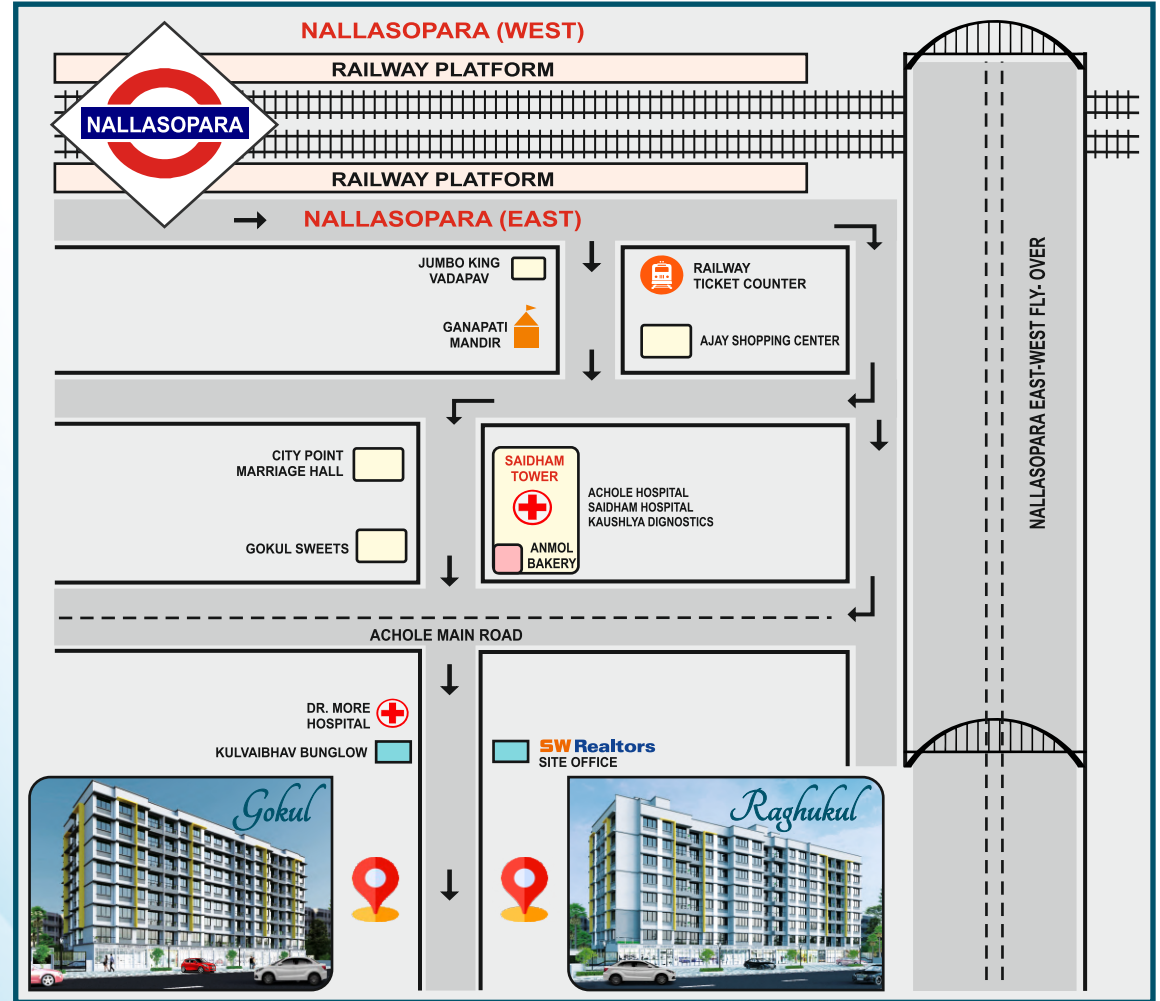

### Redg. Office Address

B-002, Nandkul, Kulvaibhav Nagar, Achole Road, Near More Hospital, Nallasopara (E), Tal. : Vasai, Dist. : Palghar : 401209.

Contact : 7757981584 • Email : sw.realtors999@gmail.com

### Site Address

RBI Gokul CHS, Raghukul CHS, Kulvaibhav Nagar, Achole Road, Near More Hospital, Nallasopara (E), Tal. : Vasai, Dist. : Palghar : 401209.

This brochure is purely conceptual and not a legal offering. The Promoter/ Architect reserve the right to add/delete/ alter any detail/specification/elevation mentioned herein. The brochure is indicative of how the furniture can be arranged in the flat. No furniture of any nature is to be supplied to the flat purchaser by the developer.