

LIVE LIFE **KINGSIZE**
AT **AMAZING PRICE**



ELEMENTS

by **ORO**

2 & 3 BHK APARTMENT AT ORO CITY, LUCKNOW

Sector-J (Extn.) Jankipuram, Lucknow

ELEMENTS WOULD BE A PLACE
WHERE YOU WOULD LOVE TO
ENJOY YOUR LIFE



Elements new address of your home, Every possible care has been taken while designing & conceptualizing your new home. The name Elements is symbolic to the five elements of nature described in Vedas. The first and the most essential i.e. Bhumi defines the spacious housing, the Jal is a symbolic to clean and perennial water supply, the Agni is a synonymous to 24x7 supply of electricity, the Pavan offers a source of fresh air to life and finally Akash completing it with spacious parks and playing area for kids to grow in the realms of nature.

ELEMENTS

by **ORO**

LIVE LIFE KINGSIZE AT AMAZING PRICE

Elements by Oro City is a chain of apartments – **Azure, Aria and Aqua** through which we aim at gratifying the luxury desires of our customers at affordable prices.

Access to the park, club and swimming pool in the Oro city is nothing but icing on the cake. Last but not the least, it has been developed within the periphery of the city to provide easy accessibility to all the prime locations.

At Elements three blocks Azure, Aria & Aqua symbolizing the essential elements of life, these blocks have been designed in such a way to ensure maximum comfort & ease of life.

A WELL-PLANNED FACILITIES AND AMENITIES

- Manned entry & exit
- Double Height Entrance Lobby
- 70% open and green area
- Ample parking space
- Large central lawn
- Walkway and yoga area
- Quite Zone
- Children play area

Club Celebration
CLUBHOUSE WITH
SWIMMING POOL

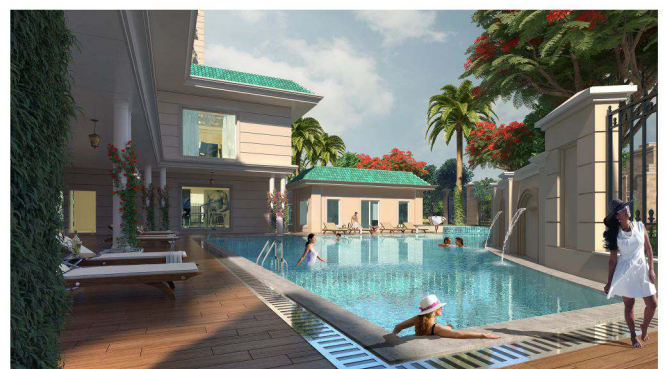

3BHK UNIT PLAN TYPE - A1



UNIT : 3 BHK | TYPE - A1 | **3BHK+2TOILET+4BALCONIES**
RERA CARPET AREA : 644.35 SQ.FT.
BUILT-UP AREA (Including balcony) : 843.38 SQ.FT.
REFERENCE AREA: 1125.00 SQ.FT.

3BHK UNIT PLAN TYPE - A2



UNIT : 3 BHK | TYPE - A2 | **3BHK+2TOILET+4BALCONIES**
RERA CARPET AREA : 644.35 SQ.FT.
BUILT-UP AREA (Including balcony) : 843.38 SQ.FT.
REFERENCE AREA: 1125.00 SQ.FT.

3BHK UNIT PLAN TYPE - B



UNIT : 3 BHK | TYPE - B | **3BHK+2TOILET+3BALCONIES**
 RERA CARPET AREA : 645.18 SQ.FT.
 BUILT-UP AREA (Including balcony) : 814.13 SQ.FT.
 REFERENCE AREA: 1090.00 SQ.FT.

2BHK UNIT PLAN TYPE - C



UNIT : 2 BHK | TYPE - C | **2BHK+2TOILET+2BALCONIES**
 RERA CARPET AREA : 532.03 SQ.FT.
 BUILT-UP AREA (Including balcony) : 677.50 SQ.FT.
 REFERENCE AREA: 890.00 SQ.FT.

Disclaimer : The area and plan shown here is subject to change. 1sq.ft.=0.093sq.mt. | 10.764sq.ft.=1.196sq.yd. and 3.28ft.-1mt.
 All dimensions shown in feet inches are close approximation to metric dimensions.
 The dimensions and super area mentioned above may vary from unit to unit on completion of construction.
 Please check exact dimensions with the marketing team. | RERA carpet area includes area between the inner face of the outer wall of the unit.
 Reference area includes RERA carpet area plus balcony area, external wall area of the unit, common area of the tower.

SITE LAYOUT PLAN



Disclaimer: This Brochure is indicative in nature & may not constitute as an offer or invitation for the purpose of Registration/Booking/Sale. The viewer may seek all such information, sanction plans, approval, development schedule, specifications, facilities & amenities, from the company in respect of the concerned project that they may be interested in, before any such booking/registration, etc. Further details of the project(s) are available on the Company website or the Website of up-rera.in. Visual representation shown in this advertisement is purely conceptual and not a legal offering. All building plans, specifications, site plan, layout plans etc. may be sought from the company/site/marketing office or website of the company-www.oroconstructions.in or RERA website: up-rera.in/ before the registration/booking of the said flat/unit.

RERA Project Registration No. **UPRERAPRJ951368**
 website : <http://up-rera.in/>

