



Gajanan ICON

Welcome to the WORLD of
LOVE and COMFORT



Gajanan Properties have made their mark in Real Estate Development and Construction in Kalyan with their focused approach and customer centric deliverables for more than a decade.

They are supported by an able team of engineers, architects, contractors, construction professionals, consultant and affiliates who are responsible for continuously innovating and developing milestones of distinction.

Launching of the flagship Gajanan Icon is yet another important milestone in the relentless journey on the path to excellence.

A Blissful **Feeling**
you Truly **Deserve...**

Naturally, our objective is to give you experiences of living in a habitat no less than heaven.





Gajanan ICON



1 BHK Isometric View

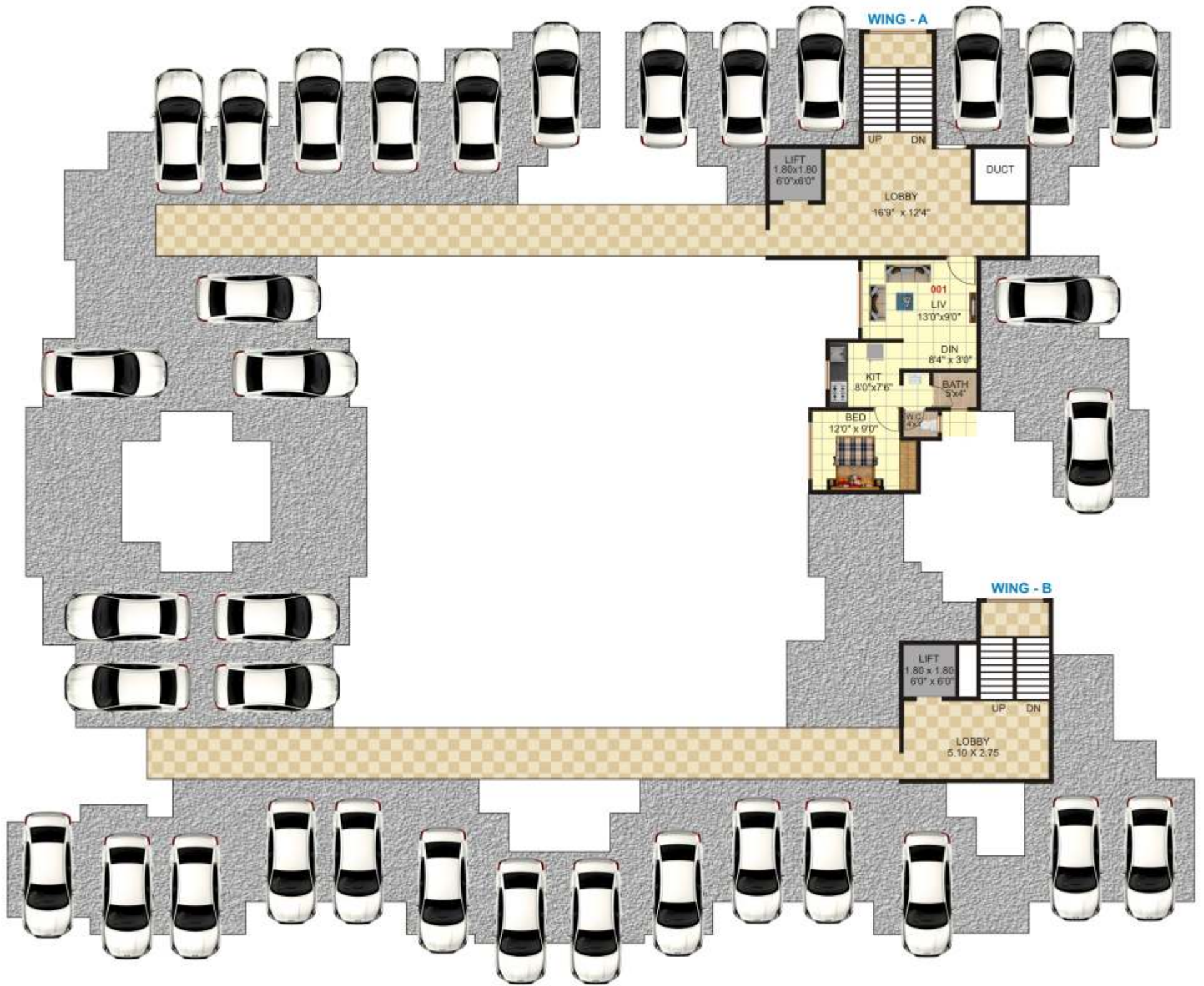

**GROUND FLOOR PLAN
BLDG. NO. 2**



Gajanan ICON



2 BHK Isometric View

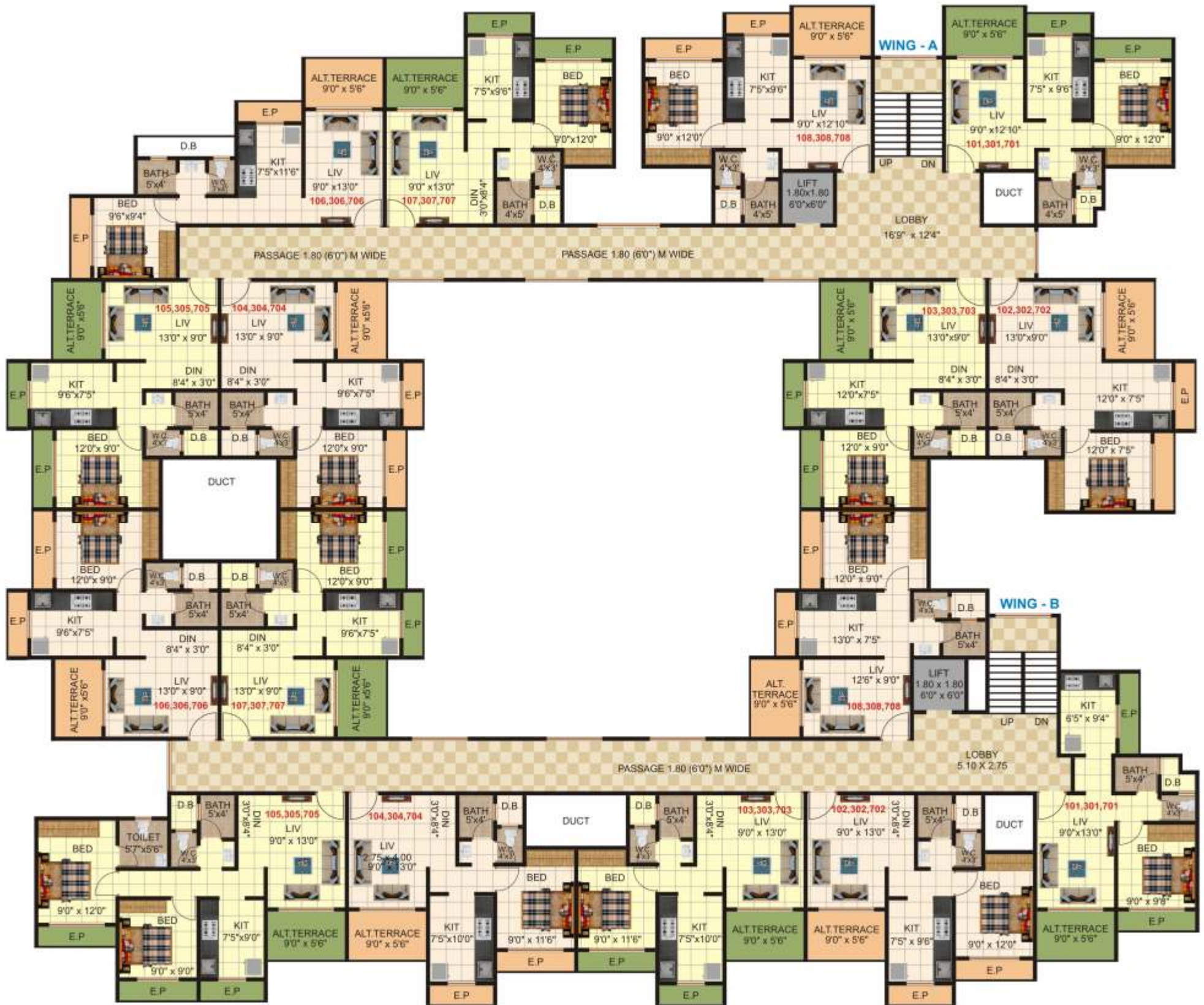

**FIRST, THIRD & SEVENTH FLOOR PLAN
BLDG. NO. 2**

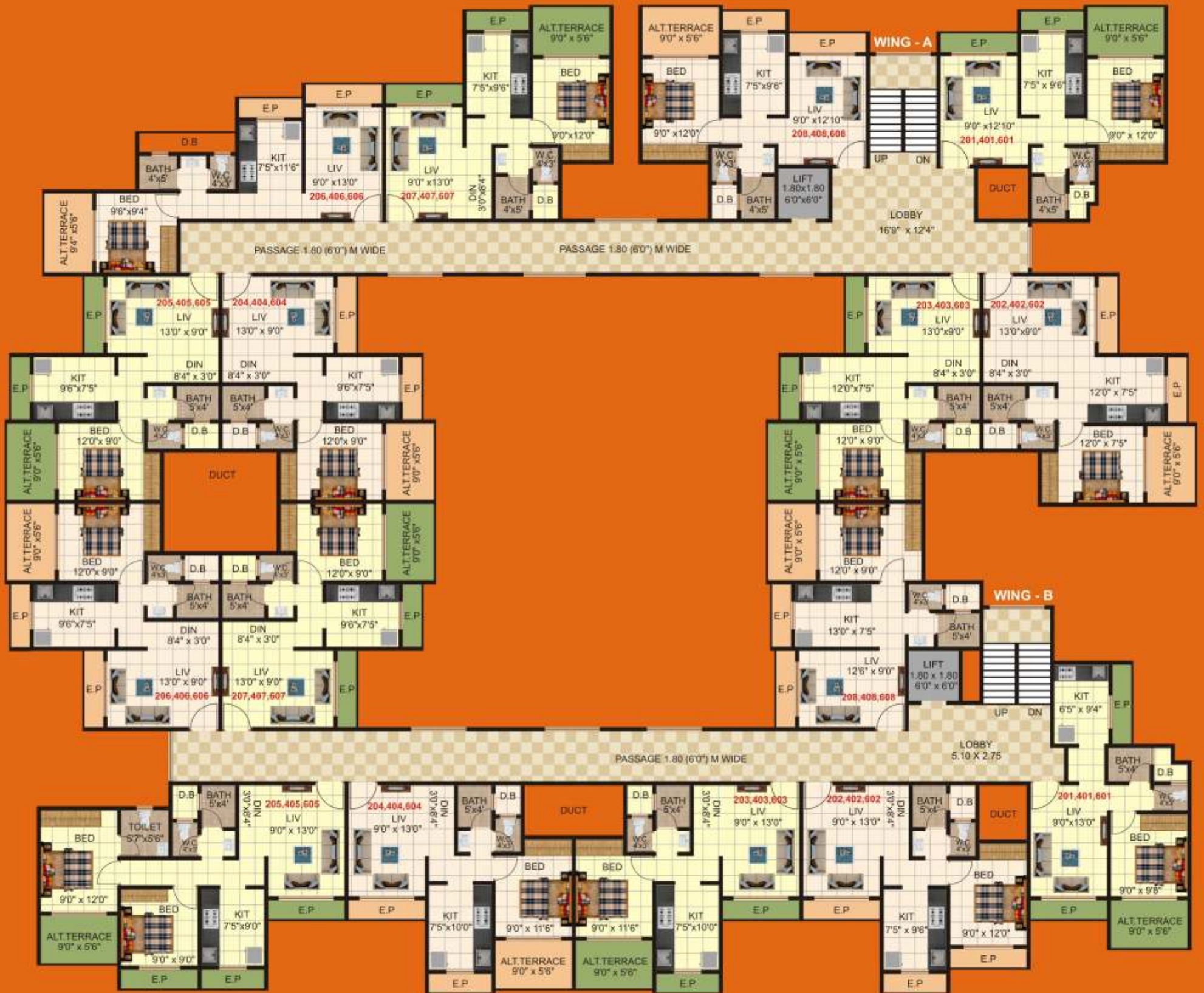

**SECOND, FOURTH & SIXTH FLOOR PLAN
BLDG. NO. 2**



**FIFTH FLOOR PLAN
BLDG. NO. 2**

Flat Specifications

Flooring : 32" X 32" Polished Vitrified Branded Flooring Tiles

Skirting : 3" High Skirting of Vitrified Tiles.

Windows Sill : Indian Marble from Outside and Black Granite from inside (Double Step Sill)

Toilets : 12" X 12" Ceramic Tiles for Flooring & Dado of approved Shade upto door Height

Kitchen : Double side Platform in Black Granite with Stainless Steel Sink with loft above door.

Door Frame : Salwood / Red Mirandi

Main Door : 40mm flush door with Laminate finish & with provision of safety door.

Bedroom & Toilet Door : FOB type Doors

Locks : Mortise Handle in SS finish with Branded Lock on Main Door.

Windows : 25mm series Anodised Aluminum Section.

Railing : MS Painted Railings

Sanitary Ware : All Sanitary ware in Parry Ware / Hind ware Mirror in each Bathroom.

CP Fitting : All CO Fitting in Jaguar - Florentine Series or equivalent.

Plumbing : Concealed type.

Electrical : Concealed Wiring of ISI quality Brand - Polycab / Finolex or equivalent.

Switches : MDS / Anchor or equivalent.

Wall finish : POP with plastic emulsion paint of Asian / ICI / Berger.

Storage : Loft above all toilets storage tank of 500 litres.

Security : Intercom facility. facility for water





Gajanan ICON



Our Landmark

A world within striking distance of
key Destinations and Major Transit Junctions