



SUMMER GARDEN

#48/4, Muthukumarappa Street,
Saligramam, Chennai - 93



SUMMER GARDEN

SUMMER GARDEN

Day View



Evening View



Flat	Facing	BHK's	RERA Carpet Area	Area
A	East	2 BHK	656 Sq Ft	945.40 Sq Ft

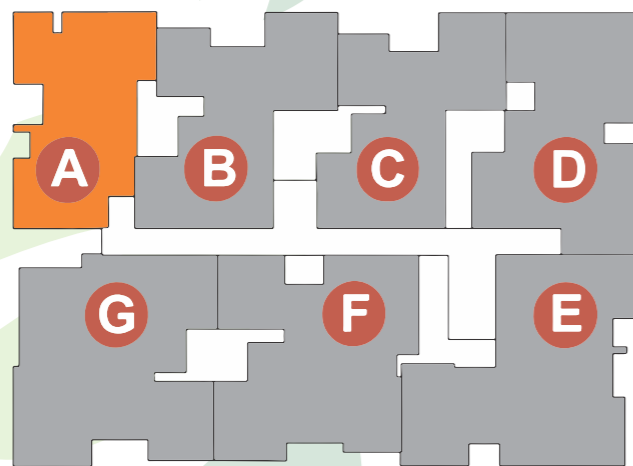

KEY PLAN





A
ENTRY

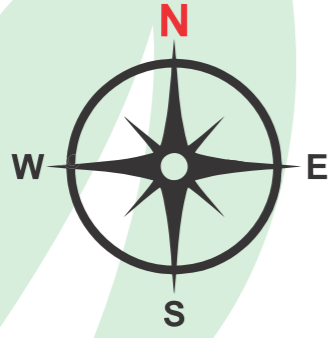

Flat	Facing	BHK's	RERA Carpet Area	Area
B	East	2 BHK	694 Sq Ft	1048.48 Sq Ft

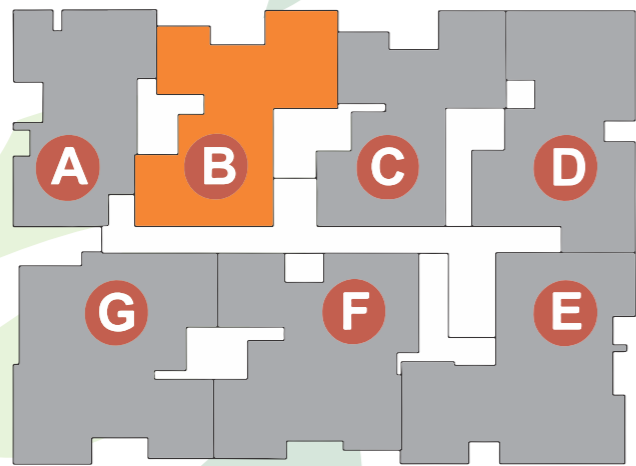

KEY PLAN



ENTRY

ENTRY  **B**



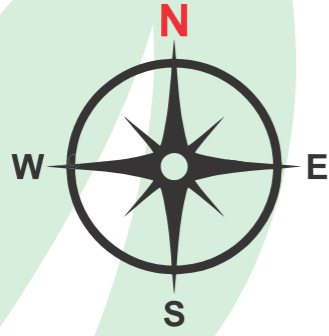

Flat	Facing	BHK's	RERA Carpet Area	Area
C	East	2 BHK	673 Sq Ft	1028.26 Sq Ft

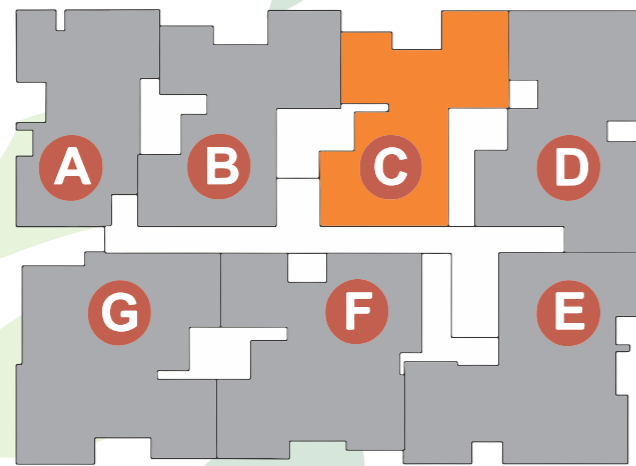

KEY PLAN



▲ ENTRY

ENTRY  



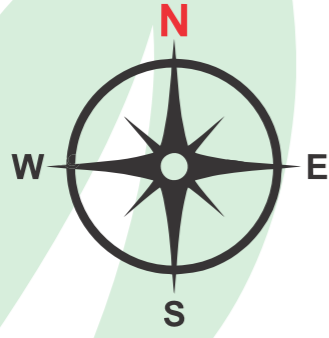

Flat	Facing	BHK's	RERA Carpet Area	Area
D	South	3 BHK	811 Sq Ft	1147.86 Sq Ft

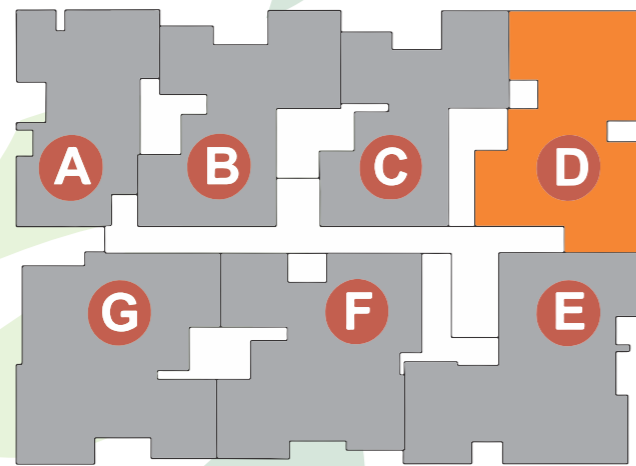

KEY PLAN



ENTRY

ENTRY



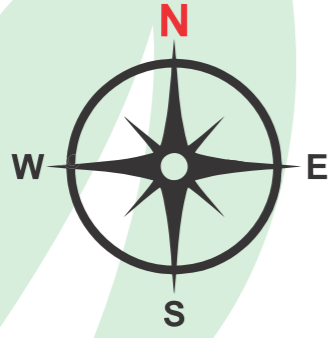

Flat	Facing	BHK's	RERA Carpet Area	Area
E	North	3 BHK	945 Sq Ft	1324.59 Sq Ft

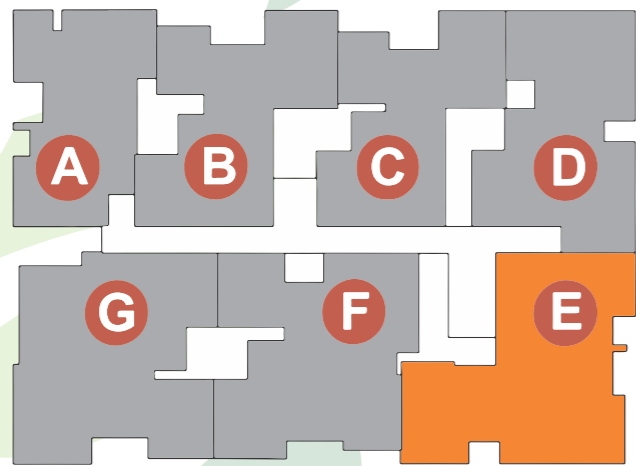

KEY PLAN





ENTRY  **E**

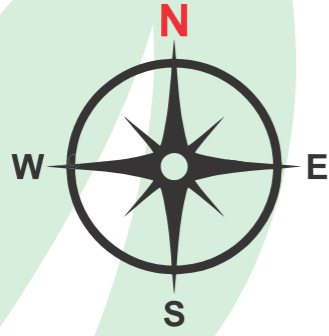

Flat	Facing	BHK's	RERA Carpet Area	Area
F	North	3 BHK	907 Sq Ft	1292.11 Sq Ft

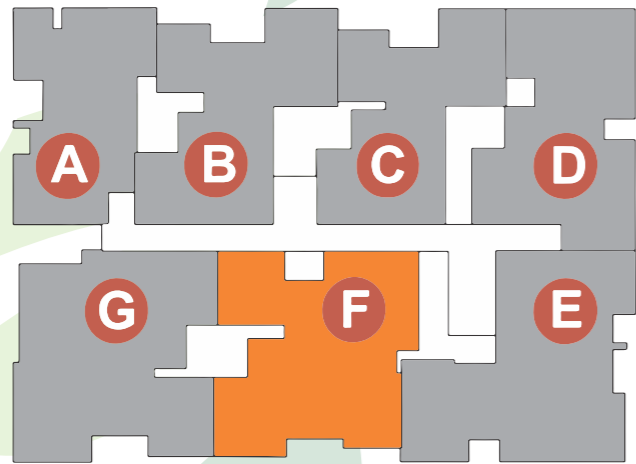

KEY PLAN





ENTRY  

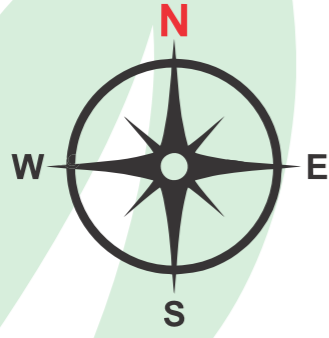

Flat	Facing	BHK's	RERA Carpet Area	Area
G	North	3 BHK	977 Sq Ft	1370.69 Sq Ft

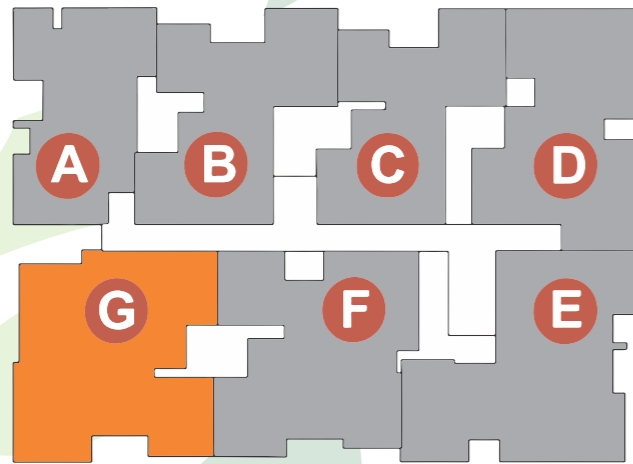

KEY PLAN

ENTRY



ENTRY  

Floor Plan



Specifications

Common Amenities & Features

- ❖ Automatic Lift
- ❖ CCTV Cameras
- ❖ Meeting/Office Room.
- ❖ 100 % power back up for common area
- ❖ 1000 Watts supply for each apartment
- ❖ Toilet for drivers
- ❖ Equipped GYM
- ❖ Reserved Car Parking
- ❖ Rainwater harvesting
- ❖ 24/7 Security

Flooring

- | | |
|----------------------|---------------------------------|
| ❖ Living + Dining | Vitrified Tiles |
| ❖ Bedrooms | Vitrified Tiles |
| ❖ Kitchen | Vitrified Tiles |
| ❖ Balcony + Bathroom | Anti-skid Tiles |
| ❖ Bathroom Wall | Tiles upto false ceiling height |

Kitchen

Granite platform with S.S. sink with drain board
wall tiles upto 2" feet above the platform

- | | |
|---------------|-----------------|
| ❖ Windows | UPVC Windows |
| ❖ Balcony | Glass handrails |
| ❖ Dry balcony | S.S. handrail |

Bathroom

CP & Sanitaryware Fittings Parryware / Hindware
Hand shower with mixer in Master bathroom
Wall mounted closet in all bathrooms

Doors

- | | |
|---------------------|--|
| ❖ Main Door | Classy main door & Frame with varnish finish |
| ❖ All Bedroom Doors | hardcore flush door with melamine finish |
| ❖ Bathroom doors | Anti-rotting door |
| ❖ Locks | Dorma/Hafele |

Wall Finish

- | | |
|------------|--|
| ❖ Exterior | Weatherproof emulsion (Texture finish) |
| ❖ Interior | Quality emulsion |

Electrical

- ❖ 3- Phase with individual meters
- ❖ Switches Legrand or equivalent make
- ❖ Polycab or equivalent make with MCB's & ELCB'S

Schedule of payments

On Booking	10%
Payment for Agreements	40%
Completion of Foundation	10%
Completion of Stilt Roof Slab	10%
Completion of Respective Flat Roof Slab	10%
Completion of Respective Flat Brick Work	10%
Completion of Respective Flat Plastering	5%
Completion of Respective Flat Flooring	2.5%
On Handing Over	2.5%
Total	100%

Living Room



Kitchen



Dinning



Bed Room



Meeting / Office Room



Corridor



Gym



Toilet





SUMMER GARDEN

#48/4, Muthukumarappa Street,
Saligramam, Chennai - 93



for more detail contact

90030 89000
99400 22516

www.vaanamconstructions.com
sales@vaanamconstructions.com

RERA No. : TN / 29 / Building / 0092 / 2021

Approved Banks



Vaanam Constructions &
Development Private Limited
Old. No 74, New. No.192, 3rd Floor,
Triplicane High, Triplicane, Chennai - 600 005.