



THE PINNACLE OF
LUXURY



PROJECT BY



ARCHITECT

HKA
HK ARCHITECTS

STRUCTURAL



MARUTI CONSULTANTS

RERA REGISTRATION NO. :
PR/GI/AHMEDABAD/AHMEDABAD CITY/Ahmedabad Municipal Corporation/
RN81AA09981/180622

Website : www.gujrera.gujarat.gov.in

Shiv Vivanta, Nr. Jay Visat Royal,
Opp. Parmeshwar Merriment,
Chandkheda , Ahemdabad.

For Booking :
+91 80007 88176, 84691 96207, 90994 91349



3 BHK PREMIUM SKY-LIVING
@ CHANDKHEDA

NOTES • Stamp Duty, Registration Charges, Legal Documentation Charges, Advance Maintenance, Fixed Maintenance Charges, AMC Charges And Electrical Co. Charges including cable and sub-station cost shall be borne by the purchaser. • GST or any additional charges, taxes, cess or duties levied by the government/ local authorities prior, during or after the completion of the scheme shall be borne by the purchaser. • Changes/alteration of any nature, including the elevations, exterior colour scheme of the apartments or any other change affecting the overall design concept and outlook of the scheme are strictly not permitted during or after the completion of the scheme. • All elements, Objects, treatments, materials, equipments and colour scheme shown are artist's impressions. Actual may be different as per architect's designs. • All dimensions shown here are unfinished wall. • The brochure is intended only to convey the essential design and technical features of the scheme.

**SHIV
VIVANTA**
3BHK MODERN LIVING

Shiv Vivanta - Built with Love, Crafted with finesse; come home to a privileged address.

Right from its amazing location, fine architecture, smart space planning, modern amenities to the passion to bestow you with the fine living experience, these abodes will be the reason for you to realize "life is truly wonderful".



A COLLAGE OF
DESIGN & LUXURY

A symbiotic collage of design and luxury.

Calm and convenience. Style and sophistication.

Shiv Vivanta addresses every little details of life in a big city in its thoughtfully designed apartments.

Amenities, features and sublime finishes, blend seamlessly to provide a holistic and harmonious living experience. A place that lets you live life your way.



WHERE 'LIGHTER LIVING' IS THE WAY OF YOUR LIFE

In today's hectic life when time is the most precious element of our lives, the prime location of Shiv Vivanta offers you unmatched connectivity and convenience, saving you a lot of moments to spend with your family.

- Hospital _____ 0.2 Km
- BRTS Bus Stop _____ 0.3 Km
- S. P. Ring Road _____ 1.0 Km
- Mall & Multiplex _____ 1.0 Km
- Divine Child Int. School _____ 2.5 Km
- Metro Station _____ 3.0 Km
- Nirma University _____ 5.0 Km
- Railway Station _____ 5.0 Km
- Sabarmati River Front _____ 6.0 Km
- Adalaj Tri Mandir _____ 7.0 Km
- Air Port _____ 10.0 Km



SHIV VIVANTA
3BHK MODERN LIVING





ENRICH YOUR MIND, BODY & SOUL

Keep yourself, friends and kids busy and active with access to a one-of-a-kind indoor game zone.

Enjoy unwinding in the lap of nature. In the lush and lavish garden while still well within the confines of Shiv Vivanta. Being close to home, yet still frolic within such a calming place is an unfathomably joyous experience.

- LANDSCAPED GARDEN
- ELEGANT CLUB-HOUSE
- INDOOR GAME ZONE
- WELL EQUIPPED GYMNASIUM
- SENIOR CITIZEN SIT-OUT AREA
- CHILDREN PLAY AREA
- LIBRARY
- BOX CRICKET



SPECIFICATIONS



■ STRUCTURE

- Earthquake resistant R.C.C. frame structure with A.A.C block walls.



■ FLOORING

- Vitrified flooring in living, dining, kitchen & all bedrooms.
- Anti-skid rustic floor tiles in balcony.



■ KITCHEN

- Mirror polished granite platform with Quartz Sink.
- Tile dado up to lintel level on wall above the kitchen platform.
- Storage space.



■ DOORS

- Main door laminated finish and other doors flush doors.
- Premium quality locks for all doors.



■ WINDOWS

- Anodized aluminum sliding windows with stone window jambs



■ BATHROOMS

- Anti-skid floor tiles for flooring.
- Tile dado up to lintel level.
- European type w/c pan in all bathrooms.
- Branded sanitary ware & C.P. fittings.
- Water proofing in all bathrooms.
- Rigid PVC pipes for drainage & plumbing.



■ ELECTRIFICATION

- TV point in drawing room & A.C. points in all bedrooms.
- ISI copper concealed wiring & branded modular switches.



■ COLOUR & WALL FINISH

- Internal all : Single mala plaster with putty.
- External wall : Double coat plaster texture finish with acrylic paint.



- 24 hours water supply from tube well & AMC



- Two elevators for Each building



- PNG pipe line to every units



- Centrally fitted DTH Connection







GROUND FLOOR PLAN

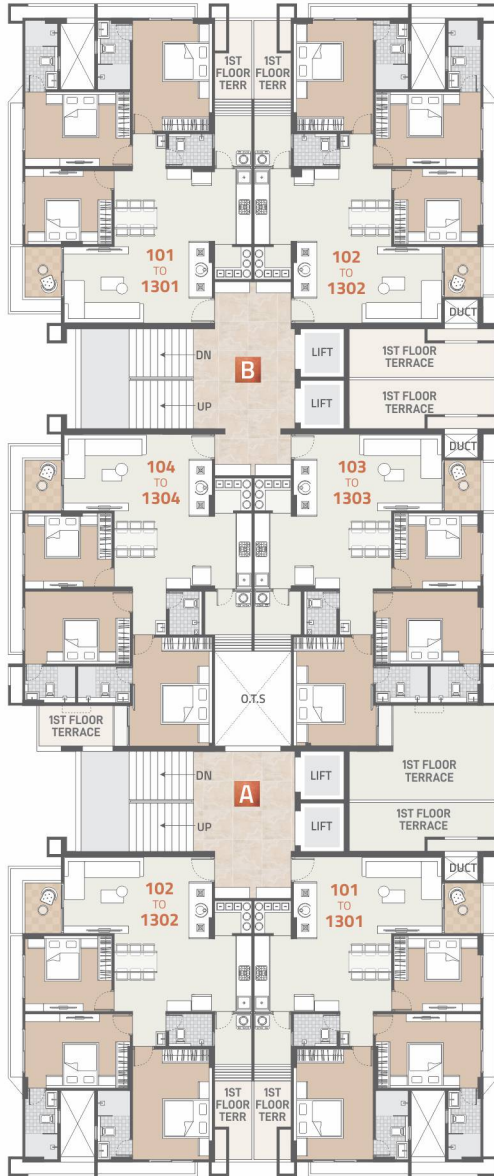

 **TYPICAL**
FLOOR PLAN



 **14th FLOOR**
PENTHOUSE PLAN



COME HOME AND BE AMAZED...

Arrival at Shiv Vivanta ushers a sense of entering to whole new set of emotions.

A foyer that is well-designed, beautifully maintained and with delicately designed interiors. The arrival embarks with your entry to the foyer area enwrapped with a warm embrace of tranquility.

- ATTRACTIVE MAIN ENTRY GATE
- SECURITY CABIN
- 24 X 7 CCTV SURVEILLANCE
- 2 LIFTS IN EACH BLOCK
- A-BLOCK - ONLY TWO UNITS IN EACH FLOOR
- NATURAL LIGHT & AIR WITH 100% PRIVACY
- PARKING AT GROUND WITH 2 BASEMENT
- EV CHARGING POINT





3 BHK
UNIT FLOOR PLAN



BLOCK A & B
UNIT NO. 101 TO 1301,
102 TO 1302





3 BHK
UNIT FLOOR PLAN



BLOCK B
UNIT NO. 103 TO 1303,
104 TO 1304





BLOCK A

BLOCK B

UNIT NO. 1402

UNIT NO. 1401

PENTHOUSE

UNIT FLOOR PLAN



BLOCK B

UNIT NO. 1404