







Pearl | 78

Pearl|78



# Amenities

-  GOOD QUALITY LIFT
-  DECORATIVE FOYER
-  SENIOR CITIZEN SITTINGS
-  FIRE SAFETY
-  INTERNAL PAVED AREA
-  SECURITY





**A**  
BLOCK



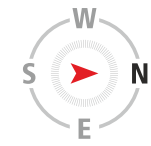
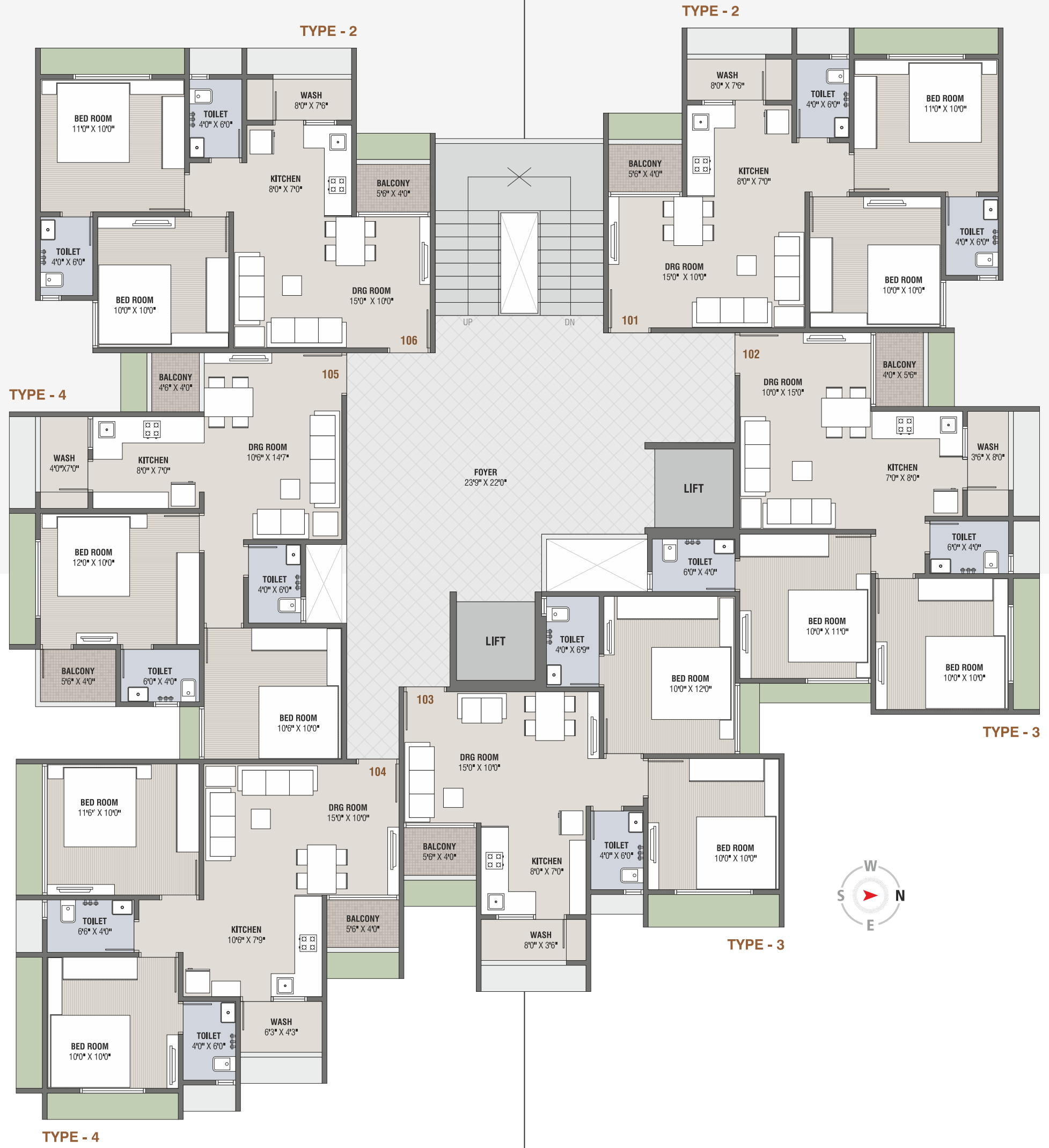

**B**  
BLOCK

# Specification

## Structure

Earth quake resistance AAC sand base block & Masonry wall.

## Wall finish

Internal single coat plaster with white putty & External double coat plaster with Texture and acrylic paint.

## Kitchen

Granite top platform with S.S. sink & designer tiles dado up to lintel level.

## Flooring

Good quality tiles in entire flat.  
China mosaic in terrace for heat reflection.

## Electrification

Single phase Concealed copper wiring with modular switches & MCB with sufficient electric points.

## Doors & Windows

Decorative main door with wooden frame, all other doors are flush doors.  
Powder coated aluminium section sliding windows with plain glass & stone sill.

## Toilet & Plumbing

Glazed tiles on flooring & dado up to lintel level. Concealed plumbing with good quality sanitary ware & C.P. fittings.



NOTES ■ All rights are reserved to Developer for any changes in plan & specification. ■ Irregular payment shall cause cancellation of booking. ■ GEB, AUDA, Stamp duty, Legal charges, GST, Other Tax, Labourcess & Initial maintenance contribution will be levied extra. ■ Any additional liabilities due to change in the by laws, Stamp duty, Govt. Laws, shall be borne by member. ■ Change in external elevation shall not be permitted. Internal changes shall be done only with prior permission & shall be charged extra in advance. ■ Details & dimensions in brochure are indicative & for the tentative representation only which should not be treated as legal documents. ■ Possession of the unit shall be given only after full payment.



# Pearl 78

DEVELOPER

**PANNA & SONS**

BOOKING CONTACT

**MO : + 91 97378 55527**

**MO : + 91 97378 55524**

DESIGN BY

**RAJESH DARJI**

STRUCTURAL ENGINEER

**KANHAI ENGINEERS**

SITE ADDRESS

**PEARL 78**

BH. ASHRAY PLATINA, SATATYA AVENUE ROAD,  
NEW RANIP, AHMEDABAD.

RERA - PROJECT REGISTRATION NUMBER :

PR / GJ / AHMEDABAD / AHMEDABAD CITY / AUDA / RAA10346 / 220622

Website : [www.gujrera.gujarat.gov.in](http://www.gujrera.gujarat.gov.in)

