



**GOLDEN
PLAZA**

SHOWROOMS | SHOPS | OFFICES



DESIGN TO REFLECT
THE SINGLE MOST

IMPORTANT IMPERATIVE OF BUSINESS GROWTH

Located in the heart of Gandhinagar South, Golden Plaza boasts of a location that is considered one of Gandhinagar-Ahmedabad's most upcoming business districts. This 6 Storey Business Hub brings you spacious office spaces ranging in size from 700 to 3000 square feet onwards. Add to that its grand entrance, high speed elevators and flexible floor space, and you have everything you need for your business to succeed and grow.

DESIGN TO REFLECT
THE SINGLE MOST







GROUND FLOOR PLAN





FIRST FLOOR PLAN



100'0" FEET WIDE T.P. ROAD



SECOND FLOOR PLAN



100'0" FEET WIDE T.P. ROAD



THIRD FLOOR PLAN



100'0" FEET WIDE T.P. ROAD



FOURTH FLOOR PLAN



100'0" FEET WIDE T.P. ROAD



FIFTH FLOOR PLAN





BASEMENT PLAN

1ST & 2ND

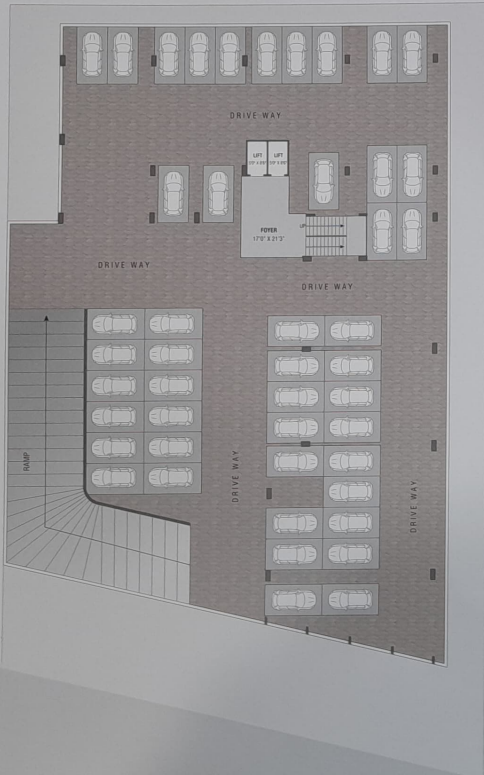



S U R R O U N D I N G S

 THE METRO
MINUTES AWAY

 THE AIRPORT
10 MINUTES AWAY

 GIFT CITY
6 MINUTES AWAY

A M E N I T I E S

 Attach Toilets

 Wide Parking Space

 Security Gates

 CCTV Camera

 Street Lights

 Commit Green Space & Rest Area

 Unique Architecture

 Branded Elevators

KEY PLAN



SPECIFICATION



Structure

- Earthquake Resistant RCC Frame Structure Building



Flooring

- 600x600 mm Vitrified Tiles in all Shops and Common Passages



Walls

- Internal smooth plaster with wall putty and external
- Double coat plaster with premium quality exterior paint



Elevator

- 2 Lifts for convenient
- Provision for hospital stretcher Lift



Doors & Windows

- Fully glazed aluminum window in offices and rolling shutters for Shops



Plumbing

- CPVC/UPVC piping with branded plumbing and sanitary fixtures



Electrification

- ISI branded concealed copper wiring with good quality accessories





**GOLDEN
PLAZA**

Site Address: "Golden Plaza",
Opp. Sant vihar-2, Near Sarthak Ganesh Flats,
K Raheja Road, Koba, Gandhinagar.

Developers:
Gopnath Developers Pvt. Ltd.
Gandhinagar



Architect:
Arcline Architects,
Ahmedabad



Structure:
Arise Structure Design
Ahmedabad.

Booking Contact
+91 98244 06038
+91 91063 54404

Terms & Conditions: - GST and other government charges levied from time to time shall be borne by the purchaser. - Stamp duty, registration fees and maintenance charges shall be borne by the purchaser on actual basis. - Any taxes and duties that will be levied by any government or any appropriate authority body in the future shall be borne by the purchaser. - All the images in this brochure are an artist's imagination and are solely used for purpose of presentation. - In the interest of continuous development in design and quality of construction the developers reserve all the rights to make any changes in the entire scheme or part of the scheme including specification, design, planning, layout and purchaser shall abide by such changes. - In order to maintain the aesthetics of the building, installation of AC outdoor units will be permitted at designated spots and nowhere else. - Purchaser are strictly not permitted to make any changes or alterations of any nature in the elevation, exterior color of the building, overall design, concept and outlook of the entire scheme during or after completion of scheme. - Structural and patch work changes are strictly not allowed. - Encroachment, in any form outside the defined units will not be allowed. - This brochure is only to convey the essential design, display and technical features of the scheme and is not part of any legal document. - In case the purchaser cancels the booking, he will get back the paid amount only when the registered unit gets resold after deduction of 10% of the total value.

RERA NO. : Coming Soon...