



DEVELOPERS :
ANANTA
REALTY

CONTACT : +91 87805 71402, +91 87805 75751

SITE ADDRESS : Nr. Vaidehi Shine, Vavol - Uvarsad Bypass Road,
Vavol, Gandhinagar - 382016.

GROWING TODAY FOR A BETTER TOMORROW

THIS IS HOW A SPIRITUAL LIVING LOOKS LIKE



WONDERFUL

THESE 3 & 2 BHK
RESIDENCE HAS
EVERYTHING THAT YOU
WISHED FOR IN A DREAM HOME



SOULFUL

THE GREEN
LANDSCAPE LETS YOU
EMBRACE THE SERENE
SHADES OF NATURE

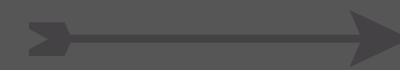
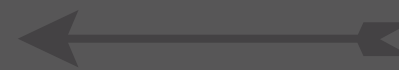

ELITE CLUBHOUSE
WITH MODERN
LIFESTYLE AMENITIES
MAKE LIVING HERE
A DELIGHTFUL AFFAIR



JOYFUL

A WELL CONNECTED
LOCATION THAT PUTS
YOU IN THE CENTER OF
EVERYTHING YOU NEED
AND DESIRE.



THOUGHTFUL

A SKY FULL OF LIFE

When the life below encompasses you with routine and normalcy, we welcome you to something fresh, something blue and something utterly divine - the sky!

Where everyday is a good day to taste a little of the clouds, to feel a gush of the winds and hear the chirping of the birds.

Do not make sky the limit, make sky your home.

RESIDENTIAL BUILDING SPECIFICATION

7 Stories Structure

Residential Total Unit : 168

Landscaped Garden

Attractive Club House

Well Equipped Gymnastic

ARIZONA
SKY
3 & 2 BHK LIVING SPACE & SHOPS





**MAKE ARIZONA SKY
YOUR HOME;
AND LIVE HAPPILY
EVER AFTER**

ARIZONA
3 & 2 BHK LIVING SPACE & SHOPS **SKY**



GRAND
ENTRANCE



SECURITY
AT GATE



CCVV
CAMERA

WONDERFUL

At ARIZONA SKY, get used to more. More luxuries, More air and light; More greenery; More amenities; This thoughtfully planned project offers you more of everything than you expect.





SPECIOUS
FOYER AREA



CHILDREN
PLAY AREA



ATTRACTIVE
GARDEN



INDOOR
GAME AREA



TODDLER
PLAY AREA



SENIOR CITIZEN
SEATING AREA

SOULFUL

Here, Nature is an Integral Part of Your Life.
At ARIZONA SKY, we have exquisitely combined nature into your day to day living Wherever
you look tranquil greenery prevails. It's your peaceful arizona sky the chaos of the town.





WELL EQUIPMENT
GYMNASIUM

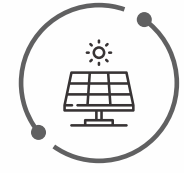

SOLAR
ROOF TOP



FIRE
SAFETY

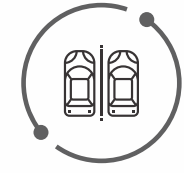

BASEMENT
PARKING



YOGA
SPACE



LIFTS
PER BLOCK

JOYFUL

The Fabulous Club House. Why go outside when you can enjoy plethora of lifestyle amenities here. The marvelous club house bestows you with so many recreation possibilities that living here becomes a delightful experience.



TYPICAL FLOOR LAYOUT

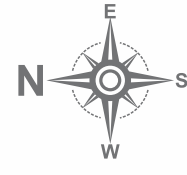

BASEMENT FLOOR LAYOUT

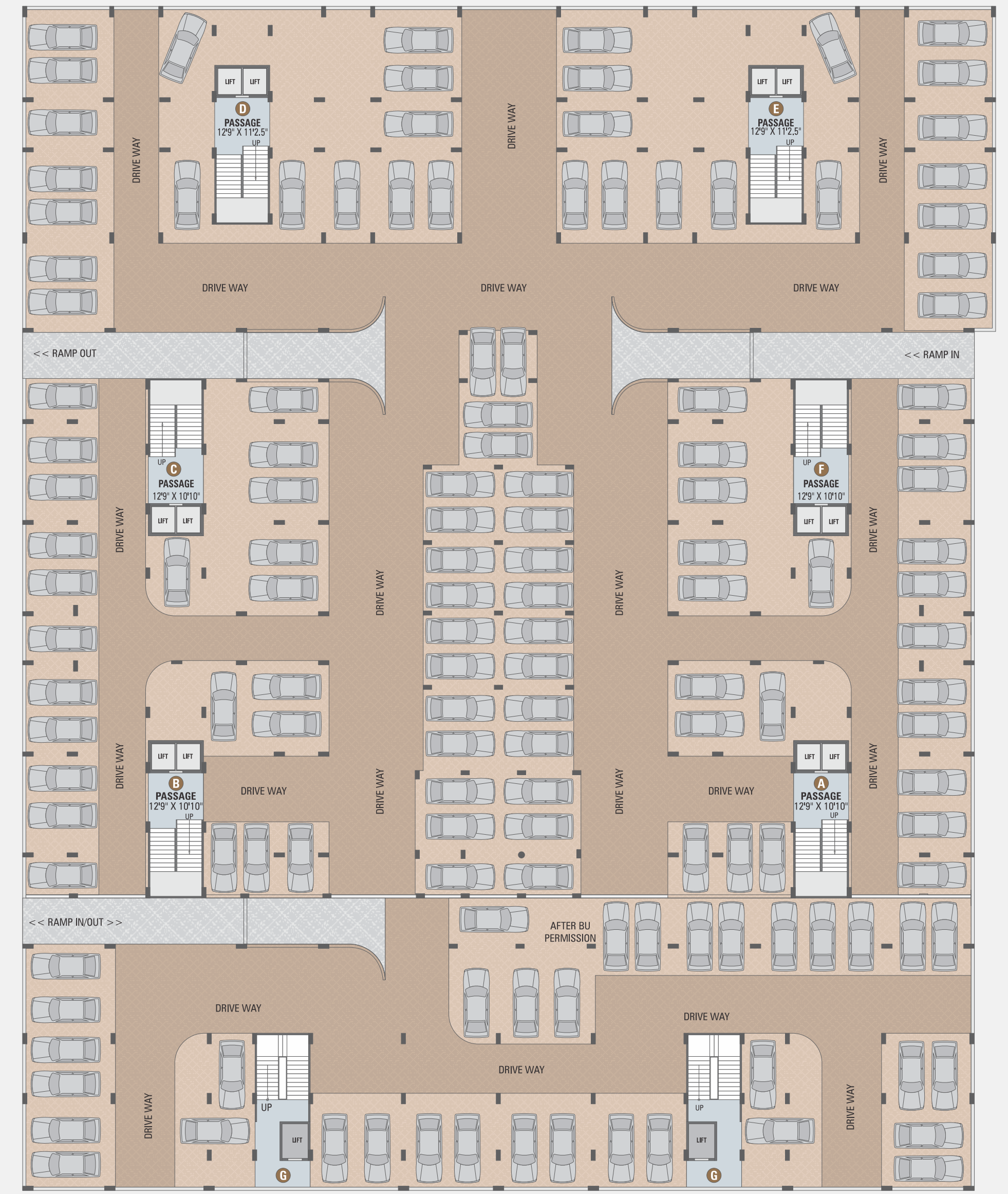



BLOCK A, B, C & F | UNIT PLAN
TYPE - A | 2 BHK

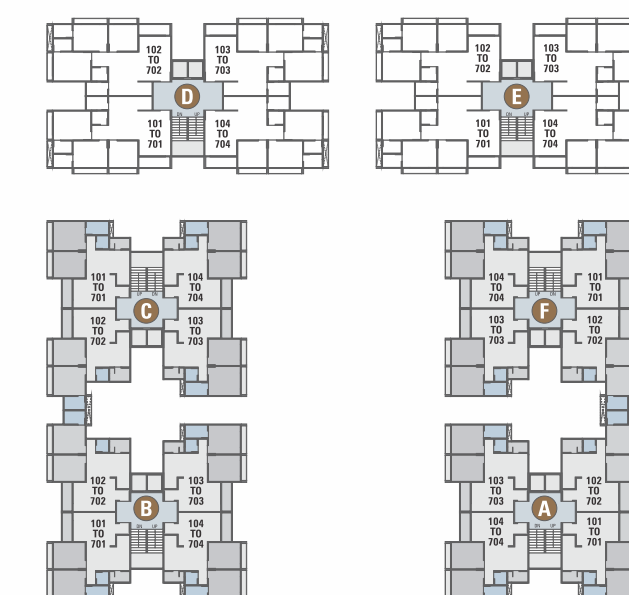

BLOCK D & E | UNIT PLAN
TYPE - B | 3 BHK

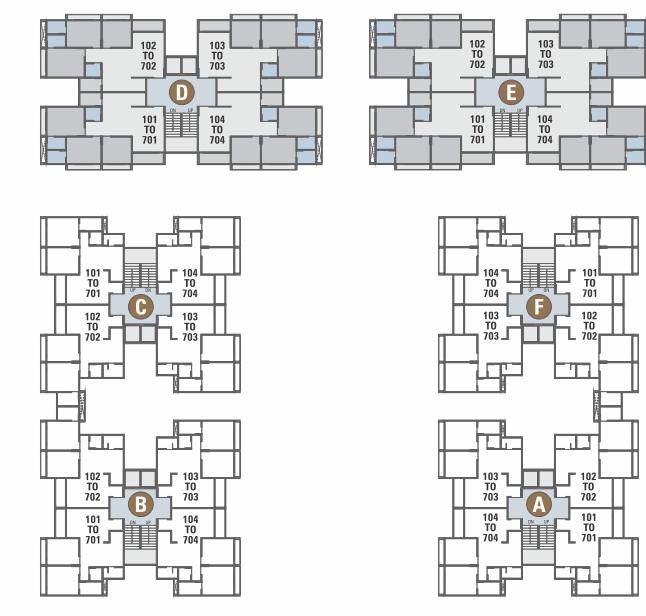

THIS IS HOW A SUCCESSFUL GROWING LOOKS LIKE



OPPORTUNITIES

WE ARE SITUATED IN THE MOST EMERGING AND DEVELOPING AREA AT VAVOL-GANDHINAGAR. FOR RETAILS, OFFICES, SHOWROOM, DINE & MULTIPURPOSE BUSINESS SPACE.



INNOVATION

A PUBLIC REALM BUZZING WITH EVENTS AND ACTIVITY DELIVERS A MEMORABLE EXPERIENCE FOR SHOPPERS AND MAXIMISES TRADING. WHATEVER THE RETAIL QUESTION, THERE IS AN ANSWER TO BE DISCOVERED.

SOMETHING DIFFERENT ON EVERY LEVEL

Offers a mix of lifestyle stores & brands for every age and aspiration. In today's every changing world spaces have become an spring for business ! With maximum display for businesses and a location that is unique Arizona Sky will have spaces that will cater to independent retailers to large national & international chains.

COMMERCIAL BUILDING SPECIFICATION

GROUND + 6 Storey Structure

Commercial Total Unit : 64

Ground, First & Second Floor : 50 Shops

Third to Six Floor : 14 Hall

ARIZONA
SKY
3 & 2 BHK LIVING SPACE & SHOPS





CORPORATE OFFICES



RETAILS SPACES



RESTAURANTS & CAFE



HOSPITALS & MEDICAL



BANK & ATM



EDUCATION INSTITUTIONAL

OPPORTUNITIES

Establish your business at the most prominent and posh location of Vavol - Gandhinagar. ARIZONA SKY is an epicenter of business and growth.





ATTRACTIVE ELEVATION



BASEMENT PARKING



STANDARD LIFT



24 X 7 WATER SUPPLY



FIRE SAFETY SYSTEM



MAIN ROAD TOUCH LOCATION

INNOVATION

The East Gate is Commercial project comprising of shops and offices encompassing the entire initiative. ARIZONA SKY marked for its innovation and quality of construction.



COMMERCIAL

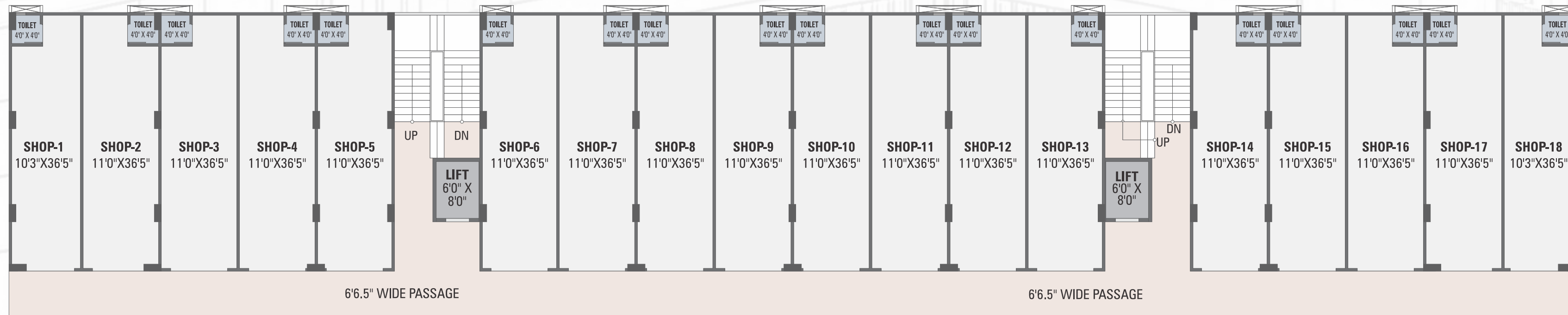

COMMERCIAL
GROUND FLOOR

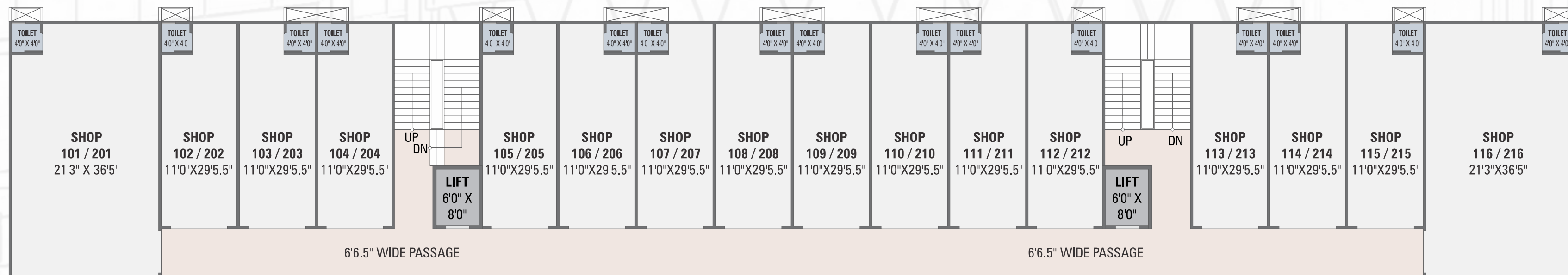

COMMERCIAL
FIRST & SECOND FLOOR

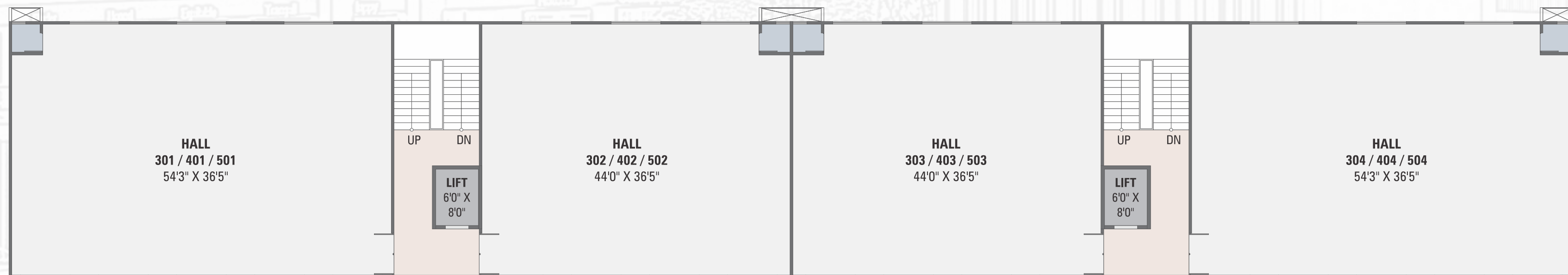

COMMERCIAL
THIRD, FOURTH &
FIFTH FLOOR

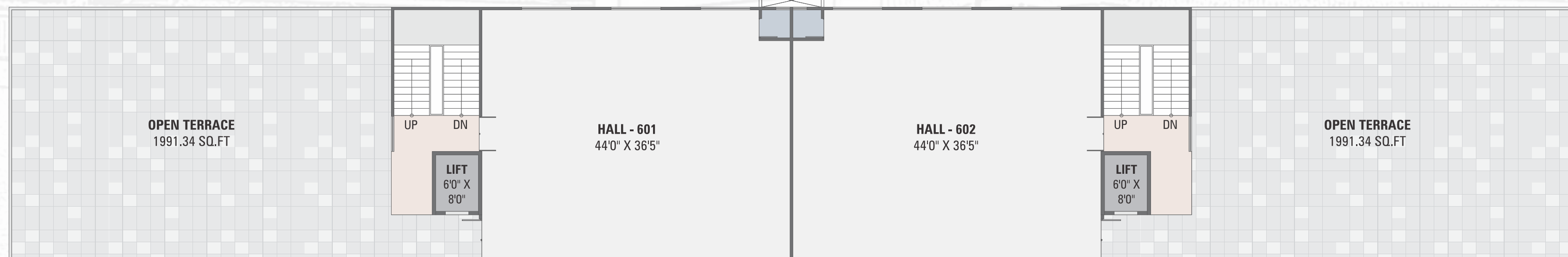

COMMERCIAL
SIXTH FLOOR

RESIDENTIAL

- STRUCTURE** : Earthquake resistant R.C.C. frame structure as per new by laws.
- FLOORING** : Vitrified tiles for entire flooring in all apartments & balcony wooden tiles.
- WALL FINISH** : Internal mala plaster with white finish putty. Attractive external elevation with double coat sand face plaster with 100% acrylic paints
- DOORS & WINDOWS** : Decorative main door & other flush doors with wooden / granite frame. All windows in aluminum section with granite frame.
- KITCHEN** : Mirror polished granite platform with S.S. sink, designer glazed tiles up to lintel level.
- ELECTRIFICATION** : Branded ISI modular switches with concealed copper wiring and adequate number of points. MCB distribution panel.
- FIRE SAFETY** : Fire Safety System Facilities
- PLUMBING** : ISI CPVC and UPVC pipes for water supply, PVC & SWR pipes for solid waste and drainage systems. Percolation recharge wells as per norms.
- TOILET** : Designer tiles on floor and walls up to lintel level. Branded sanitary ware & bath fittings.
- TERRACE** : Brick-bat concrete with china mosaic for heat reflection and thermal insulation.



COMMERCIAL

- STRUCTURE** : Earthquake resistant structural design for R.C.C. framed Structure.
- PLASTER** : Double Coat Of Sand Mala with Textured Finishing Outside. Single Coat of Mala Plaster Inside.
- FLOORING** : Premium Quality Vitrified Tiles.
- WINDOW** : Powder coated Aluminum sliding windows with glass finishing.
- WASHROOM** : Premium Tiles Up To Lintel Level & Quality Sanitary Ware.
- PLUMBING** : Center Point Plumbing With Adequate Points & Good Quality C.P. Fittings.
- ELEVATORS** : Branded high standard stature size automatic lifts with optimum capacity.
- ELECTRIFICATION** : Exclusive modular switches in all offices & shops. ISI copper wiring.
- FIRE SAFETY** : Fire hydrant in all Building.
- PARKING** : Ample parking at double basement floors with well-designed parking layout. Suitable paving for parking areas.
- TERRACE** : China mosaic over waterproof coat on thick bat concrete for thermal insulation.



NOTE : • Commencement and timely execution of the project is subject to all necessary approvals from relevant govt. authorities, occurrence of natural calamities or any other external beyond developer's control. • The dimensions shown in the brochure are approximate. • The developer reserves the right to change, revise or make any modification, addition, omission or alteration in the scheme as a whole or part thereof, at their sole discretion. • The brochure is only for illustration & private circulation purpose & is not a legal document or a binding one. • Government levies like stamp duty, registration charges, legal charges, GST and any other additional charges are to be borne by the member. • Subject to Ahmedabad / Gandhinagar Jurisdiction. • Payments in favour of "ANANTA REALTY"

Developers : 	Architect :  9805060576 / 9879590576 Ahmedabad.	Structural & MEP  Ahmedabad.	Scan for Location 
---	---	--	--

THOUGHTFUL

EVERYTHING YOU NEED IS JUST AROUND THE CORNER

- HOTEL LELLA & RLY. STATION - 05 MINUTES
- UVARSAD DENTAL COLLEGE - 10 MINUTES
- GIFT CITY - 15 MINUTES
- MAHATMA MANDIR - 05 MINUTES
- SARGASAN CROSS ROAD - 10 MINUTES
- EDUCATION CENTRE - 05 MINUTES
- ADALAJ TRI MANDIR - 10 MINUTES
- D-MART MALL - 10 MINUTES

SITE ADDRESS :
 Nr. Vaidehi Shine, Vavol - Uvarsad Bypass RCC Road, Vavol, Gandhinagar - 382016.

CONTACT :
+91 87805 71402, 87805 75751

ARIZONA SKY

3 & 2 BHK LIVING SPACE & SHOPS

