

KOTWAL BUSINESS ZONE

INVEST IN YOUR BUSINESS



Relocate your business on the express route to success.



Located in the Heart of Somatne, Kotwal Business Zone is a premium shopping destination and convenience centre in Somatne. Be part of Somatne's Big Growth Story and grow your business.



ARTIST'S IMPRESSION



ARTIST'S IMPRESSION

Premium Retail Spaces

2 Buildings of premium retail spaces in the commercial hub of Somatne

1772 sq Mtr of Retail Spaces

- Ground Floor

Total Retail Space – 886 sq mt

- First Floor

Total Retail Space – 886 sq mt

Retail Specifications

- Floor to Floor height: 11'0 ft
- 100% power back up for common area
- Fire Hydrant and tap off point for sprinklers

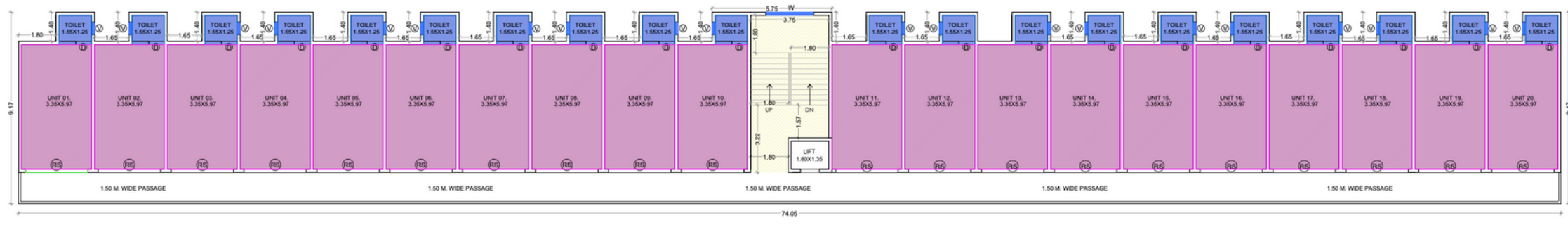



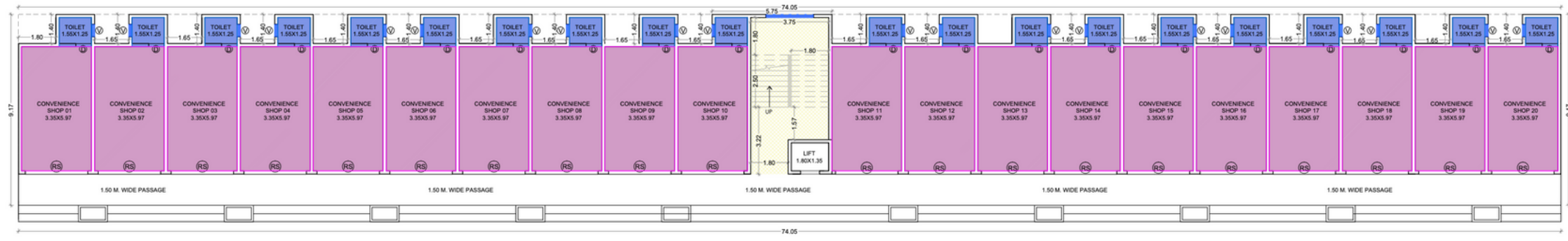







FIRST FLOOR PLAN (BUILDING A & B)

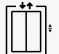

GROUND FLOOR PLAN (BUILDING A & B)

PLAN. VISION. GOAL.

AMENITIES

-  Private toilet for every shop
-  Allotted car park
-  Lift
-  24/7 CCTV for common areas
-  Security cabin
-  24/7 Generator back up for common areas
-  Individual water connection
-  Sewage treatment plant
-  Street lighting
-  Wheel chair access

FEATURES FOR COMMERCIAL

MODERN DESIGN WITH
SPACIOUS SHOPS &
UNITS
ROAD FRONT SHOPS &
UNITS

LANDSCAPING &
PLANTATION BEDS
SHOPS & UNITS WITH
LOCK & KEY



SUITABLE FOR ALL BUSINESS



Grocery store



Electronic store



Gym



Doctor clinic



Clothing store



Medical store



Jewellery store



Cafes



Banks



Furniture store



Hardware store



Restaurants



Vishhram Developers was founded in 2005 with a single mission: to build structures with enduring value and the potential to become timeless. Our team of creative professionals carefully evaluate each project in order to adhere to both financial and time constraints, and over the years we've become known as a top Real Estate Developer in an around Pune. With years of experience in projects large and small since 2005, we have the expertise and the desire to help you succeed.

OUR VISION

To constantly strive to set ever higher standards in every aspect of our business from construction quality to our systems, equipment and most of all our human assets. We aim to establish an ethos that seeks to identify and maximize potential through innovative use of land and technology, in harmony with our nature and with respect for our social responsibility.



Easy Connectivity

- Talegaon
- Hinjewadi
- PCMC
- Baner
- Balewadi
- Pune – Mumbai Expressway



SITE ADDRESS - SOMATANE-SHIRGAON ROAD, TALUKA-MAVAL,
DIST.OPPOSITE DAFFODILS PUNE - 410506

SALES@VISHHRAM.COM | WWW.VISHHRAM.COM

OFFICE ADDRESS - OFFICE NO. 101, PLOT NO. 67, ASHOK SANKUL-II, ASHOK NAGAR, RANGE HILL
ROAD, MAHARASHTRA, PUNE - 411007



BUILDING A



MAHARERA No.
<https://maharera.mahaonline.gov.in>

P52100054072



BUILDING B



MAHARERA No.
<https://maharera.mahaonline.gov.in>

P52100054076

