

Are you ready

to be captivated by an upcoming marvel

A project comprising
super luxury suites
transcending all your
expectations!

This is not merely a development;
it is an **opulent masterpiece**,
a sanctuary of **extravagance** set against
the backdrop of **our flagship golf development**

Are you ready

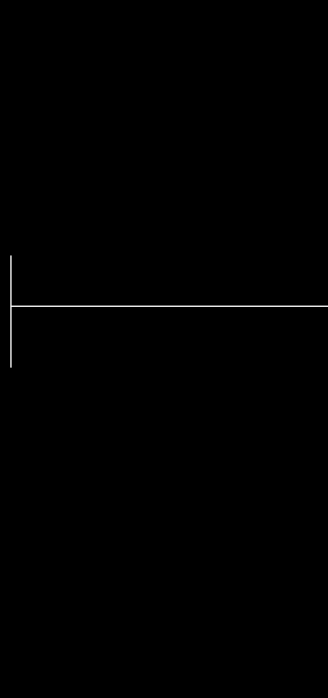

For the City's Big Reveal ?

PRESENTING

M3M

ALTITUDE

— AT **golfestate** —

LUXURY SUITES (4.5 BHK+S) & SKYLINE PENTSUITES

PROJECT NAME/ RATIONALE

CORE THOUGHT BEHIND NAME OF THE PROJECT: M3M Altitude encapsulates the essence of luxury, elegance, and aspiration. Through this name, we aim to convey the unparalleled living experiences and prestige that define this exclusive enclave.

M3M Altitude is not just a name; it's a promise of elevated living at its finest!

M3M ALTITUDE

M3M ALTITUDE is not merely a name; it's a *symbol of aspiration and distinction*. As we embark on the journey of creating a super luxury real estate project, the choice of name plays a pivotal role in conveying the essence and promise of the development. M3M Altitude embodies the ethos of *unparalleled luxury, elevated living experiences, and the pinnacle of sophistication*.

1

ELEVATED LIFESTYLE

M3M Altitude signifies living at the peak of luxury, where every aspect of life is elevated to new heights. *It evokes a sense of exclusivity and prestige, reflecting the extraordinary lifestyle that awaits residents within the project.*

2

PRESTIGE & DISTINCTION

M3M Altitude exudes an *aura of prestige and distinction*, appealing to discerning individuals who seek nothing but the best. It sets the project apart as a *beacon of luxury and sophistication*, attracting affluent buyers who value exclusivity and opulence.

3

ASPIRATIONAL APPEAL

The name resonates with the aspirations of individuals who aspire to reach new heights of success and luxury. It inspires potential buyers to envision themselves *living a life of grandeur and sophistication*.

TIME IS ON YOUR SIDE

THE CONCEPT

MORNING

At **M3M ALTITUDE**, mornings are effortless.

The app-based valet service lets you efficiently order your car to be detailed, fuelled or simply brought to the porte cochère before you reach the front door.

A light continental breakfast and daily newspapers are available in the lounge.

MIDDAY

At **M3M ALTITUDE**, the Wellness and Performance Concierge creates the perfect plan for your unique health and fitness goals. Private trainers, classes led by expert instructors or lessons with a tennis pro on the outdoor court are among the many possibilities offered right at your doorstep.

AFTERNOONS

At **M3M ALTITUDE**, The butler service for deliveries and dry cleaning and technical assistance for digital device management are just one text away.

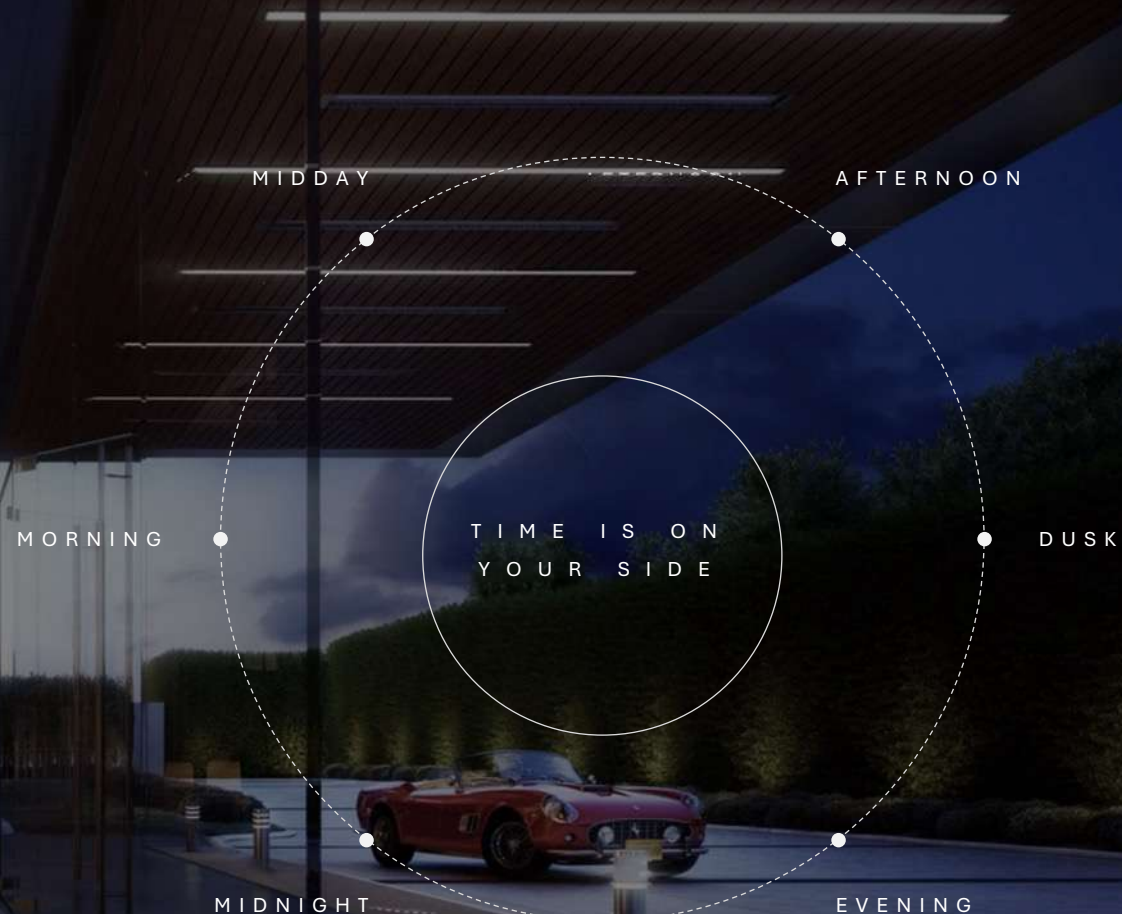

EVENINGS

At **M3M ALTITUDE**, the perfect place to unwind is just an elevator ride away with a spa treatment room, steam rooms, and saunas.

DUSK

Whether a candlelit setting on the terrace or a corporate dinner in the Private Dining Room, at **M3M ALTITUDE**, organizing your next party is our Lifestyle Concierge's pleasure.

MIDNIGHT

Comfortably resting in your residence, you enjoy a nightcap while looking out over the glittering lights of city's downtown



DESIGN THOUGHT & INSPIRATION

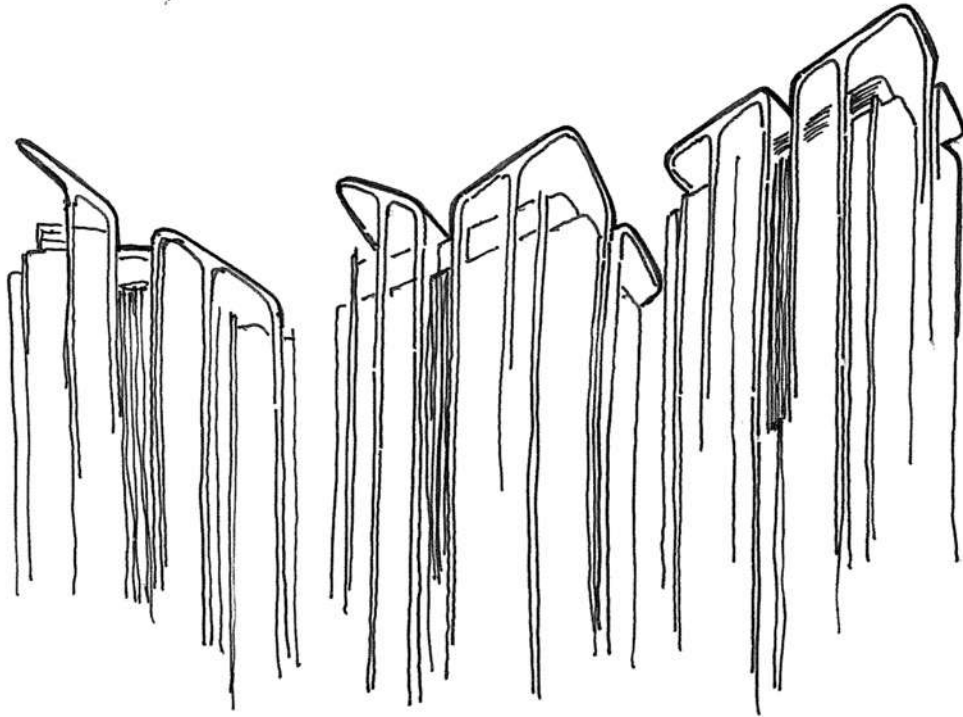

The facade design draws inspiration from the **graceful cascading movement of waterfalls**. It elegantly mirrors the descent of water over a steep drop, employing white ribbons to delineate the journey from the cascading point to the base.

This design element accentuates the fluidity and movement, while louvers and mesh screens further amplify the verticality and dynamic essence of tumbling water, resulting in a **visually captivating representation of nature's beauty**.

MASTERCRAFTSMEN



Jonas Upton-Hansen
Founding Director



© Ricardo Mateu
Director



Founded in London in 2011, **UHA** is a London based architecture design firm with 7 global offices across 6 time zones.

UHA London is one of the most awarded architecture design firm.



UHA on the Big Screen

Oscar-nominated film *The White Tiger* starred four of UHA's Delhi-based projects.

M3M Latitude and M3M St Andrews feature repeatedly alongside M3M Tee Point and M3M Urbana Premium in the Netflix Original.



Sadro Residencias
Puebla, Mexico



Qingdao Waterfront
Qingdao, China



Al Fujairah
Dubai, UAE



Infinity Towers
Limassol, Cyprus

MASTERPLAN ARCHITECT



PRINCIPAL ARCHITECT
GYAN PRAKASH MATHUR



GPM – Architects & Planners is India’s leading architecture and design firm providing comprehensive services across architecture, engineering and project management.

GPM Architects & Planners has completed four decades of its ongoing efforts to rethink and revitalise urban India through its work – 40 years of making ‘Progress a Process’.

LANDSCAPE ARCHITECT



ORACLES LANDSCAPE is India’s leading landscape design studio with an extensive experience in conceptualizing and delivering projects in the domains of residential, hospitality, business, commerce, culture, transportation and the public realm.

M3M LATITUDE

CYBERCITY

MAHENDRA
LUMINAIRE

BAY ISLAND RESORT
PORT BLAIR

AEROCITY,
NEW DELHI

EMAAR DIGI
HOMES

HYATT
JAISALMER

MUMBAI INTL.
CRUISE TERMINAL

DLF CREST

DLF
MAGNOLIAS

M3M
GOLFESTATE

DLF GOLF CLUB

DESIGN THOUGHT AND APPROACH

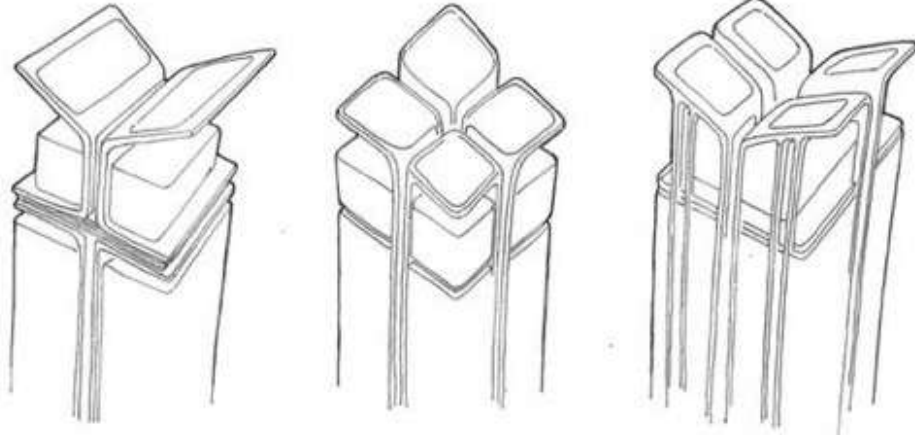

DELIVERED:
M3M LATITUDE

DELIVERED :
M3M ST. ANDREWS

LAUNCHING:
M3M ALTITUDE

The iconic M3M St. Andrews then M3M Latitude and now **prepare yourself to be awe-struck** by the epitome of luxury living.

We are excited to introduce our newest project – M3M ALTITUDE, marking the completion of a **trilogy of iconic structures** that will grace the skyline of Gurugram as **epitomes of luxury living**.

A TRINITY OF 'ICONS'!

The crowning features of these towers serve as unmistakable landmarks, showcasing **extraordinary architectural feats** and an irresistible charm.

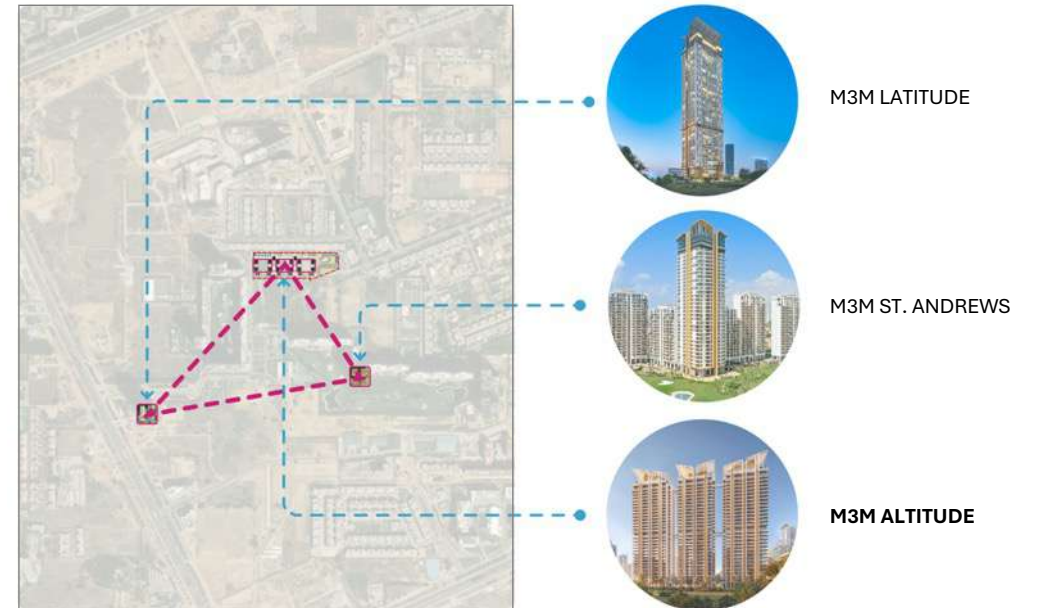

ICONIC LOCATION: SETTING THE STAGE FOR SUPER LUXURY ICON

This enclave is exquisitely situated right next to the Golf Course Road Extn., in the immediate proximity of iconic luxury projects such as **Trump Towers**, **M3M Golfestate** and the likes.

Additionally, prestigious international schools, haute couture boutiques, and gastronomic delights that define the epitome of cosmopolitan living are going to be in close setting.

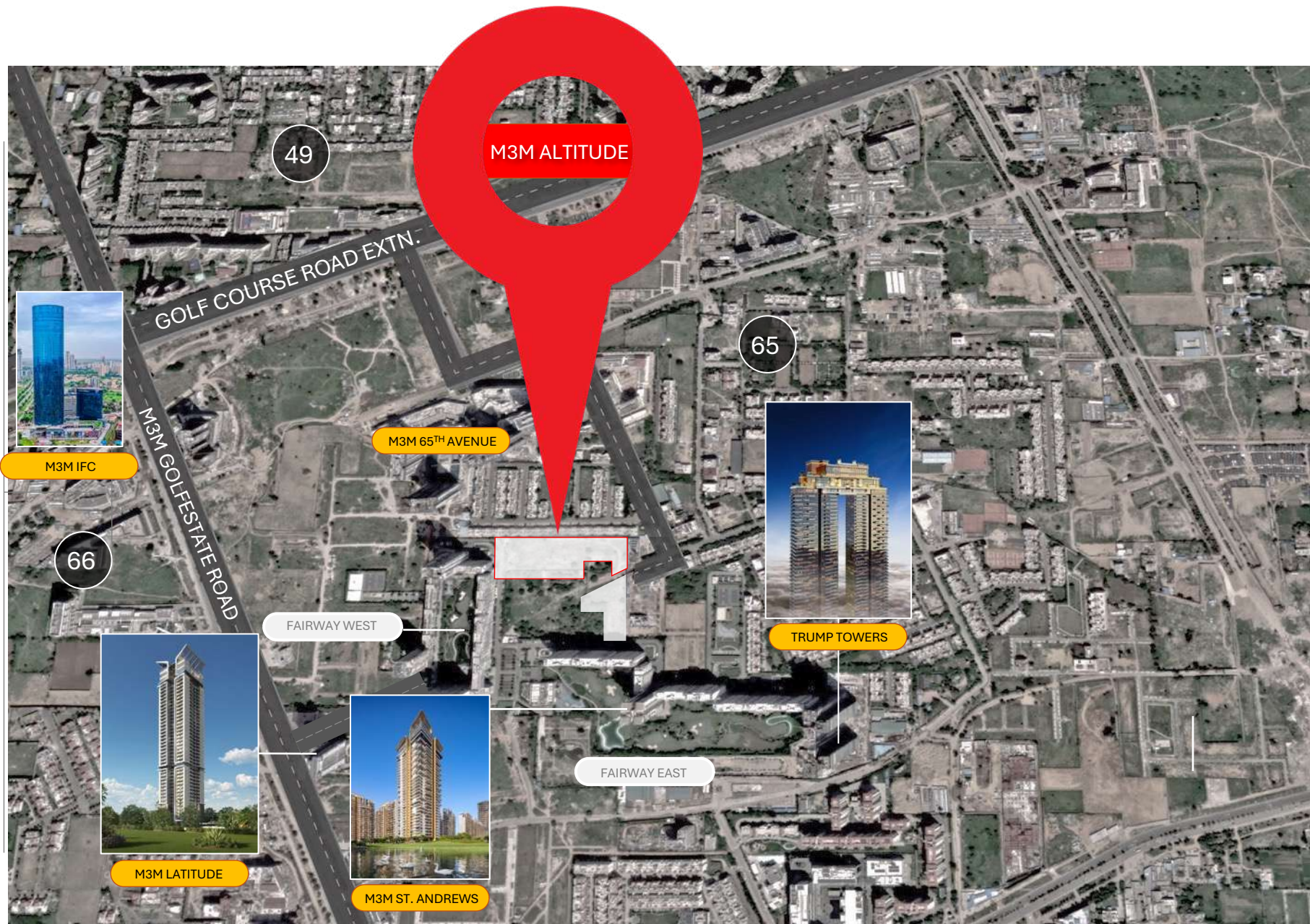

CRAFTING THE GENESIS OF THE ULTIMATE LUXURY ICON!

Consisting of three meticulously designed towers, this development embodies **opulence, refinement, and exclusivity**, providing discerning individuals with a **lifestyle unparalleled in its grandeur.**

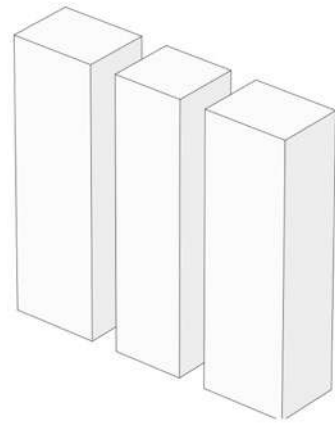

1

Basic massing

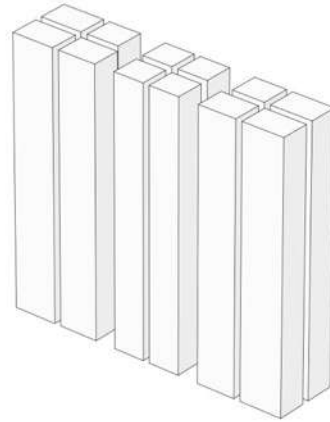

2

Break down the mass into slender vertical volumes

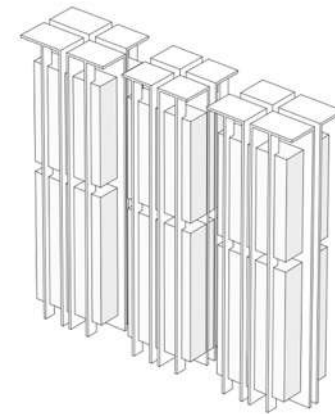

3

Express facade verticality

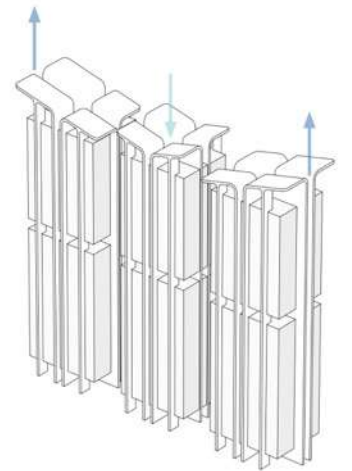

4

Create iconic architecture

TOWER FAÇADE CONCEPT

The suggested materials and **colour scheme are subtle**, combining bright white and dark gray highlighted by a **warm bronze tone**.

Vertical structures and crown details are finished in bright white to emphasize them, while windows and balcony frames are in **dark anthracite grey**.

The vertical aluminium louvers and the connections between the towers are all given a **reflective golden bronze coating**.



1 - Solid Surface (Type Krion)



2 - Glass balustrade



3 - Aluminum cladding with wood finish



4 - White render



5 - Aluminium louvers with bronze finish



6 - Expanded metal mesh, white finish

TOWER FACADE

NORTH ELEVATION

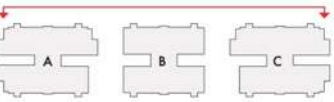

SOUTH ELEVATION

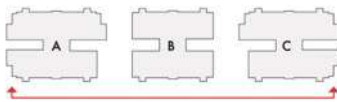

OPTIMIZING NATURAL LIGHT

Dive into the meticulous solar study unveiling the graceful dance of sunlight upon M3M Altitude's glorious towers, **illuminating every facet of their architectural brilliance.**

Explore how the strategic positioning of our structures harnesses the sun's movement to create **dynamic interplays of light and shade**, crafting an ambiance of unparalleled elegance.

Witness innovation and sustainability converge as our design seamlessly integrates with nature's rhythm, offering residents a **harmonious living experience bathed in natural radiance.**

Winter solstice - December 21

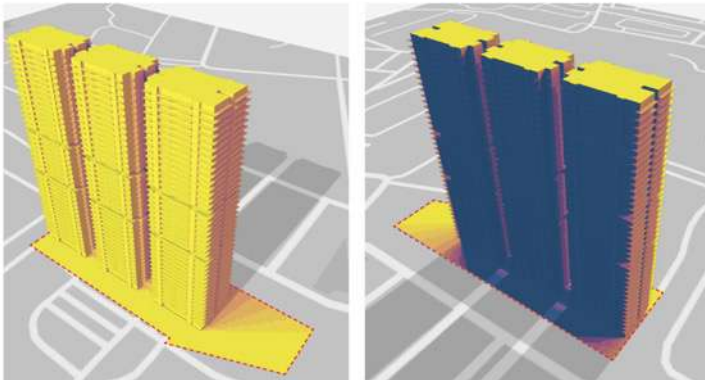

01 South East View

02 North West View

Autumn/ Spring Equinox - September 22/ March 20

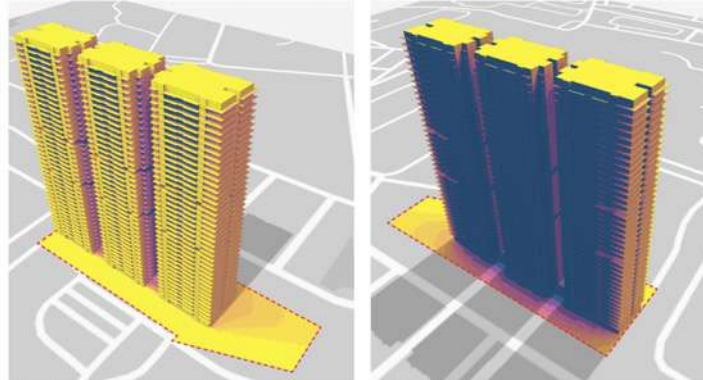

01 South East View

02 North West View

Summer solstice - June 21

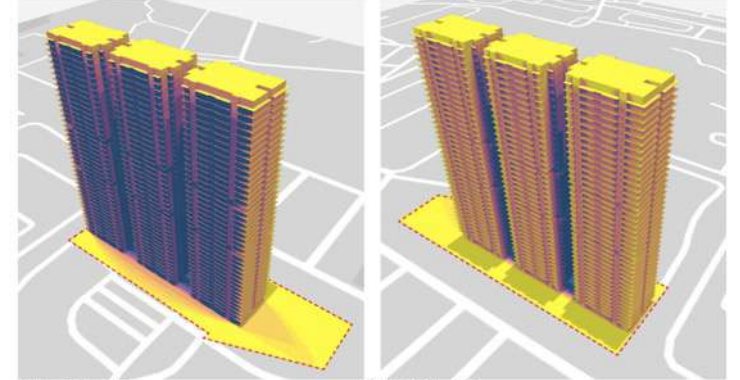

01 South East View

02 North West View

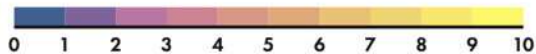

Sunlight hours / day

THE CROWN

A BEACON OF ELEGANCE AND AUTHORITY

Standing tall atop the tower, the crown **gleams with an aura of sophistication and power**, casting its majestic presence over the city below. Its intricate design, captivates all who behold it, symbolizing not just luxury, but also a **sense of regal authority**.



As the sun sets, the crown becomes a **beacon of elegance**, illuminating the skyline with its radiant glow, reminding all who gaze upon it of the timeless allure and strength embodied by **those who wear the crown**.





Towering Magnificence The Skyward Splendor!

Standing tall at approx. 140 mtrs and spread over 4 Acres, M3M Altitude is a **feat of modern engineering.**

A state-of-the-art combination of world class living habitat, **exceptional architecture, celebration of nature, and hotel-style services** makes it the ultimate urban resort.

ARRIVAL

A gracious driveway culminates at M3M Altitudes porte cochère.

In addition to doormen, butlers, and valet attendants, residents enjoy **luxury house car service with on-call private drivers.**



■ VEHICULAR DROP-OFFS AT BASEMENT LEVEL

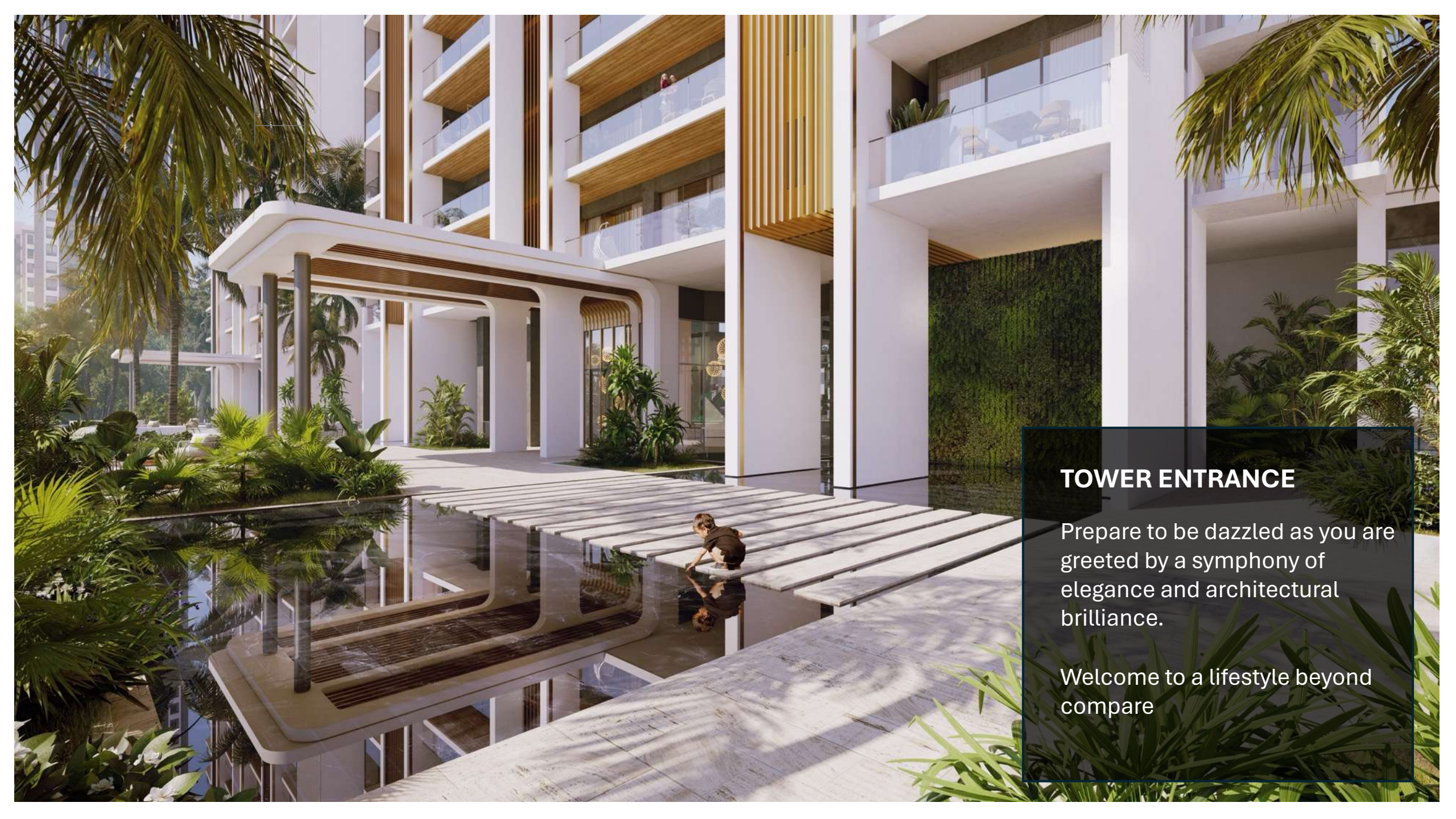

TOWER ENTRANCE

Prepare to be dazzled as you are greeted by a symphony of elegance and architectural brilliance.

Welcome to a lifestyle beyond compare

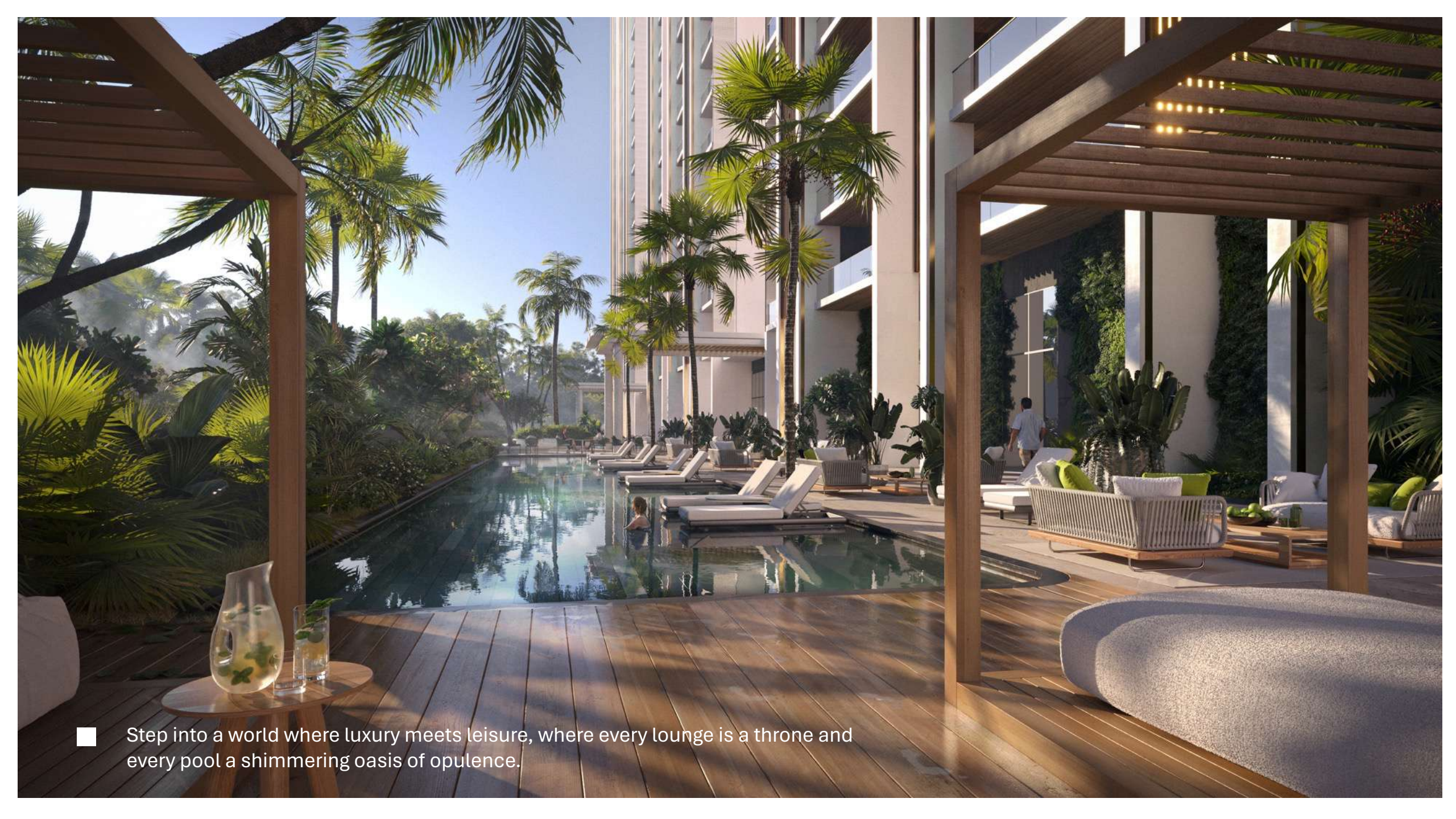

■ Step into a world where luxury meets leisure, where every lounge is a throne and every pool a shimmering oasis of opulence.

BEYOND IMAGINATION

A SPECTACULAR VIEW OF M3M ALTITUDE

Indulge in the epitome of sophistication with our unparalleled façade design, where every line, curve and detail exudes luxury and refinement.

All units get outdoor visual experience and well ventilated, also 4-to-a-core cluster gives corner units providing two-sided outdoor experience.



Observatory sky lobby and club on terraces are connected with sky-bridges.

The elegant façade design resides harmoniously with surrounding structures.

Are You Ready

for **The Largest AirClub of Delhi-NCR !**

The **AirClub**

The Crowning
Glory that Is Set
To Become The
Beacon Of
Luxury, Adorned
By A Waterfall
Design



~1,25,000 sft of luxury extravaganza !

A UNIQUE CONCEPT OF ZONING AND CONNECTIVITY

The club's program is distributed across the ground floor and the rooftop, capable of operating separately yet linked by elevators.

Programs within each tower are paired based on their nature: the Spa is linked with the Gym, the Family Zone with the Lagoon Restaurant, and the Business Club with both the bar and Executive Lounge.

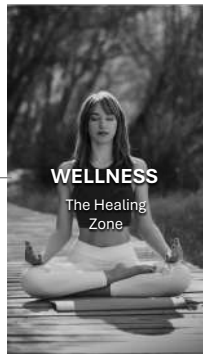
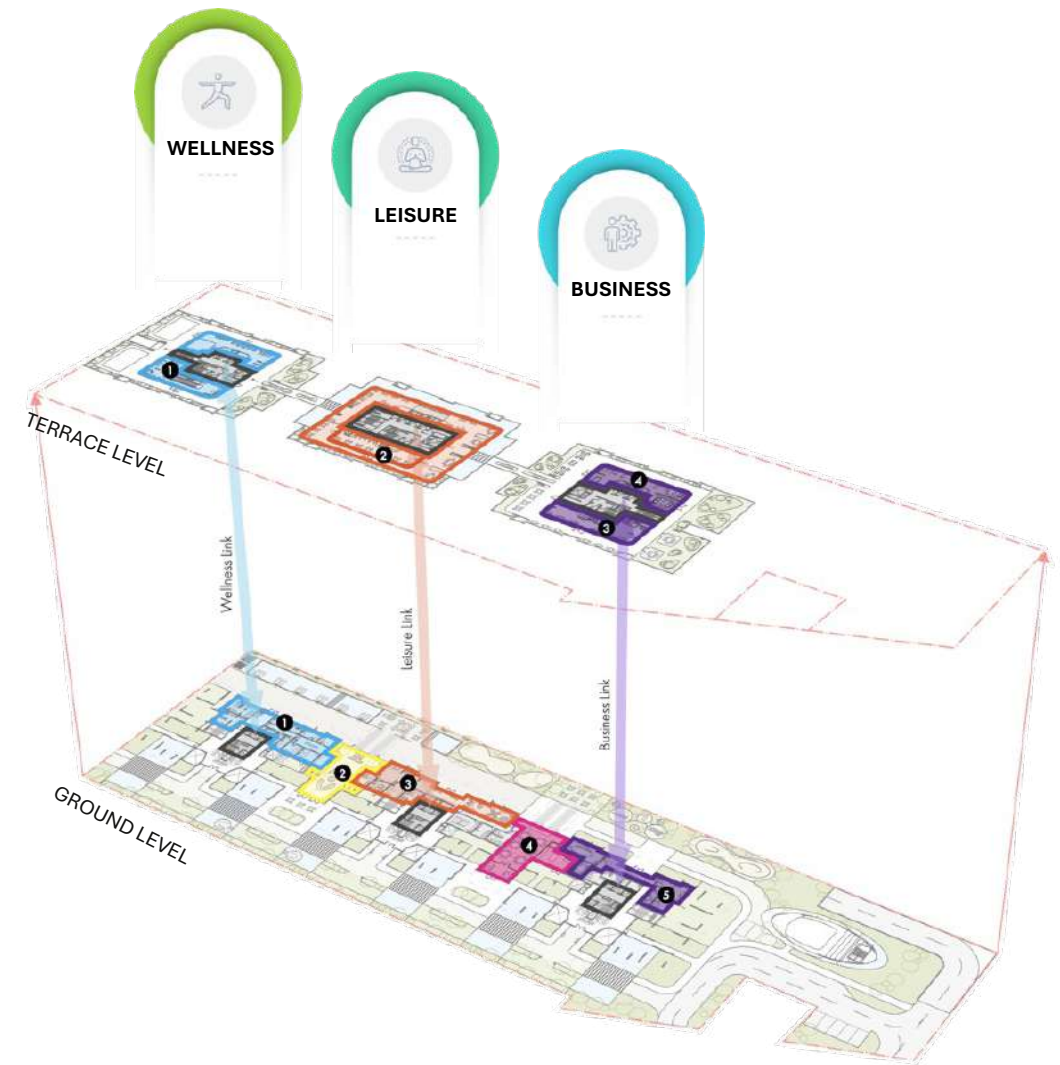

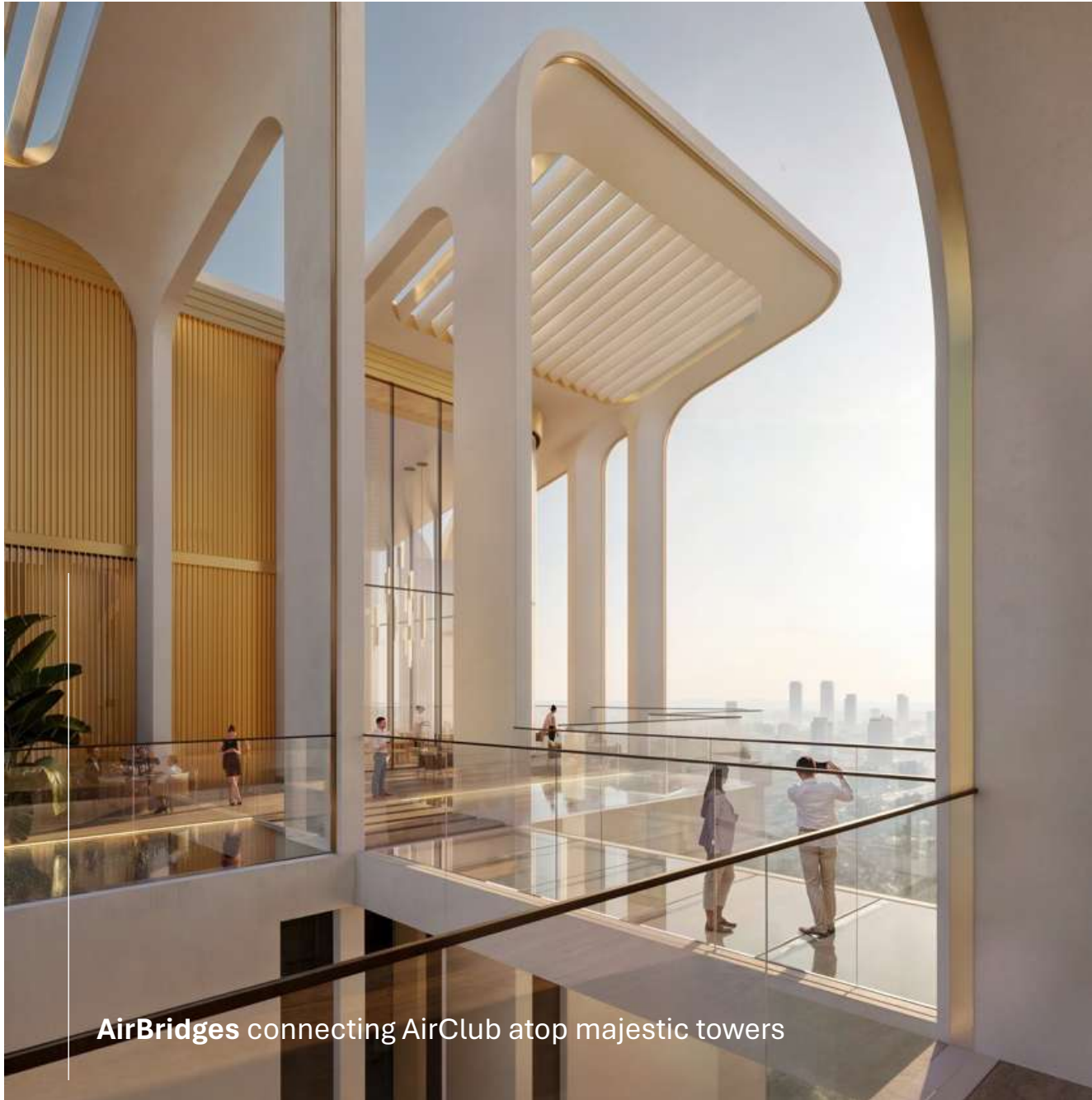

AirBridges connecting AirClub atop majestic towers

~**1,25,000** SFT OF
CLUB AMENITIES

Connected Through
A Glass **AirBridge**

Making It **The Largest
Interconnected
Sky Experience**
In Gurugram

A perfect ecosystem

for **Every Desire Of Live, Work, Leisure & More..**



WELLNESS

The Healing Zone



Skating Area

Yoga

Amphitheatre

Garden

Meditation Zone

Games Area

Sunken Ponds

Swimming Pool

Sauna

Hamam

Ice Room

Steam Room

Outdoor Fitness

Water Feature

Cloud Meditation

Outdoor Classes

Cardio

Climbing Wall

Banquet Hall

Spa

Playground

Banquet Lawn



LEISURE

The Aquatic Luxury



- Cafe
- Island Dining
- Art Room
- Lounge
- Music Room
- Sky Dining
- Water Restaurants
- Banquet Lawn
- Shallow Water Feature
- Green Pods
- Arcade Room
- Waterfall
- Restaurant
- Games Room
- Outdoor Sculpture Plan
- Virtual Gaming Room
- Karaoke Room

ALT-BREW CAFÉ

Step into a realm of exquisite flavors and unparalleled elegance at AltBrew - our cafe, where each sip and bite ignites the senses and transports you to a world of flamboyant indulgence.



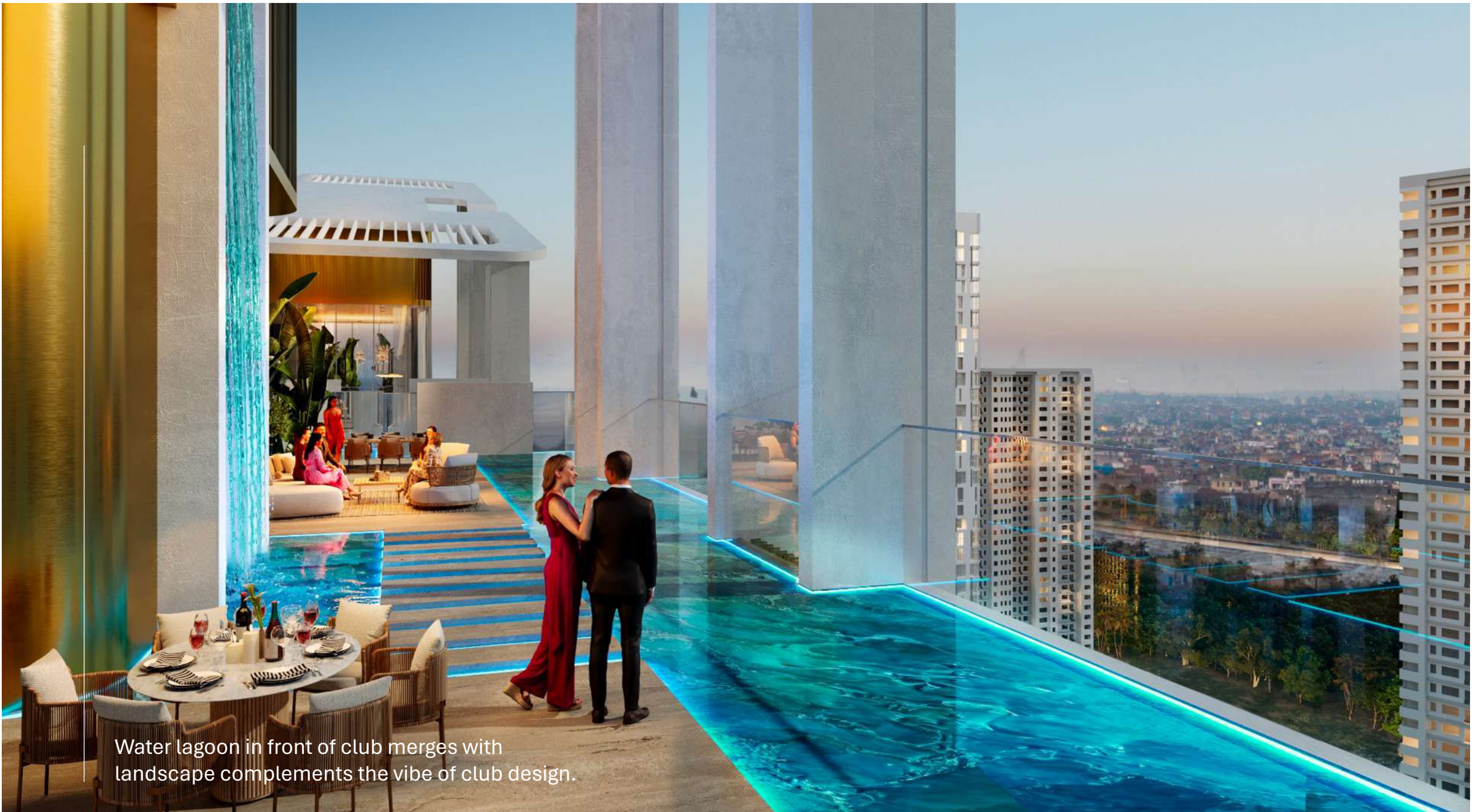

Water lagoon in front of club merges with landscape complements the vibe of club design.



BUSINESS

The Aquatic Luxury



- Conference Room
- Meeting Room
- Agile Working
- Co-working Area
- Relaxation Garden
- Sky Bar
- Outdoor Lounge Area
- Informal Meeting
- Pre-function Area
- Board Room
- Offices
- Business Centre Lounge
- Executive Lounge
- Banquet
- Outdoor Bar
- Executive Bar
- Library
- Sky Lounge



Indulge in serenity at the **AirClub**, where tranquil waters meet breath-taking horizons

Are You Ready

to Own this masterpiece?

ONLY **100** OPPORTUNITIES !

SALE BY APPOINTMENT ONLY

Own The **Most Extravagant Sky Experience** of Delhi NCR