

*Find your  
Dream Home*



*Plot No. 68, Sector- R2, Chinchpada,  
Pushpak-Vadghar, Panvel, Navi Mumbai.*



*A life full  
of Happiness*



*Artist's Imression\**



*Every moment is a picture  
perfect moment here...*

### *Project Features :*

- *Clear Title CIDCO Plot*
- *G + 7 Storied Residential & Commercial Project*
- *Exclusive Shop, 1 RK and 1 BHK Flats with natural light*
- *Quality Construction with earthquake Resistant RCC Structure*
- *Excellent Planning with no wastage area in all rooms*
- *Decorative Entrance Lobby*
- *Spacious Fitness Center and Society Office in 1st Floor*
- *CCTV Camera in Common Area*
- *Reputed make Branded Fire Elevator (Lift)*
- *Provision for Rain water Harvesting*
- *Loan available & Project approved by major Financial Institution and Banks*

### *Project Location :*

- *Excellent road connectivity to Mumbai - Pune expressway, Uran-Panvel, Sion-Panvel Highway connecting entire Mumbai and Navi Mumbai.*
- *Near by Navi Mumbai International Airport*
- *5 minutes drive from ST Depot and Panvel Railway Station*
- *2 minutes drive from Khandeshwar Railway Station*
- *Close to Mahatma Phule Art's, Science & Commerce College*
- *10 minutes accessibility to educational Institutes like Pillai Campus and MGM Group of Colleges and Hospital*
- *The Mumbai Trans Harbour Link ( Atal Setu ) will connect Panvel to Mumbai*
- *India largest and most modern sea port - (JNPT)*

*Premium Living  
Prime Location...*





**FLOORING :**

- 24" x 24" Vitrified flooring in all rooms
- Anti-skid flooring in toilet & bath

**KITCHEN :**

- Granite Kitchen platform with stainless steel sink
- Designer glazed tiles upto beam height
- Provision for water purifier point

**DOORS & WINDOWS :**

- Decorative laminated main door with wood frame
- Decorative laminated Internal doors with wooden frame
- Powder coated Aluminum sliding windows

**ELECTRIFICATION :**

- Concealed copper wiring of polycab make MCB's
- Adequate electrical points in all rooms
- ISI modular switches of premium make

**WALLS & PAINTS :**

- Putty finished Internal Walls
- Emulsion paints for Internal walls
- Asian apex paint for External walls

**BATH & WC :**

- Designer glazed tiles upto beam level
- Branded Sanitary wares of reputed make
- Premium quality C.P. Fittings
- Provision for Exhaust fan & Geyser Point

**WATERTANK :**

- Underground & Overhead water tank with adequate storage capacity

**TERRACE :**

- Special brickbat water proofing treatment with China Chips flooring on top floor







1  
RK  
FLAT



Type 1  
1  
BHK  
FLAT

*3D Impression*



# Type 2 1 BHK FLAT



Note :

The 3D images are provided to enable the allottees to visualization the flat with furniture and furnishing. The furniture and furnishing are not provided by the developers and the final look and feel of the flat is dependent on various factors like type/style of interior, furniture layout etc. and the developers have no role in the same.



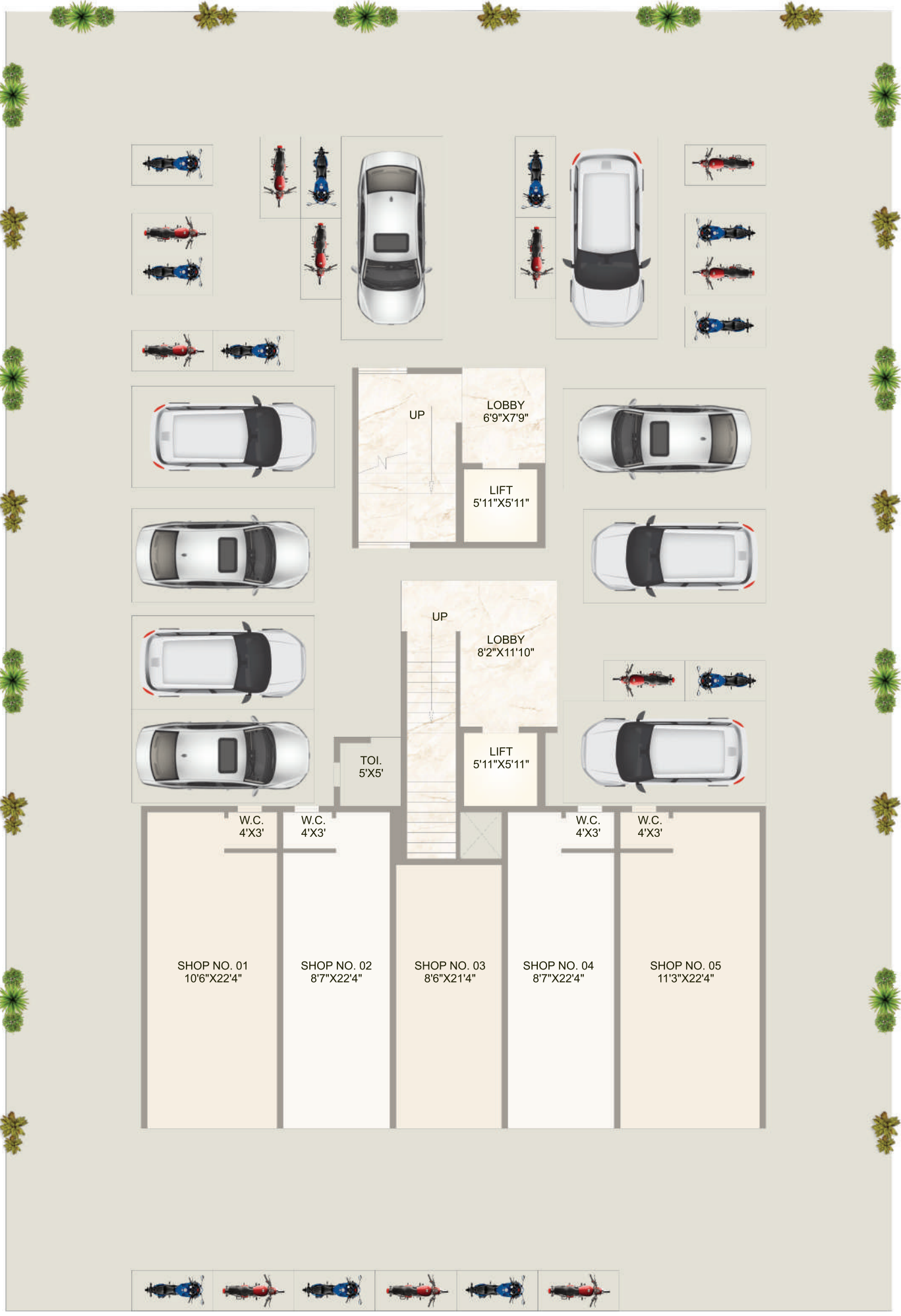

*Ground Floor Plan*

--- 20.0 M. WIDE ROAD ---

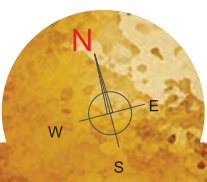

*1st Floor Plan*



--- 20.0 M. WIDE ROAD ---

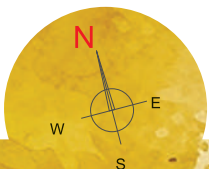





*2nd Floor Plan*

--- 20.0 M. WIDE ROAD ---

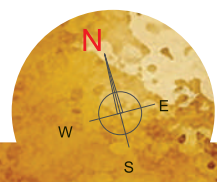



*3rd, 4th, 5th, 6th Typical Floor Plan*



--- 20.0 M. WIDE ROAD ---

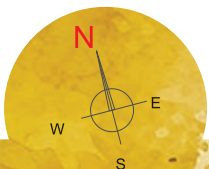





7th Floor Plan

--- 20.0 M. WIDE ROAD ---

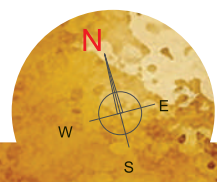



## Location Map

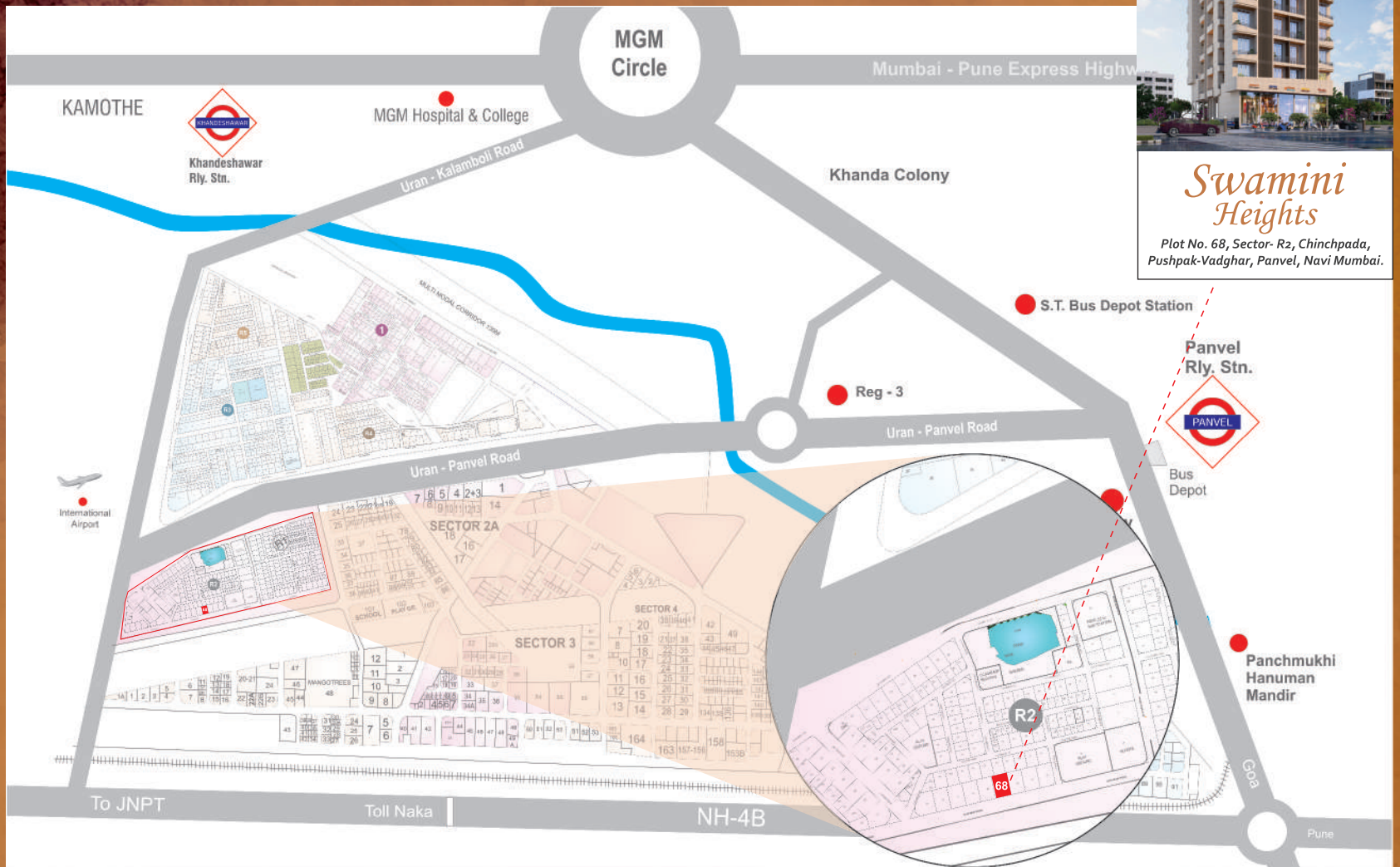

### Swamini Heights

Plot No. 68, Sector- R2, Chinchpada, Pushpak-Vadghar, Panvel, Navi Mumbai.

Project by :

# Swamini Infra

Builder & Developers

Office Address :

Swamini Heights, Plot No. 68, Sector - R2, Chinchpada, Pushpak-Vadghar, Panvel, Navi Mumbai.

Email : [vivekckeni@gmail.com](mailto:vivekckeni@gmail.com)

**Booking Contact : 90294 10325 | 81047 22626**

Architect :  
**MAYUR T. JAIN ARCHITECT**

RCC Consultants :  
**YATISH TARE (VASTUKALP)**

*Disclaimer : This communication is purely conceptual and is not a legal offering. It is made for only promotional purpose. This information contained in this communication is only indicative of the kind of development is proposed and is subject to change. The developers reserve the right to make change or alternation at their sole discretion.*