



Homes with
XXL Car Parking Space



BASEMENT FLOOR

- CAR PARKING: 15'7" X 19'6"
- OFFICE : 5'7" X 9'4"
- SERVANT : 5'7" X 8'8"

GROUND FLOOR

- LIVING : 19'8" X 10'8"
- DINING : 11'8" X 10'0"
- KITCHEN: 7'1" X 7'10"
- TOILET: 4'3" X 7'7"
- BED ROOM : 11'2" X 11'0"

FIRST FLOOR

- BALCONY: 17'5" X 4'1"
- M.BED ROOM: 17'5" X 10'10"
- PUJA: 5'3" X 6'1"
- TOILET: 5'5" X 11'0"
- BED ROOM: 17'5" X 11'0"
- TOILET: 5'5" X 10'10"

SECOND FLOOR

- OPEN TERRACE: 13'7" X 10'10"
- BAR COUNTER: 9'2" X 10'4"
- TOILET: 5'5" X 11'0"
- BED ROOM: 17'5" X 11'0"
- SEATING: 10'2" X 7'0"



EAST FACING



BASEMENT FLOOR

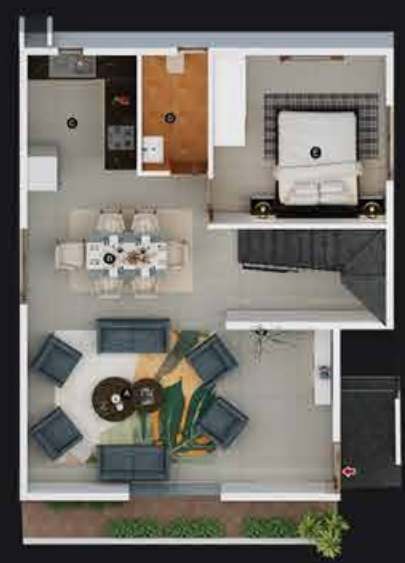

GROUND FLOOR



FIRST FLOOR



SECOND FLOOR



BASEMENT FLOOR

- CAR PARKING: 15'7" X 19'6"
- OFFICE: 5'7" X 9'4"
- SERVANT: 5'7" X 8'8"

GROUND FLOOR

- BED ROOM: 11'2" X 11'0"
- LIVING: 19'8" X 10'8"
- DINING: 11'8" X 10'0"
- KITCHEN: 7'1" X 7'10"
- TOILET: 4'3" X 7'7"

FIRST FLOOR

- M.BED ROOM: 17'5" X 11'0"
- TOILET: 5'5" X 10'10"
- BALCONY: 17'3" X 4'1"
- BED ROOM: 17'5" X 10'10"
- PUJA: 5'3" X 6'1"
- TOILET: 5'5" X 11'0"

SECOND FLOOR

- BED ROOM: 17'5" X 11'0"
- OPEN TERRACE: 13'7" X 10'10"
- SEATING: 10'2" X 7'0"
- BAR COUNTER: 9'2" X 10'4"
- TOILET: 5'5" X 11'0"



NORTH FACING



BASEMENT FLOOR



GROUND FLOOR



FIRST FLOOR



SECOND FLOOR



EAST FACING



BASEMENT FLOOR

- CAR PARKING: 15'7" X 17'3"
- OFFICE : 9'4" X 10'8"
- STORE ROOM : 8'6" X 9'4"
- SERVANT: 6'3" X 9'4"

GROUND FLOOR

- LIVING : 18'6" X 11'6"
- KITCHEN & DINING : 11'8" X 16'0"
- BEDROOM : 10'0" X 14'0"
- TOILET: 6'3" X 5'0"
- UTILITY: 5'1" X 5'0"

FIRST FLOOR

- BALCONY : 16'1" X 4'2"
- M.BEDROOM: 16'3" X 15'7"
- TOILET: 5'5" X 10'4"
- WALK-IN WARDROBE: 8'0" X 5'0"
- PUJA: 5'3" X 6'5"
- BEDROOM: 16'3" X 14'0"
- TOILET: 5'5" X 8'8"
- WALK-IN WARDROBE: 8'0" X 5'0"

SECOND FLOOR

- SEATING: 8'10" X 11'8"
- OPEN TERRACE: 13'9" X 15'7"
- BAR AREA: 7'10" X 10'4"
- BEDROOM: 16'3" X 14'0"
- TOILET: 5'5" X 8'8"
- WALK-IN WARDROBE: 8'0" X 5'0"



BASEMENT FLOOR



GROUND FLOOR



FIRST FLOOR



SECOND FLOOR



BASEMENT FLOOR

- ① CAR PARKING: 15'7" X 17'3"
- ② OFFICE : 9'4" X 10'8"
- ③ STORE ROOM : 8'6" X 9'4"
- ④ SERVANT: 6'3" X 9'4"

GROUND FLOOR

- ⑤ BED ROOM : 10'0" X 14'0"
- ⑥ LIVING : 18'6" X 11'6"
- ⑦ KITCHEN&DINING : 11'8" X 16'0"
- ⑧ UTILITY: 5'1" X 5'0"
- ⑨ TOILET: 6'3" X 5'0"

FIRST FLOOR

- ⑩ M.BED ROOM: 16'3" X 14'0"
- ⑪ WALK-IN WARDROBE: 8'0" X 5'0"
- ⑫ TOILET: 5'5" X 10'4"
- ⑬ BALCONY: 16'5" X 4'2"
- ⑭ BED ROOM: 16'3" X 15'7"
- ⑮ PUJA: 5'3" X 6'5"
- ⑯ WALK-IN WARDROBE: 8'0" X 5'0"
- ⑰ TOILET: 5'5" X 8'8"

SECOND FLOOR

- ⑱ BED ROOM: 16'3" X 14'0"
- ⑲ OPEN TERRACE: 13'9" X 15'7"
- ⑳ SEATING: 8'10" X 11'8"
- ㉑ BAR COUNTER: 7'10" X 10'4"
- ㉒ WALK-IN WARDROBE: 8'0" X 5'0"
- ㉓ TOILET: 5'5" X 8'8"



NORTH FACING



BASEMENT FLOOR



GROUND FLOOR



FIRST FLOOR



SECOND FLOOR

Homes with
Servant Quarters & Workspaces



World-Class Amenities
Infinity Pool & Rooftop Delights



Club House

Yash Elite-spaces

Water Body



Outdoor Party Area



Play Area



Half Basket Ball Court



Skating Rink



Amphitheater View

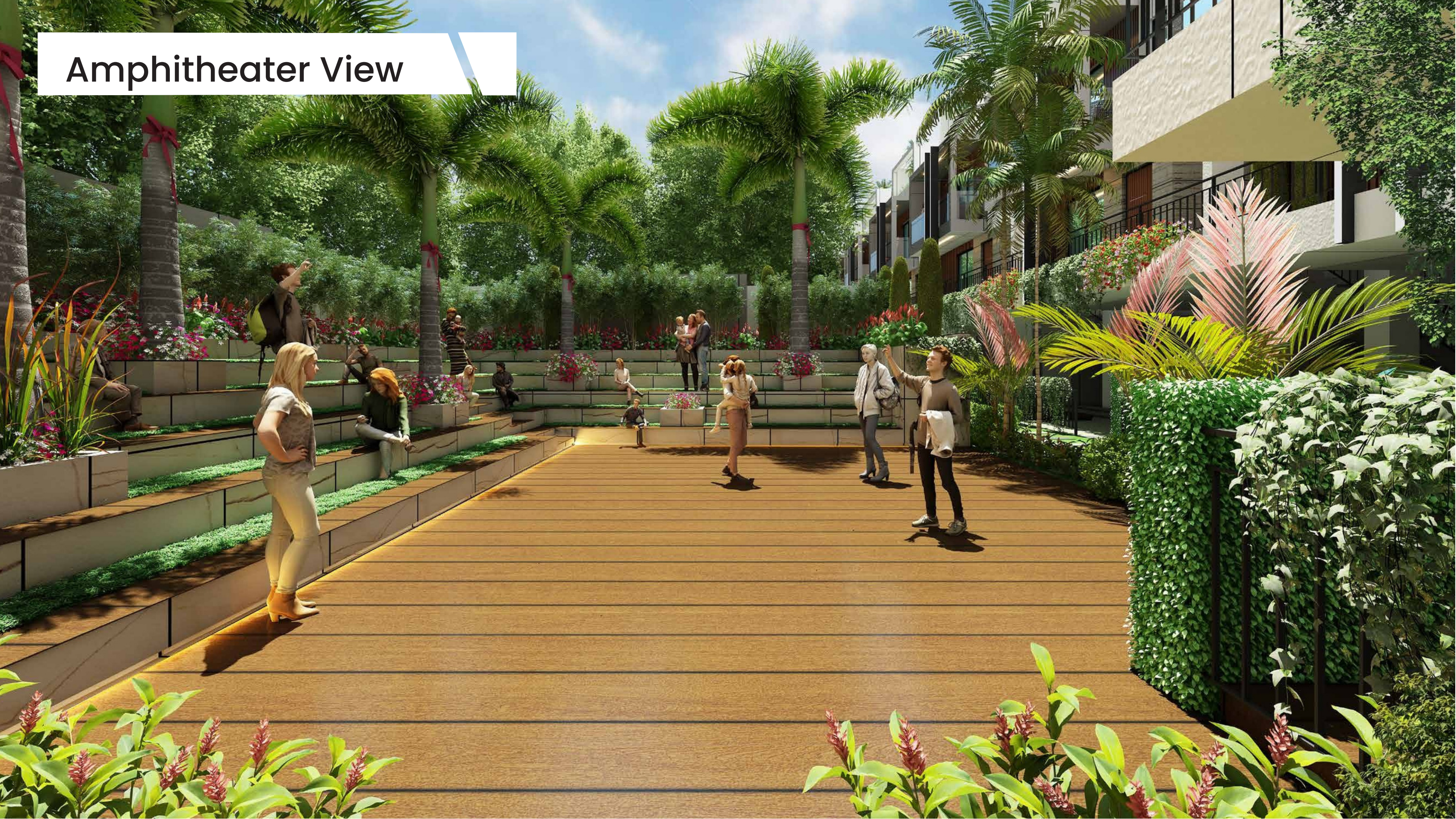

Cricket Pitch



Ultimate Convenience

Live Close to Schools and Workspaces



Unmatched Specifications

Blocks:

Wienerberger / equivalent

Electrical wires:

KEI/equivalent

Electrical switches:

Honeywell / equivalent

Electric Vehicle Support:

Provision for EV Charging Point in Garage

UPVC Windows:

Aparna /equivalent

Doors:

Main Door Teak wood frame with moulded skin shutter

Bedroom:

Sal wood frame with moulded skin shutter

Toilet Sal wood frame with water proof moulded skin shutter

Locks & hardware:

Yale/equivalent

Staircase railing:

Glass railing with SS

Sink:

Franke/equivalent

Plumbing pipes:

Prince/equivalent

Sanitary:

VitrA/equivalent

CP fittings:

VitrA/equivalent

Flooring:

Diana Italian Marble/equivalent

Imported Laminated Wooden Flooring:

for all Bedrooms

Granite flooring:

Staircase

Anti-skid tiles:

Toilet, Utility

Paint:

Asian Paints/equivalent

Power Backup:

100% Generator Backup