



# PARIJAS HORIZON

Discover a Sky-High Living

Venture By:



**Parijas Group**  
Concept To Creation.



**RM UNIVERSAL**  
*universe of opportunities*

At PARIJAS GROUP, creating luxurious lifestyle projects is an art that we cherish and celebrate. With a rich experience of working with the leading architects, designers and developers of the industry, our thoughtfully designed homes are crafted to delight our customers with world-class quality offerings. Our magnificent homes are reflection of refined luxury and impeccable artistry.

Built on the pillar of customer-centric approach, we're now a name that real estate industry veterans with a cumulative experience of more than 40 years. With a vision of making everybody's dream home a reality, we're committed to bring to life projects and lifestyle offerings where one can relish the best of everything life has to offer.

# Crafting Spaces

Where Neighbors Turn Into Lifelong Friends



**Parijas Group**  

---

**Concept To Creation.**

---



# IN THE HEART

*of our Projects, The Dreams and Joy of Cherished Families Dwell.*

## COMPLETED PROJECT

**Parijas Zenith**

Parijas Zenith in Kalyan (E)

**136 RESIDENTIAL & 13 COMMERCIAL UNITS.**



The project was completed **13 MONTHS** ahead of schedule.

## ONGOING PROJECT

**Parijas Greens**

Parijas Green in Khadakpada, Kalyan (W.)

**28 UNITS, ALL 2BHK**



Completion is expected by **DECEMBER 31, 2025**



**H**<sup>A</sup>**orizon**

of enduring bonds, where happiness radiates from every direction.

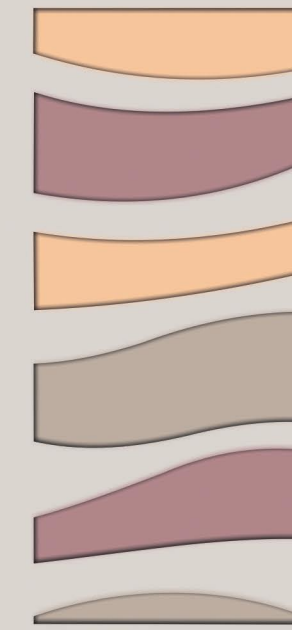
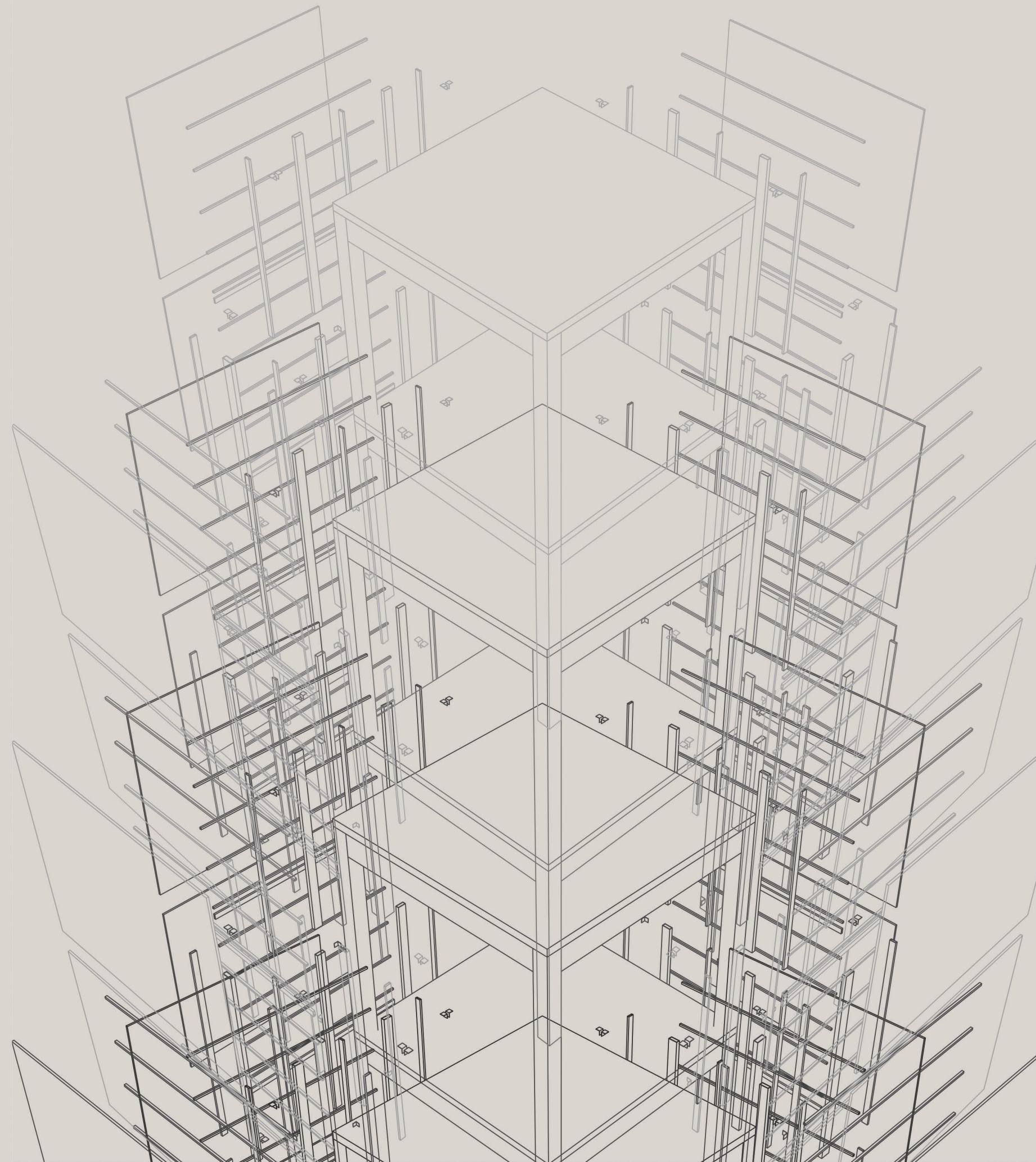

# PARIJAS HORIZON

## **A HORIZON** of architectural gem

Step into the extraordinary PARIJAS HORIZON - an architectural masterpiece that transcends the feel of mere residences. These spacious homes redefine modern living, seamlessly blending luxury and coziness for a lifestyle beyond the ordinary.

With ample parking providing unparalleled convenience, the journey to the 10th floor and beyond unfolds a captivating river view. Each room, embellished with its private balcony, blurs the lines between indoor and outdoor bliss.

A tall, modern skyscraper stands against a night sky filled with stars and the Milky Way. The building's windows are illuminated from within, and its balconies feature lush greenery. The base of the building is lit up, showing a modern entrance with palm trees and a few cars. The overall scene is a blend of urban architecture and natural beauty.

THE HORIZON  
of Modern Living  
Where Every Moment is a  
Masterpiece



PARIJAS HORIZON

Venture By

Parijas Group  
Concept To Creator

RM UNIV

**E** An elegant  
**Entrance Gate**  
that Sets the Stage for Remarkable Experiences

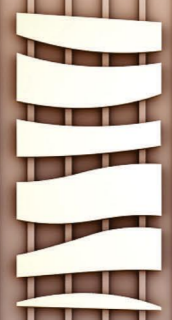

PARIJAS HORIZON

# E

A sophisticated  
**Entrance Lobby**

Adorned with exquisite design elements, extending an inviting embrace to residents and guests.







Gymnasium

Indoor Game

Community Hall

Unwind Zone

Yoga & Meditation Corner

Pergola Seating

# The Amenities Floor

The Amenities Floor isn't just a treasure trove of facilities; it's an area where residents can indulge in a multitude of activities, fostering a vibrant community within the confines of unparalleled comfort and convenience.



## Conquer With Indoor Games

From engaging in strategic chess matches to indulging in thrilling games of billiards, residents can indulge in a plethora of recreation choices.

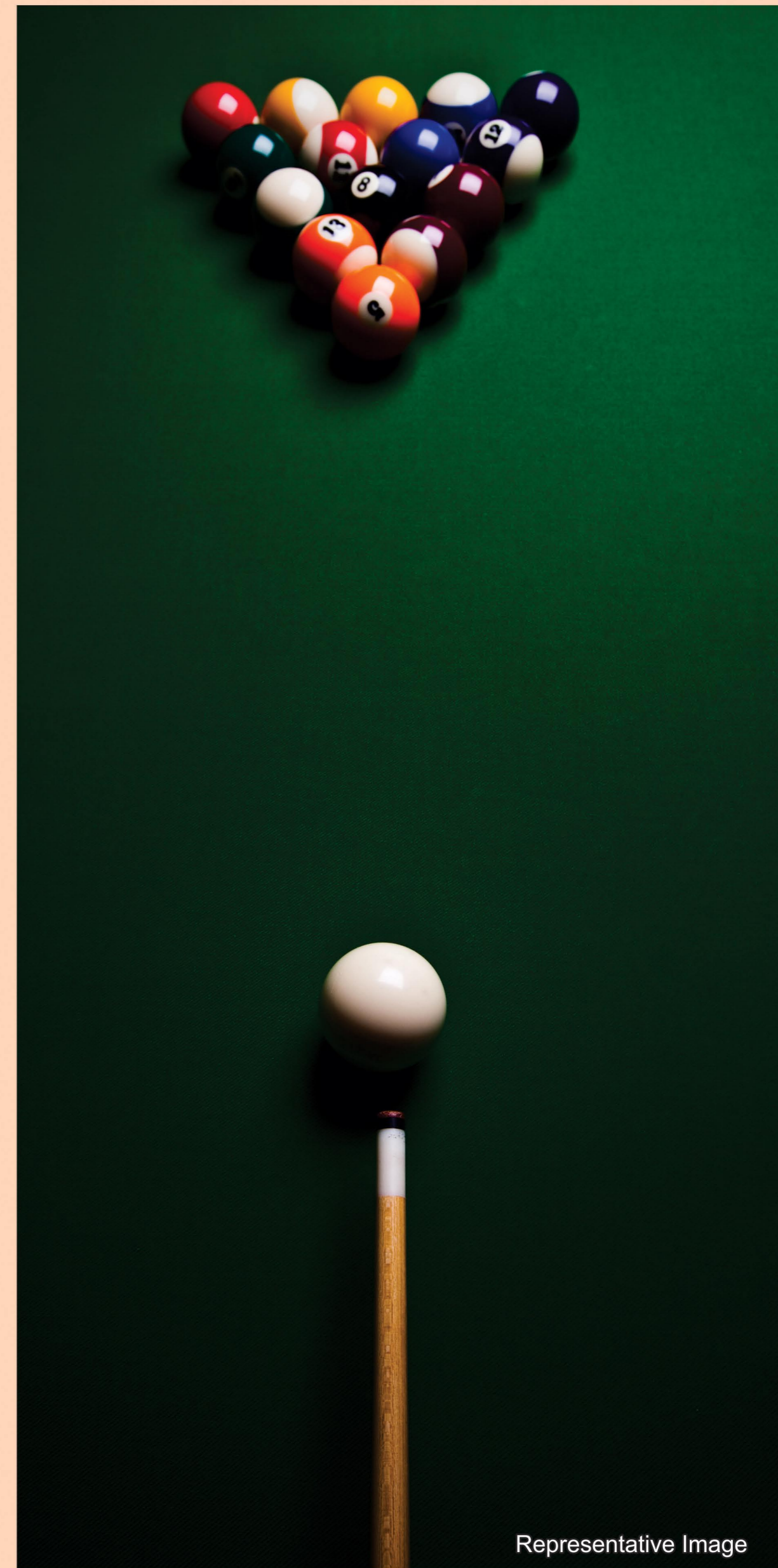

Representative Image



Representative Image



# F Hustle for the muscle! itness Center

Embark on a fitness journey, exploring a spectrum of exercise options — from cardio to strength training and specialized workouts.



Representative Image



Artistic Impression

Discover Fulfillment at  
**Sitout Space**

Embrace the fusion of aesthetics and leisure. A space where you can relax, recharge, relish the surrounding beauty and the bonds!



**Y** A sacred space for  
**oga & Meditation**

Elevate your senses, escape the noise, and embrace stillness in this calm enclave.

Artistic Impression



Representative Image



**W** A step for good health  
**alking Track**

This thoughtfully designed walking track invites you to stride towards well-being amidst architectural grandeur

Artistic Impression





Representative Image



Artistic Impression

Relish joyous moments on  
**Adult Swing**

Revel in the simple pleasures of life; surrounded by a carpet of greenery, where relaxation takes flight.

# Connectivity

## COMMERCIAL SHOPPING

- Dmart Mohan Square, Vasant Valley – 1.2 kms
- Patel R Mart – 2.5 kms
- Reliance Fresh – 2.7 kms
- Dmart Godrej Hill – 2.9 kms
- Metro Junction Mall – 5.5 kms

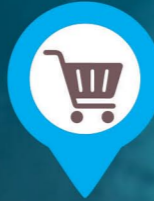

## ROAD & RAILWAY STATION

- Kalyan Station – 4.4 kms
- Shahad Station – 4.8 kms
- Vitthalwadi Station – 6.9 kms
- Upcoming Kalyan Ring Road – (Titwala –Dombivli)



## FOOD & ENTERTAINMENT

- 88 Bar & Kitchen – 800 mtrs
- Nock Nock – Resto & Bar – 800 mtrs
- Golden Wok – 1.3 kms
- Hotel Gurudev NX – 2.5 kms
- Hotel Indigo – 2.5 kms
- Aromagasm Café – 3.4 kms
- INOX – 5.2 kms



## BANKS

- ICICI Bank – 1.8 kms
- IDBI Bank – 2.1 kms
- Axis Bank Branch – 2.3 kms
- Canara Bank – 2.8 kms
- Indusland Bank – 2.9 kms



## SCHOOLS & COLLEGES

- Periwinkle Pre School – 0 mtrs (Adjacent to our project)
- KM Agarwal College – 450 mtrs
- Vibgyor Roots & Rise (CBSE) – 900 mtrs
- Narayana e-tech School – 1.1 kms
- Vibgyor High School – 1.5 kms
- Mumbai University Sub Division – 1.7 kms
- Cambria International School – 2.2 kms
- B.K. Birla School – 3.4 kms
- Birla College – 3.7 kms



## HOSPITALS

- Vedant Kalyan Hospital – 1.9 kms
- Aayush Hospital – 2.0 kms
- Khadakpada Multispeciality Hospital – 2.4 kms
- The Kalyan Hospital – 2.4 kms
- Venkatesh Hospital – 2.8 kms



# Seamless Accessibility Convenience made Easy

Embrace the ease of access to transportation hubs, educational institutions, shopping centers, and recreational hotspots. It's more than a location; it's a lifestyle designed for connected living.

## Location Map





# A HORIZON

of refined living Explore the art of fine living at Parijas Horizon, where a diverse range of flats are designed with precision, each exuding spaciousness and contemporary elegance.



15.0 M. W. D.P. ROAD

9 MTR. WIDE DRIVE WAY

6 MTR. WIDE DRIVE WAY

6.00 WIDE DRIVE WAY

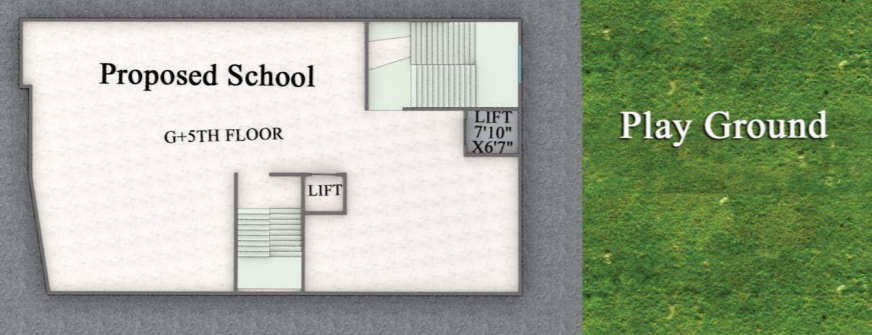
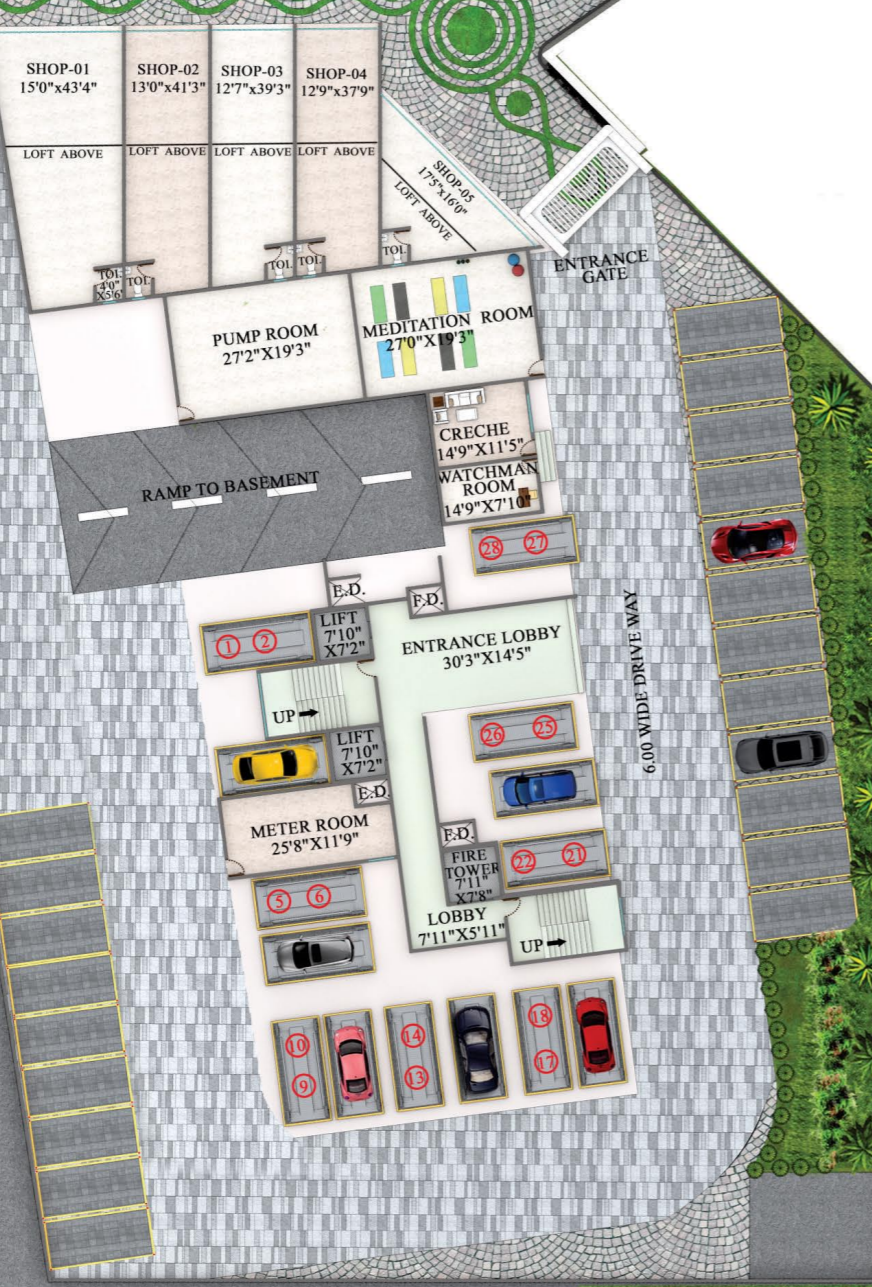

**Ground Floor**



**1st Floor Plan**



Flat No.	Rera Carpet Area (In Sq.Ft)	Balcony Area (In Sq.Ft)	RERA + Balcony (In Sq.Ft)	Total Usable Carpet Area (In Sq. Ft.)
01	636.04	51.24	687.28	732.60
04	660.80	51.24	712.04	757.36
05	660.80	51.24	712.04	757.36
06	416.57	49.19	465.76	484.49
07	386.97	78.79	465.76	484.49
08	636.04	51.24	687.28	732.60



## Typical Floor 2nd to 27th



Flat No.	Rera Carpet Area (In Sq.Ft)	Balcony Area (In Sq.Ft)	RERA + Balcony (In Sq.Ft)	Total Usable Carpet Area (In Sq. Ft.)
01	636.04	51.24	687.28	732.60
02	430.13	49.19	479.32	498.05
03	430.13	49.19	479.32	498.05
04	660.80	51.24	712.04	757.36
05	660.80	51.24	712.04	757.36
06	416.57	49.19	465.76	484.49
07	386.97	78.79	465.76	484.49
08	636.04	51.24	687.28	732.60



## Typical Floor 7th, 12th, 17th, 22nd, 26th



Flat No.	Rera Carpet Area (In Sq.Ft)	Balcony Area (In Sq.Ft)	RERA + Balcony (In Sq.Ft)	Total Usable Carpet Area (In Sq. Ft.)
01	636.04	51.24	687.28	732.60
02	430.13	49.19	479.32	498.05
03	430.13	49.19	479.32	498.05
04	660.80	51.24	712.04	757.36
05	341.54	51.24	392.78	392.78
06	416.57	49.19	465.76	484.49
07	386.97	78.79	465.76	484.49
08	636.04	51.24	687.28	732.60



**TYPE - 1BHK  
(Exclusive)  
FLAT NO - 2 & 3**



Flat No.	Rera Carpet Area (In Sq.Ft)	Balcony Area (In Sq.Ft)	RERA + Balcony (In Sq.Ft)	Total Usable Carpet Area (In Sq. Ft.)
02	430.13	49.19	479.32	498.05
03	430.13	49.19	479.32	498.05



**TYPE - 1BHK  
(Impressive)  
FLAT NO - 6 & 7**



Flat No.	Rera Carpet Area (In Sq.Ft)	Balcony Area (In Sq.Ft)	RERA + Balcony (In Sq.Ft)	Total Usable Carpet Area (In Sq. Ft.)
06	416.57	49.19	465.76	484.49
07	386.97	78.79	465.76	484.49



**TYPE - 2BHK  
(Exclusive)  
FLAT NO - 4 & 5**



KEY PLAN



Flat No.	Rera Carpet Area (In Sq.Ft)	Balcony Area (In Sq.Ft)	RERA + Balcony (In Sq.Ft)	Total Usable Carpet Area (In Sq. Ft.)
04	660.80	51.24	712.04	757.36
05	660.80	51.24	712.04	757.36

**TYPE - 2BHK  
(Impressive)  
FLAT NO - 1 & 8**



KEY PLAN



Flat No.	Rera Carpet Area (In Sq.Ft)	Balcony Area (In Sq.Ft)	RERA + Balcony (In Sq.Ft)	Total Usable Carpet Area (In Sq. Ft.)
01	636.04	51.24	687.28	732.60
08	636.04	51.24	687.28	732.60

## TYPE - 2.5 BHK



Rera Carpet Area (In Sq.Ft)	Balcony Area (In Sq.Ft)	USABLE AREA (IN SQ.FT)
869.28	98.38	967.66



## TYPE - 3 BHK



Rera Carpet Area (In Sq.Ft)	Balcony Area (In Sq.Ft)	USABLE AREA (IN SQ.FT)
1,013.31	102.46	1,115.77



# TYPE - 4.5 BHK

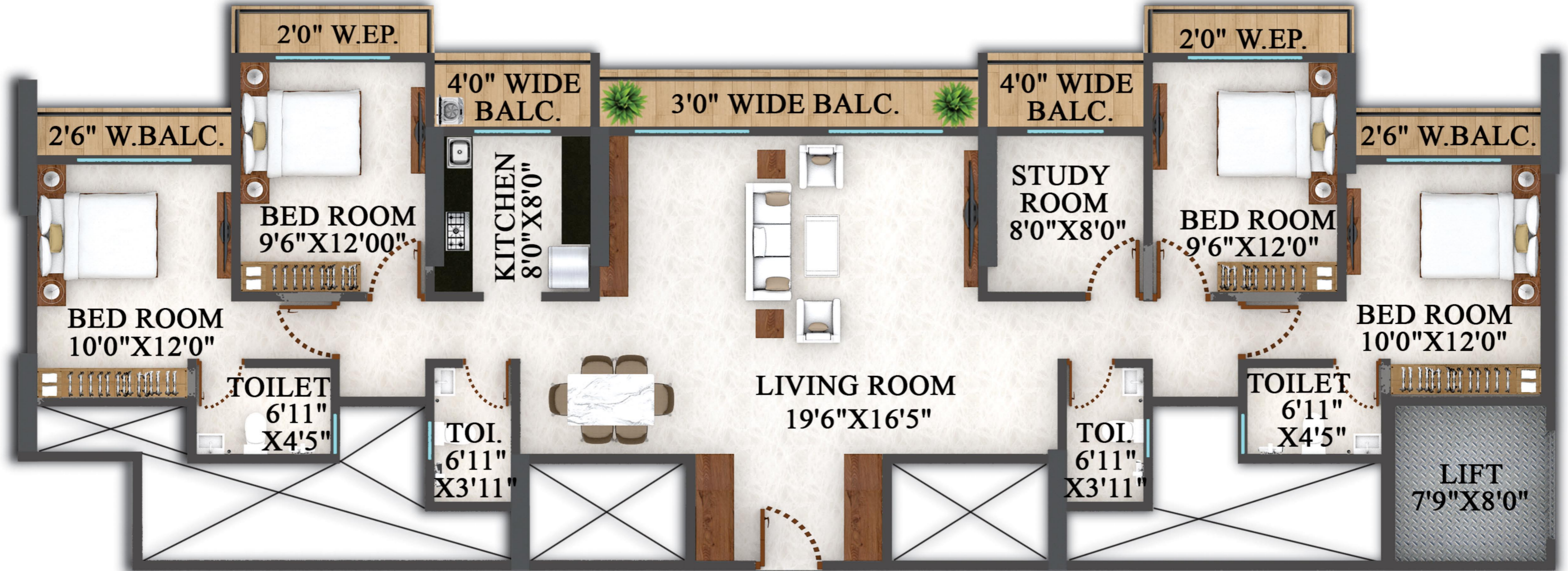

Rera Carpet Area (In Sq.Ft)	Balcony Area (In Sq.Ft)	USABLE AREA (IN SQ.FT)
1323.32	147.46	1470.78



## Amenities

### DOORS & FRAMES:

- Good quality wooden frame with oil paint finish.
- Designer flush doors with both side laminate decorative fitting.

### FLOORING:

- Branded vitrified tiles in entire flat.

### WALL FINISH:

- Internal walls with gypsum finish.
- Decorative ceiling.
- Oil paint in bathrooms above the lintel level.

### BATHROOM:

- Branded CP fittings.
- C-PVC concealed piping.
- Exhaust fans in all bathrooms.
- Washbasins with granite counter.
- One geyser of reputed brand in each flat.
- Designer tile flooring and dado up to lintel level.

### WINDOW:

- Colour anodized aluminium sliding windows.
- Mosquito net shutter in windows.
- Photo frame, granite window sill.

### ELECTRIFICATION:

- Concealed copper wiring with circuit breakers.
- Telephone and cable TV points in living room and bedrooms.
- Inverter provision in flat.
- Video door provision in flat.

### GENERAL FEATURES:

- Building consists of 3 high speed lifts.
- Decorative Entrance Lobby.
- Generator back up for lifts, staircase lights & water supply pumps.
- Solar Net Metering for common areas.
- CCTV Surveillance and Security in Ground Floor Entrance Lobby and Entry and Exit Gates.

## Advanced Features

Horizon boasts top-notch security with CCTV and provision For door video systems, stylish branded elevators, advanced fire safety, eco-friendly solar power, and a cozy senior citizen relaxation area.



Provision Door Video



CCTV



Branded Elevators



Senior Citizen Sitting Area



Ample Parking



Solar Systems



Fire Equipments



Chimney(Provision)



DG Backup



### -: KITCHEN :-

- Parallel kitchen granite platform with SS sink and drain board.
- Granite stone fixed for water dispense.
- Electrical provision for chimney in kitchen.
- RCC loft in kitchen.



Inviting you to create a story of  
FULFILLMENT, LOVE, AND LAUGHTER;  
where each day is a chapter of your  
*Happily Ever After!*

Venture By.



Site Add.: Near Periwinkle Pre-School, Village Gandhare, Khadakpada, Kalyan 421 301

9089 998 444 | [www.parijasgroup.com](http://www.parijasgroup.com)

Architect: VITAN CONSULTANTS | R.C.C. Consultant: ASC | Legal Advisor: LAW MEN CONCEPTS

DISCLAIMER: This brochure is for guidance only. It is not legal document and does not constitute part of any offer contract. This brochure is not to be reproduced or copied or made available to others. Design subject to change without prior notice. Proposed development is subject to approval of competent authorities.

More Details:



P51700054200