

Emirus

www.emirus.in

Emirus
the top slot

3.5 & 4.5 BHK Premium Villaments
BANER

THE TOP SLOT I

A lavish home, world class amenities, great location and nearness to all lifestyle conveniences...are your genuine expectations. We not only have exceeded those, but intensified the set of offerings with an invigorating view of sky, private lobby and personalelevator. Welcome to Emirus. It reflects your imagination.

SYMBOL OF CREME DE LA CREME URBAN LIVING.

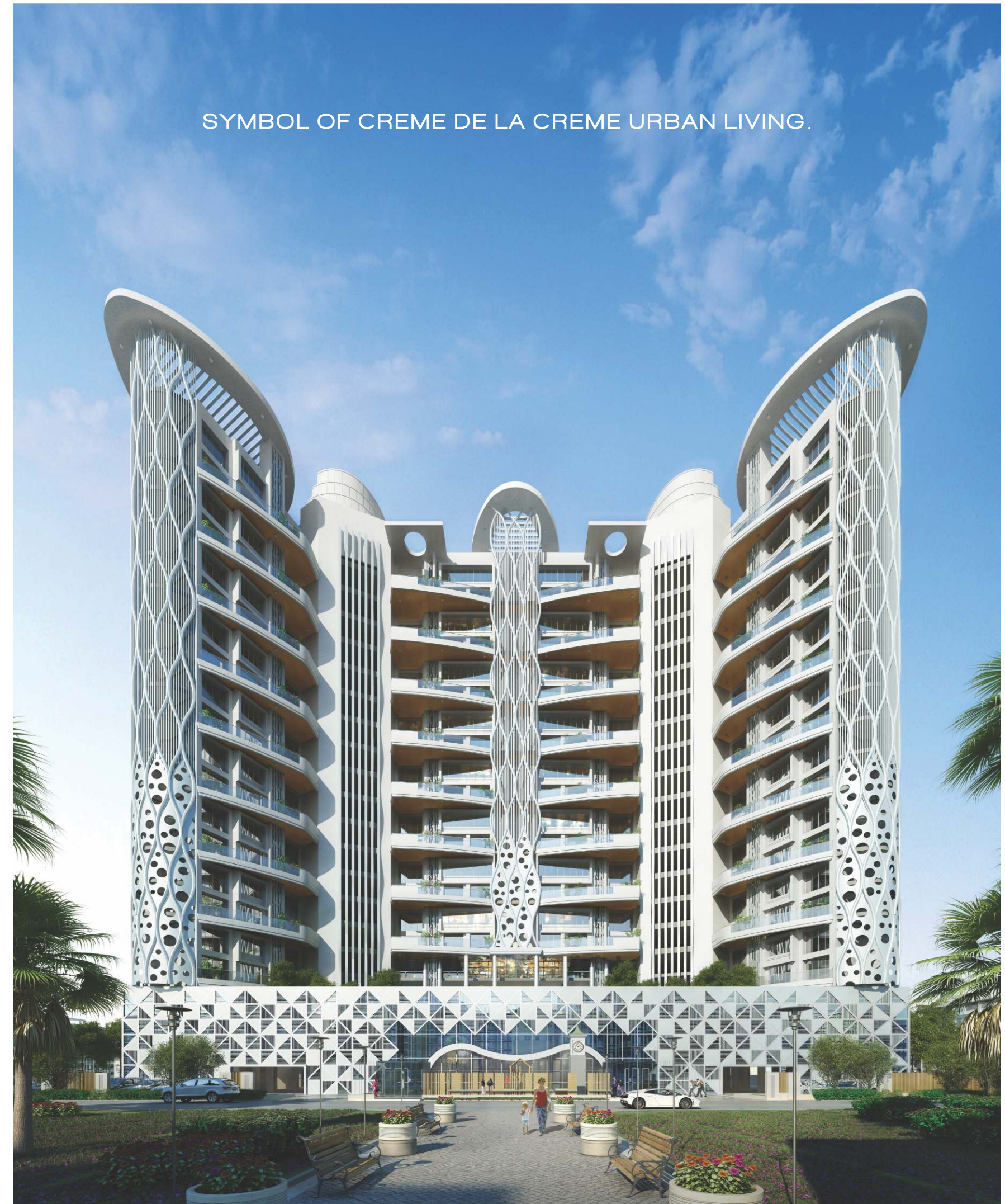



INDULGE IN RAPTURE.
IN THE MOST INTRIGUING WAY.

Villaments with high speed personalised elevator

- Video Door Phone
- Designer Veener finish wooden main door
- Digital main door lock (Samsung or Equivalent)
- Designer lift interiors with maximum height

Emirus is a blend of privacy of a bungalow and safety of an apartment. The personal elevator would take you to your home directly. Giving rise to many mischievous, rapturous moments you would reminisce for a lifetime.

FOR THE EXTRA AFFLUENT MOMENTS
YOU DESERVE



THE RELAXING DEN

- Imported marble in Living & dining
- Mood lighting
- 10ft clear height
- Arrangement for Air Conditioning System
- Intercom facility
- Cross ventilation in living and dining
- POP finish with plastic / luster paint
- TV & Telephone Point in living & all bedrooms
- Concealed copper wiring
- Schneider or equivalent electrical switches
- Limited Power backup
- Full size windows in living and dining

Space is outsized, so much so that taking a stroll within your apartment is a worthwhile journey in itself. Ultra spacious lavish apartments will set your imagination free...for productive utility. Even for mischief!



UNCOVER THE FANTASIES.
LUXURIATE.



Villaments with private lobby

Affluence would be the attitude over here. Why would even think of confining your ideas to mediocrity? If you feel like performing a step or two of ballroom dance, any place at your home should let you be you. Be it your private lobby for that matter ...



THE MASTER'S DEN

- Designer Vitrified tiles for bedrooms
- Texture painted internal doors
- Wooden door frames for bedrooms
- Imported Marble window sills
- 3 track sliding UPVC windows with mosquito net.
- Concealed foot lamps in all bedrooms
- Window ledge sitting in bedroom

ENLARGE THE MAGNITUDE OF YOUR LIFE

Redefine luxury. Experience the utmost comfort. Much beyond said & done, a classy living suite reflecting your innermost desires would let you unleash a new you. At Emirus, do the different. Enlarge your life.



EXPLOIT THE AWE-INSPIRING DESIGN.
PAMPER YOUR MOODS.

Villaments with breathtaking Views &
cross-ventilation

THE DECK

- Large Sun/Party Decks
- Designer Deck with Glass Railing
- Wooden finish Ceramic Tiles
- Wooden Ceiling at 20ft height

Describing the apartments at Emirus as 'beautifully designed homes' will not do enough justice to the clever architecture of the project. The elevation is mind-blowing. The height would always let you inhale fresh. And at your large terrace you would be enthralled with the winds of the mountains.



THE FINE DINING & BUTLERS PANTRY

- Designer modular kitchen with Hob & Chimney (Faber or Equivalent)
- L-shaped Granite Kitchen platform with SS sink
- Exhaust fan
- Designer Dado tiles upto Lintel level
- Water purifier
- Piped gas with Gas leak detector
- Double sink in Kitchen of 4.5 BHK
- Utility Area with facility for dishwasher and washing machine

WELCOME LIFE.
RAISE A TOAST.

Homes which can be aptly portrayed as personification of your dream! Live. Follow the artistic approach. Reinvent your own style.

CELEBRATE EVERY EXPERIENCE
WITH NOVEL IDEAS



THE RESTROOM

- Designer premium sanitary ware (Toto or Equivalent) and CP fittings (Isenberg or Equivalent).
- Occupancy sensors
- Premium designer tiles upto lintel level
- Shower enclosures
- Rain shower and bathtub in master bathroom
- Exhaust Fans
- Concealed flush tanks / water closet
- Wash Basin with Marble counters
- Separate shower area and stand alone bathtub
- Pex plumbing for easy maintenance
- Drain channels



Infinity Pool with kids Pool



Podium View



Entrance lobby with Kids Pick n drop area & clock tower



Labyrinth on Podium

CLASSY AMENITIES & SPECS
TO LIFT YOUR SPIRITS



3.5 Bhk Even Floor Saleable – 2238sqft
3.5 Bhk Odd Floor Saleable – 2315sqft

TYPICAL 3.5 BHK



4.5 BHK (Odd & Even Floor)
Saleable – 3145sqft

TYPICAL 4.5 BHK

LAYOUT PLAN

Baner, Pune, Maharashtra

Emirus
the top slot

3.5 & 4.5 BHK Premium Villaments
BANER

18M Wide D. P. Road



- AMPHITHEATRE
- INFINITY POOL
- KIDS POOL
- PARTY LAWN
- CHILDREN PLAY AREA
- LABYRINTH
- GAMING ZONE
- HANGING GYMNASIUM on 4th floor
- PUTTING GREENS
- MEDITATION AREA
- SECURITY CABIN
- CHILDREN PICK-UP & DROP AREA
- EXIT GATE
- ENTRANCE GATE

DOUBLE HEIGHT ENTRANCE LOBBY
WITH CONCIERGE SERVICE AND BUSINESS CENTRE

9M Wide Internal Road



LOCATION MAP

Baner, Pune, Maharashtra



DISTANCES :

D-Mart	100 mtrs
Mumbai-Bangalore High-way	300 mtrs
Hinjewadi	3 Km
Aundh	5 Km
Pune University	7 Km
Senapati Bapat Road	7.5 Km
Deccan	10 Km
Railway Station	12 Km



An Initiative By

KUNDAN MEHTA
A S S O C I A T E S

EXCEEDING EXPECTATIONS

G. M. Kenjale Group is a name synonymous with Legacy, Quality, Trust and Commitment. All the exquisite residential and commercial projects the company has developed, reflect the same.

Kundan Mehta Associates is known for refined aesthetic vision and innovative thinking. The company has a new-age mindset that appeals the most to the sensible people with contemporary lifestyle.

With a common objective of building out-of-the-box creation, both these coveted brands have come together. And the upshot is in front of you. As enthralling and awe-inspiring like 'Emirus'.

CREDITS

ARCHITECT
ETHIQUE by Ar. Sanjeev Mehta
(Mumbai)
Ar. Jay Aeram

MEP
Architectural Energy Solutions (P) Ltd.

LEGAL
Adv. Surekha Kinkar

RCC
G.A Bhilare Consultants PVT. LTD

LANDSCAPE
Burt Hill & Stantec Pvt. Ltd.
(USA)

MARKETING
CBRE

BRAND
RJ Design Pvt. Ltd.

Site Office :
Sr. no. 107, Baner Road, Near D'Mart, Baner, Pune-411 045, Maharashtra, India.
Tel. : +91 8237 000041, 42, 43
Email : sales@emirus.in | admin@emirus.in | Website : www.emirus.in

Disclaimer: This brochure is conceptual in nature & is by no means a legal offering.
The promoters reserve the right to change, delete or add any specifications or plan mentioned herein.