



A GRAND
MASTERPIECE
IN THE MAKING.

Artist's Impression

A PROJECT BY



Adorning Mother Earth
ISO 9001:2015 CERTIFIED COMPANY

022 4893 4099

Site Off: Bhoomi Castle, Kalyan Shilphata Road, Opp Bhoomi Lawns, Daighar Gaon, Pin-421204 Email: info@gajragroup.co.in

Corp Off: Gajra Developers – 8 & 9, Shivji Market, Sector 19D, Vashi, Navi Mumbai, Behind Satra Plaza, Pin-400705 Tel: 022 4102 4102

Scan For More

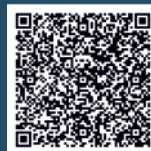

Disclaimer: Images / contents herein depict larger project "Bhoomi Castle", to be developed in several phases. Phase 1 of the larger Project is regd under MahaRERA Registration No: P51700054644 (Phase 1) available on <https://maharera.mahaonline.gov.in> under registered projects

STELLAR LOCATION,
UNFETTERED CONNECTIVITY,
A GRAND
VISION OF THE FUTURE.

Grandness is easy access to luxury.
Grandness is connectivity that takes you places. Grandness is a community of like minded people. Grandness is a living space that's not just about living, but living the extraordinary life.



INTRODUCING **SHIL JUNCTION:**

NOT JUST AN ADDRESS, BUT A PERFECT PIECE OF THE FUTURE.

You want something and you want it now. You are not willing to wait, patience is not your hallmark. We understand. Shil Junction offers modern living to the young, the restless and the ambitious. It's a junction where glorious present meets perfect future.

- **Upcoming Navi Mumbai International Airport**
A mere 45 minutes away, the new airport makes travelling to the airport a breeze.
- **Airoli Katai Tunnel Road**
Over 80% complete, this 6 lane road will directly connect you to Airoli's corporate hub.
- **Dombivli Station**
Pulsing with life, this Central Line is the heartbeat of city life.
- **Airoli Mindspace**
The largest business park in the Mumbai region spread over 50 acres.
- **Mahape Millennial Business Park**
One of the most popular IT park in Navi Mumbai.
- **Thane**
A city that stands at the junction of tradition and modernity
- **Multimodal Corridor**
Will connect you to Western Mumbai, Navi Mumbai International Airport and Mumbai Trans Harbour Link. Operational by 2030.
- **Mankoli-Mothagaon Bridge**
Convenient access to Thane and Mumbai, reach Thane in 20 minutes. Now partially open.
- **Kalyan Talaja Metro Line 12**
A 22 km line that will connect Navi Mumbai city and Kalyan Dombivali city. Operational by 2031.
- **Upcoming Mumbai Ahmedabad Bullet Train Station**
Reach BKC in a 10 minutes, or get to Ahmedabad in a few more. Operational by 2026.

SHIL JUNCTION: A GRAND EXPERIENCE AWAITS

Everything you need is a hop, skip and a jump away. From schools and colleges to malls, multiplexes and hospitals, everyday living and access to cutting-edge medical facilities is a breeze.



FASHION & ENTERTAINMENT

- Xperia Mall
- Dmart
- INOX
- PVR



HOSPITALS

- AIMS Hospital
- Neon Hospital
- Reliance Hospital
- Neptune Hospital
- Kalsekar Hospital



SCHOOLS

- Euro Kids Pre-school
- Pawar Public School
- Lodha World School



ALL THAT IS GRAND, ALL AT SHIL JUNCTION.





SHIL JUNCTION GETS A TASTE OF THE
GRAND

A GRAND

LIFESTYLE BROUGHT TO YOU BY BHOOMI CASTLE.

ROOFTOP

- Rooftop
- Terrace
- Open Chess
- Outdoor games
- BBQ Deck
- Swing deck
- Floor Ludo
- Outdoor movie screen
- Floor Tic Tac Toe
- Alfresco seating
- Party lawn
- Juice Bar
- Leisure Lawn
- Hammock

PODIUM

- Toddlers Area in Creche + outer extension
- Gamers Room
- Gym
- Yoga, art & Performance room
- Steam & Sauna
- Climbing wall
- Kids adventure area

GROUND

- Clock Tower
- Maze garden
- Swimming Pool
- Badminton, Tennis
- Cycle track
- Zen Garden
- Butterfly Alcove
- Pet Garden
- Reflexology
- Acupressure Path
- Flower Alcove

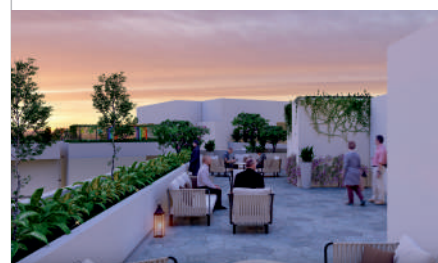
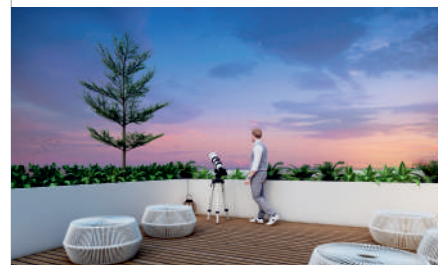
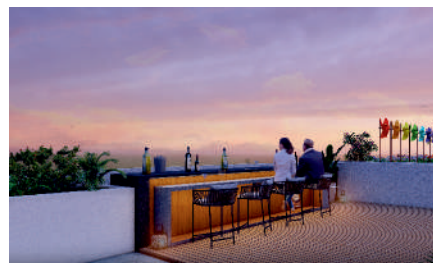
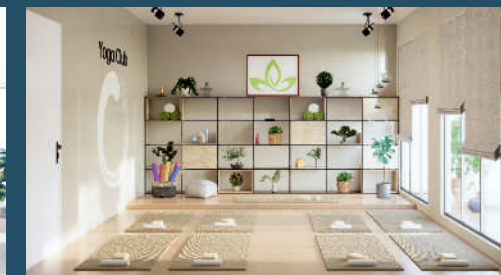

Bhoomi Castle is an expansive oasis in the prime location that is Shil Junction.

- 3.5 acres of luxurious living
- Palatial 1 & 2 bedroom apartments
- 32 storeys & 2 towers
- Vastu compliant apartments
- 6 flats per floor
- Deck in living room
- Podium parking
- Grand Lobby & open space between Apartments
- Mechanical car parking
- Uninterrupted view

Artist's Impression

Artist's Impression