

*High Standards
Of Living...*



SHREE PARADISE

MAHA RERA NO: P52100050527



**SHREE MAHALAKSHMI
ENTERPRISES**

RENDERING / 2 BHK APARTMENTS



SHREE MAHALAKSHMI
ENTERPRISES

1 BHK ▶

- A** Living
- B** Kitchen
- C** Bedroom
- D** Toilet's
- E** Bathroom
- F** Balcony
- G** Dry Balcony



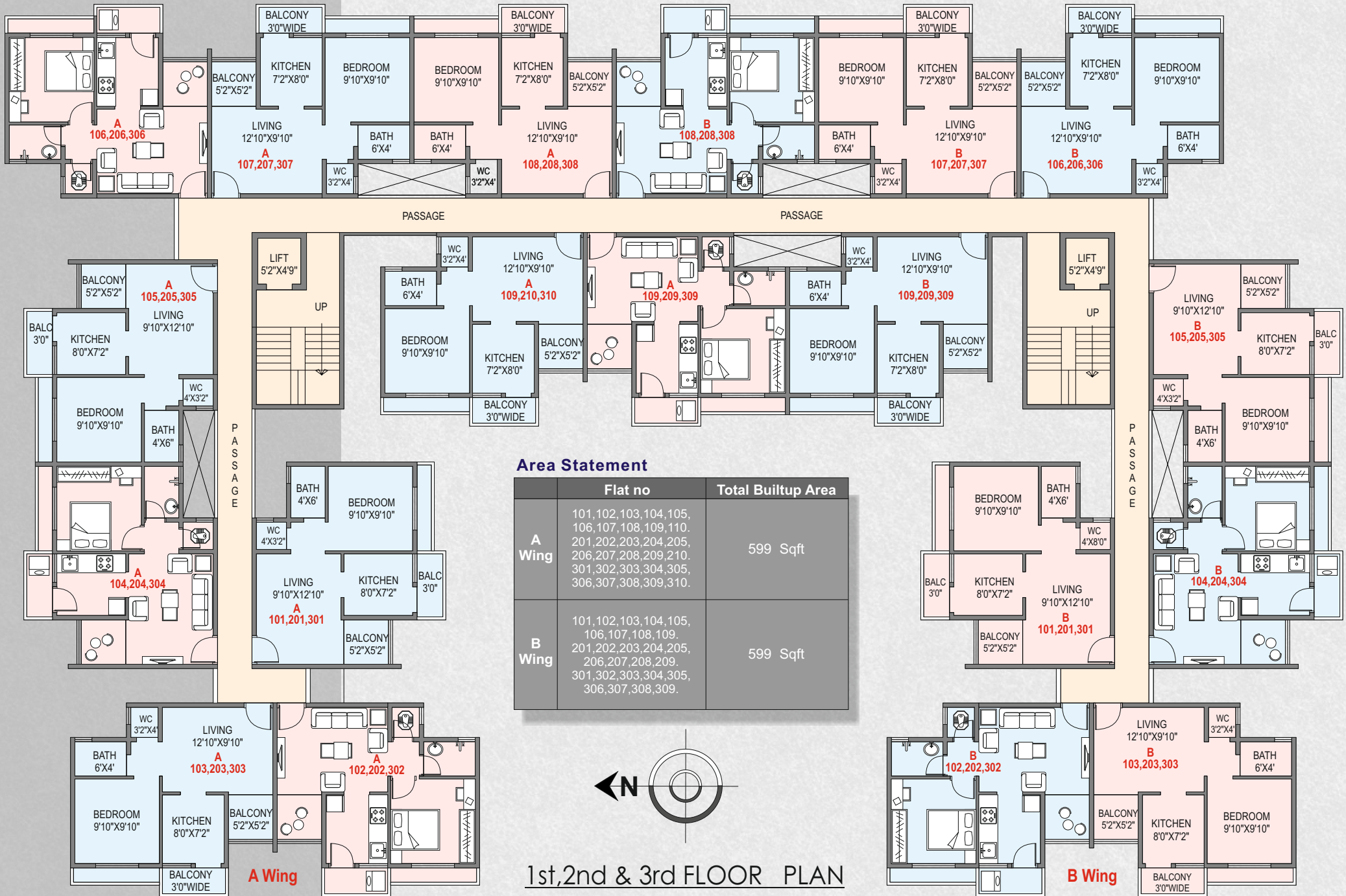

Area Statement

	Flat no	Total Builtup Area
A Wing	101,102,103,104,105,106,107,108,109,110,201,202,203,204,205,206,207,208,209,210,301,302,303,304,305,306,307,308,309,310.	599 Sqft
B Wing	101,102,103,104,105,106,107,108,109,201,202,203,204,205,206,207,208,209,301,302,303,304,305,306,307,308,309.	599 Sqft



1st,2nd & 3rd FLOOR PLAN

Location map

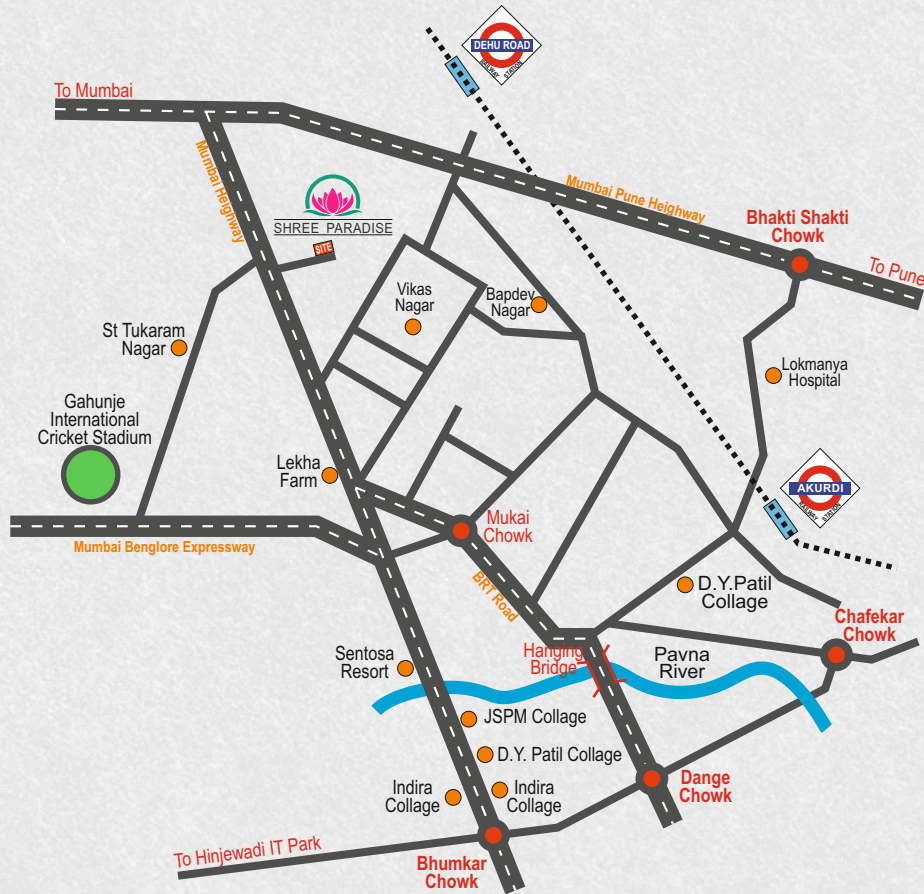

CLOSE PROXIMITY



Dehu Railway Station 10 Min



Birla Hospital 7/8 Km.



Symbiosis 3 Km



Old Mumb Expressway 1 Km



D - Mart 100 Meter



Shivaji College 1 to 2 Min.



Cricket Stadium 5 Km

Best of Specifications

PAINT:

Internal wall & ceiling plastic emulsion paint
External -waterproof apex paint

STRUCTURE:

Earthquake Resistant RCC framed Structure
Brick Masonery for Internal & External Walls
Gypsum Finish Internal Plaster & Sand Faced External Walls

TILING:

Elegance 2'0 x 2'0" Vitrified Flooring for all Rooms
Designer tiles dado for Bathroom & W/C
Rustic Finish Flooring for Balcony
& 4'0" Dado above Kitchen Platform
Granite Kitchen Platform with SS Sink

TOILETS:

All Concealed Plumbing with branded Sanitaryware & branded CP Fittings in Toilets

LIFT:

Lift with standard make & battery backup

DOORS:

Decorative Main Door with ply frame
All waterproof Flush Door shutter
Anti-rust hardware

ELECTRICAL:

Concealed ISI copper branded Wire for all internal wiring
Branded Switches for all internal switches
Sufficient points for all rooms with MCB
Water purifier provision
Electrical points for Fridge.

WINDOWS:

3 Tracks Aluminum Powder Coated window with Mosquito net
Exhaust fan provision for kitchen

SITE ADD: Sr.No. 35, Dehu Road, Next To Gurudwara, Katraj By Pass Kiwale, Pune -412 101.

Email : shreee104@gmail.com **Booking Contact:** 9420946622 / 9420949026 / 7208208649

CREDITS:

Architect
Nilesh saswade

Legal Advisor
ADV.Krushna Dabhole

R.C.C. Designer
MR MANE

