



MAHARERA Registration No.

Office: 101, J.K.Chamber, Sector-17, Vashi, Navi Mumbai. 400 703

PRAGATI PINNACLE

Building No 57, Near BMC School, Kanamwar Nagar 1, Vikhroli (East), Mumbai - 400083

Sale Contact: **9224353284 / 9833286107**

Project Approved by **LEADING BANKS & NBFC'S**

Architect: **Concept & Design, Vashi**
 Elevation Architect: **Dev Soni Architects**
 Legal Advisor: **S.C.Pai and Associates**
 Rcc Consultant: **Associated Structural Engineers LLP**

Option Print | 9933024919



PRAGATI ICON
BLDG. 33
GHATKOPAR (E), MUMBAI



PRAGATI REVANTA
BLDG. 48
GHATKOPAR (E), MUMBAI



PRAGATI EANZA
BLDG. 52
GHATKOPAR (E), MUMBAI



SIDDHIVINYAK ORCHID
BLDG. 59
GHATKOPAR (E), MUMBAI



PRAGATI IMPERIA
CHEMBUR



PRAGATI AURA
VIKHROLI



SHIVALIC
SECTOR-5
ULWE, NAVI MUMBAI



PRAGATI PARK
SECTOR-5
ULWE, NAVI MUMBAI



SHIVALIC HEIGHT
SECTOR-20
KALAMBOLI, NAVI MUMBAI



OM SHIVSAGAR
BLDG. NO. 17
TILAK NAGAR, MUMBAI

COMPLETED PROJECTS

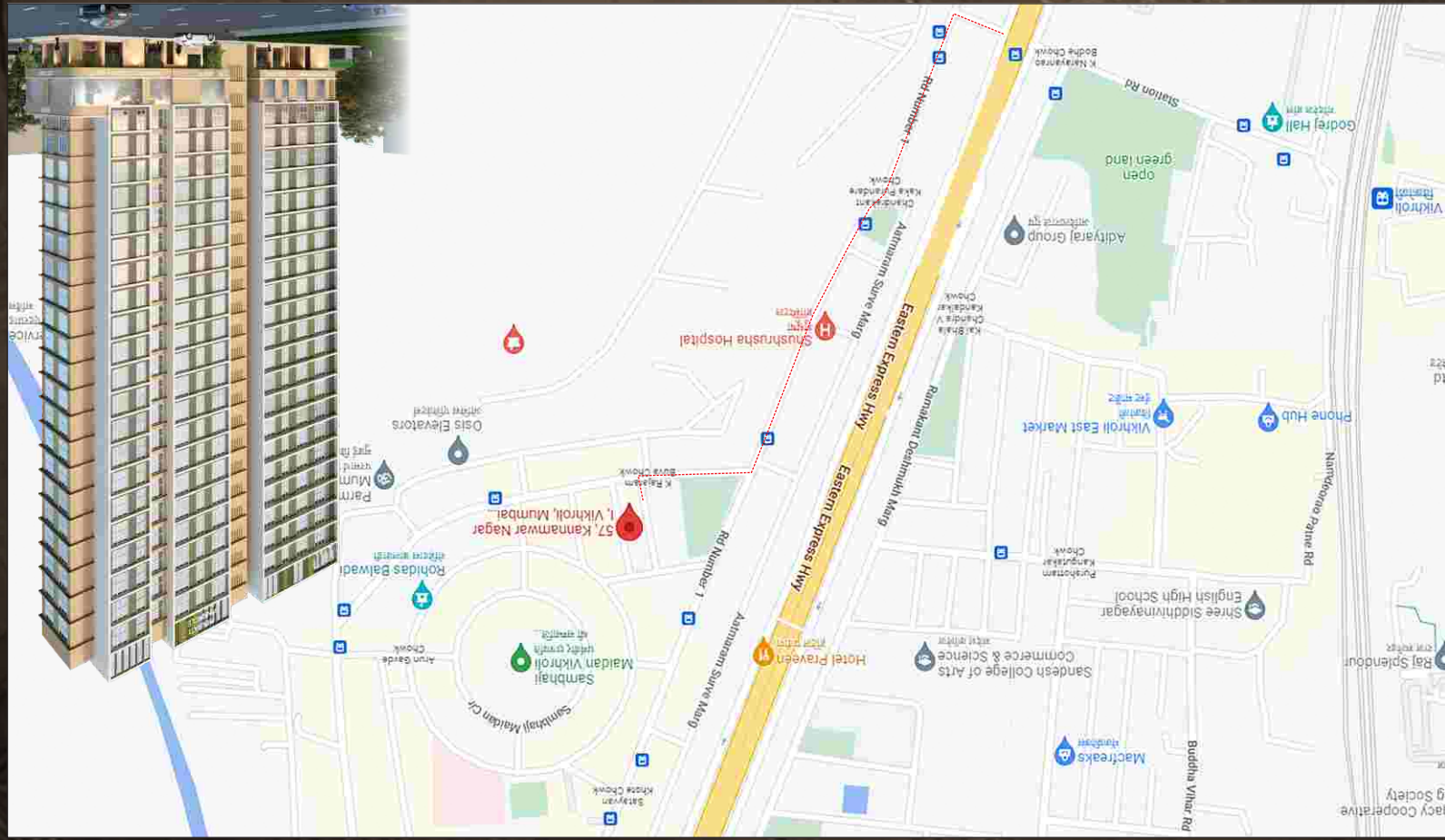

UPCOMING PROJECTS

Pragati Pinnacle



Note: The information in this brochure is indicative of the kind of development that is proposed. It is prepared and issued in good faith and is for guidance only. It does not constitute part of any offer or contract. It is subject to the approval from the respective authorities. In the interest of the continuing improvement of the project and or any changes as suggested by the authorities the Developers reserve the right to alter the Layout, Plans, Specifications, Amenities or features of the buildings without any prior notice or obligation to any buyers in the project. The photographs and the artists impressions in the brochure are for reference only. All the amenities provided subject to approval of MHADA, MCGM.



Pragati Pinnacle



Launching **PRAGATI PINNACLE**, an urban oasis located at Kannamwar Nagar – a covered address right at the heart of Vikhroli (E). A premium G+22 Floor Residential Cum Commercial tower offers luxury 1 & 2 Bed homes letting you enjoy the serene hues of majestic Vikhroli sky. Adorned with lifestyle amenities, it provides you endless avenues to play, relax and unwind. Offering 120 luxurious 1 & 2 Bed homes ranging from 400 to 628 sqft Rera Carpet Area, **PRAGATI PINNACLE** is here to fulfill your desire for a dream home.

PROJECT HIGHLIGHTS

- MAHARERA Approved Project
- G+22 Storey Tower (Proposed)
- Luxurious 1 & 2 BHK Apartments
- Quality Construction with Hightech and Modern Amenities
- Automated Car Parking Tower
- Loan available through leading Banks and Financial institutions

PROJECT SPECIFICATION

DOORS AND WINDOWS:

- Teak wood frame main door & bedroom (Laminate Sunmica)
- Waterproof hardener sheet doors to bath/wc toilet with all hardware fitting.
- Finished flush doors to all rooms with all hardware fitting including mortis lock, tower bolt, handle, door stopper etc.
- Granite door frame for toilets.
- Powder coated / Anodized aluminium sliding windows with Plain / tinted glass with all hardware fitting & fixture including locks.

FLOORING:

- Superior quality vitrified tiles (2',0" x 2',0").
- KITCHEN:**
 - Superior quality vitrified tiles.
 - Italic Marble, Indian Marble or Granite Kitchen Platform.
 - Branded Sink.
 - MGL Gas Connection for Cooking.
 - Exhaust Fan.
- TOILETS:**
 - Superior quality vitrified tiles.
 - Branded Geyser, Exhaust Fan & Handwash Basin.
 - Sanitary Fitting & Fixtures 1st quality.
 - Hot & Cold mixture / diverter including spout & shower.

LIFT:

- Total 2 Hightech lifts of reputed company (OTIS/KONE/SCHINDLER).
- FIRE SAFETY:**
 - Sprinkler system at common areas and in apartments.
 - Portable fire Extinguisher.

WALLS & PAINT:

- Gypsum finished internal walls.
- Plastic / Luster paint for all internal surfaces.
- Acrylic emulsion weather coat paint to all external surface.

ELECTRIC:

- High grade concealed copper wiring with MCB & ELCB.
- Adequate electric AC, TV, Internet, Telephone points.
- One broad band connection point in each flat.
- Modern designer switches.





TYPICAL FLOOR PLAN
 3RD to 7TH | 9TH to 14TH | 16TH to 22ND

FLAT NO.	TYPE	RERA CARPET
1	2 BHK	628 Sq. Ft.
2	1 BHK	442 Sq. Ft.
3	1 BHK	459 Sq. Ft.
4	2 BHK	585 Sq. Ft.
5	2 BHK	585 Sq. Ft.
6	1 BHK	400 Sq. Ft.

Note: The information is indicative of the kind of development that is proposed. It is prepared and issued in good faith and is for guidance only. It does not constitute part of any offer or contract. It is subject to the approval from the respective authorities. The photographs and the artist impressions in the brochure are for reference only. All the amenities provided subject to approval of MCGM.

TOWER FEATURES

- Designer Entrance Lobby Shall Be With Granite.
- Common Toilet for Watchman Cabin & Society Office.
- Uniform Decorative Common Name Plate & Metal Letter Boxes Provided for All Flats At Stilt Floor.
- Provision of Power Backup Generator for Society.
- New Decorative Compound Wall, Pillar / Gates.
- Terrace Garden, Seating Area, Yoga Deck & Jogging Track. Gymnasium at 2nd Floor provided.
- Fully Furnished society Office shall be provided.
- Rain Water Harvesting System.
- Fire – Fighting System.
- Intercom from Security desk to flat.
- 24/7 CCTV Camera Surveillance.
- Under ground and Overhead water tank with required capacity.
- Combination of Italic Marble, Indian Marble or Granite.
- Common Toilet for Watchman Cabin & Society Office.
- Uniform Decorative Common Name Plate & Metal Letter Boxes Provided for All Flats At Stilt Floor.
- Provision of Power Backup Generator for Society.
- New Decorative Compound Wall, Pillar / Gates.
- Trimix Coba at open ground.

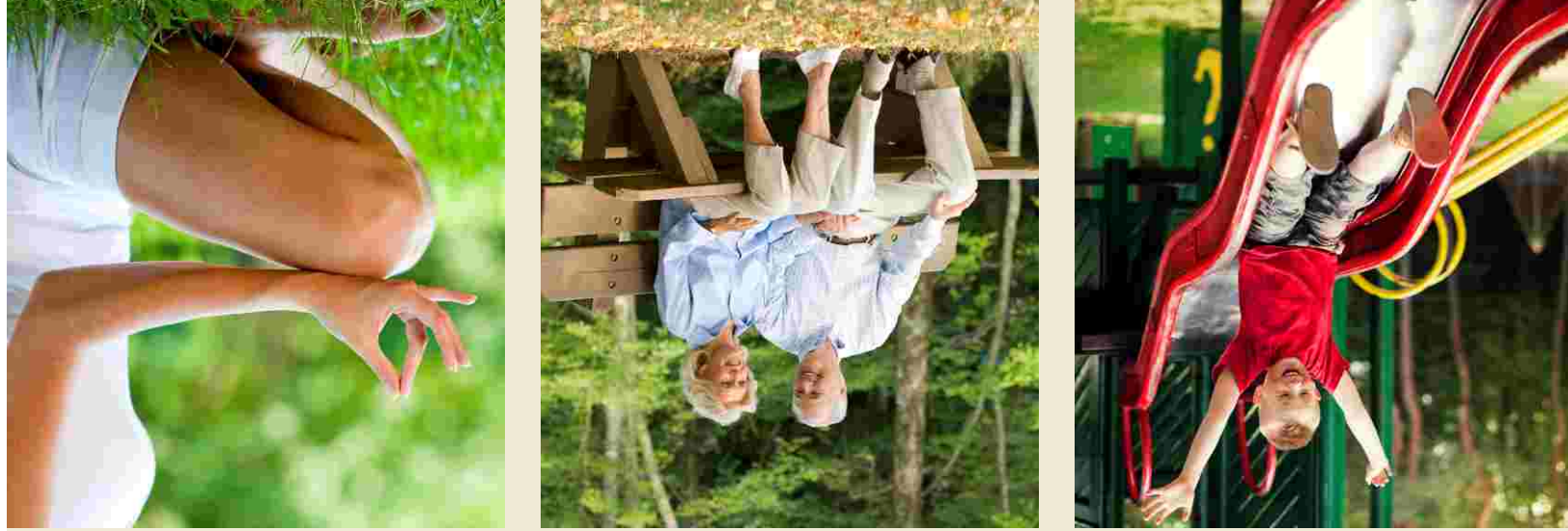

CONNECTIVITY

- HIGHWAY**
- Eastern Express Highway (0.5km).
- RAILWAY STATION**
- Vikhroli Railway Station (0.9km).
- AIRPORT**
- Terminal 1 Domestic (12.00km).
 - Terminal 2 International (10.00km).
- HOSPITAL**
- Shushrussha Hospital (0.5km).
 - Godrej Memorial Hospital (1.0km).
 - Ruby Hospital (0.5km).

- SCHOOLS**
- BMC School (1min).
 - Madhyamik Vidyalaya (2mins).
 - Abhay Intl. School (2mins).
 - Vikas High School & Jr. College.
- GARDENS**
- Priyadarshani Udyan.
 - Ramabai Thakre Garden.
 - Sambhajii Maidan Vikhroli.
- MALLS**
- R-City Mall (5.8 kms).
 - Phoenix Market City (8.5kms).

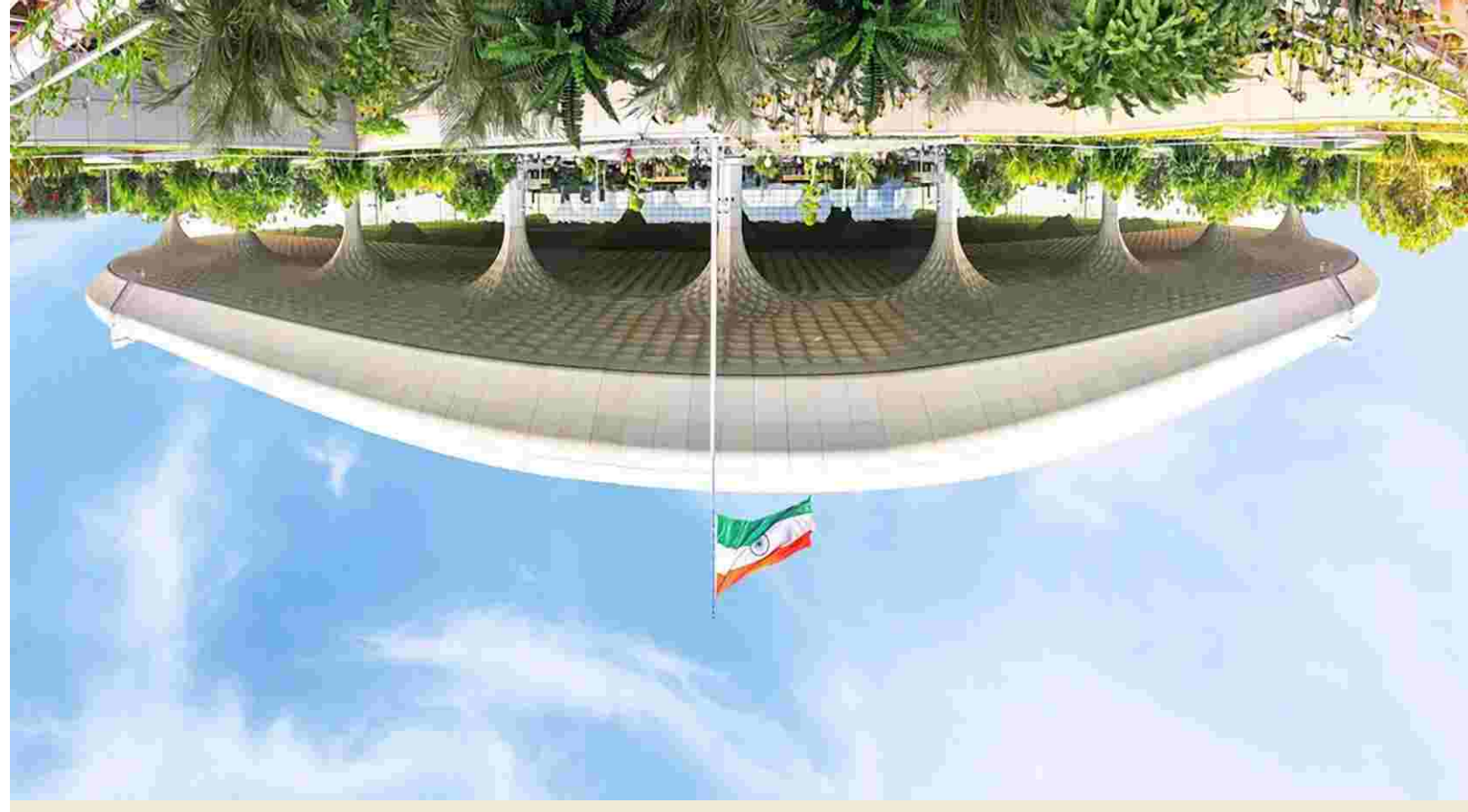
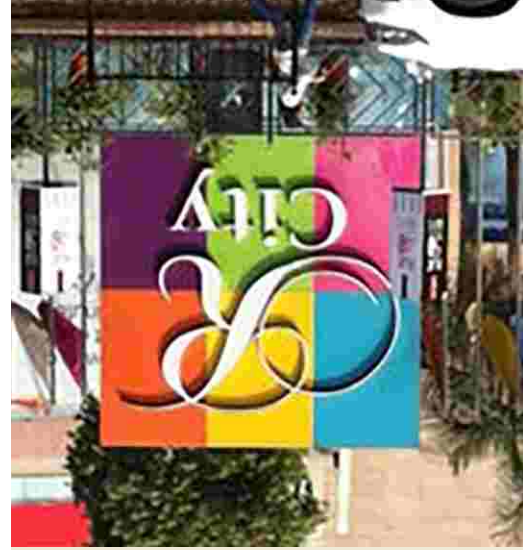
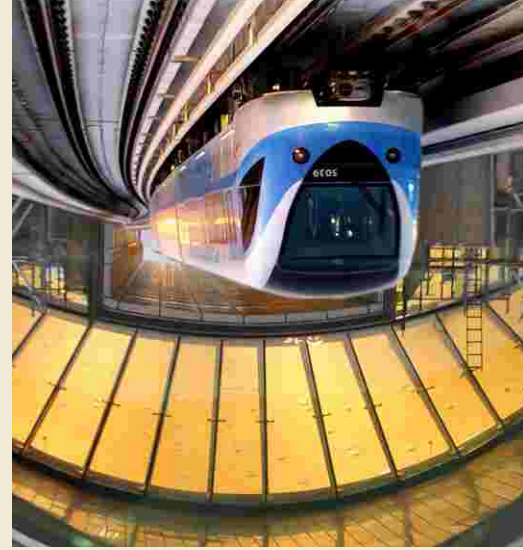

Pragati Pinnacle



PRAGATI
GROUP



Note: The information is indicative of the kind of development that is proposed. It is prepared and issued in good faith and is for guidance only. It does not constitute part of any offer or contract. It is subject to the approval from the respective authorities. The photographs and the artist impressions in the brochure are for reference only. All the amenities provided subject to approval of MCGM.



ISOMETRIC VIEW
1BHK & 2BHK



GROUND FLOOR PLAN

SHOP NO.	RERA CARPET
1	130 Sq. Ft.
2	91 Sq. Ft.
3	273 Sq. Ft.
4	146 Sq. Ft.
5	176 Sq. Ft.

SHOP NO.	RERA CARPET
6	1155 Sq. Ft.
7	1035 Sq. Ft.
8	163 Sq. Ft.
9	124 Sq. Ft.

12.20 M. WIDE EXISTING LAYOUT ROAD

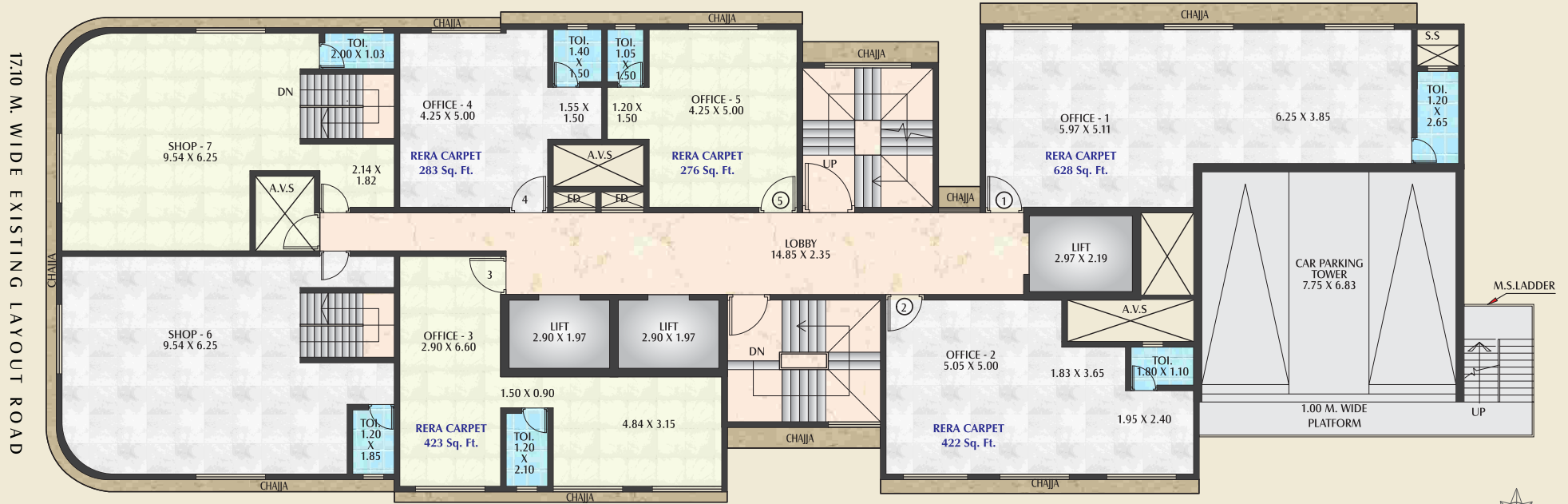

12.20 M. WIDE EXISTING LAYOUT ROAD

1ST FLOOR PLAN

OFFICE NO.	RERA CARPET
1	628 Sq. Ft.
2	422 Sq. Ft.
3	423 Sq. Ft.
4	283 Sq. Ft.
5	276 Sq. Ft.

