



Where Nature Blooms.





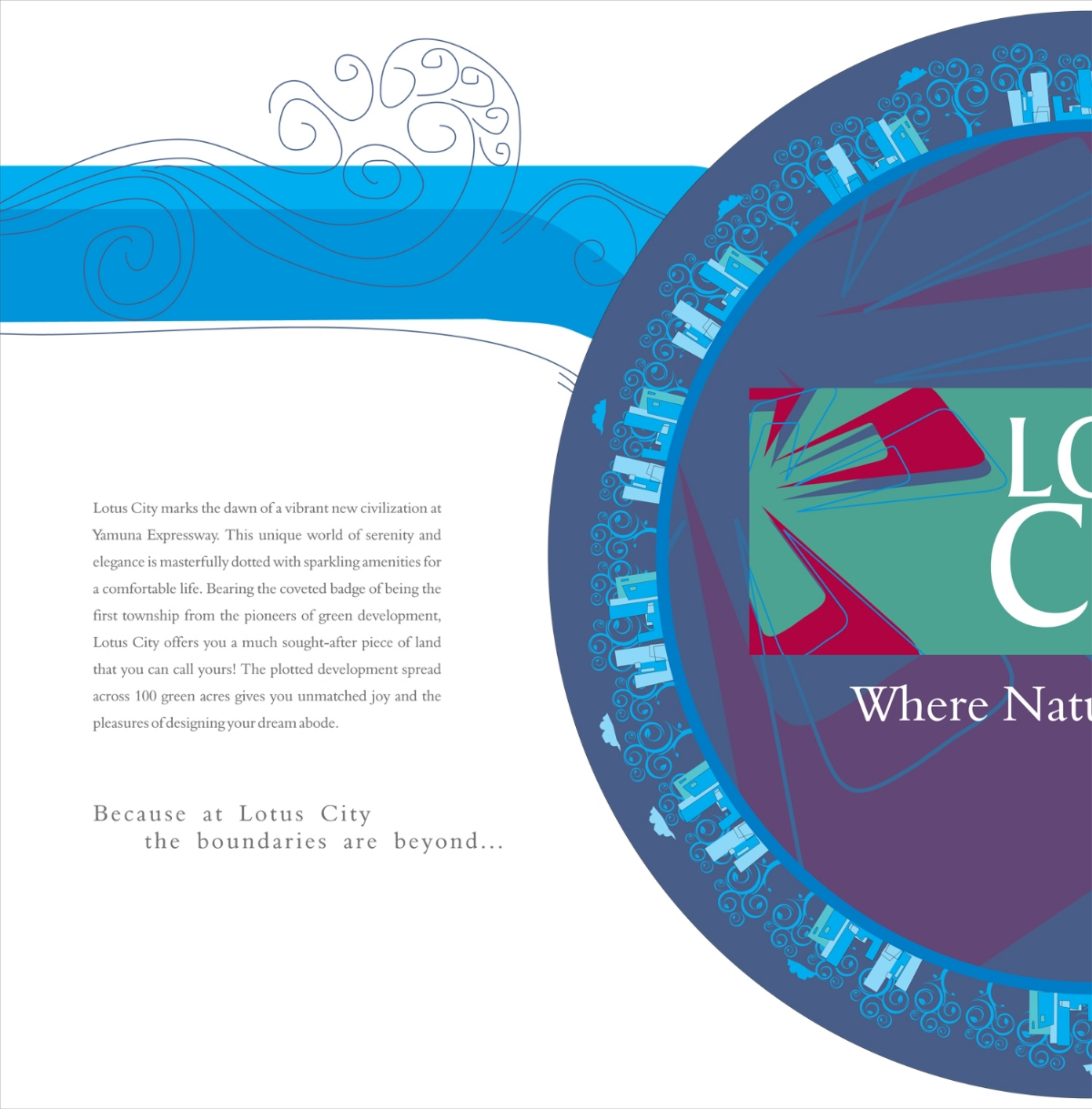

A decorative graphic on the right side of the page. It features a large, dark blue circular shape containing a stylized city skyline with various buildings and trees. The skyline is rendered in shades of blue and green. To the left of this circle, there are blue wavy lines representing water or clouds, with intricate white line art patterns above them. The overall design is modern and artistic.

Lotus City marks the dawn of a vibrant new civilization at Yamuna Expressway. This unique world of serenity and elegance is masterfully dotted with sparkling amenities for a comfortable life. Bearing the coveted badge of being the first township from the pioneers of green development, Lotus City offers you a much sought-after piece of land that you can call yours! The plotted development spread across 100 green acres gives you unmatched joy and the pleasures of designing your dream abode.

Because at Lotus City  
the boundaries are beyond...

LO  
C

Where Nat





# LOTUS CITY

are Blooms.

Where a congenial lifestyle  
leads to cherished moments...



When you have an address like Lotus City, you know you are privileged. And the reasons are aplenty - two Expressways offering seamless connectivity, a formula one track just across the street, the adventures of night safari round the corner, an international airport to bring you closer to the world, a renowned university to introduce you to the world of unlimited wisdom just about a mile!

Adorning the Yamuna Expressway, Lotus City is also close to the DND flyway, knitted to the National Capital by a few short miles. With all the luxuries of life in close proximity, Lotus City offers a lot more than you could ever imagine





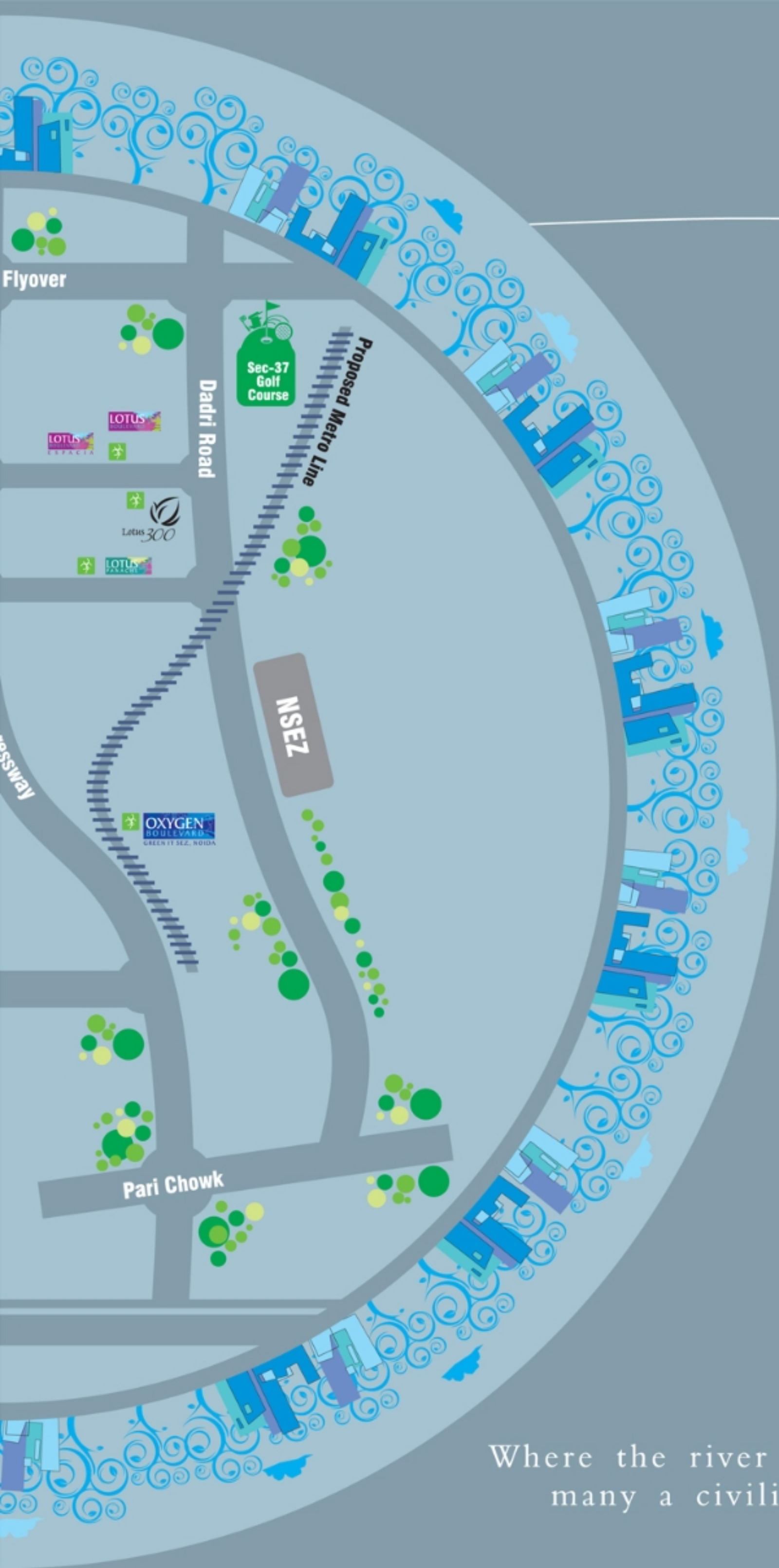

Where the river that housed  
many a civilization welcomes you to dwell...



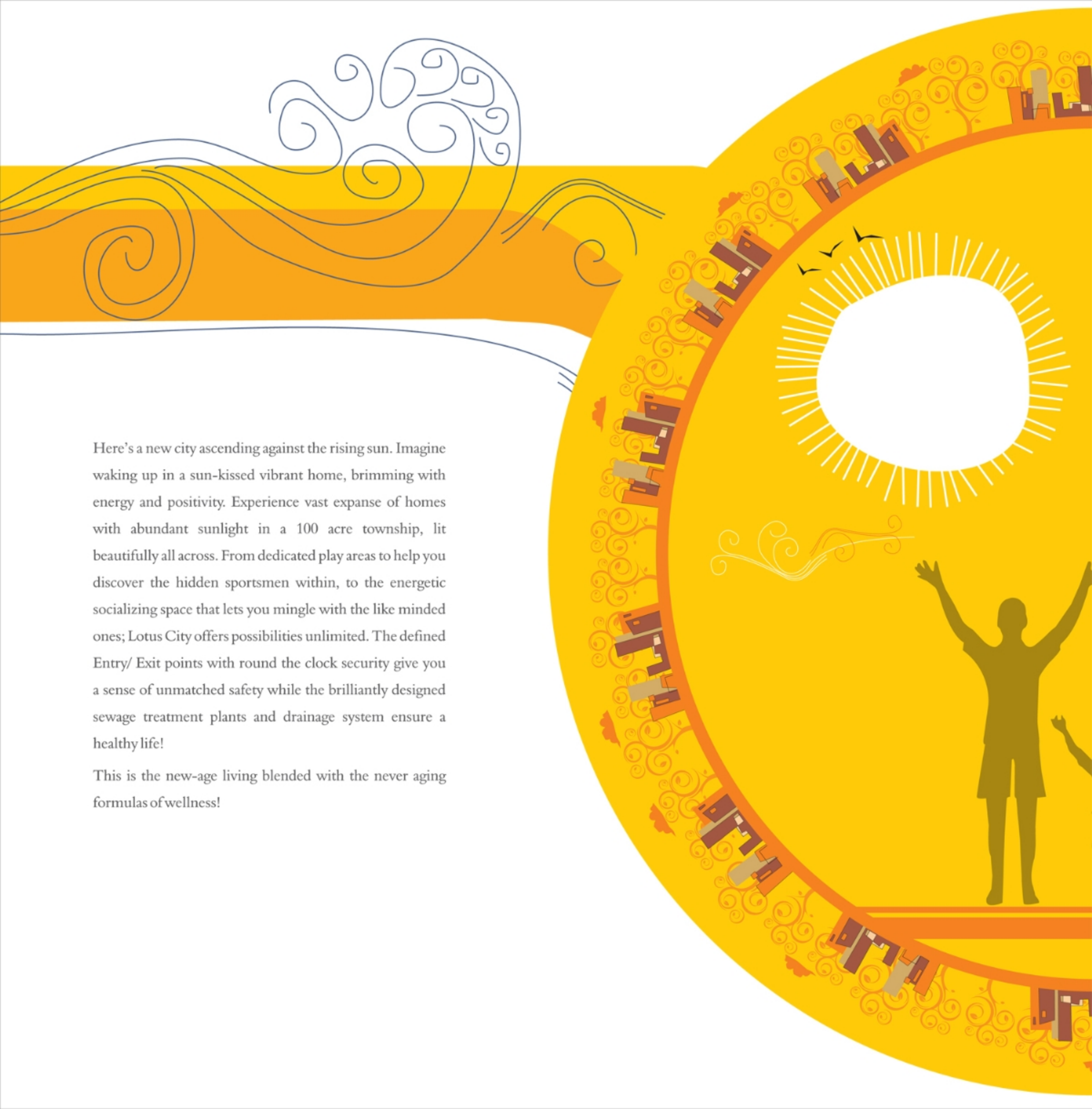

Here's a new city ascending against the rising sun. Imagine waking up in a sun-kissed vibrant home, brimming with energy and positivity. Experience vast expanse of homes with abundant sunlight in a 100 acre township, lit beautifully all across. From dedicated play areas to help you discover the hidden sportsmen within, to the energetic socializing space that lets you mingle with the like minded ones; Lotus City offers possibilities unlimited. The defined Entry/ Exit points with round the clock security give you a sense of unmatched safety while the brilliantly designed sewage treatment plants and drainage system ensure a healthy life!

This is the new-age living blended with the never aging formulas of wellness!





Where the glorious sunshine befriends  
happiness for your wellness...



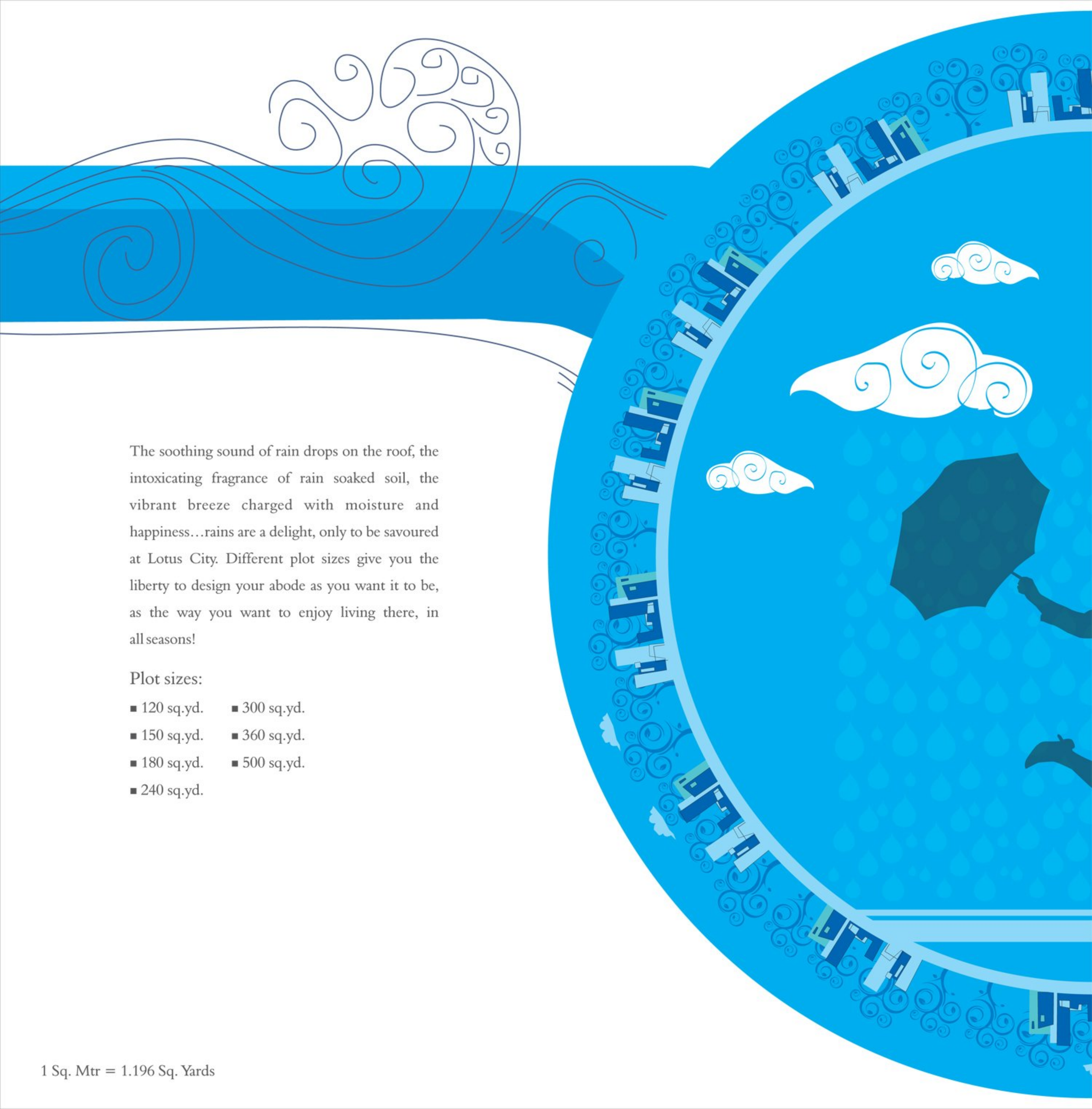

The soothing sound of rain drops on the roof, the intoxicating fragrance of rain soaked soil, the vibrant breeze charged with moisture and happiness...rains are a delight, only to be savoured at Lotus City. Different plot sizes give you the liberty to design your abode as you want it to be, as the way you want to enjoy living there, in all seasons!

Plot sizes:

- 120 sq.yd.
- 150 sq.yd.
- 180 sq.yd.
- 240 sq.yd.
- 300 sq.yd.
- 360 sq.yd.
- 500 sq.yd.





Where the playful rain drenches nostalgia  
to attain a soulful enlightenment...



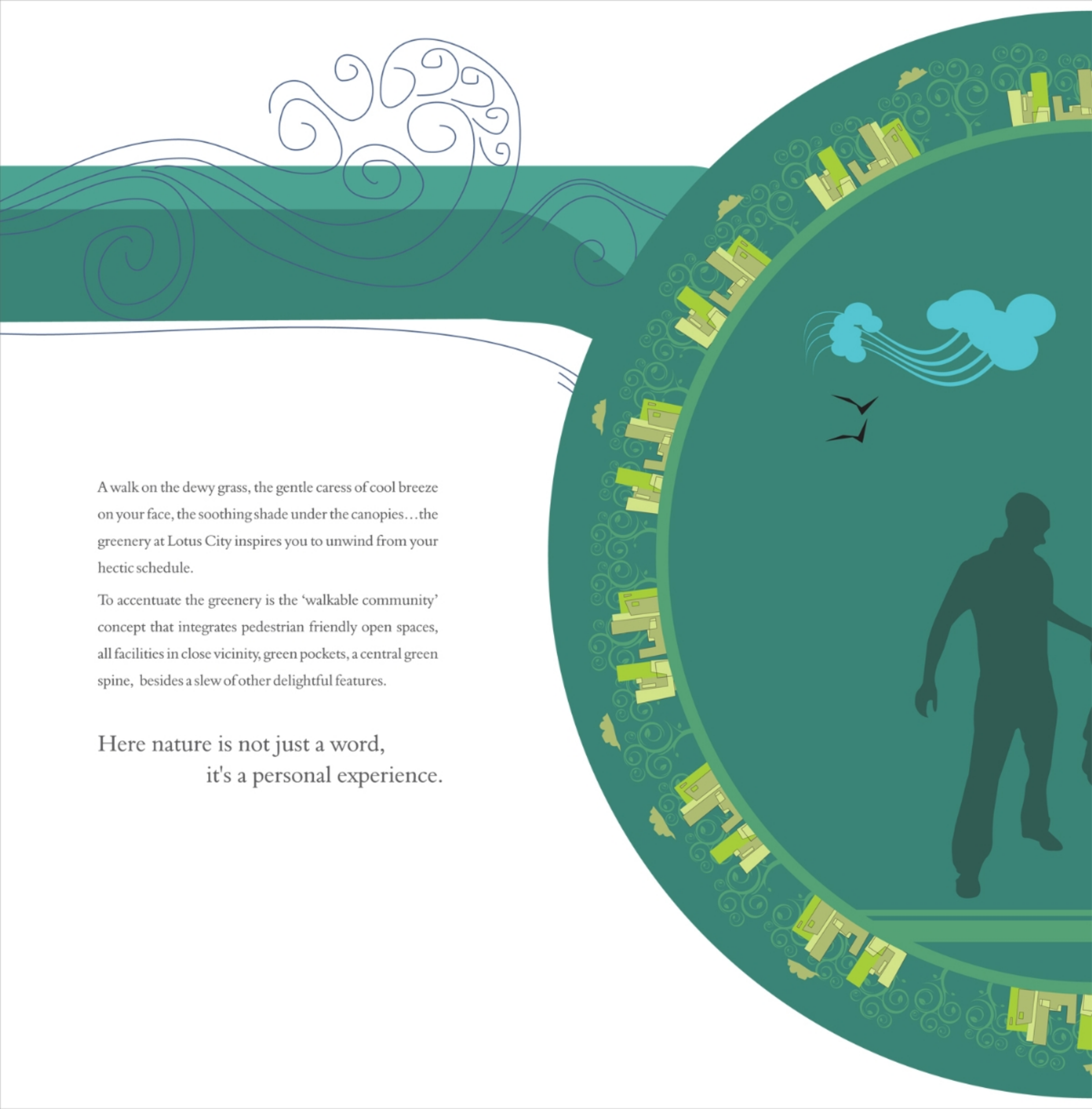

A walk on the dewy grass, the gentle caress of cool breeze on your face, the soothing shade under the canopies...the greenery at Lotus City inspires you to unwind from your hectic schedule.

To accentuate the greenery is the 'walkable community' concept that integrates pedestrian friendly open spaces, all facilities in close vicinity, green pockets, a central green spine, besides a slew of other delightful features.

Here nature is not just a word,  
it's a personal experience.





Where the cool breeze sweeps in  
freshness to offer a life of fulfillment...

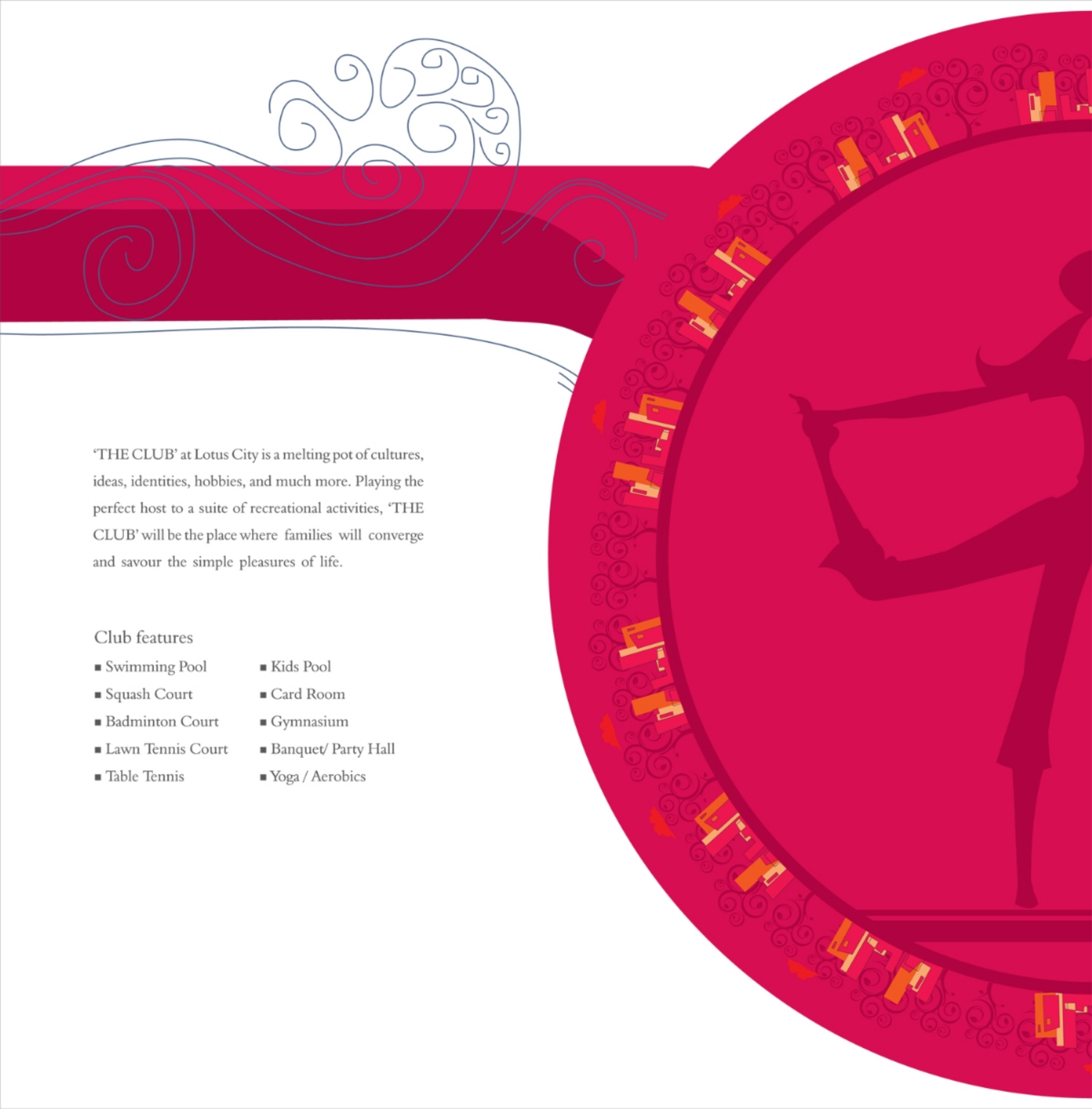

'THE CLUB' at Lotus City is a melting pot of cultures, ideas, identities, hobbies, and much more. Playing the perfect host to a suite of recreational activities, 'THE CLUB' will be the place where families will converge and savour the simple pleasures of life.

#### Club features

- Swimming Pool
- Squash Court
- Badminton Court
- Lawn Tennis Court
- Table Tennis
- Kids Pool
- Card Room
- Gymnasium
- Banquet/ Party Hall
- Yoga / Aerobics





Where kindred minds converge  
to create an amiable community...





As the face of Noida in the global real estate arena, The 3C Company's holistic perspective as a developer balances the growth of NCR while respecting the heritage, traditional values and above all, the nature. Each project of The 3C Company is developed from the cornerstone of fostering economical but ecologically sustainable growth.

The accolade of being the sole squad in the entire Asia Pacific with THREE PLATINUM & FOUR GOLD RATED LEED certified Green Buildings by the USGBC (U.S. Green Building Council), does not only testifies the impeccable architectural excellence of The 3C Company but also echoes its concern for the environment.

With the vision to provide opportunities of healthy living, the company launched 5 green residential projects in Noida. All of these projects received overwhelming response and have played an instrumental role in bringing about a paradigm shift in the entire real estate sphere.

The company has excelled and achieved milestones by having already delivered more than 13 million square feet of niche developments.







Where ambitious ideas seamlessly  
transform into dynamic reality...

PLATINUM RATED LEED CERTIFIED GREEN BUILDINGS: Wipro Technologies, Gurgaon; Pami Knowledge Centre, Noida; Green Boulevard, Noida; GOLD RATED LEED CERTIFIED GREEN BUILDINGS: Wipro Technologies, Greater Noida; Spectral Services, Hyderabad; OTHER PROJECTS: Lotus Boulevard, Noida; Lotus











Three C Universal Developers Pvt. Ltd.  
Tech Boulevard, Central Block, Plot No. 6, Sector 127, Noida (U.P.) 201301. Tel: +91-120-476 6414, Fax: +91-120-476 6415  
Site Address: Plot No. TS-01, Sector 22A, Yamuna Expressway, Noida (U.P.). Email: sales@the3c.in, Website: www.lotuscity.in, www.the3c.in