

**SUITABLE HOME
IN EVERY ASPECT**



HOMES THAT ARE INSPIRED BY YOUR DREAMS

Sri Vigneshwara Infra, is a combination of combined generations and trends on the horizon of Residential Home Building Constructions delivery. We, having more than 3 decades of experience in the field of construction and are responsible for delivering number of happy homes to our customers including - Housing Plots, Villas and Apartments, now emerged as one entity to serve the needy homes most desperate but in their budget.

As per our research on Hyderabad's Real Estate growth corridors, taking into the

consideration of livable, affordable, approachable concerns - we found this location as an opt and offering valuable home units to suit to your budget. When we say home, it means peace of mind. It means to have a wonderful quality time spend with your loved ones.

We at, Sri Vigneshwara Infra is committed to quality and perfection and ensures customer satisfaction. We bring happiness and comfort with our honest and transparency relationship in our every deal.



UPGRADE TO A LIFESTYLE. YET AFFORDABLE.

SREE VISTA

SreeVista is the project brought to you by Sri Vigneshwara Infra. SreeVista is a project that strategically located and make available to the community of middle and upper middle class, who desires privacy and approachable at the same time.

Privacy by location, yet approachable to most of the IT Corridors. Our main goal is to make our customer comfortable and convenience.

SreeVista is spread in 2 Acres of land with two blocks. Each block contains 85 living spaces of 2&3 BHK in different sizes and only East & West facing. You will have a vast choice to choose according to your budget. Each unit is designed as

individual units with no common walls and allows you with a full breath. The sizes ranging from 1100 sft to upto 1700 sft .

SreeVista provides every need of a person to have in his lifetime. The project is located at Patancheru near ORR, between Exits - 3 & 4. SreeVista is surrounded by well developed colonies, gated communities and educational institutions.

SreeVista is equipped with 5 high-speed lifts, 3 grand entrance plazas, spacious parking, play areas and abundant water supply.





F.NOs	AREAS
1	1175
2	1375
3	1175
4	1170
5	1500
6	1500
7	1500
8	1100
9	1125
10	1125
11	1115
12	1500
13	1500
14	1555
15	1500
16	1550
17	1965



TYPICAL FLOOR PLANS - BLOCK-B

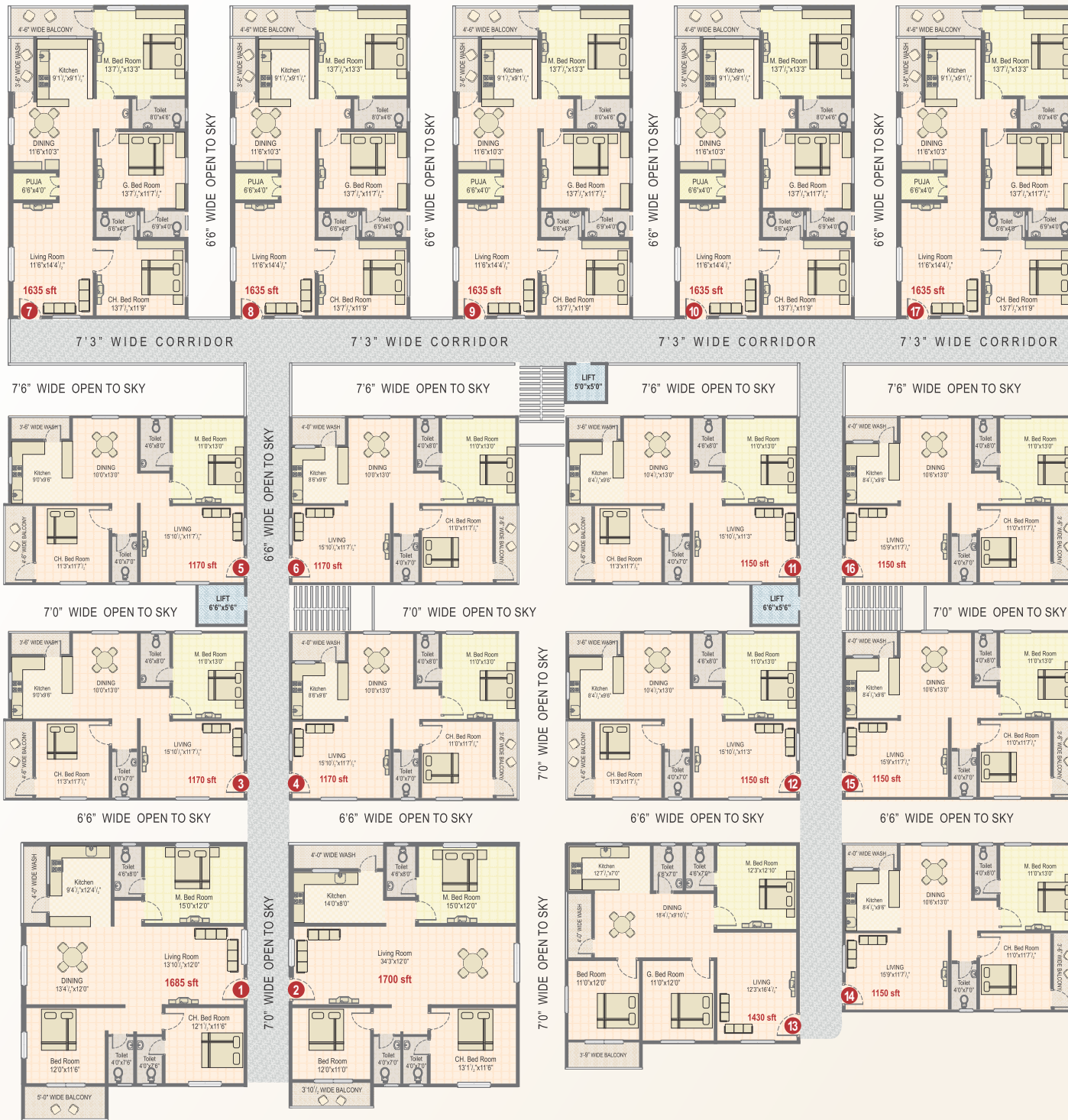

F.NOs	AREAS
1	1685
2	1700
3	1170
4	1170
5	1170
6	1170
7	1635
8	1635
9	1635
10	1635
11	1150
12	1150
13	1450
14	1150
15	1150
16	1150
17	1635





KINDLE UP EVERY MOMENT
OF YOUR LIFE HERE.

EACH FLAT
DESIGNED TO
ALLOW FLOW OF
FRESH BREEZE
AND BRIGHT
SUNSHINE

SALIENT FEATURES:

- 3 Grand Entrance Plazas
- Water Body
- Kids Play Area
- Gymnasium
- 5 Hi-speed Lifts
- Sewerage Treatment Plant
- Electric Vehicle Charging Station
- Designer Landscapes
- Solar Fencing
- Rain Harvesting Pits
- Common Toilets for Maids/Drivers
- Generator Back-up
- Multi purpose for Convenience Store
- Round the clock Security System

LOCATION ADVANTAGES

- 5 mins from Patancheru Bus Stand
- 5 min from Medical Devices Park
- 8 mins from Exit-03 Patancheru ORR and Exit-04 Sulthanpur ORR
- 15 mins from BHEL and Nallagandla
- 25 mins from All International Schools
- 30 min from Miyapur Metro Station
- 45 min from Airport

SPECIFICATIONS

STRUCTURE

Super Structure: RCC framed structure as per design by licensed structural engineers.

Walls: 9' Red bricks for External wall and 4' Red bricks for Internal walls

PLASTERING

Internal: Double coat cement plaster with smooth finish

External: Two coats of cement plastering with sponge finish

Drainage: PVC pipes with sudhakar or equivalent brands.

Water Supply: CPVC / UPVC pipes with sudhakar or equivalent brands.

LIFTS:

5lifts with 6Passenger capacity

GENERATOR:

Emergency power supply for common areas and services.

DOORS WINDOWS

Main Door Frame: Indian Teak Wood, P.U Polished with Beadings.

Main Door Shutter: Solid hardwood flush door shutters

Internal Door Frame: Kiln dried Teak Wood, P.U Polished with Beadings.

Internal Door Shutter: laminated flushed door.

Windows: UPVC windows of reputed make with mosquito mesh track provision.

PAINTING

Exterior: Weather coat emulsion paint on Texture of Berger or equivalent brand.

Interior: Smooth finish with putty , over a coat of primer and finished with 2 coats of Berger or equivalent brand.

FLOORING

Entire House: 2X2 double charged verified times throughout the house.

Stairs & Landing: Granite

Kitchen: Premier quality granite platform & glazed ceramic dado tiles up to 2'

Corridors: Anti-skid vitrified tiles.

BATHROOMS

- Single piece EWC (Hindware or equivalent)
- Wall mounted hot & cold wall mixture with shower (CERA or equivalent).
- Provision for geyser.
- Bathroom wall tiles (AGL or equivalent brand) up to lintels height
- Ceramic anti-skid flooring (AGL or equivalent brand)
- ALL CP fittings by CERA or equivalent brand

ELECTRICAL

- Finolex/Havells or equivalent brand, concealed copper wiring.
- Elegant modular electrical switches by MARU or equivalent brand.
- Anchor or equivalent brand MCBs & Distribution boards.
- Provision for AC in halls and bedrooms.
- Provision for geyser in all bathrooms.
- Provision for cable TV in living room and bedroom.
- Provision for Internet.

- OPEN AUDITORIUM
- GUEST ROOMS
- MULTIPLE PURPOSE STORES
- INDOOR GAMES
- GYMNASIUM
- CHILDREN PLAY AREA

AMENITIES

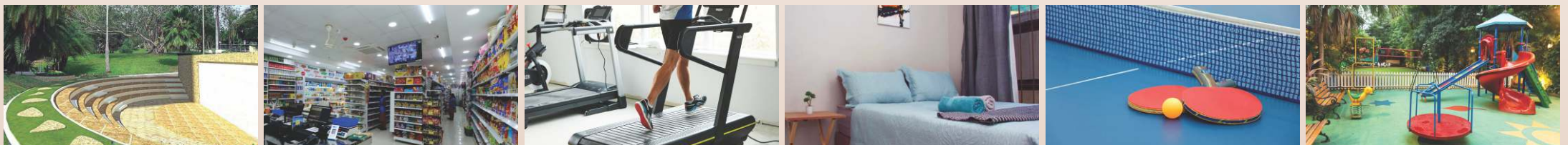



9-34/4 Rice Mill Road, Muthangi Village, Patancheru
Mandal, Sangareddy District, Telangana

sales@sv-infra.in

www.sv-infra.in

SREE VISTA

Affordable Deluxe Apartments @ Patancheru

SCAN TO VIEW THE
LOCATION



Note: This brochure is only a conceptual presentation of the project and not a legal offering. The promoters reserve the right to make changes in elevations, plans and specifications as deemed fit.