



MEADOWS

# Better, by NATURE



RERA NO.: PRM/KA/RERA/1251/446/PR/141022/005322

## PROJECT PHILOSOPHY

### The Grass Is Greener At Meadows

Greenfinch Meadows was conceptualised and designed keeping the needs of the new-age millennial in mind. From choosing the perfect location that leaves you with more time for the people you love, to bringing together amenities that are actually functional and allow you to explore your passions.

Meadows was curated not to cater to the people, but to a mindset. This premium lifestyle apartment project envisions a tightly-knit community of like-minded individuals, where happiness and tranquillity prevail.

That's what makes us Better, By Nature.

## PROJECT OVERVIEW

### A Glimpse Into Your Future

Greenfinch Meadows is spread over an area of 7891 square metres. Hosting just 181 apartments means the project has vast open spaces that allow you to forget the concrete jungle and reconnect with nature.

#### What You Should Know:

- Total Built-up Area - 18000 sq. mt.  
Structure - Basement + Ground + 13 Floors
- Plan Sanction No. :  
BBMP/Addl.Dir/JDNORTH/0076/21-22
- RERA Reg. No. : PRM/KA/RERA/1251/446/PR/141022/005322
- Total No. of Units - 181 Apartments
- 2 Bed Apartments  
(1116 sq. ft. – 1135 sq. ft.) - 155
- 3 Bed Apartments (1435 sq. ft.) - 26

### Designed For You

Whether you're someone looking at starting a family or someone finding a better home for your loved ones, we've got just the space for you at Greenfinch Meadows. With apartments ranging from 1116 square feet and going up to 1435 square feet, you can find the perfect space to call your own.

Our 2 and 3 BHK apartments have been thoughtfully designed to make living a luxurious lifestyle a reality. From maximising the carpet area on offer and smartly designing spaces to give you access to balconies, each and every apartment at Meadows has something to look forward to.

## Make Time For The Things You Love

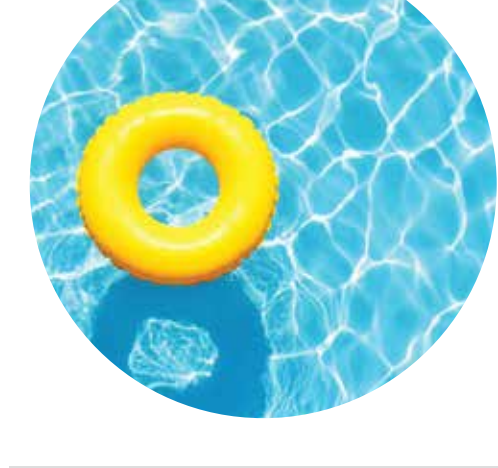

Swimming Pool



Kids Pool



Cricket Nets with Bowling Machine



Sauna & Steam Rooms



Lawn Tennis Court



100 Capacity Multipurpose Hall



Kids Play Area & Creche



Escape Clubhouse



Reception Lounge



Fully equipped Gym

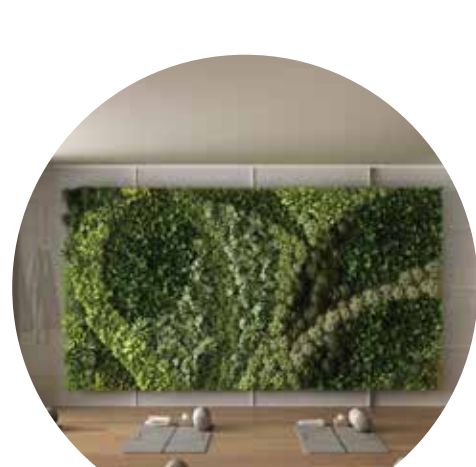

Yoga & Meditation Deck



Indoor Games

## Welcome to Escape The Clubhouse At Meadows

Escape is a space for the Meadows community to get together and forge bonds that'll last a lifetime. Equipped with some of the finest amenities you'll find and designed to elevate your well-being, Escape is one of the most incredible spaces at The Meadows.



Whether you're planning on ringing in your anniversary at our multipurpose hall or stacking the rack against your neighbour over a gentlemen's game of Billiards, there's so much to do at Escape.

You can even leave the kids behind at the creche or with some board games, as you get that workout you've been skipping or a session at the steam rooms you've been craving for. The avenues are endless.





# Jump In And Make Some Waves

Is there a better feeling than wrapping the little ones in an oversized towel and heading for a dip in your very own pool? This could be your Sunday morning at Greenfinch Meadows. With separate pools for kids and adults, you can rest assured that your children are safe as you count your laps or simply float in a state of bliss.

## A Sense Of Belonging With Your Tribe

We are all social creatures who love the company of other individuals, who share a similar set of ideals and belief systems. With the city's biggest tech parks in close proximity to our project, Meadows has already piqued the interest of many young couples who see it as an ideal destination to raise their families in a space that offers them everything they need along with the company of folks who are at a similar life-stage as themselves.



## LOCATIONAL ADVANTAGES

### About Kadubeesanahalli

- Well connected to the nearby suburbs of Marathahalli and Bellandur.
- Kadubeesanahalli is part of the tech corridor.
- A good mix of commercial and residential infrastructure.
- Easy access to parks, gardens, schools and banks.

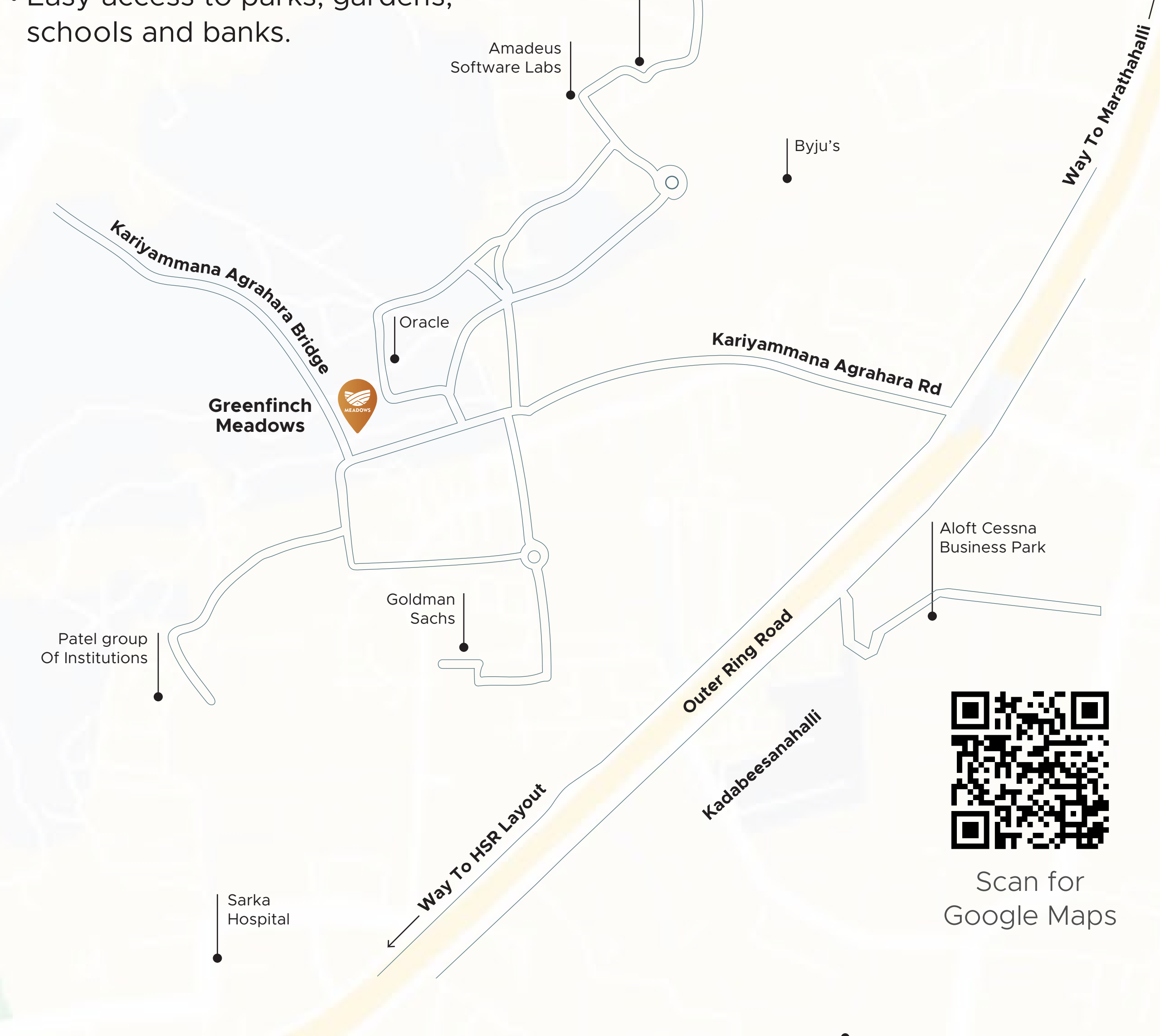

### What's Great?

Excellent connectivity to other suburbs of Bangalore.

### Watch Out For?

- Rapidly growing IT sectors.
- Developmental focus on the tech corridor by government authorities.
- Excellent road connectivity with the establishment of links to outer ring roads.

### Property Price Rising Factor

#### Short Term

Kadubeesanahalli has excellent connectivity to well developed areas like Whitefield, Brookefield, koramangala, etc. A good mix of commercial and residential projects.

#### Long Term

Majority of people living in and around Kadubeesanahalli work in the booming IT industry. With close proximity to the tech corridor, it has seen a huge number of employees and families move in closer to work. Additionally, government authorities have also shifted their focus toward the regions' development. The near future will see state-of-the-art infrastructure and exceptional road connectivity to enable seamless travel.

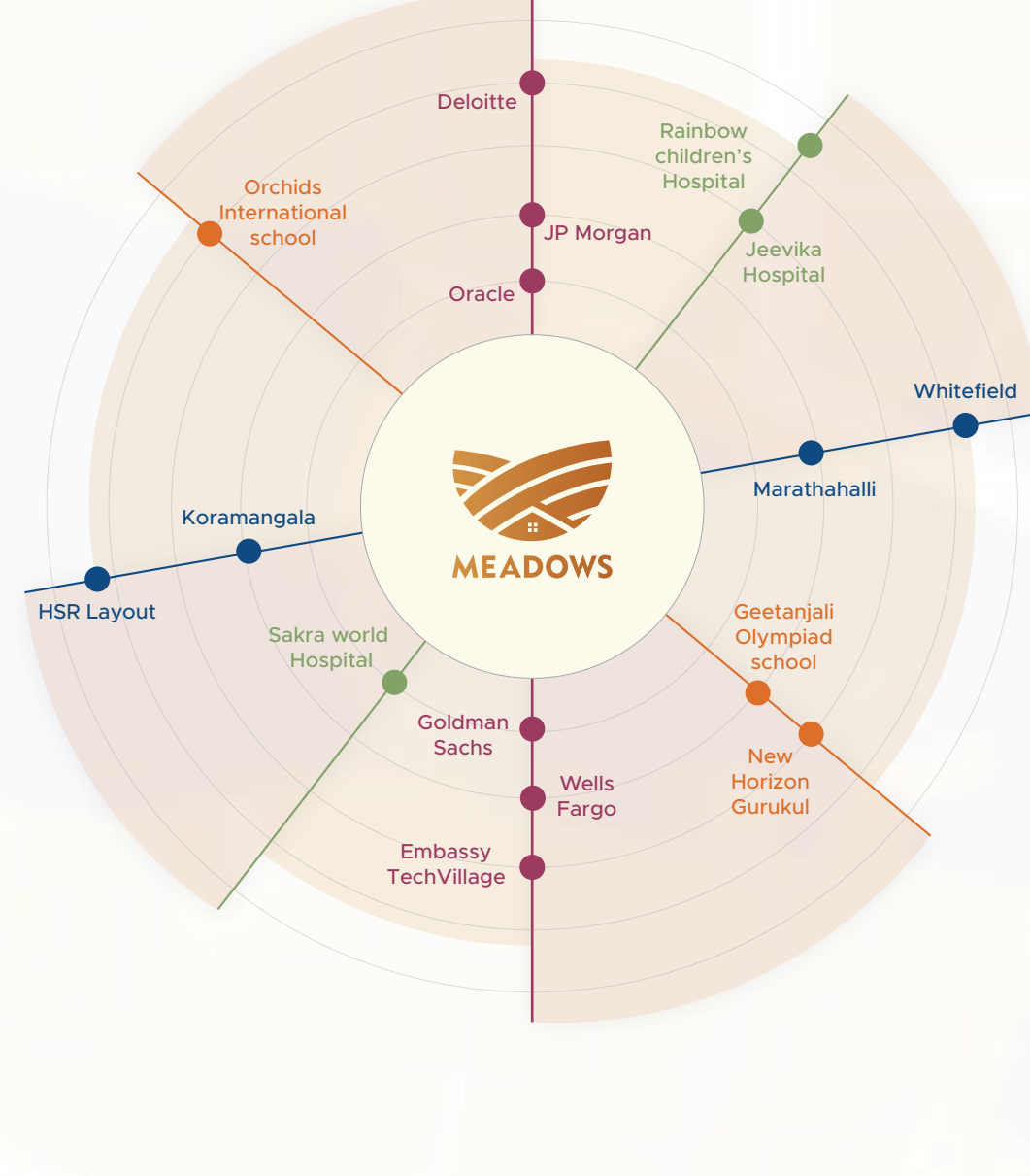

- Hospitals
- City Centre
- Schools
- Industries

## MASTER PLAN

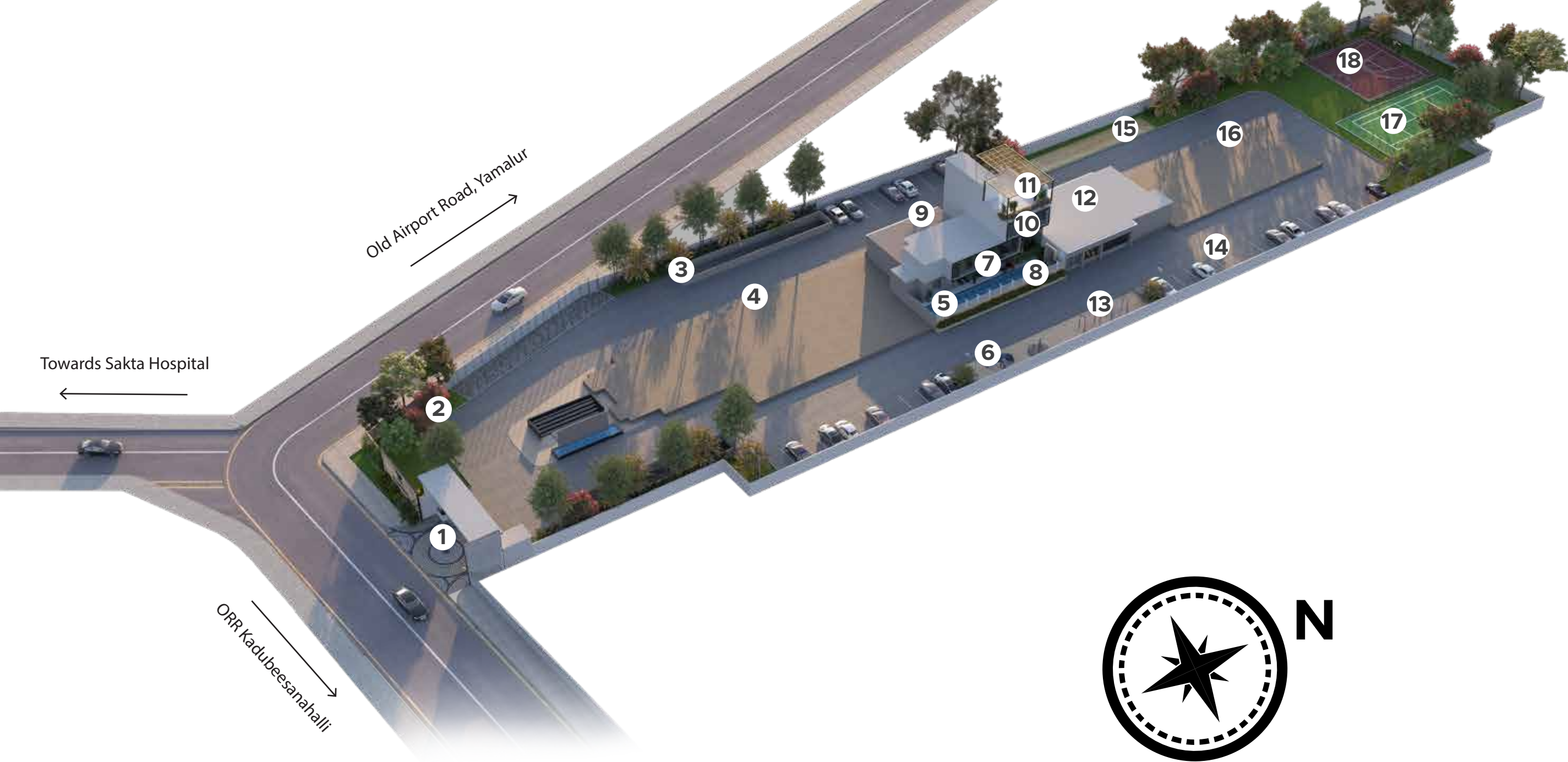

### LEGEND

- |                      |                          |
|----------------------|--------------------------|
| 1. Entry             | 10. Billiards/cards room |
| 2. Reflexology walk  | 11. Community workspace  |
| 3. Ramp to basement  | 12. Multipurpose hall    |
| 4. Entry Block B     | 13. Skating rink         |
| 5. Swimming pool     | 14. Open parking         |
| 6. Kids play area    | 15. Cricket net          |
| 7. Gym               | 16. Entry Block A        |
| 8. Escape club house | 17. Tennis court         |
| 9. Creche            | 18. Basket ball court    |



## Where Every Home Is Designed To Perfection



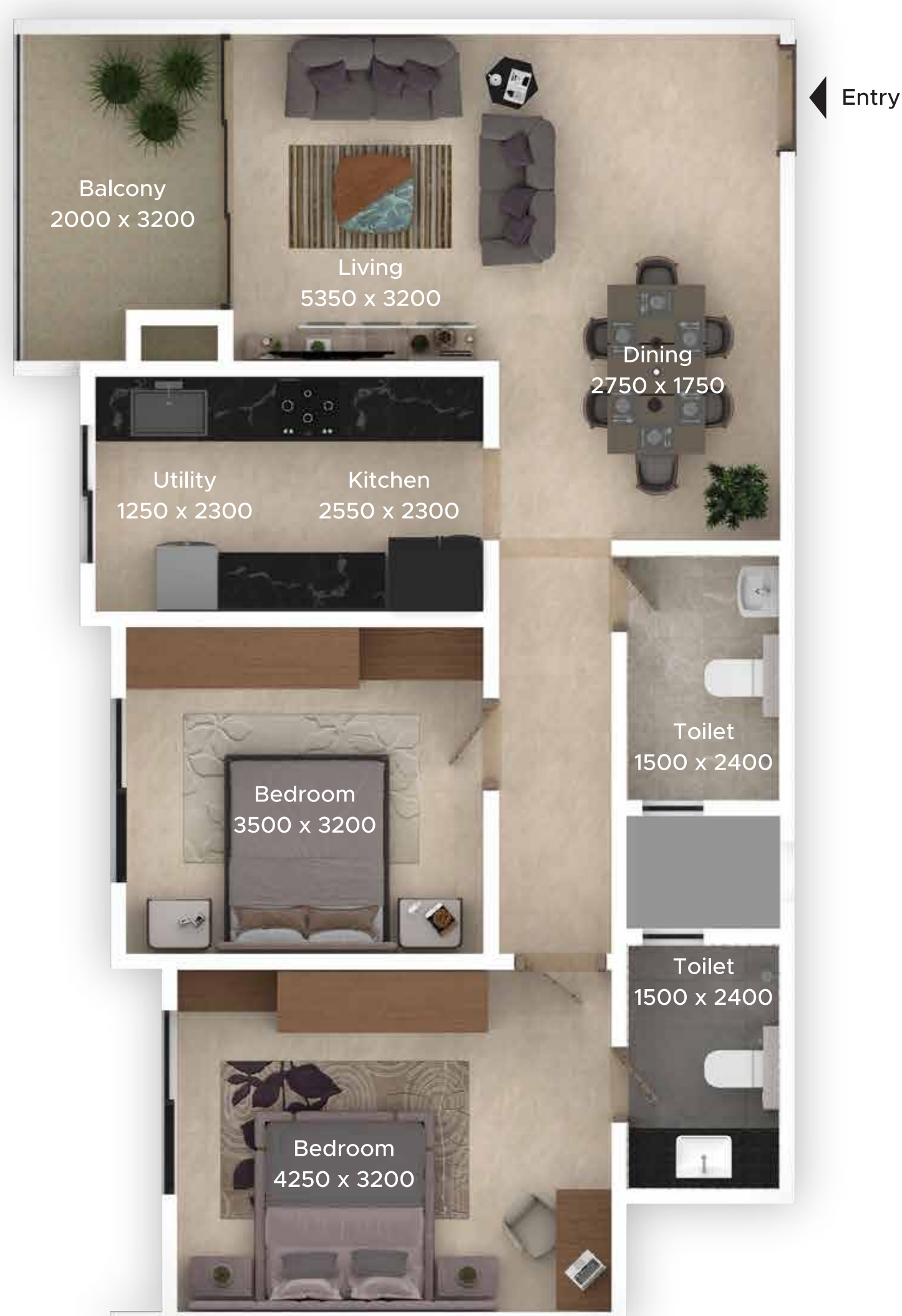

Super Built-up Area

**109.40 SqMt**

Unit Carpet Area

**71.94 SqMt**

Balcony Area

**6.01 SqMt**

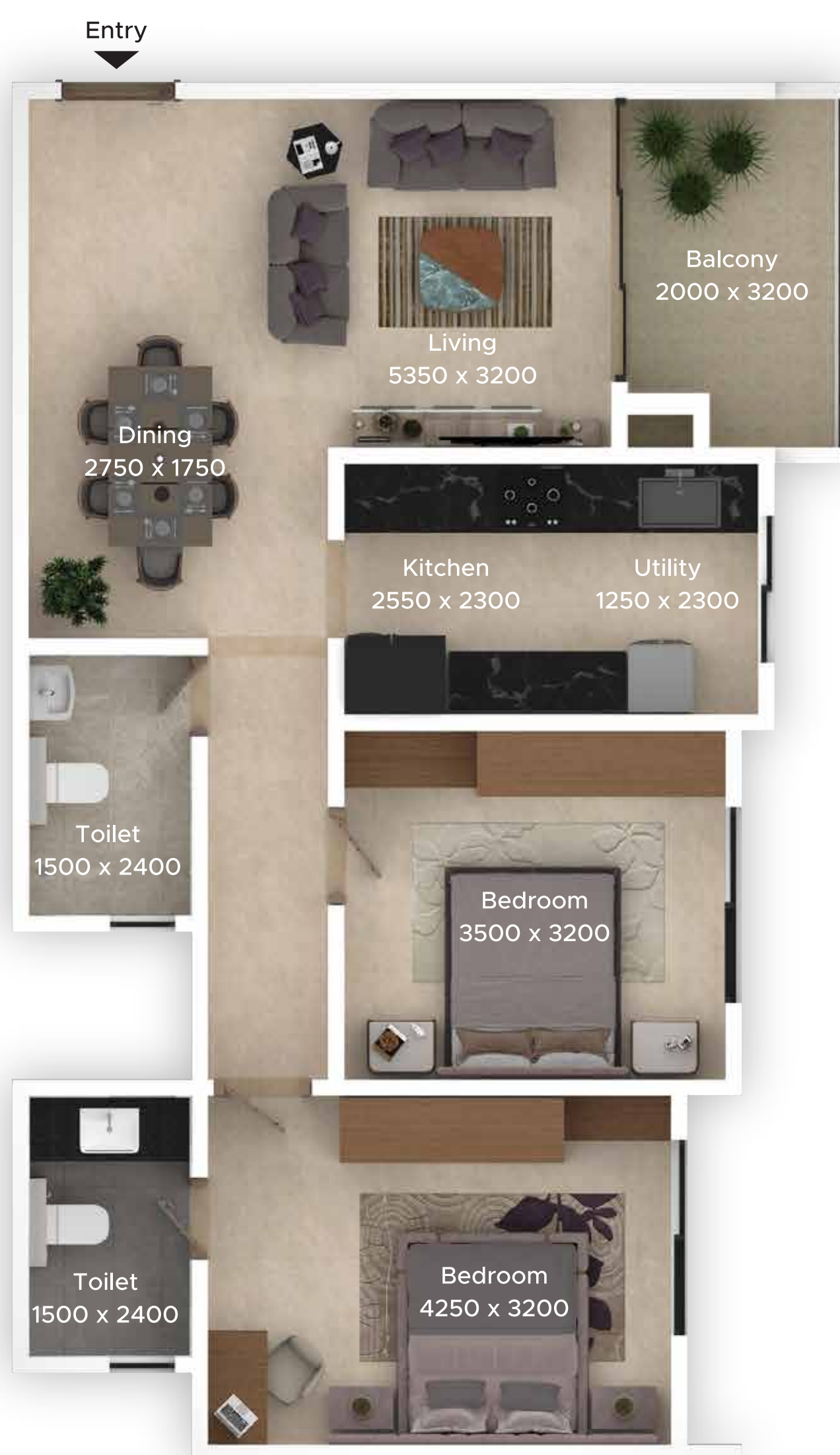

Super Built-up Area

**111.91 SqMt**

Unit Carpet Area

**73.11 SqMt**

Balcony Area

**6.19 SqMt**

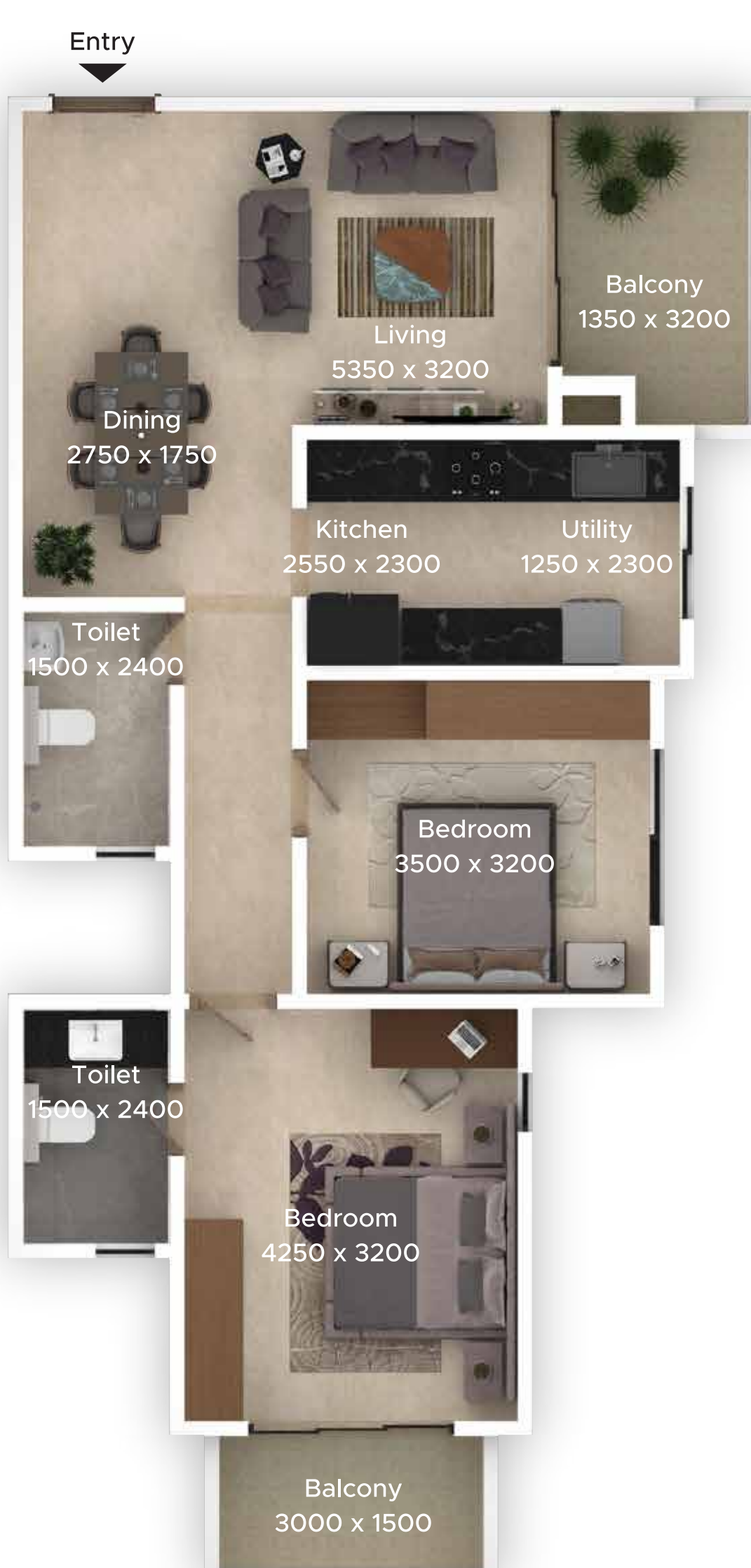

Super Built-up Area

**113.77 SqMt**

Unit Carpet Area

**71.91 SqMt**

Balcony Area

**7.99 SqMt**



Super Built-up Area

**114.39 SqMt**

Unit Carpet Area

**94.17 SqMt**

Balcony Area

**7.99 SqMt**



Super Built-up Area

**139.82 SqMt**

Unit Carpet Area

**93.58 SqMt**

Balcony Area

**5.78 SqMt**



# Because You Shouldn't Settle For Anything Less Than The Best



## Flooring

- Vitrified tiling for living, dining and all bedrooms
- Anti-skid ceramic tiling in bathrooms and balcony floors



## Bathroom

- Premium quality CP fittings
- European closet and wash basin
- Socket for geyser
- Opening for exhaust fan



## Openings

- Main entrance door with teakwood build and melamine polish
- Bedroom doors with hardwood framing and emulsion paint
- All doors fitted with premium quality locks and stoppers
- Windows with three-track UPVC frames and mosquito mesh for bedrooms
- Aluminum fixed louvered ventilators in toilets and sliding windows for kitchen



## Wall Finish

- Weather proof coating on the exterior of the structure
- Emulsion paint on all interiors with putty



## Kitchen Amenities

- Granite counter top
- Stainless steel single bowl sink with movable tap and drainboard
- Provisions for electric chimney, hob, grinder and fridge
- Provisions for aqua guard, water heater, microwave and exhaust fan



## Electrical

- Adequate light and fan points with modular switches
- AC points in all rooms TV and telephone points in all bedrooms and living room
- 100% DG power backup 4kw power supply allotted for each apartment



## Greenfinch Projects

# Curating Spaces Worth Living

With over 40 years of experience in the real estate space, Greenfinch Projects was established to create spaces that become landmarks in their own right. With over a million square feet of residential real estate already designed and completed, we've delivered homes to over 300 happy families, and we look forward to you joining our ranks.

## Contact

+91 70909 56789

[www.greenfinchprojects.com](http://www.greenfinchprojects.com)

Kariyammana Agrahara, Kadabeesanahalli, Bengaluru, Karnataka 560103



Scan for website

