





RUDHRA CONSTRUCTIONS PVT. LTD.

Started its place with a group of young & energetic professional who serve with commitment. It has experienced & high quality Engineers, Architects, Efficient technical Personnel to provide lucrative apartments to its valued clients with competitive price.

Before designing any project it prepares a theme based on the existing technical support and available best constructions material, which helps to construct a quality product. It emphasizes on the desire of its valued clients. We believes that the client will speak for the company and their satisfaction will accelerate its journey to reach the goal smoothly.

Since 2005, Rudhra construction started and Completed 11 Projects Successfully all over hyderabad Major locations.

Ongoing Project



Now we Proudly came with



Welcome to a **View Extraordinary**

The Royal Village Address symbolizes finely crafted homes that overlook the natural splendor of a superior living. Fine luxury now finds expression on a breathtaking canvas of greenery .

Come and live in the lap of fine and luxurious living.

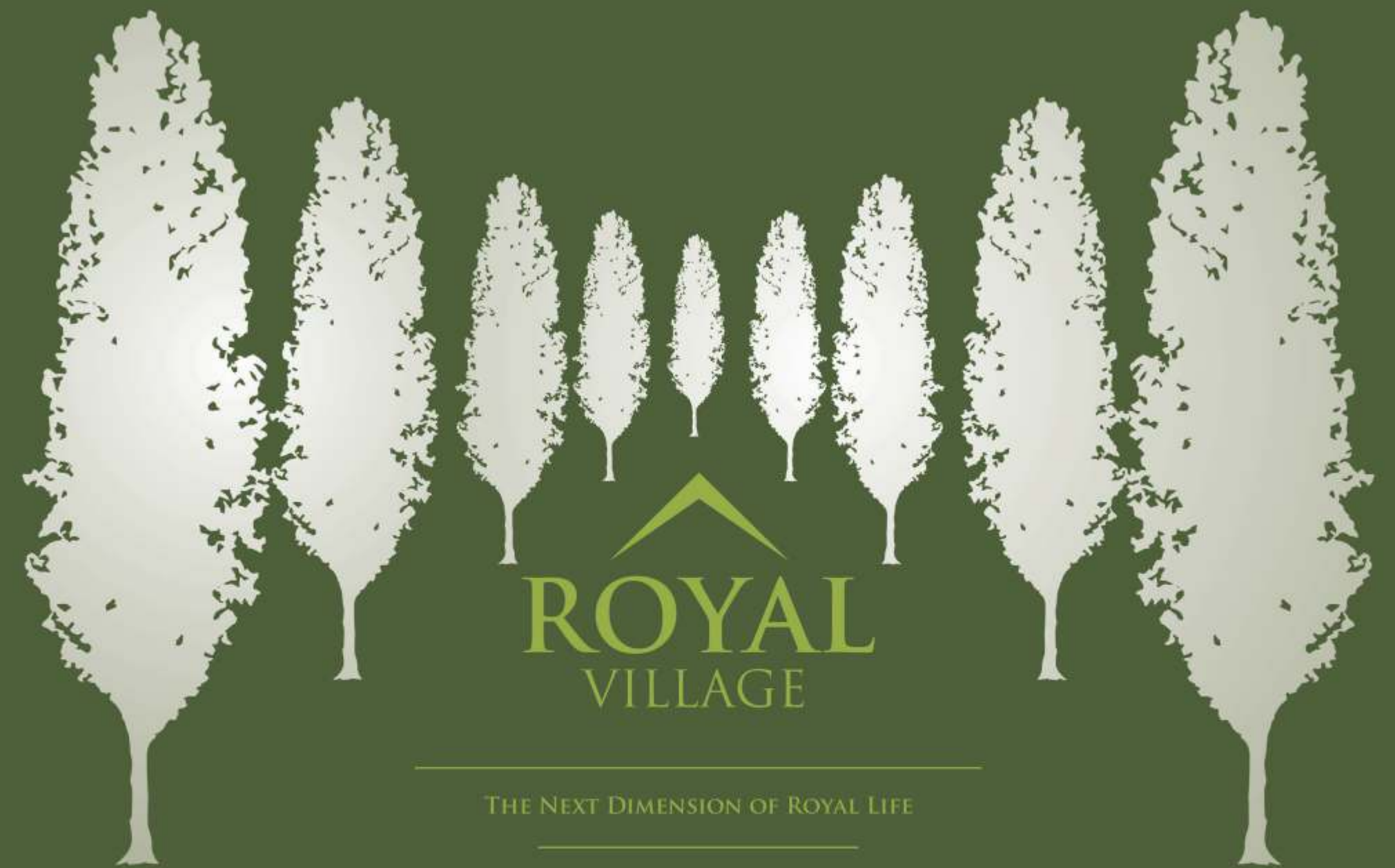

LUXURY & BEYOND

Hyderabad, is a place of infinite natural beauty. The warm friendly people, many historic sites, IT industry, Fashion, Food, lot more Business opportunities and wonderful climate are only some of this city's appeal. Who wouldn't want to live here? This is where we come in. When it comes to development and management of exclusive real estate, we are at the before.

We go about this the same way houses are built, from the ground up. From inception to completion we attend to all the details, all the specifics, and ensure that everything is as specified by our clients.

Welcome to Royal Village, by Rudhra Constructions.



CREATE LIVE LUXURY

CREATE

Welcome to a life of luxury. Rudhra Construction Pvt. Ltd., Project presents Royal Village - beautiful, private, detached and Unique style duplex villas for those who love the good life. Equipped with private plunge pool, state-of-the-art amenities, posh interiors with imported fittings, fixtures and garden area, our lavish 3 bedroom villas promise a truly grand life for you and your family.

This beautiful living spaces is located in the main part of Hyderabad City. It is a living environment that encompasses all the modern luxuries and promises happiness for eternity.



ROYAL
VILLAGE

ROYAL
VILLAGE



LIVE

A living that offers a 360 degree of nature's beauty. Every morning brings a new opportunity in a true sense that beautifies the experience of living.

A paradise of happiness and heaven of harmony that upgrade the lifestyle by offering excellent amenities. Nature plays an enthusiastic host everyday and fills life with multiple colors of happiness and prosperity. Every home is designed by considering even a tiny expectation, homes that express the quality and spells tranquility.

Your privacy has always been our priority and with this thought in mind, we have designed homes that give a complete freedom but also offer a personal space. Sliding windows are strategically designed big.



YOUR OWN SPACE

CREATE LIVE LUXURY

STEP INTO YOUR SMART HOME...



Home Automation
Technology for each Villa

- | | | | |
|---|--|--|-------------------------------|
|  | Designer Landscaping |  | Bt Roads With Surface Drain |
|  | Avenue Plantation With More Than 500 Trees |  | Underground Cabling |
|  | Central Park |  | 100% Power Back-up |
|  | Street & Land Scope Solar Lighting |  | Water Treatment Plant |
|  | All-around Compound Wall With Solar Fencing |  | Rainwater Harvesting |
|  | 24-hr Security CCTV With Video Intercom System |  | Adjacent to 200'-0" Wide Road |
|  | Manjeera Water | | |



LUXURY

Living at Royal Village has become a style statement and why not? When one gets everything from luxury to panache at affordable price.

Royal Village Villas that truly justify the real meaning of luxury. Spacious homes that are designed as per your comfort, every corner tells a story of perfection in architecture. Lavish bedrooms, bountiful bathroom and a thoughtful sitting area just make this project different from the rest.



All The **Comforts**
for **Better Lifestyle**

Exclusive Clubhouse



Children Play Area



Jogging Track



Swimming Pool



Kid's Pool



Convention Hall



Spa



Gym



Tennis Court



Visitors Lounge



Indoor Games



Suit Rooms

Amenities that enhance your lifestyle...



WEST VILLA
Ground
Floor



WEST VILLA
First
Floor



PLOT AREA : 321.67 SQ. YDS
G. FLOOR SLAB AREA : 1,433 SFT
F. FLOOR SLAB AREA : 1,433 SFT
STAIR CASE AREA : 170 SFT
TOTAL BUILT-UP AREA : 3,036 SFT

WEST FACING
VILLA



EAST VILLA
Ground
Floor

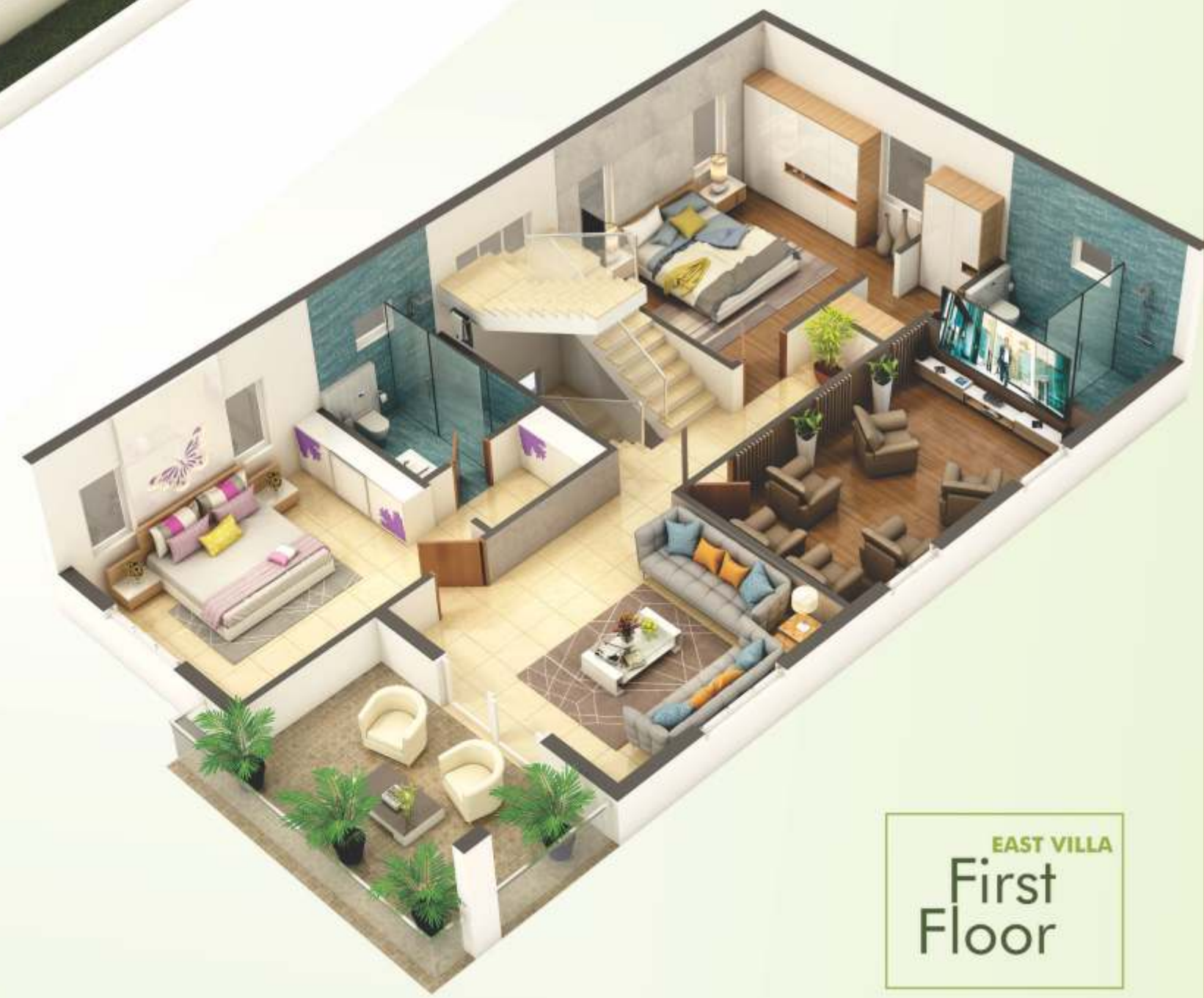

EAST VILLA
First
Floor



PLOT AREA : 298.44 SQ YDS
 G. FLOOR SLAB AREA : 1,657 SFT
 F. FLOOR SLAB AREA : 1,657 SFT
 STAIR CASE AREA : 203 SFT
 TOTAL BUILT-UP AREA : 3,517 SFT

EAST FACING
VILLA

NORTH FACING VILLA



Typical Floor Plan

VILLA AREA : 238.44 SQ. YDS

GROUND FLOOR : 1,657 SFT

FIRST FLOOR : 1,657 SFT

STAIR CASE AREA : 203



Specifications

STRUCTURE

R.C.C. framed structure with earthquake load desing.

WALLS

External Walls 9'-0" thick, internal walls 4'-5" thick table molded light weight bricks with cement mortar.

PLASTERING

Internal & External walls cement plastering with double coat sponge finish.

DOORS

Main Door Teak Wood(BT) frame with Teak Wood paneled Shutter. Remaining doors Teak Wood(MT) frames with skin door shutters. Beading to main door and remaining doors.

WINDOWS

Three track UPVC made windows with mosquito mesh.

TOILETS

- A) EWC with flush tank of Cera, Hindware.
- B) Hot and Cold wall mixer and shower.
- C) All C.P Fittings with 7 years warrenty.
- D) Ceramic flooring with door height glazed tiles dado.
- E) Provision for exhaust Fan & Geyser and plug point.

FLOORING

Good quality vertified flooring 800x800.

KITCHEN

- A) Black Granite Kitchen platform with stainless steel sink.
- B) 2'-0" height granite tiles dado above Kitchen platform.
- C) Provision for exhaust fan plug points.
- D) Provision for washing machine plug points in utility area.
- E) 3'-0" height dado to wash area with ceramics tiles.

PAINTINGS

Asian plastic emulsion for their inner walls with wall care putty finishing elevation sides with texture paintings. Anti fungal and water proof weather shield for the other exterior walls, enamel for the internal doors & enamel polish for main door.

ELECTRICAL

Concealed Copper wiring with Finolex make conduits for lights and fans points where ever necessary.

- A) Power outlets for air conditioners in all bed rooms.
- B) Power plug for cooking range Chimney, Refrigerator, Mixer-Grinder in kitchen.
- C) Power points for TV and Audio Systems where ever necessary.
- D) Telephone points in Hall & Master bedroom.

PLUMBING

Concealed CPVC piping with Ashirvaad.Prince PVC Pipes for external & internal lines with separate tanks for bore-well and drinking water at terrace and under ground sump for storage. All plumbing points will be pressure tested.

GENERATOR

100% backup for Villas and Common areas.



EAST FACING VILLA



Typical Floor Plan

VILLA AREA : 221.67 SQ. YDS

GROUND FLOOR : 1,433 SFT

FIRST FLOOR : 1,433 SFT

STAIR CASE AREA : 170



WEST FACING VILLA



Typical Floor Plan

VILLA AREA : 217.78 SQ. YDS

GROUND FLOOR : 1,394 SFT

FIRST FLOOR : 1,394 SFT

STAIR CASE AREA : 170



83 Premium Villas

Experience Healthy & Stress Free Living



Key Distances from ROYAL VILLAGE

Royal Village - Premium Villas, in Hyderabad City, Pragthi Nagar is well connected to the rest of the city with the Inner Ring road on the other 200ft Road. It has close proximity to the IT Corridor, High Tech City, Gachibowli and is within striking distance of reputed institutions like Oakridge School, Ambitus World School, Delhi Public School, Unicent School, JNTU Engineering College and is 15 minutes away from the Metro Station, Shopping Malls like Manjeera and The Forum Mall.

Royal Village - Premium Villas is strategically located with a wide independent access road. The area has a health care center, commercial & shopping complexes, education facilities and much more in the near vicinity. The Best price we are offering with comparing the Best amenities we have.





Rudhra
CONSTRUCTIONS

Rudhra Constructions Pvt. Ltd.

Flat # 404, 4th Floor, Ramachandra Residency, Srinivas Nagar Colony, Nizampet, Hyderabad-90.

Contact : 040-48554280, +91 99498 36096, +91 83094 75836.

www.rudhraconstructions.com | rcpl1980@gmail.com