



Where the journey of life begins



Site Office:

Sy No: 89/3 & 90/1,
Byagadadhenahalli Village,
Chandapura -Anekal Road,
Kasaba Hobli, Anekal Taluk,
Bangalore - 560081

Corporate Office:

SUBHA BUILDERS AND DEVELOPERS
#17/F, 18th Cross,
Sector - 3, HSR Layout
Bangalore - 560102
✉ sales@subhabuilders.com

Say hello to easy living

☎ +91 76 76 322 333

Architect

[notion]

Marketed By

🏠 CLICKHOMEZ



Life begins as a journey and reaches a destination.

The journey of life is inexplicable. In theory, each journey begins with the first step whether it's your first step as a baby, your first day at school, your first job, your first car or even your first home. This journey will take you down many roads, but that does not matter. The only thing that matters is the number of times you brush off the dust on your knees to continue following your dream. It is a journey with many options. We currently live in a world that is yet to be discovered, to be explored, goals to reach and people to meet. There will be times when you will need assistance with knowing what you want, when you want it and where you want it. At times like these our homes will be a constant reminder that you made the right choice.



“The journey of a thousand miles begins with a single step”

- Lao Tzu



Homes that help you make the right choice.

The Good, Great and the Greatest

Welcome to Subha 9 Sky Vue, inspired by premium design, the architecture of this project creatively blends contemporary style with the combination of luxurious lifestyle amenities.

It promises a quality life in its nourishing homes that not only appeals visually but also reaps the benefits of living in one of the finest and premium location.

Subha 9 Sky Vue is designed to ensure its residents receive access to amenities that become an integral part of their living. From relaxation to rejuvenation, Subha 9 Sky Vue provides an array of indoor and outdoor activities that are oriented to improve the lifestyles of the residents.

Subha 9 Sky Vue is the first economical residential building that offers exclusive premium amenities at reasonable rates. It is a project that will help you reach your destination by providing you the best in class, style and design.

**Begin the journey of your life,
at Subha 9 Sky Vue**



On a long journey of human life,
faith is the best of companions; it is
the best refreshment on the
journey; and it is the greatest
property.

- Gautama Buddha



Introducing for the first time
Club Azure

Azure means a bright blue colour, like the sky

The journey of life is full of situations where one will have to go through extensive stress of the body and mind. We at 9 Sky Vue understand this stress level and to tackle them we have provided our residents with the state-of-the-art amenities that will help them improve their life. Club Azure provides a platform for families to enjoy recreational activities that will not only keep them fit but also relieve them of all their tensions.

Elder's Park



Barbeque Deck

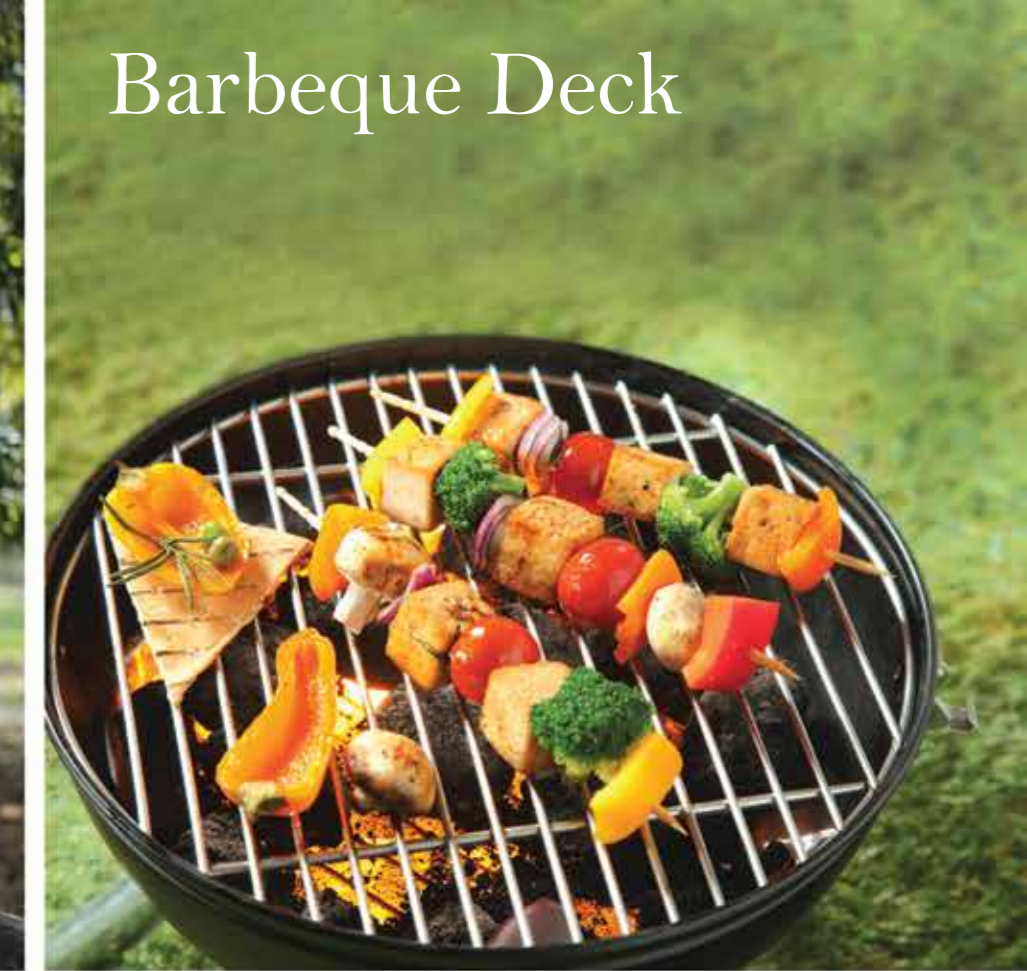

Meditation
Deck

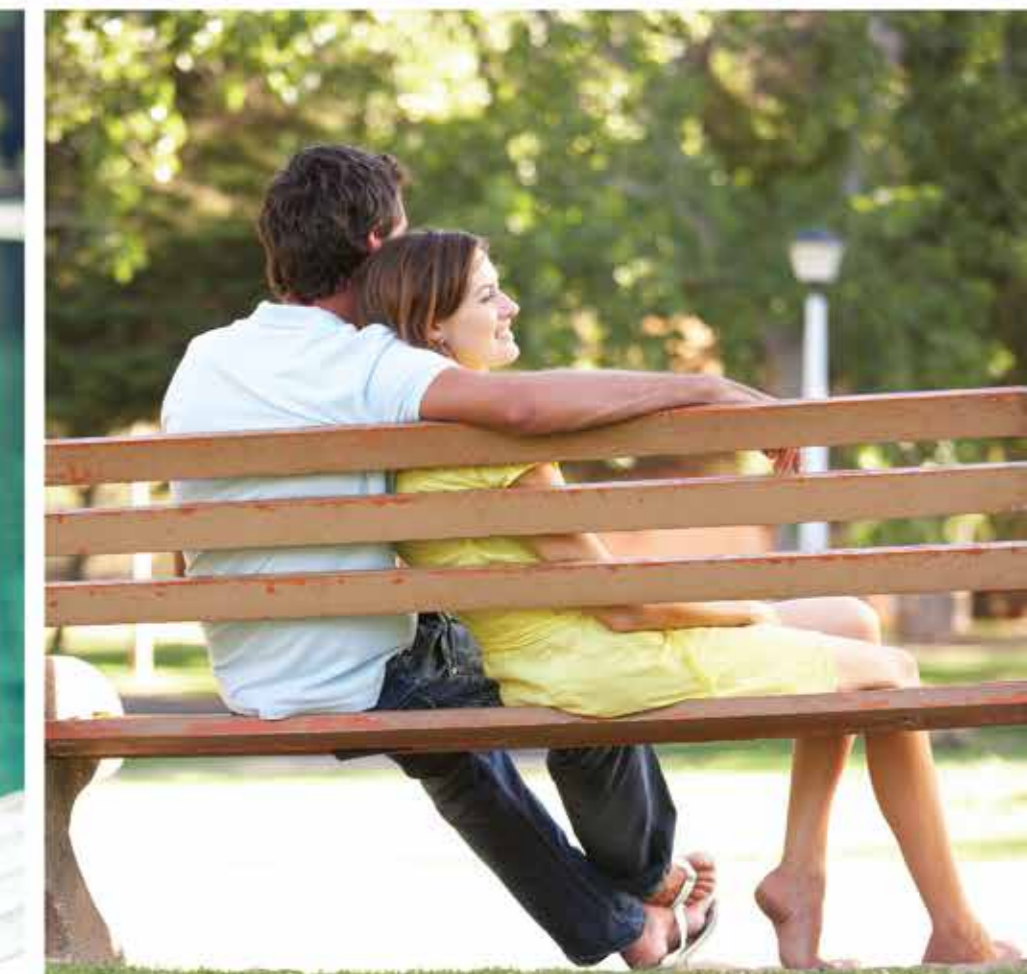

Chatting Corner



Club House

-  Well Equipped Gymnasium
-  Multipurpose Hall
-  Table Tennis
-  Billiards
-  Foosball Table
-  Board Games

Amenities

-  Swimming Pool with Deck
-  Kids Pool
-  Children's Play Area
-  Exercise Station
-  Basket Ball Hoop
-  Jogging / Walking Track
-  Badminton Court
-  Meditation Deck
-  Barbeque Deck
-  Mini Amphitheatre
-  Palm Plaza
-  Elders Park
-  Chatting Corner

Features

- | | | |
|---|--|---|
|  Clear Title Project |  DG Power Backup |  Sewage Treatment Plant |
|  Vastu Compliant |  CCTV Surveillance and Intercom |  Good Connectivity |
|  Rain Water Harvesting |  Round the Clock Security |  Well Designed Landscape |



Companions for your journey

The journey of life is never travelled alone but with companionship of near and dear ones. At 9 Sky Vue we seek to match the requirements of families by providing spacious 1, 2 and 3 BHK apartments. It is our strong belief that families benefit greatly from spaces that are committed to provide a nurturing environment.



Type: 1 BHK
Unit Size: 520 sq-ft

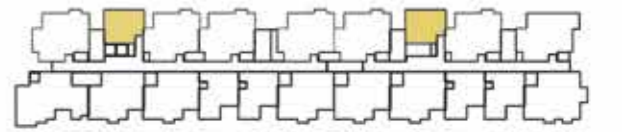

Keyplan



1 BHK EAST
SALEABLE : 520 SFT

Type: 1 BHK
Unit Size: 645 sq-ft



Type: 1 BHK
Unit Size: 645 sq-ft

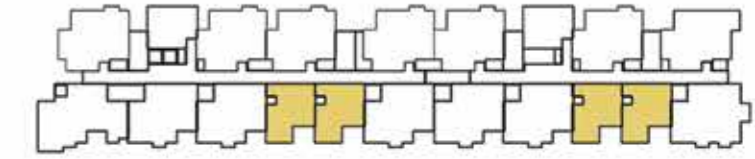

Keyplan



1 BHK NORTH
SALEABLE : 645 SFT



Type: 2 BHK
Unit Size: 950 sft

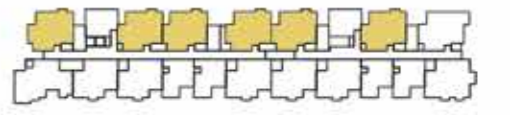

Keyplan



2 BHK EAST
SALEABLE : 950 SFT

Type: 2 BHK
 Unit Size: 950 sq-ft



Type: 2 BHK
 Unit Size: 1025 sq-ft

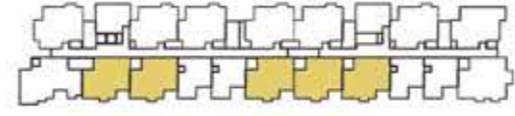

Keyplan

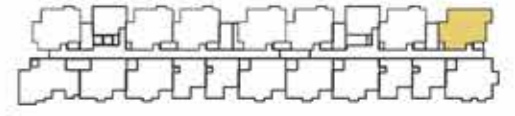

Keyplan



2 BHK NORTH
 SALEABLE : 950 SFT



2 BHK EAST CORNER
 SALEABLE : 1025 SFT



Type: 2.5 BHK
 Unit Size: 1110 sq-ft

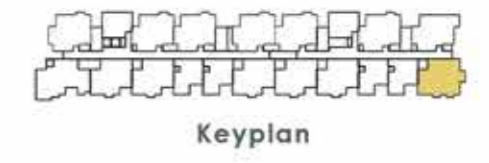

2.5 BHK NORTH
 SALEABLE : 1110 SFT

Type: 3 BHK

Unit Size: 1225 sq-ft



Type: 3 BHK

Unit Size: 1225 sq-ft



A spectacular view of journey ahead



Road to your Journey

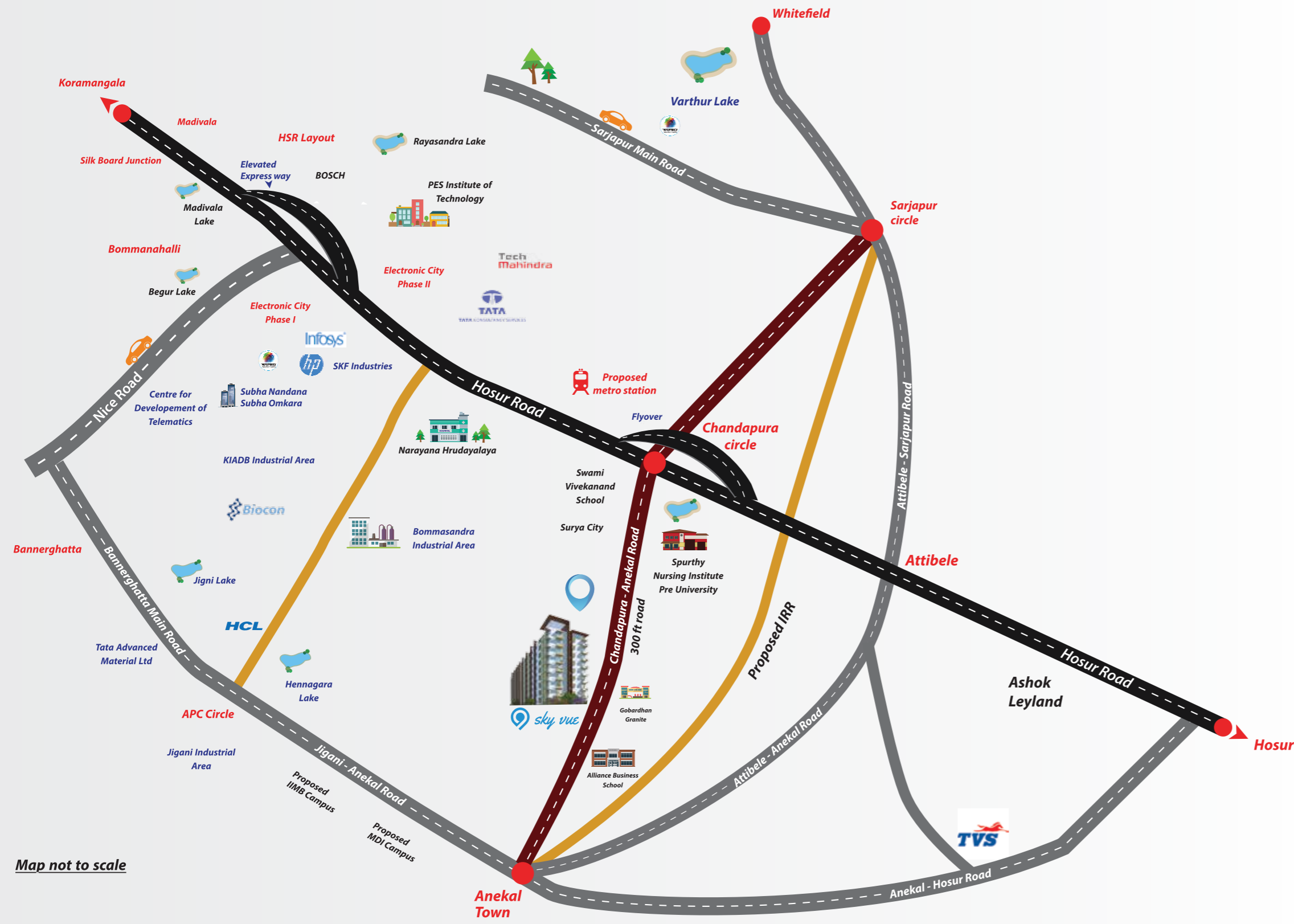

Map not to scale

The journey begins here

Located at Chandapura-Anekal Road, just about 2.5 Km from Alliance University. Subha 9 Sky Vue is an ideal dwelling for IT professionals because of its proximity to Electronic city which is only a 10 minute drive away. The property remains in isolation from the hustle and bustle of city life and is in proximity to major multi-nationals and manufacturing units. The location of the site is amidst some of the finest schools and colleges that provide international education, state-of-the-art hospitals, fine-dining restaurants and shopping centers that follow global standards.

Connectivity

30 minute drive to Koramangala

In close proximity to landmarks on Bangalore-Hosur 6 Lane Express Highway

Narayana Hrudayala Hospital (4.5 Kms), • Electronic City (9.5 Kms),

Connected to Whitefield through Chandapura – Dommasandra road, and other parts of the City through NICE corridor

Educational Facilities

- ◆ Alliance University (2.5 Kms)
- ◆ Spurthy Global School
- ◆ Swami Vivekananda primary, higher & degree college
- ◆ Sujay School
- ◆ Achievers International Academy
- ◆ Indus International School
- ◆ The PES School of Engineering (PESSE)
- ◆ Proposed IIM Bangalore
- ◆ The International School Bangalore
- ◆ Delhi Public School

Hospitals

- ◆ Narayana Hrudayala Hospital
- ◆ Sparsh
- ◆ Athreya Hospital
- ◆ Apollo Clinic

Shopping Centers

- ◆ D-Mart
- ◆ Total Mall
- ◆ Forum Mall
- ◆ Upcoming Neo Mall



Kitchen

The kitchen is that room in the house where the food for your journey will be prepared. It is a sacred space where moms, aunts and many men who take an interest in cooking begin their cooking journey's to please their loved ones.



Living Room

The living room is a place where many of your family and friends will narrate stories about their various journey's across the world. It is a place where you will make numerous memories with your loved ones that you will never forget.

Specification



- **Structure**

RCC framed structure with solid block masonry

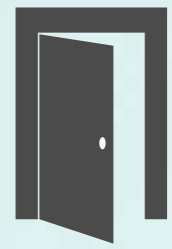

- **Doors**

Main Door: Teak Panel Door with Teak wood frame
Other Doors: Flush Door with hard wood frame

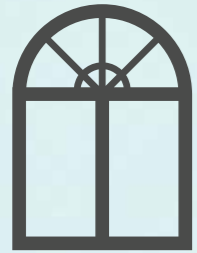

- **Windows**

Aluminium Sliding Window & Balcony Doors
MS Designer grill with enamel pain

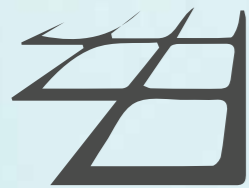

- **Flooring**

Vetrified Flooring for Living, Dining, Kitchen, Bedrooms etc.
Anti Skid Flooring for Toilets & Balcony



- **Toilets**

Sanitary Fittings of Cera, Hindware or equivalent make.
CP fittings of Jaquar, Hindware or equivalent Ceramic Tile Cladding
up to 7 ft height Geyser point & Exhaust fan provisions.
Suspended Pipelines in toilets.

Specification



- **Kitchen**

Granite counters with single bowl sink, Exhaust Fan provision for Hob.



- **Painting**

OBD for Internal walls & weather proof paint for Exterior.



- **Electrical**

Anchor Panasonic or equivalent modular switches with ISI
Standard cables AC point provision for master bed room

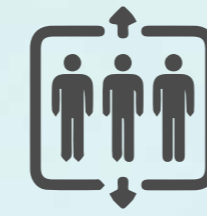

- **Lift**

Fully automatic lift of reputed make



- **Power Supply**

3BHK - 4KW, 2BHK - 3KW, 1BHK -3 KW



- **Power Back up**

1BHK - 0.6KVA, 2 and 3BHK - 1 KVA
Minimum Power Backup for common Areas.