

VTP

---

BELLISSIMO

BEAUTIFULLY THOUGHTFUL

---



# IN YOUR LIFE, YOU HAVE SEEN MANY CONFLUENCES.

You have seen meandering paths going up to greet the hills.

You have seen the sun diving into the horizon, changing the colour of the river.

You go back to that single place every time, where your different personas find respite, hand in hand.

Because you are not only YOU.  
You have two personas inside you.

**A beautiful one and a thoughtful one.**

Who have grown up seeing many confluences, admiring them secretly.

OUR NEWEST CREATION  
IS BUILT KEEPING  
**THE THEORY OF INFUSION**  
IN MIND.



HOW ABOUT A HOME  
THAT IS **BEAUTIFULLY**  
ELEGANT IN ITS APPEARANCE?

WELL, HOW ABOUT IT  
BEING GRACED BY EXTENSIVE  
**THOUGHTFULNESS?**



PRESENTING

VTP

# BELLISSIMO

BEAUTIFULLY THOUGHTFUL

A RARE BLEND OF  
**BEAUTY AND THOUGHTFULNESS**  
WITH **PREMIUM 1, 2 & 3 BEDROOM HOMES**  
NEAR INFOSYS CIRCLE, HINJAWADI PHASE 1







VTP  
BELISSIMO  
BEAUTIFULLY THOUGHTFUL



FOR YOU, WE BRING  
**A NEW  
WORLD**

Have you ever imagined a lifestyle that is at once, both glamorous as well as meticulously planned? We have made it possible with **VTP Bellissimo**.

The glory of this high-rise is reflected in the stunning façade, in the spaciousness of its apartments, in its location amidst the hills and the greens of Pune West, and in the heart with which it's made to accessorize your luxury life.

But we didn't just stop there, for our aim went higher.

We incorporated thoughtful planning within every aspect of this beautifully crafted home. When you enter, you will find it in the plethora of apartment layouts and sizes to choose from, all of which are made to maximise space usage. While the amenities are many, each is made specifically to suit your lifestyle.

It's truly a world where beauty and thoughtfulness rise to greet you.

Regards,

**VTP Realty**

**BEAUTY**  
THAT APPEALS TO ALL  
YOUR SENSES

**THOUGHTFULNESS**  
IS EXPERIENCED IN EVERY  
ASPECT OF THE DETAILS



## WHERE TWO WORLDS MEET, **VTP BELLISSIMO** EMERGES

200+ acres of Township Codename Blue Waters has got its heart with the arrival of **VTP Bellissimo**. Its name, Italian for "beautiful", is reflected in this stunning new residential cluster of 9 towers studded with beautifully thoughtful homes.

Standing like a shining beacon against the western skyline on the Hinjawadi Phase 1 side, of the township, **VTP Bellissimo** bears the philosophy of MLA (Maximum Liveable Area), specially curated for your love for space.

IT'S CERTAINLY AN ABODE THAT  
BOTH YOUR PERSONAS WILL  
LOVE TO CALL A HOME.





WELCOME TO THE BEAUTIFULLY  
THOUGHTFUL WORLD OF  
VTP BELLISSIMO





## MAHALUNGE-HINJAWADI: WHERE THE FAMILIES OF THE FUTURE WOULD LOVE TO BELONG

VTP Bellissimo's location falls in the Mahalunge-Hinjawadi belt, a rapidly developing corridor of West Pune. Mahalunge brings the bountiful nature in its lap with the verdant green Mahalunge hills and the Mula river whereas Hinjawadi is one of India's fast growing software hubs.

The project is perched at the confluence of both these popular destinations, keeping you close to the dynamism of fast-paced metropolitan life while being close to nature.

Why should you compromise on the location, when here, you get the best of both the worlds!

## ADVANTAGE MAHALUNGE - HINJAWADI

- Advantage **1** Possessing the laurel of being one of India's **LARGEST IT PARKS** sprawled across 2800 acres
- Advantage **2** **HUB** of the Maan-Mahalunge **SMART CITY** development
- Advantage **3** **23.3 KM LONG METRO** connecting Hinjawadi with Mahalunge, Baner & Shivajinagar (Sanctioned Phase 2)
- Advantage **4** **HINJAWADI** has a high appetite **FOR RENTAL** apartments due to proximity to workplaces
- Advantage **5** Mumbai is easily connected via **MUMBAI PUNE EXPRESSWAY**
- Advantage **6** **HIGH SOCIAL LIFE** with plenty of leisure & entertainment options in Hinjawadi & around
- Advantage **7** **CRADLED BY NATURE** with hills & river of Mahalunge in close proximity
- Advantage **8** Hub of well-known **EDUCATIONAL INSTITUTES**
- Advantage **9** **UPCOMING 6 LANE ROAD** means improved connectivity between Mahalunge & Hinjawadi and faster movement of traffic
- Advantage **10** One can reach Baner, Balewadi High Street, Wakad, University Chowk or Chandni Chowk **IN UNDER ~30 MINS.**
- Advantage **11** **THE STRATEGIC LOCATION** means you are near all the important junctions of Pune West



**THOUGHTFULNESS** IS  
WORK, PLAY, SHOP  
IN WALKING DISTANCE

**BEAUTY** IS  
HILLS AND RIVER  
IN YOUR VIEW

## A NEIGHBOURHOOD WHERE **NATURE AND CITY LIFE ARE IN FINE CONFLUENCE**

When you choose **VTP Bellissimo**, you are not only surrounded by a wide sky, rolling hills and a calm river, but also by a wonderful social life. Where work is also near and other necessities like education, healthcare, shopping encircle you, giving you the benefit of living at the heart of convenience.





Scan the QR for site location

### FIND TRANQUILITY IN THE LAP OF NATURE

Imagine your mornings waking up to the serene view of the hills. And when you are out for a jog, the gentle breeze flowing over the Mula river caresses you.



## STAY IN THE WELL-CONNECTED NUCLEUS



Connectivity is smooth and fast paced to all the important parts of Pune West. The Mumbai-Pune Expressway and the Pune-Bangalore Highway are the just a few minutes away thus ensuring you are never far from your workplace or leisure destinations.

<b>UPCOMING PUNE METRO STATION - Hinjawadi -</b>	1.5 KM
<b>MUMBAI PUNE HIGHWAY NH 48 -</b>	4.3 KM
<b>BHUMKAR CHOWK, WAKAD -</b>	4.3KM
<b>BALEWADI HIGH STREET -</b>	7 KM
<b>PIMPRI STATION -</b>	11.7 KM
<b>PUNE STATION -</b>	20 KM
<b>PUNE AIRPORT -</b>	26.5 KM

## IT HUBS: YOUR NEXT DOOR DESTINATION



Staying here means being at the centre of a work-life balance where every major company is only a short distance away.

<b>TATA TECHNOLOGIES LTD. -</b>	800 Meters
<b>WIPRO LTD. -</b>	800 Meters
<b>INFOSYS PHASE 1 - BUILDING 1 -</b>	800 Meters
<b>COGNIZANT OFFICE -</b>	1.2 KM
<b>THINKSMART IT SOLUTIONS PVT. LTD. -</b>	1.6 Km
<b>PERSISTENT SYSTEMS -</b>	1.7 KM
<b>BIRLASOFT LTD. -</b>	1.8 KM
<b>GLOBANT INDIA PVT. LTD. -</b>	1.9 KM
<b>INFOSTRETCH CORPORATION (II) PVT. LTD. -</b>	1.9 KM
<b>CISCO SYSTEMS PVT. LTD. -</b>	1.9 KM
<b>HCL TECHNOLOGIES LTD. -</b>	1.9 KM

## EXPLORE THE FINE DINING & HAPPY HOSPITALITY RADIUS



The foodie in you will be welcomed graciously if you choose this as your home, because it will be studded with well-known hotels and restaurants nearby.

### RESTAURANTS

HOTEL BLU GRASS -	1.50 KM
24/7 GALLERY CAFE - HYATT PLACE -	1.50 KM
FOUR SEASONS RESTAURANT -	1.70KM
MEZZA 9 -	1.80 KM
OVER THE TOP -	1.80 KM

### HOTELS

LEMON TREE -	0.50 KM
VIVANTA -	2.00 KM
HOLIDAY INN -	2.50 KM
COURTYARD BY MARRIOTT -	3 KM
RAMADA PLAZA BY WYNDHAM -	4.70 KM
SAYAJI HOTEL -	5 KM
THE ORCHID HOTEL -	8 KM



## MAKING A STRONG FOUNDATION BY STAYING IN THE EDUCATION HUB

Perfect place for your child's education because the place is blessed by many famous schools and colleges.

SYMBIOSIS INSTITUTE OF INTERNATIONAL BUSINESS (SIIB) -	900 METERS	ALARD COLLEGE OF ENGINEERING AND MANAGEMENT -	2 KM
MAHINDRA INTERNATIONAL SCHOOL -	1.3 KM	BLUE RIDGE PUBLIC SCHOOL -	2.2 KM
INTERNATIONAL INSTITUTE OF INFORMATION TECHNOLOGY -	1.3 KM	VIBGYOR HIGH HINJAWADI -	2.8 KM
BLISS INTERNATIONAL SCHOOL -	1.5 KM	WS SCHOOL OF BUSINESS ANALYTICS AND DATA SCIENCE -	4.8 KM
SYMBIOSIS HINJAWADI -	1.6 KM	SAI BALAJI INTERNATIONAL INSTITUTE OF MANAGEMENT SCIENCES -	6.3 KM
D.Y.PATIL UNIVERSITY -	10 KM		
FLAME UNIVERSITY -	15 KM		

## LOOKED AFTER BY WORLD CLASS HEALTHCARE

Your health should always be your priority. So, when you are here, the world famous hospitals are always ready to take care of your health.



### MEDICAL CENTRES & HOSPITALS

RUBY HALL CLINIC, HINJAWADI -	1.50 KM
SANJEEVANI MULTISPECIALITY HOSPITAL -	2.40 KM
LIFE POINT HOSPITAL -	4.70 KM
SURYA MOTHER & CHILD SUPER SPECIALTY HOSPITAL -	5.80 KM
GOLDEN CARE HOSPITAL -	3.60 KM
JUPITER HOSPITAL, PUNE -	10.40 KM
PHOENIX HOSPITAL -	7 KM
NRS HOSPITAL -	6.80 KM
ASHRAYA HOSPITAL -	4.70 KM
ADITYA BIRLA MEMORIAL HOSPITAL -	7.50 KM
STERLING MULTISPECIALTY HOSPITAL -	11.70 KM



**THE**



**TOWNSHIP**





WELLNESS CENTRE & SPA



YOGA & MEDITATION



AROUND 1KM RIVERSIDE PROMENADE

YOUR BEAUTIFULLY THOUGHTFUL HOME COMES WITH A TOWNSHIP ATTACHED.  
TOWNSHIP CODENAME  
**BLUE WATERS**

**A 200+ ACRES TOWNSHIP**  
SPANNING ACROSS MAHALUNGE TO HINJAWADI PHASE 1.



5 STAR LUXURY TOWNSHIP CLUB\* WITH PREMIUM LODGING & FACILITIES FOR GUESTS

As you enter Township Codename Blue Waters, you will find yourself immersed in the world of WOWs. The touch of VTP Realty is evident everywhere in every inch of this sprawling township. Be it design or the build quality,

be it internal road planning or in lifestyle curation – everywhere you will be wowed by VTP’s meticulous planning where beauty is silently residing at the core of it.



KIDS ACTIVITY AND LEARNING CENTRE



HIGH STREET SHOPPING



CONVENIENCE STORE



HOSPITAL



SCHOOL

\*Township amenities will be chargeable





HORSE RIDING ACADEMY



BADMINTON ACADEMY



TENNIS ACADEMY



SWIMMING ACADEMY



CRICKET ACADEMY

PLEASE NOTE : ALL ACADEMIES USAGE WILL BE CHARGEABLE.

# 5 PROFESSIONAL SPORTS ACADEMIES

The township has 5 Professional Sports Academies Cricket, Swimming, Badminton, Lawn Tennis & Horse Riding operated by professional & celebrity coaches with international competition-level courts & facilities.

These academies are pay-per-use hence **not burdening the residents with the additional cost of the celebrity endorsements, setting up and operations of the academy infrastructure.** Now that's WOW!

## TOWNSHIP HIGHLIGHTS

Multiple Grand Entrance Plazas

Well-planned Internal Roads

Around 1km. riverside promenade

Police Station, Fire Station & Bus Stop

Large Landscaped Zones

School & Creche

5-Star Club & Spa

Multi-tier Security

Yoga & Fitness Centre

TOWNSHIP CODENAME  
**BLUE WATERS**



**THOUGHTFULNESS** IS  
AMENITIES MADE FOR  
EVERY GENERATION

**BEAUTY** IS FOUND  
IN EVERY SHAPE AND DESIGN  
WHEN YOU LOOK AROUND



## BEAUTIFUL AMENITIES THOUGHTFULLY CRAFTED **FOR YOU**

- VTP Realty has carefully planned large-sized amenity spaces on the ground & podium level for more families to enjoy together
- Beauty and thoughtfulness have been consciously engrained in each of the amenities, both in their aesthetic appeal and their purpose.
- The amenities are designed such that all generations can find something interesting for themselves.
- 2 club houses - one on the ground level & the other on the podium level
- Both club-houses are the center pieces of the project, stunningly designed in glass with spectacular shape and form. Both house multiple indoor games and have space for gatherings.
- The 'tulip' flower shaped swimming pool with designer tiles and in-pool lighting is a sight destined to leave you in awe.





ELEVATION VIEW WITH PODIUM LEVEL CLUBHOUSE





ELEVATION VIEW WITH PODIUM LEVEL CLUBHOUSE



# MASTER PLAN



## AMENITIES FOR TODDLERS

- 1 TRI-CYCLE TRACK
- 2 KIDS' POOL
- 3 KIDS' PLAY AREA

## ACTIVITY PLACE FOR TEENAGERS

- 4 INDOOR GAMES ROOM
- 5 MULTIPURPOSE COURT NET CRICKET
- 6 TENNIS COURT
- 7 CHESS PLAZA

## SPACE FOR ADULTS

- 8 GYMNASIUM
- 9 CYCLE TRACK
- 10 JOGGING TRACK
- 11 PUT-PUT GOLF

## UNWINDING SPACE FOR SENIORS

- 12 ACUPRESSURE PATHWAY
- 13 SENIOR CITIZEN PLAZA
- 14 PERGOLA WITH SEATS
- 15 MEDITATION AREA

## FAMILY ZONES

- 16 LIBRARY
- 17 FOOD PLAZA
- 18 CLUBHOUSE
- 19 MULTIPURPOSE HALL
- 20 DESIGNER SWIMMING POOL
- 21 PARTY LAWN
- 22 AMPHITHEATRE
- 23 THEME WALL WITH WATER SPOUTS





PODIUM LEVEL AMENITY ZONE

ARTISTIC IMPRESSION



# TODDLERS



YOUR LITTLE ONES WILL GROW  
UP KNOWING THE BEAUTY OF  
ACTIVITY EMBRACED BY SAFETY

TRI-CYCLE TRACK

KIDS' PLAY AREA

KIDS' POOL



TRI-CYCLE TRACK



KIDS' PLAY AREA



KIDS' POOL





THE YOUNGSTERS WILL  
ALWAYS BE ENERGIZED WITH  
MULTIPLE OPTIONS

MULTIPURPOSE COURT

TENNIS COURT

OUTDOOR CHESS

INDOOR GAMES ROOM



MULTIPURPOSE COURT





TENNIS & MULTIPUPOSE COURT

ARTISTIC IMPRESSION



# ADULTS



THE ADULTS WILL HAVE A  
LARGE COMMUNITY TO PLAY  
& PARTY

GYMNASIUM

PUT-PUT GOLF

CYCLING & JOGGING TRACK



GYMNASIUM



CYCLING & JOGGING TRACK

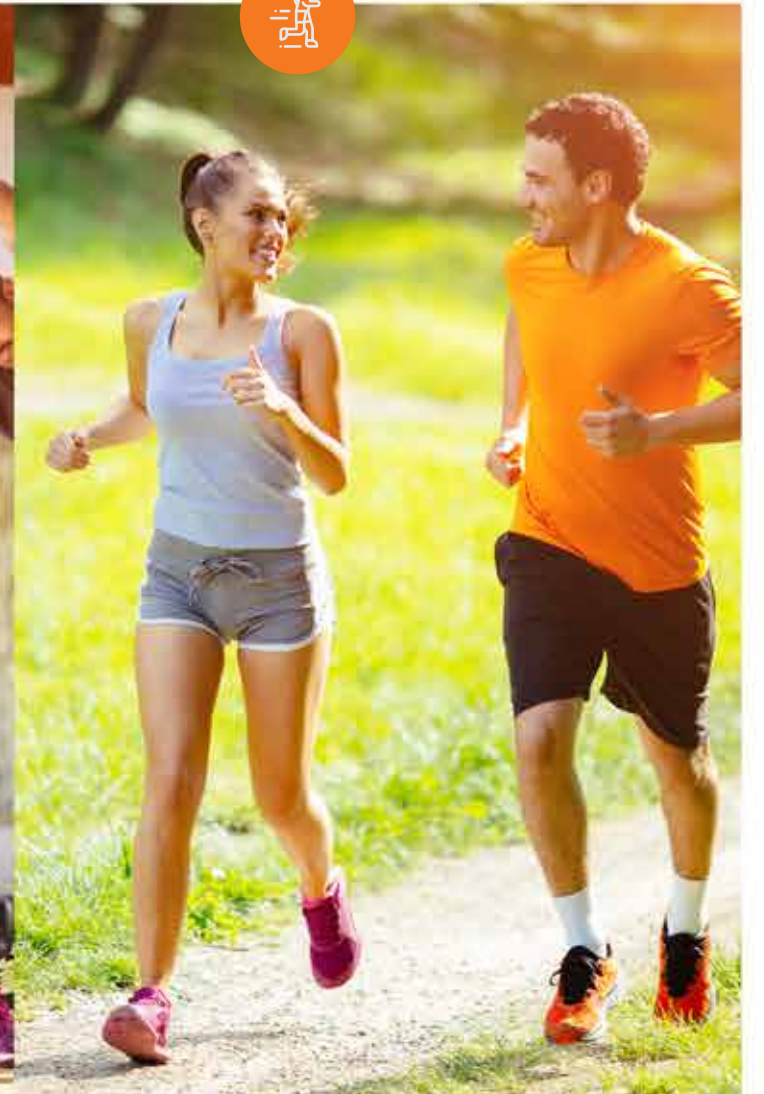

PUT-PUT GOLF



# SENIOR CITIZENS



ACUPRESSURE PATHWAY

SENIOR CITIZEN PLAZA

MEDITATION DECK

SEATING AREA WITH WOODEN PERGOLA

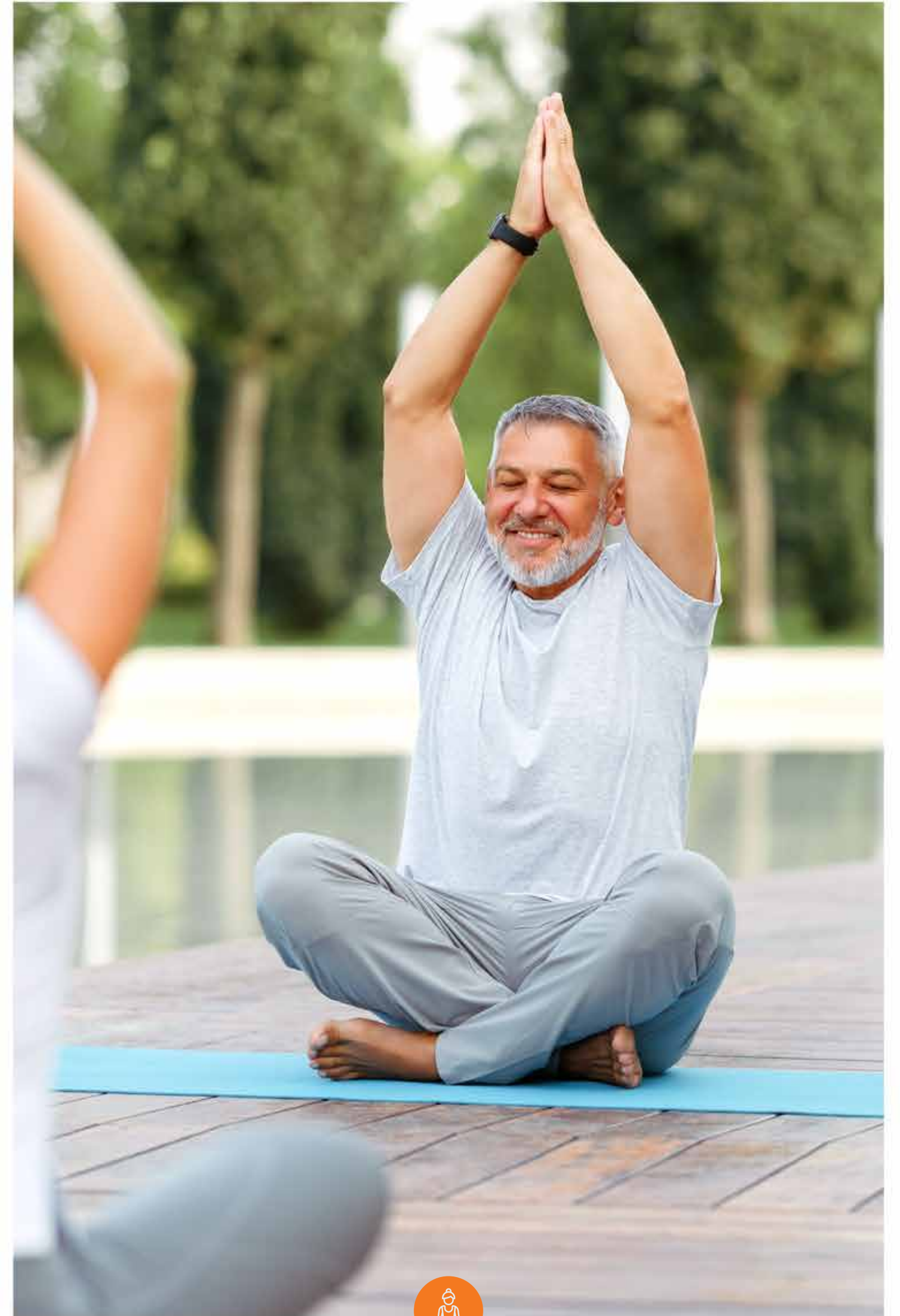

MEDITATION DECK





SENIOR CITIZEN PLAZA & SEATING AREA WITH WOODEN PERGOLA

ARTISTIC IMPRESSION



# FAMILY



A HOME IS WHERE  
THE FAMILY ENJOYS TOGETHER

CLUBHOUSE

LIBRARY

MULTIPURPOSE HALL

DESIGNER SWIMMING POOL

PARTY LAWN

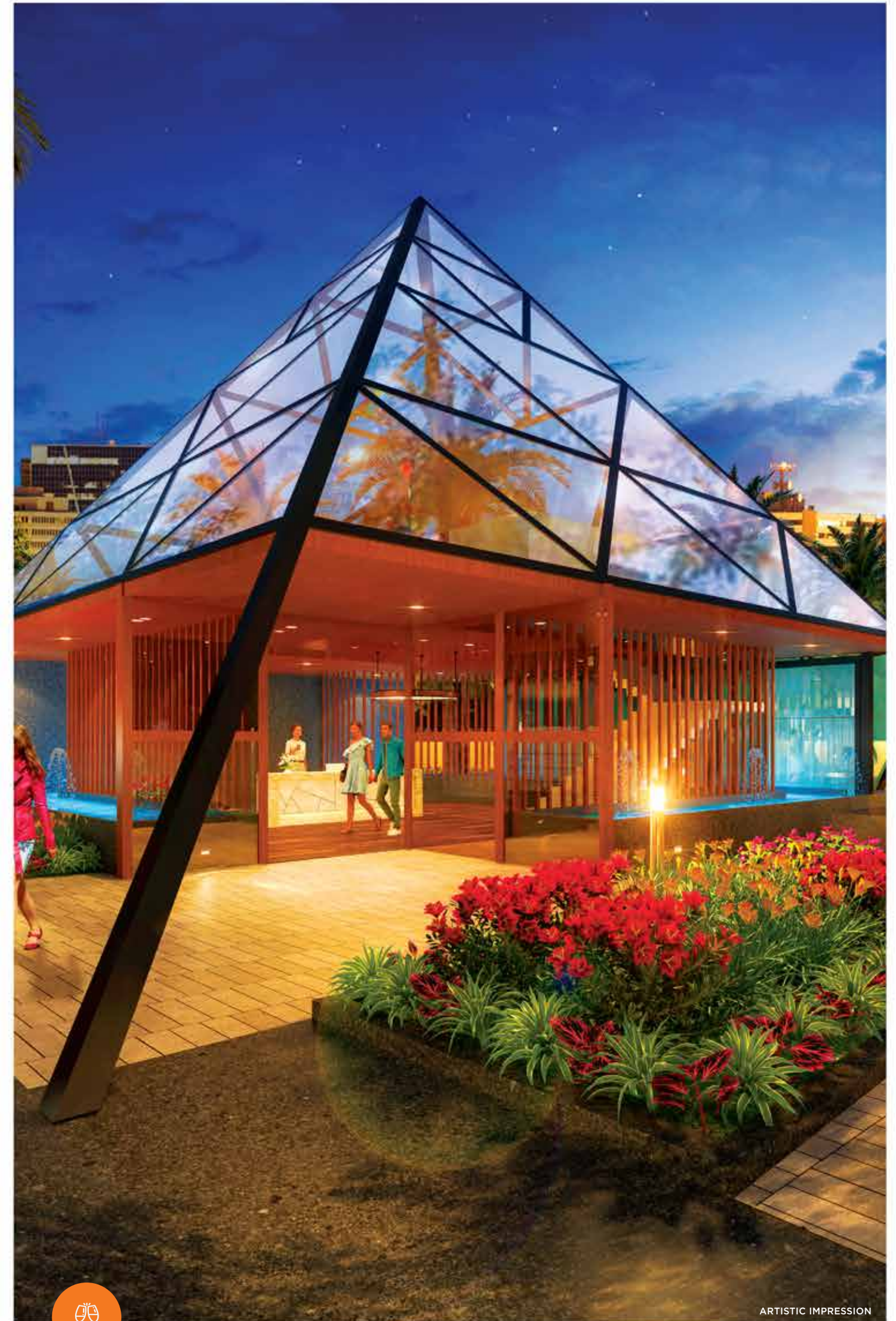

CLUBHOUSE AT GROUND LEVEL

ARTISTIC IMPRESSION





CLUBHOUSE AT PODIUM LEVEL

ARTISTIC IMPRESSION





CLUBHOUSE AT PODIUM LEVEL

ARTISTIC IMPRESSION





PARTY LAWN & PODIUM LEVEL CLUBHOUSE

ARTISTIC IMPRESSION





DESIGNER SWIMMING POOL

ARTISTIC IMPRESSION







**BEAUTY** IS  
IN THE STUNNING ELEVATION,  
LAVISH AMENITY DESIGN AND  
OPULENT INTERNAL FINISHES.

**THOUGHTFULNESS** IS  
IN THE MAXIMUM LIVEABLE  
AREA DESIGN, WHICH PROVIDE  
BIGGER ROOMS AND THE  
VARIOUS LAYOUTS & SIZE  
OPTIONS TO CHOOSE FROM.



## CARPET AREAS ARE A THING OF THE PAST. ENJOY THE **MAGIC OF MLA.**

**VTP Bellissimo** is crafted from the scientific design approach created by VTP Realty called the **MLA or Maximum Liveable Area**. The smart planning of this abode ensures that every space in your home is given a definite purpose to enable a zero space wastage living. Along with this intricate planning, **VTP Bellissimo** also presents the pleasure of choosing an apartment layout and size from a wide variety of options, so that you may find a home that truly fits your life and style.

### HIGHLIGHTS OF MLA HOMES

MAXIMUM SPACE UTILIZATION

MINIMAL WASTAGE

MULTIPLE APARTMENT  
LAYOUT AND SIZE OPTIONS

FINEST INTERNAL FITTINGS



**BEAUTY**  
REFLECTS EVEN IN  
THE MINUTEST  
AESTHETIC DETAILS

**THOUGHTFULNESS IS**  
REFLECTS IN THE CHOICE  
OF FITTINGS & FINISHES THAT  
GIVE YOUR HOME A MODERN  
APPEAL FOR YEARS TO COME





# #1

**MAXIMUM LIVEABLE  
AREA HOMES** WITH ME-  
TICULOUS PLANNING &  
EFFICIENT SPACE  
PLANNING LEADS TO  
**HOMES WITH MINIMAL  
WASTAGE**

# #2

THE MLA MAGIC  
ALLOWS FOR  
**LARGER ROOM  
DIMENSIONS** IN THE  
SAME CARPET AREA

THE SIGNATURE WOW ELEMENTS

**#ONLYINVTPHOMES**



# #3

LARGE WINDOWS IN  
ALL ROOMS FOR **24/7**  
**NATURAL LIGHT &**  
**VENTILATION**

# #4

**FEATHER-LIKE TOUCH**  
**PAD SWITCHES** IN EVERY  
HOME & **SMART HOME**  
**AUTOMATION** FEATURES  
FOR A FUTURE-READY  
HOME

THE SIGNATURE WOW ELEMENTS

**#ONLYINVTPHOMES**



# #5

THE FIRST IMPRESSION MATTERS. WHICH IS WHY OUR ALL MAIN DOORS ARE **VENEER FINISHED WITH DIGITAL LOCK**

# #6

FOR LONG LASTING IMPRESSION WE OFFER **PREMIUM PLASTIC EMULSION PAINT** FOR INTERNAL WALLS

THE SIGNATURE WOW ELEMENTS

**#ONLYINVTPHOMES**



# #7

**LARGE SIZED, MARBLE  
FINISHED, GLAZED  
VITRIFIED TILES** IN THE  
LIVING AREA

# #8

SPACIOUS BATHS  
WITH **DESIGNER  
TILES, PREMIUM CP  
FITTINGS &  
SANITARYWARE**

THE SIGNATURE WOW ELEMENTS

**#ONLYINVTPHOMES**



# #9

OUR DECKS, TERRACES  
AND BALCONIES **HAVE**  
**PVC FALSE CEILINGS**  
**WITH PRE-FITTED**  
**DECORATIVE LIGHTING**

# #10

**TOUGHENED GLASS**  
**AND STAINLESS STEEL**  
**RAILINGS** WITH PAR-  
TIAL MASONRY WALL  
AT THE BOTTOM FOR  
ALL DECKS

THE SIGNATURE WOW ELEMENTS

**#ONLYINVTPHOMES**



# BEAUTIFULLY THOUGHTFUL FINER DETAILS

## PROJECT LEVEL

- Tower 1 & 2 - Stilt parking + 29 storeys
- Tower 3 to 6 - 4 levels parking + 26 storeys
- 2 grand entrance gates with security cabin
- Access-controlled stylish entrance lobbies for every tower
- 100% DG back-up for lifts & common areas
- Electric vehicle charging points in the common area
- Common washroom for drivers in the parking area
- Superior quality apex / texture / protective exterior paint
- Earthquake resistant RCC structure + ALUFORM construction

## INSIDE YOUR HOME

### SMART HOME FEATURES

- Digital lock - Yale or equivalent
- Feather-like touch pad switches
- Smart Home Automation Control Hub - You can control your lights/mood lights, AC, Fan & Geyser via a mobile app. Also compatible with Alexa\* voice command
- Motion sensor lights in all baths
- 3-tier security system and video door phone connected to the smart phone

### INTERNAL FLOORING

- 1200 x 600 mm large sized glazed vitrified tiles For 850 sq.ft. onwards - 1800 x 1200 mm in living, dining, kitchen & lobby & 1600 x 800 mm in bedroom
- Anti-skid ceramic tiles - Dry balcony & terraces

### INTERNAL WALL FINISHES

- Premium plastic emulsion paint
- Lustre paint (1200 sq.ft. onwards)

### DOORS

- Premium veneer finished main door with digital lock
- Bedrooms & bathrooms - Laminated flush doors

### WINDOWS

Powder coated aluminium sliding windows

### KITCHEN

Granite kitchen platform with Stainless Steel sink  
Ceramic/glazed tiles above kitchen platform of 2 feet  
Provision for water purifier

### BATHROOMS

Granite door frames  
CP & Sanitary fittings - Grohe / American Standard / Kohler or equivalent  
Stylish hand shower with rain shower head in all master baths  
Glass partition in master bathrooms (850 sq.ft. onwards)  
Walk-in-wardrobe & shower cubical with bathtub (Only in 1450 sq.ft.)  
Flooring - Anti-skid tiles  
Designer decorative wall tiles upto 7 feet  
Geyser point in all bathrooms

### PLUMBING

Concealed anti-corrosive plumbing

### TERRACE / BALCONY

Toughtened glass & Stainless Steel railings with partial masonry wall in bottom  
PVC false ceiling for terraces/balcony area with decorative lighting

### ELECTRICAL

Switches - Anchor / Legrand / Schneider / L&T or equivalent  
Concealed copper wiring with M.C.B.  
Electric points with TV & telephone points in living room, master bed room  
AC points in all rooms except kitchen

### POWER & SAFETY

Provision for inverter  
Fire sprinklers in each room





# THE LEGACY OF A GAME CHANGER

Disruption is in our DNA. The prospect of changing the game gets us going. Challenging the status quo, questioning the conventions, and always attempting something new. Today, this disruptive streak runs throughout the group thanks to our inceptor Mr. Vilaskumar Thanmal Palresha. VTP.

We broke through the monopoly cartels when we debuted as a cement dealership decades ago. We added new construction materials in our portfolio year after year. We didn't just have passion, but also, foresight. Making right decisions, seizing right opportunities, turning them into game-changers, we have emerged as one of the most formidable conglomerates in the real estate sector. We are proud to have cultivated a legacy that stands unrivalled since our inception in 1985.

VTP, the man and the group, are relentless in the pursuit to be the best at whatever goal we choose. Our cement and core construction materials business, VTP Materials, is the No.1 dealership in Maharashtra and amongst the top 5 across the country. Our infra development company, Viraj Projects, is one of the India's top names for construction contracting and

government infra projects. VTP Realty, our real estate development company, is currently developing over 1.50 crore square feet. It has been ranked No.1 in Pune, in sales revenue, for 4 years in a row.

What started as a spark in a young entrepreneur's heart in Pune way back in the 80's, is today a very strong foundation of a group, that is at the forefront of the city's real estate development. We are very proud to have contributed to redefining Pune's skyline. We have set the cornerstone, quite literally, of most of the iconic structures of the city, in the last 37 years. We have contributed to the transformation of every pin code of Pune, as an end-to-end real estate group.

Never to rest on past laurels, we are most passionate about setting new benchmarks in every sector we work in. Not just to be the best, but also, be the innovators and the turnaround specialists. We carry on the legacy that is VTP.



# A WORLD OF THOUGHTFULNESS

Fondly referred to as the "turnaround specialist" of Pune, VTP Realty is changing the way real estate industry operates. Years of sweat and goodwill has helped VTP Realty emerge as the leading real estate brand of the silicon valley of Maharashtra. VTP Realty has turned large stuck projects into success stories. The case in point being Township Codename Pegasus and Township Codename Blue Waters in East and West Pune.

We also benefit from the 37-years legacy of our group in the construction industry. We source 70 % of our construction materials from our group companies through backward integration, enabling us to deliver better quality homes in a shorter time span.

VTP Materials, a leading cement supplier in West India holds No. 1 position in Pune and No. 2 in Maharashtra.

Viraj Projects, also under the flagship of VTP Group is one of renowned infrastructure development and construction contracting companies and boasts of almost every national developer as their customer. We have successfully established our leadership in every industry we operate in.





# 3-TIER PHILOSOPHY



## BETTER DESIGN

Layouts that maximize the potential of each room offering more usable space inside a home, upgraded premium specifications, amenities for every family member and better value for money.



## BETTER BUILD

VTP Group has over 35 years of experience in construction material sourcing • Constructed close to 100 projects across the country • Backward integration that allows easy access to the best construction materials • A pioneer to have used latest construction technology in India.



## BETTER CARE

No transfer fee • Community Building programs after possession • Professionally-managed team facilitating leasing and resale of property • V-Care Customer Portal for single window communication with customers.

# THE BRAND PROMISE OF VTP



## MLA ADVANTAGE OF BIGGER ROOMS

Intelligent plan with zero wastage. Maximum usable spaces. Bigger room dimensions in same carpet area.



## HIGH BUILD QUALITY

Uncompromising approach towards quality and durability. Multi-level quality audits both by internal & 3rd-party teams.



## RIGHT PRICED PRODUCTS

Value creation at any price point. Our product justifies the price they command.



## TRANSPARENT TRANSACTION

Fixed & fair price policy. Same price for all channels. No hidden costs.



## CUSTOMER CENTRIC APPROACH

Our customers are central to our product design and service processes. We aim for customer delight in every aspect.



## POST SALES & POST POSSESSION SUPPORT

Hand-holding customers till they move in, and even beyond.



## HIGHER RETURN ON INVESTMENTS AND BETTER RENTALS

Strategic locations, futuristic features and specifications, grand amenities ensure greater ROI. Maximum end users living make sure our projects also get higher rentals.



# STELLAR DELIVERY ACROSS PUNE



## OTHER DELIVERED PROJECTS

### RESIDENTIAL

VTP Celesta - 3 BHK - NIBM | VTP Urban Soul - 2 BHK - Kharadi  
VTP Urban Nirvana - 2 & 3 BHK - Kharadi  
VTP One - 1 BHK - Kharadi | Landmark - 1 & 2 BHK - Undri

### SCHOOLS

VIBGYOR Roots & Rise School - Chinchwad & Wagholi  
EDEN International School - Talegaon

### COMMERCIAL

KP Square - Chinchwad | VTP HOUSE - Viman Nagar | Landmark - Undri  
Hotel Cypress - A Luxury Hotel in Kalyani Nagar

# IT'S GREAT TO BE RECOGNIZED BY THE MOST RECOGNIZED



At VTP Realty we take pride in being the torch-bearers of a new era and these awards prove that our efforts are well-thought and well-appreciated.





# NO. 1 BRAND

ALWAYS RECOGNIZED BY LEADERS

# EARNED THE MONIKER

# “TURNAROUND”

SPECIALISTS OF THE INDUSTRY



DEVELOPER  
OF THE YEAR

ET NOW Real Estate & Construction Award-2022  
CNBC Real Estate Business Award - 2022  
Realty+ Excellence Awards - 2022  
Pune Times Mirror Real Estate Icons - 2021  
ET NOW Real Estate Grand Champions - 2021  
Realty Plus Excellence Awards - 2021  
Economic Times - Leadership Awards - 2021  
Zee Business Excellence Awards - 2021



CEO  
OF THE YEAR  
MR. SACHIN  
BHANDARI

ET NOW Real Estate & Construction Award-2022  
CNBC Real Estate Business Award - 2022  
Realty+ Excellence Awards - 2022  
ET NOW Real Estate Grand Champions - 2021  
Economic Times - Leadership Awards - 2021  
CIA World Awards - 2021  
Zee Business Excellence Awards - 2021  
National Awards - 2021

## INNOVATIVE LEADERSHIP BUILD STRONG FOUNDATION



YOUNG ASIAN  
ENTREPRENEURS  
MR. BHUSHAN &  
NILESH  
PALRESHA

40 Under 40 Realty Plus Awards 2021  
Asia One - 2020



BUSINESS  
LEADER OF THE  
YEAR MR. SACHIN  
BHANDARI

ET NOW Real Estate Awards - 2020



INTEGRATED  
TOWNSHIP  
OF THE YEAR  
BLUE WATERS

Realty Plus Excellence Awards - 2021  
Economic Times - Leadership Awards - 2021



INTEGRATED  
TOWNSHIP  
OF THE YEAR  
PEGASUS

Zee Business Excellence  
Awards - 2021



DEVELOPER  
OF THE YEAR  
TOWNSHIP

Realty Plus Excellence  
Awards - 2021



LUXURY  
PROJECT  
OF THE YEAR -  
VTP ALTAIR

Realty Plus Excellence Awards - 2022  
ET Business Leadership Awards - 2021  
Zee Business Excellence Awards - 2021



ICONIC  
PROJECT  
OF THE YEAR -  
VTP BEL AIR

Realty Plus Excellence  
Awards - 2021



RESIDENTIAL  
PROJECT  
OF THE YEAR -  
VTP LEONARA

Realty Plus Excellence  
Awards - 2021

Select awards of the recent years for more visit

[www.vtprealty.in/awards](http://www.vtprealty.in/awards)





THE **BEAUTIFULLY**  
**THOUGHTFUL** WORLD  
IS BECKONING YOU





[www.vtprealty.in](http://www.vtprealty.in)

Site Location : Maan Road, Hinjawadi Phase 1, Near Infosys Circle

MahaRERA Registration No. P52100033888 available at [www.maharera.mahaonline.gov.in](http://www.maharera.mahaonline.gov.in)

Disclaimer: All representations are believed to be correct and envisaged by the developer/promoter. All art renderings, illustrations, photographs and pictures contained in this brochure are an artist's impression only and the same should not be construed to be the final images/views of the final project. The printed material does not constitute a contract / offer of any type between the developer/promoter and the purchaser and shall supersede all statements, documents or representations made prior to signing of such sale and purchase agreement. Terms & conditions apply.

Blue Waters is a name which is used for the time being as a codename and not the final name of the project. This will change when the project is formally launched. The content in this magazine is only indicative and does not imply the ownership of project Township Codename Blue Waters by VTP Group / VTP Realty. Logos of VTP Realty & other projects are copyright and owned by VTP Group.