



An incredible opportunity to  
be a part of an exclusive lifestyle



**PREMIUM 2 & 3 RHK FLATS & SHOPS**

A Project by - Prime Reality, Pune

[www.primereality.co.in](http://www.primereality.co.in)



RERA No. P52100030479

# AMENITIES



DEDICATED LUXURY  
INDOOR GAME SECTION



YOGA & MEDITATION  
CENTER



WELL EQUIPPED  
FITNESS CENTER



FUTURE READY  
SMART HOME



PREMIUM  
COMMERCIAL SPACES



WORK FROM HOME  
AREA

## SPECIFICATIONS

### STRUCTURE

- Strong Earthquake Resistant RCC Framed Structure
- Brick Work - 5" Thick External and Internal walls
- Gypsum Finish for Internal Walls with OBD Paint

### DOORS AND FRAMES

- Water Proof Door with Superior Quality Fixtures and Fittings for Entrance and All Bedrooms
- Water Proof Flush Door in all Bathrooms
- Granite Door Frame for All Bathrooms

### WINDOWS

- 3 Track Powder Coated Aluminium Sliding Window with Mosquito Mesh
- MS Safety Grill with Oil Paint to all Windows
- Aluminium Louvers with Exhaust Fan Provision in Bathrooms
- 3 Track Powder Coated Aluminium Sliding Door with Mosquito Mesh for Balconies
- SS Railing with Toughened Glass for Balconies
- Granite/Marble Window Sill for all Windows

### BATHROOMS

- Concealed Plumbing with Good Quality Fittings
- Hot and Cold Mixing Units in Toilets
- Branded CP and Sanitary Fittings
- Dado Tiles up to Lintel Level in All Bathrooms
- Granite Counter Basin Outside Common Bathroom
- Concealed Flush Valve
- Wall Hung EWC Unit
- Solar Heated Water Supply in Common Toilet
- Geyser Provision in all Bathrooms

### KITCHEN

- Granite Kitchen Platform with SS Sink
- Dado Tiles up to Lintel Level above the Platform
- Water Purifier for all Flats
- Washing Machine Plumbing Provision and Electrical Point in Dry Balcony

### FLOORING

- 600 X 600 MM Vitrified Tiles For The Entire Apartment
- Ceramic Anti-Skid Tiles in Balconies, Dry Balcony and All Toilets

### ELECTRICAL

- Fire Retardant Copper Wiring with MCBs and RCBs
- Adequate Electric Point with Premium Modular Socket and Switches
- Telephone Points in Living Room
- Exhaust Fan Provision in Kitchen and All Bathrooms
- AC and TV Points in Living Room and Master Bedroom
- Provision for DTH, Broadband and Inverter

### PAINTING

- Superior Quality Damp Proof Apex Paint for External Painting
- Superior Quality OBD Paint for Internal Painting

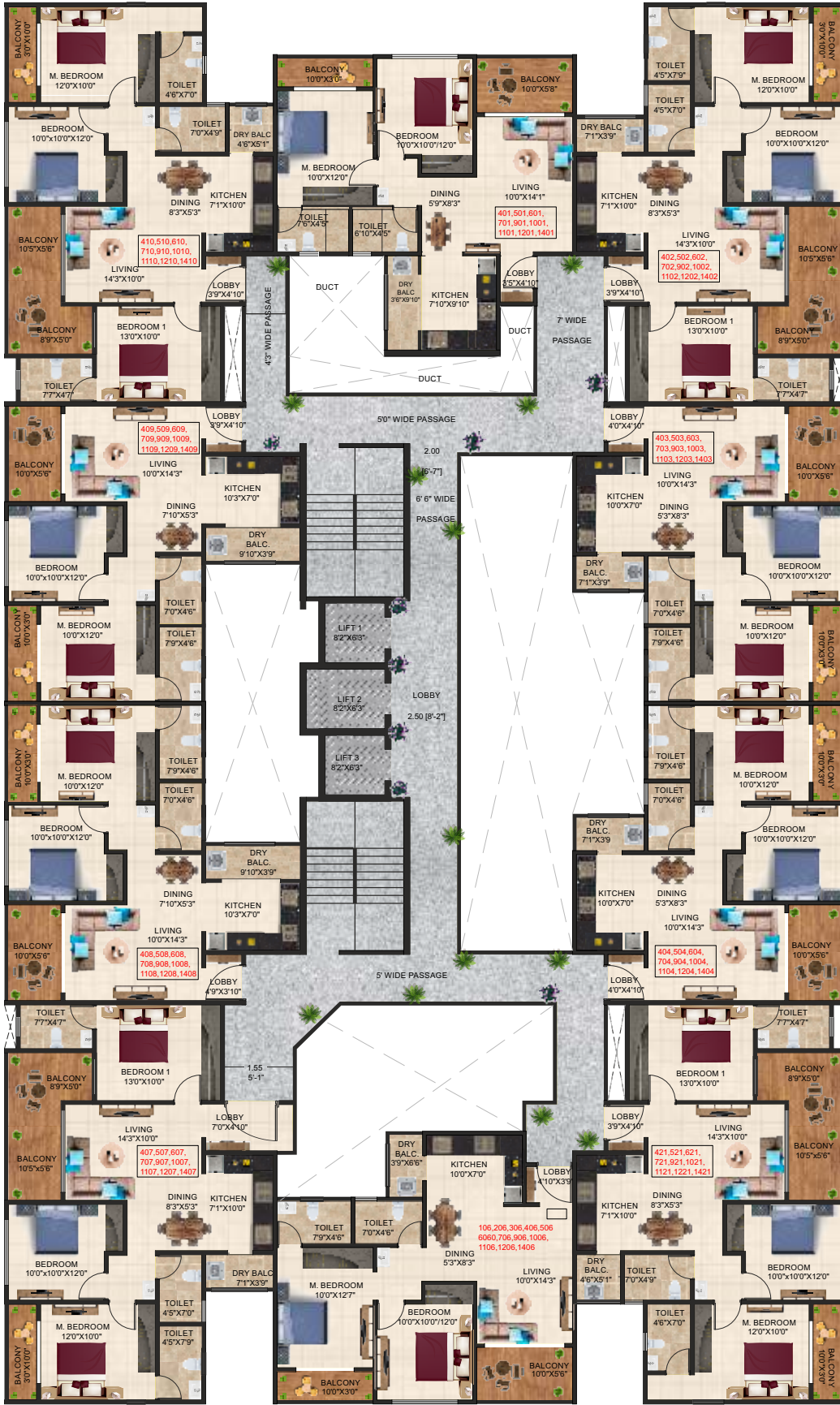

**TYPICAL FLOOR PLAN - AREA STATEMENT**

UNIT NO.	FLAT TYPE	REERA CARPET AREA		AREA OF BALCONIES		AREA OF DRY BALCONY		TOTAL CARPET AREA	
		SQ. M.	SQ. FT.	SQ. M.	SQ. FT.	SQ. M.	SQ. FT.	SQ. M.	SQ. FT.
01	2 RHK	59.74	643.04	8.01	86.22	2.85	30.68	70.6	759.94
02	3 RHK	76.06	818.71	12.15	130.78	2.26	24.33	90.47	973.82
03, 04	2 RHK	59.62	641.75	7.86	84.61	2.26	24.33	69.74	750.68
05, 10	3 RHK	77.28	831.84	12.15	130.78	2.03	21.85	91.46	984.48
06	2 RHK	60.3	649.07	7.86	84.61	2.07	22.28	70.23	755.96
07	3 RHK	77.67	836.04	12.15	130.78	2.26	24.33	92.08	991.15
08, 09	2 RHK	59.38	639.17	7.86	84.61	3.15	33.91	70.39	757.68

## KEY DISTANCES

Mumbai-Bangalore Highway	2 Min
Hinjewadi IT Park	15 Min
Reliance Mart / D Mart	10 Min
Vision One Mall / Decathlon	7 Min
Upcoming Pheonix Market City	10 Min
Schools / Colleges	10 Min
Multispecialty Hospitals	10 Min
Major Banks / ATM	5 Min

## LOCATION MAP



2RHK



3RHK



Scan the code for Site Location

**Disclaimer:** The contents including images/Renders/Pictures/Maps/Layout displayed/provided in this brochure are solely for informational purposes and are not intended to constitute an offer or solicitation. All images which are not actual photographs are artist's impressions and are indicative of the project and spaces. All layouts, plans, specifications, dimensions, designs, measurements and locations, are indicative and not to scale, and are subject to change as may be required by the competent regulatory authority. The pictures, of the proposed residential flat/commercial unit, furniture, objects, electronic goods, accessories etc. specified herein, are only for the purpose of showcasing the interior layout of the residential flat/commercial unit, and the promoter/developer is not liable to provide the same. This brochure is merely conceptual and the promoter/developer reserves the right to change, amend and modify the contents from time to time. It cannot be treated as part of the booking and/or final purchase agreement/s that may be executed from time to time. The brochure and its contents shall not be construed as any offer/promise/commitment of any nature in respect of the project.

## SITE ADDRESS

Sr No - 14/1, Next to Koyte Wasti, Near Balaji Mandir, Punawale, Pune, Maharashtra, India - 411033  
Contact No - +91 7777 877 422 | E-Mail - sales@primereality.co.in | Website - www.primereality.co.in



## Registered Office Address

Office No 18,19, Sr. No. - 3/21,  
Damodar Villa, Opp. Kothrud Bus Stand,  
Kothrud, Pune, Maharashtra, India 411038



RERA No. P52100030479  
available at:  
www.maharera.mahaonline.gov.in

**Prime  
Serenity**  
PUNAWALE