

A project by



Harihara's **SRI SAI**
VIRADHIYA

Love. Live. Leisure



PEERZADIGUDA, UPPAL



Harihara's **SRI SAI VIRADHYA**
Love. Live. Leisure

LIVE THE LIFE YOU LOVE



HIGH RISE Gated Community, in 2 Acres.



10 Floors + 2 Basements + 1 Stilt



Total Flats: 214 (3 BHK Only)



Flat Size: 1458 sft - 2359 sft



Clubhouse 12500 Square feet



AMENITIES & FEATURES



Badminton Court



Children's Play Area



Half Basketball Court



Skating Area



Elder's Sitting Area



Intercom Facility



Electric Car Charging Station



Car Wash Facility



Lush Green Landscaping



Premium Quality Construction



Vaastu-Compliant



CRAFTED WITH LOVE TO COMPLIMENT YOUR LIFESTYLE

LITTLE LUXURIES TO PAMPER YOUR INNER EPICURE

COMFORT OF A CLUBHOUSE



Swimming Pool



Conference Hall



Dining Hall



Guest Rooms



Gymnasium



Home Theater



Indoor Games



Meeting Room



Society Office



EXPERIENCE THE LIFESTYLE MEANT FOR YOU

Spread across 2 acres, Harihara's Sri Sai Viradhya is a high rise gated community located in Peerzadiguda near Uppal within 400 meters from the Warangal Highway. The luxury 3 BHK homes with modern amenities and robust architecture enable one to live life to its fullest without giving up on desires and comfort. The community is close to the urban facilities making it more desirable for those who look for a secured and flexible housing location for their family

Harihara's SRI SAI VIRADHYA

Love. Live. Leisure



SPECIFICATIONS

FOUNDATION & STRUCTURE RCC framed structure to withstand wind & seismic loads.

WALLS Cement Blocks with 8" thick external walls and 4" thick internal walls
Internal : Smooth cement plastering finish
External : Double coat cement plastering finish

PAINTING External: Textured finish or putty with 2 coats of exterior emulsion paint of reputed make
Internal: Premium Emulsion Paint of reputed make with roller finishing over luppam finish

FLOORING Living/drawing, dining, all bedrooms & kitchen: 800 x 800 mm size double charged vitrified tiles of reputed make
Bathrooms/balcony/utility: Anti-skid vitrified/ceramic tiles of reputed make
Corridors: Granite flooring as per architect design
Staircase: Tandoor Polished stone

DADOING Kitchen: Ceramic tiles up to 2'- 0" height above kitchen countertop of reputed make
Utilities: Ceramic tiles of reputed make, up to 3' - 0" height of reputed make
Bathrooms: Ceramic tiles of reputed make, up to 7' - 0" height of reputed make

DOORS Main door: Teakwood frame and hardwood teak veneer shutter with polish and SS hardware of reputed make
Bedroom doors: Teakwood frame and flush door shutter with laminate finish and SS hardware of reputed make
Toilet & Utility Doors : Teakwood frame and flush door with PU polish and SS hardware of reputed make
Balcony: UPVC sliding doors with plain glass & mosquito mesh of reputed make.

WINDOWS/GRILLS Windows: UPVC sliding windows with plain glass & mosquito mesh.
Grills: Aesthetically designed, Mild Steel (MS) grills with powder coat finish

KITCHEN/UTILITIES Granite countertop with a single bowl, stainless steel sink with bore and municipal water connection, along with provision for water purifier and washing machine

BATHROOMS Wash basins in all toilets, Diverter and Shower in all toilets, Wall-mounted WC in all toilets of reputed make, Premium CP fittings of reputed make, Power provision for geysers in all bathrooms

ELECTRICAL Concealed copper wiring of reputed make
Power outlets for air conditioners in all bedrooms
Power outlet for cooking range chimney, refrigerator, microwave oven, mixer/grinder in kitchen
Power supply for each unit Miniature Circuit Breakers (MCB) for each distribution boards, of reputed make. Switches of reputed make

TV/TELEPHONE/DATA One TV point in living room /drawing room and master bedroom and data point in living room /drawing room
Telephone & Intercom provision in living/drawing room

LIFTS High speed automatic passenger/service lifts with rescue device of reputed make
Lift lobby with granite as per architect design
False Ceiling in all Lift Lobbies.

POWER BACKUP 100% DG backup for lights and fans in all flats (excluding ACs and geysers and other heavy appliances) 100% DG backup for common areas and service/utility area

FIRE & SAFETY Fire alarm, hydrants and sprinklers as per fire regulations and norms

CAR WASH FACILITY Provision for Car Wash facility in each cellar parking area.
ELECTRIC CHARGING STATION Public Electric Charging Station will be provided at a feasible location in car parking area.

PARKING Entire parking designed to suit the requisite number of car parks at stilt and basement levels.

SECURITY 1) Sophisticated round the clock security system
2) Surveillance cameras at the main security gate, entrance of each tower, passenger lifts, children play area, and appropriate common areas

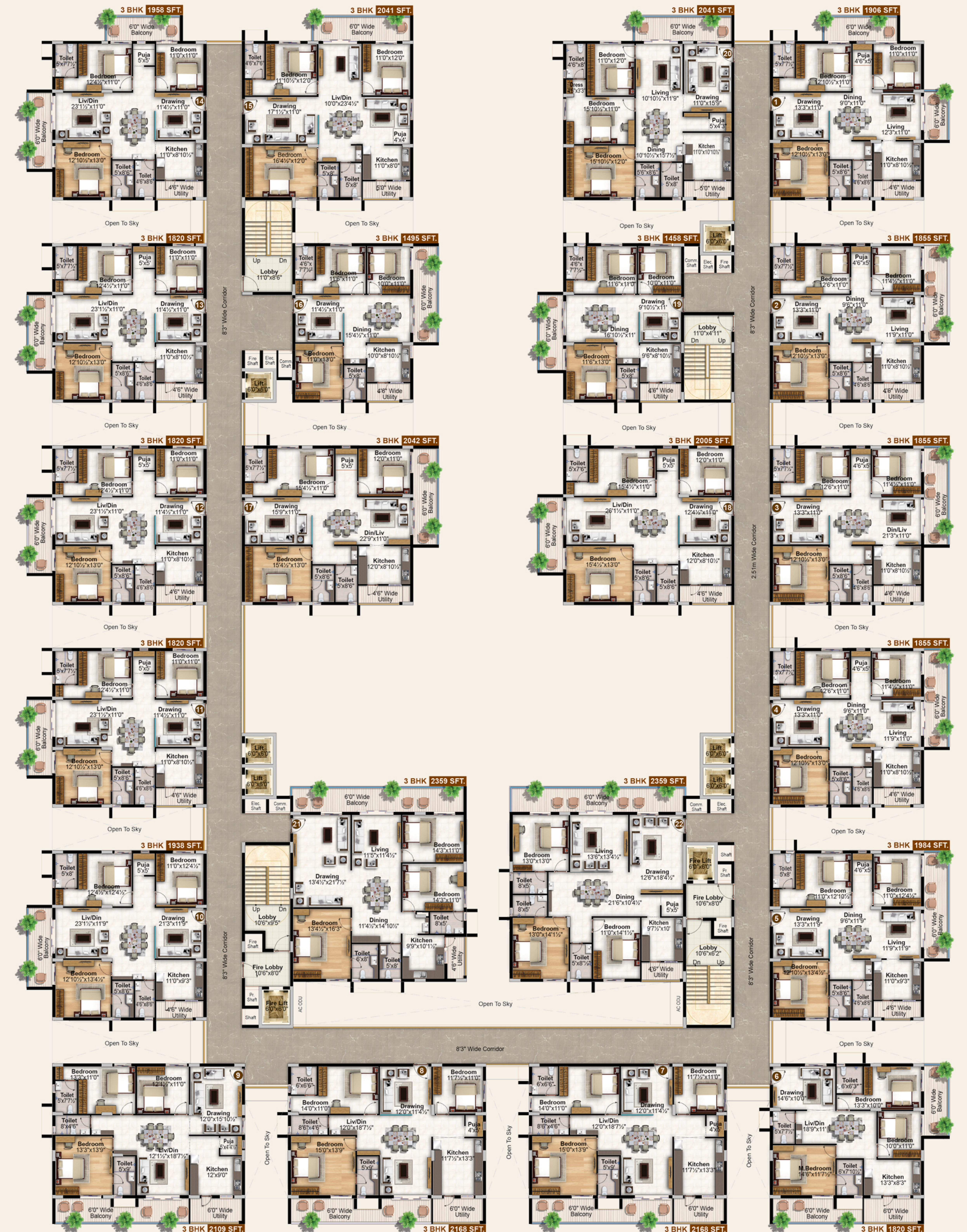



PROXIMITY

SCHOOLS

- Global Indian International School
- Kendriya Vidyalaya
- Siddhartha Public School
- Sri Chaitanya Techno School

OFFICES

- Infosys
- Genpact
- Survey of India
- NGRI

CONVENIENCE STORES

- Big Bazaar
- Asian Cine Square
- Decathlon Sports
- Metro Super Market

CONNECTIVITY

- Uppal Metro Station
- Uppal Bus Station
- Secunderabad Railway Station
- Shamshabad Airport

HOSPITALS

- Spark Hospital
- Ankura Hospital
- Aditya Hospital
- APEX Hospital

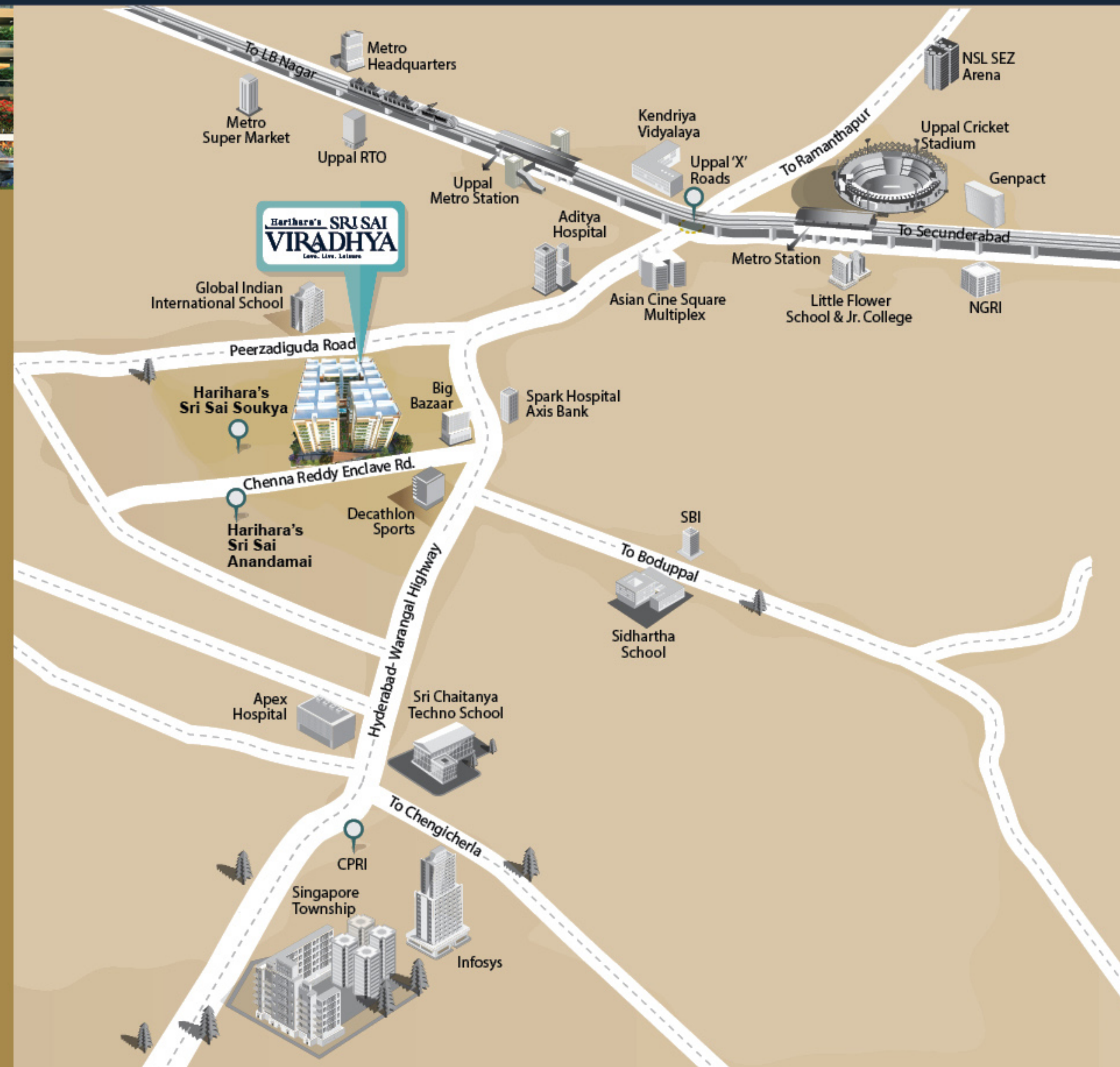

Site Address:

Chennareddy Enclave, Peerzadiguda,
Uppal Depot, Hyderabad - 500 092.

Member Of CREDAI



/hariharaestates



@HariharaEstates

Builders & Developers



SRI SAI HARIHARA ESTATES(P) LTD.

1-7-9/3, 4th Floor, Harihara Estate, Opp. ISI,
St. No. 8, Habsiguda, Hyderabad - 500 007

Contact us: +91 90667 32732, 90668 32832

e-mail: salesharihara@gmail.com,

harihara96@gmail.com

visit us at: www.hariharaestates.com

TS RERA Registration. No. P02200003663