



RECREATION GETS A NEW ADDRESS

● **OUR PRESENCE**

● **ABOUT US**

● **OUR RETAIL PROJECTS**

● **A COMPLETE RECREATION DESTINATION**

● **WHY VAISHALI (NCR)**

● **LOCATION ADVANTAGES**

● **EXPERIENCE LUXURY IN EVERY DETAIL**

CHAIRMAN'S MESSAGE

Dear Friends,

At Signature Global, we have been working passionately since last four years to create our own distinct identity in the field of real estate. We emphasize on the core values of reliability, responsibility and global standards with regard to the International real estate realm.

Signature Global has outlined its vision for 'India of Tomorrow', with a mission & vision of 'Making India Affordable' and 'Har Parivar Ek Ghar' (A home for every family).

Ours is a customer-centric organisation and the management believes in strong business ethics. In the last four years, we have successfully launched 10 affordable housing projects, all in prime localities of Gurugram, Sohna and Karnal, keeping the interests of customers supreme. Each residential project is complemented with one branded retail hub christened as Signum. The hallmark of our projects is ideal location, impeccable quality of construction, awesome amenities and reasonable prices. They are unique in terms of planning, design, quality, workmanship, transparency, customer delight and service. We are fully conscious of our quality of construction and take utmost care to use only the best of construction materials. Not just that, we are fully committed to timely delivery of our projects. And to ensure that Signature Global is using innovative technologies for achieving speed, quality and efficiency of construction. We believe in customer-oriented development with responsibility. And as we strive for timely delivery, the construction of all of our projects is going on in full swing.

It is our group's core values that differentiate us from other real estate development groups. And we have been quite successful in making our mark in the residential segment. With the same zeal and expectations, we are now foraying into Uttar Pradesh and launching our 11th project, a commercial project — Signature Global Mall in Sector 3, Vaishali, Ghaziabad. Strategically located at the border of three cities — Noida, Ghaziabad and Delhi — with strong physical and social infrastructure and excellent connectivity to Delhi through road, rail and metro, Vaishali, has emerged as a hot residential and commercial hub in the National Capital Region. With more than half a dozen malls and scores of entertainment hubs in and around Vaishali, it has today come up as a most lucrative lifestyle destination for both end users and investors. In this bustling location, our upcoming shopping mall in the midst of residential and commercial developments, and at a walking distance from Vaishali Metro station, will delight the residents with its unique offerings.

Leading a team of highly enthusiastic professionals is always an enjoyable task. The same becomes even more interesting when the society starts recognizing and rewarding your efforts. In the last one year, we have won several awards from several prestigious media houses for our outstanding contribution to real estate. We were awarded as 'Haryana's Icons' & 'Emerging Developer' by Times of India, 'Business Leaders in Affordable Housing' by ASSOCHAM, 'Best Upcoming Developer of the Year' by Realty Sutra, 'World Best Realty Brand Award' by Realty Fact & 'Game Changer of India Realty' & 'Best Developer of the Year Award' by Indian Realty Award. We are also adjudged as '5 Star Rating Brand' by CARE Ratings. More recently, we have got ISO 9001-2015 Certification. It is indeed a proud moment for us and I thank you all for your support.

Dear friend and patrons, as we set out to create new benchmarks, I thank you for your unstinting support that has helped us achieve all this in a short time. We have just started our journey and we shall go miles together. And in our endeavour to enrich the society at large, we will be earnestly seeking your support at every step.

Yours Sincerely



Pradeep Aggarwal



OUR PRESENCE

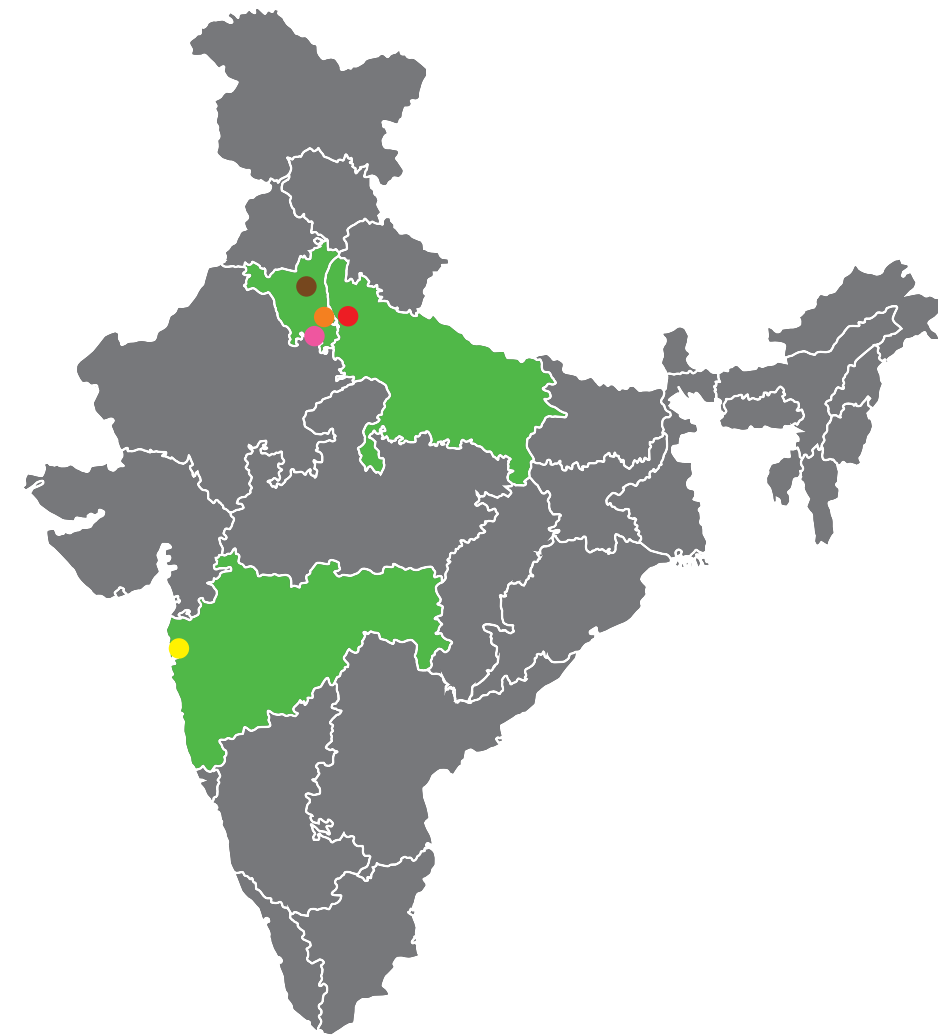

●
NEW DELHI

●
KARNAL

●
GHAZIABAD

●
GURUGRAM

●
MUMBAI

ABOUT US

Welcome to Signature Global. An ISO 9001:2015 Certified company, internationally recognized for Quality Management and committed to delivering world-class residences to meet customer satisfaction. As a brand, Signature Global stands for: Realty, Reliability and Responsibility. At Signature Global Group, we aspire to deliver India's most innovative real estate projects developed around the nation's most desirable locations. And to do so, we are powered by an accomplished and ever innovating team of experienced professionals. With a strong foundation, and an even stronger determination to succeed, the next decade will be one of dramatic growth where we will etch the Signature Global Group brand deep into the annals of residential and commercial architecture in India.



OUR RETAIL PROJECTS

 Located in Signature Global's Solera Residential Complex in Sector 107, Gurugram. Possession in 2018.

- Total area: 28000 sq.ft. (approx)
- Retail and Food Court Hub



 Located in Signature Global's Synera Residential Complex in Sector 81, Gurugram. Possession in financial year 18-19

- Total area: 21000 sq.ft. (approx)
- Retail and Food Court Hub



 Located in Signature Global's Orchard Avenue Residential Complex in Sector 93, Gurugram.

- Total area: 23000 sq.ft. (approx)
- Retail and Food Court Hub



 Located in Signature Global's The Serenas Residential Complex in Sector 36, Sohna.

- Total area: 38000 sq.ft. (approx)
- Retail and Food Court Hub



 Located in Signature Global's Andour Heights Residential Complex in Sector 71, Gurugram. Possession in financial year 18-19

- Total area: 26000 sq.ft. (approx)
- Retail and Food Court Hub



 Located in Signature Global's Grand Iva Residential Complex in Sector 103, Gurugram.

- Total area: 41000 sq.ft. (approx)
- Retail and Banquet



 Located in Signature Global's The Roselia Residential Complex in Sector 95A, Gurugram.

- Total area: 23000 sq.ft. (approx)
- Retail and Food Court Hub



 Located in Signature Global's The Millenia Residential Complex in Sector 37D, Gurugram.

- Total area: 46000 sq.ft. (approx)
- Retail and Food Court Hub



THE BEST WAY TO PREDICT THE FUTURE IS TO CREATE IT.

Signature Global's flagship commercial centres, Signum, are state-of-the-art retail centres which cater to millions. With uniquely designed shops and world class infrastructure, they are the most preferred shopping destinations for necessity shoppers and affluent spenders alike.

A COMPLETE RECREATION DESTINATION



- Signature Global Mall is primed to become the next family entertainment sensation in the NCR region and the new 'Go-to' center for all recreational needs.
- Enveloping & unfolding fine dining restaurants, brand shops and resto-bars — a paradise for epicures.
- Recreational Entertainment Indoor Zone for children.
- 'Fully Furnished Serviced Suites' by Clarks Premier with lifetime returns & royalty benefits.
- An array of recreational club amenities with pool & gym accessible through an exclusive elite royalty program.
- A plush banquet managed by Clarks Premier for celebrations & corporates, offering a premium gourmet dining experience.
- Spread across 8 floors & rooftop club full of lifestyle amenities.
- Signature Global Mall is all set to be the new 'Place to Be' in the NCR.

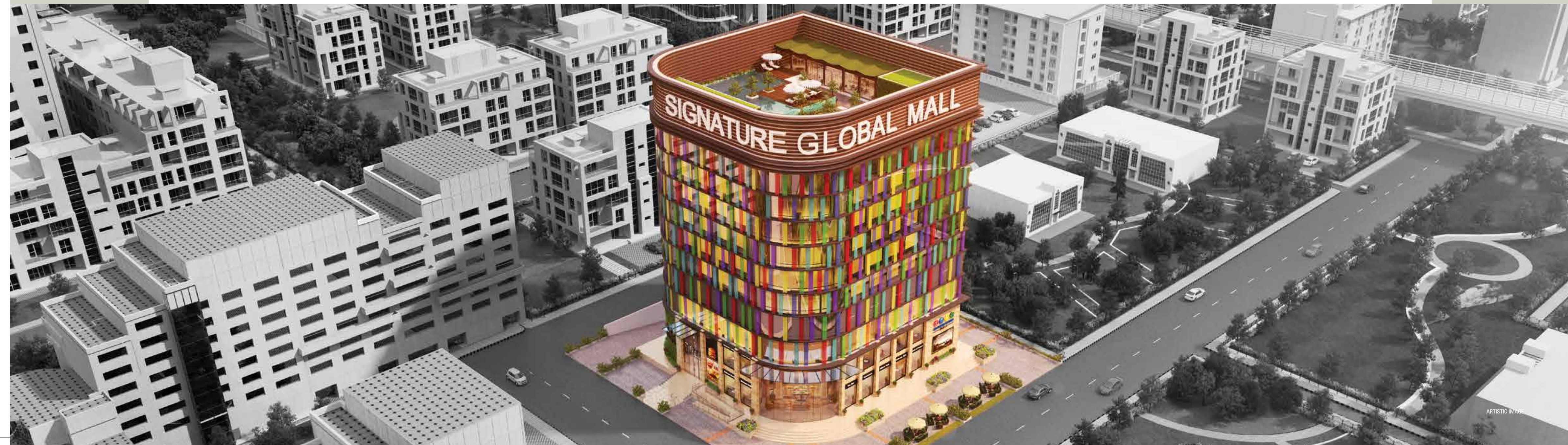



**MORE THAN 1LAC RESIDENTIAL HOMES
WITHIN A RADIUS OF 3KM.**

WHY VAISHALI (NCR)

- Vaishali (NCR) has emerged as one of the fastest and most preferred destination for residential, commercial, and industrial set-ups in Delhi / NCR.
- Due to its connectivity advantages, Vaishali has emerged as a key real estate destination within the NCR.
- The quality of infrastructure in Vaishali (NCR) has attracted many people working in multinational giants, fortune 500 companies and IT Hubs.
- There is a very high demand of commercial & retail space due to widespread residential development & robust connectivity.
- Vaishali (NCR) is a gateway to Delhi from Uttar Pradesh & Uttarakhand through NH-58 & NH-24, an existing 14 Lane Highway.



**A DESTINATION THAT
TAKES YOU PLACES
WITHOUT MAKING YOU GO FAR.**

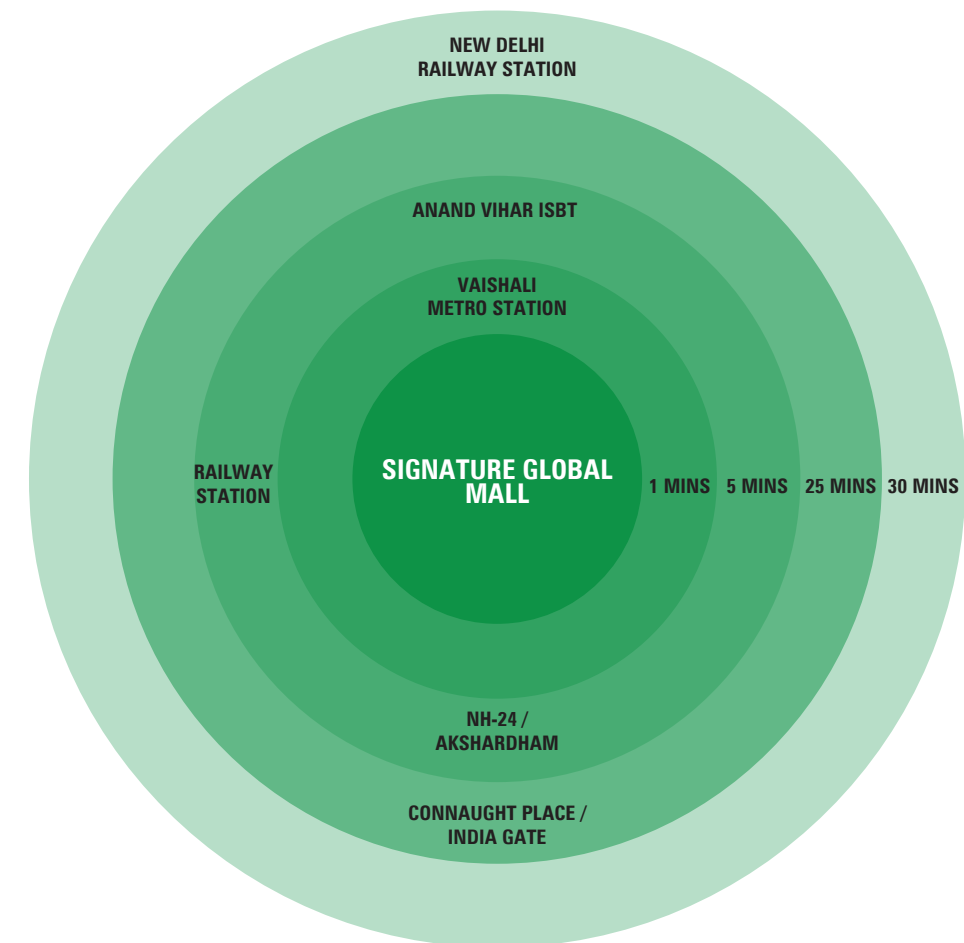

LOCATION ADVANTAGES



Walking distance from the Vaishali (NCR) Metro Station.



Multiple access from East Delhi & Noida.



Close to well-established hospitals like Max Super Speciality Hospital, Fortis Healthcare & Yashoda Hospital.



In proximity to major IT, Corporate & Institutional Hub & government offices (Noida and Delhi).



More than 1,00,000 residential apartments within a 3 km radius.

Signature Global Mall Vaishali (NCR) is located in a residential & commercial environment offering great facilities, location advantages and retail spaces as part of a mixed-use development project in Sector 3, Vaishali (NCR).

In close proximity to Sector 62-63 Noida, IT Hub & Corporates.

Vaishali (NCR), Vasundhara, Kaushambi, Noida & Indrapuram are major residential hubs.

LOCATION MAP



EXPERIENCE LUXURY IN EVERY DETAIL 4 STAR SERVICED SUITES



FAMILY ENTERTAINMENT ZONE & RETAIL



PREMIUM SERVICED SUITES FOR FAMILY & BUSINESS TRAVELLERS



ARTISTIC IMAGE

MODERN AMENITIES AND SOPHISTICATED STYLE



ARTISTIC IMAGE

URBAN ENERGY WITH GOURMET DELICACIES



ARTISTIC IMAGE

THEME-BASED FOOD COURTS



ARTISTIC IMAGE

WHERE EXCELLENCE
AND CONVENIENCE MEET



ARTISTIC IMAGE

ENJOY FLAVOURS OF WORLD CUISINE
AT AN ALL DAY DINING RESTAURANT



ARTISTIC IMAGE

ALL UNDER ONE ROOF



ARTISTIC IMAGE

FEEL GOOD SHOPPING EXPERIENCE



ARTISTIC IMAGE

WHERE EVERY EVENT IS
A CELEBRATION



ARTISTIC IMAGE

YOUR EXTRAORDINARY LIFE



ARTISTIC IMAGE

HAVING FUN IS CHILD'S PLAY.
ENJOY A UNIQUELY DESIGNED ENTERTAINMENT ZONE.



THE GAME THAT TAKES YOU THERE



ARTISTIC IMAGE

ENJOY FITNESS IN STYLE



IMAGINE THE DIFFERENCE
WITH EXCLUSIVE ROYALTY BENEFITS



THE PERFECT SOLUTION
FOR AN EVENING



CLUB
BENEFITS



A PLACE WHERE
YOU CAN INVITE YOUR
FRIENDS & FAMILY



PROJECT HIGHLIGHTS

RCC framed structure designed for zone IV earthquake detailing
Kids gaming zone promoting kids entertainment and family interaction
Fully secure through video surveillance & ample parking space
High-speed escalators & elevators of deemed brands.
Plush banquet with lavish & aesthetic interiors
Fully Furnished Suites with modern interiors & contemporary design
Food court with multi-cuisine restaurants, coffee shops, fine dining & theme-based restaurants
Retail promenade with pedestrian plaza designed sit-outs & food kiosks
Terrace garden with swimming pool & cabana seating
Lush canopy trees and landscape features
Shading of the front Plaza & Pedestrian walkways through Gazebo
Pedestrian focused circulation design ensuring an uninterrupted flow
External Elevation Cladding with Integrated LED lines of light & concealed linear lighting
Illuminated graphic line wrapping around Tower perimeter lighting the soffit
Modern & Contemporary finished Ground Floor lobby with waiting area seating and reception
Centrally air-conditioned with VRV systems for common areas & serviced suites

OUR CONSULTANTS

Façade Consultant



Concept Architect

Architect
Hafeez
Contractor

Principal Architect



Landscape Architect



Interior Consultant



ARCHITECT CONSULTANTS





Experience Luxury



ARTISTIC IMAGE



ARTISTIC IMAGE

MALL ADDRESS-PLOT NO.6, SECTOR-3 VAISHALI (NCR), GHAZIABAD, U.P. (INDIA)
www.signatureglobal.in | Email: sgm@signatureglobal.in | An ISO 9001 :2015 Certified Company
Sarvpriya Securities Pvt. Ltd. | CIN: U74900HR1995PTC032791 | UPRERAPRJ13716 dated 10.11.2017

Disclaimer: The Real Estate Regulation and Development Act 2016 and the rules made there under "RERA" has brought about significant changes to the real estate sector. Signature Global is fully committed to be comply with the provisions under RERA. Signature Global urges the applicant to inspect the site where the project is proposed to be constructed. The applicant shall not merely rely or be influenced by any architectural impression, plan or sales broucher. Hence applicant is hereby requested to contact our sales team to understand and to be well versed with the current details regarding the project before submitting an application for booking of the shop.

1 Sq.mt = 10.7639 sq.ft.