

YASH GRECIA

Exquisite 2 & 3 BHK Homes

AT DHANORI

YASH GRECIA

Superior

QUALITY | CONVENIENCE
VALUE



Artistic Impression

Dhanori

A RISING STAR IN PUNE

Known for its proximity to Vishrantwadi, Yerawada, Viman Nagar and Lohegaon, Dhanori is one of the fastest growing suburbs in north/north east Pune. Due to its unique location, Dhanori is just a few minutes away from everything important for a perfect lifestyle.

With its 22-acre lake and soon Asia's largest 450-acre bio-diversity park on Dhanori hill, Dhanori is a place bustling with activities and yet, one with nature!



YASH GRECIA

Nestled Amid NATURAL BEAUTY

Start with an invigorating view of Dhanori Hill in the morning to add extra zing to your whole day. Feel your daily stress melt away when you come back to its serenity in the evening. Envelop your home in peace and calm, rather than the noise and hustle-bustle of the city.



Artistic Impression

Conveniences NEVER TOO FAR AWAY

Dhanori is just a few minutes away from everything important for a perfect lifestyle. Minutes away from the educational hub of Viman Nagar, the best of schools and colleges are in the vicinity of Dhanori.

Entertainment is close by with bustling shopping malls like Phoenix Market City, Creativity Mall and over 30+ Retail shops in the vicinity. Dhanori also has a high density of street markets, where one can shop for fresh produce.



LOCATION MAP



QR CODE FOR GOOGLE LOCATION



Connectivity...

TRAVEL

- PUNE AIRPORT - 5 KMS
- VISHRANTWADI - 7 KMS
- KALYANI NAGAR - 9 KMS
- PUNE STATION - 12 KMS

EDUCATION

- D Y PATIL (Charholi) - 1 KMS
- St.PETERS SCHOOL - 2 KMS
- Dr MARTHEOPHILUS SCHOOL - 2 KMS
- PUNE INTERNATIONAL SCHOOL - 5 KMS
- INDIAN INSTITUTES OF ARCHITECTS - 5 KMS

HEALTH CARES

- ORCHID HOSPITAL - 1.5 KMS
- SPARSH ORTHOPEDICS - 1 KMS
- PATIL HOSPITAL - 2 KMS
- SHREE HOSPITAL - 3.5 KMS
- COLUMBIA ASIA HOSPITAL - 14 KMS

BUSINESS HUB

- COMMERCE ZONE - 8 KMS
- PANCHSHIL TECH PARK ONE - 7.5 KMS
- EON IT PARK - 12 KMS
- WORLD TRADE CENTER - 12 KMS
- MAGARPATTA CITY - 14.5 KMS

SHOPPING & ENTERTAINMENT

- BIG BAZAR (Dhanori) - 7 KMS
- PHOENIX MALL - 8 KMS
- PULSE MALL - 8 KMS
- INORBIT MALL - 8.5 KMS
- CREATI CITY MALL - 8.5 KMS

Enjoy

UBER LIVING REINVENTED

At YASH GRECIA we offer you a choice of 2 & 3 BHK elegant apartments across 5 wings. Designed to maximize space, every apartment includes a host of thoughtful gestures, Larger living room & bedrooms, a window seating, a separate dining space. Immaculately finished, your home boasts vitrified flooring in the living room, bedrooms & kitchen.

With the bathrooms & toilets bedecked with premium sanitary-ware, you have everything you need & deserve. You have everything what you need & everything what you deserve.

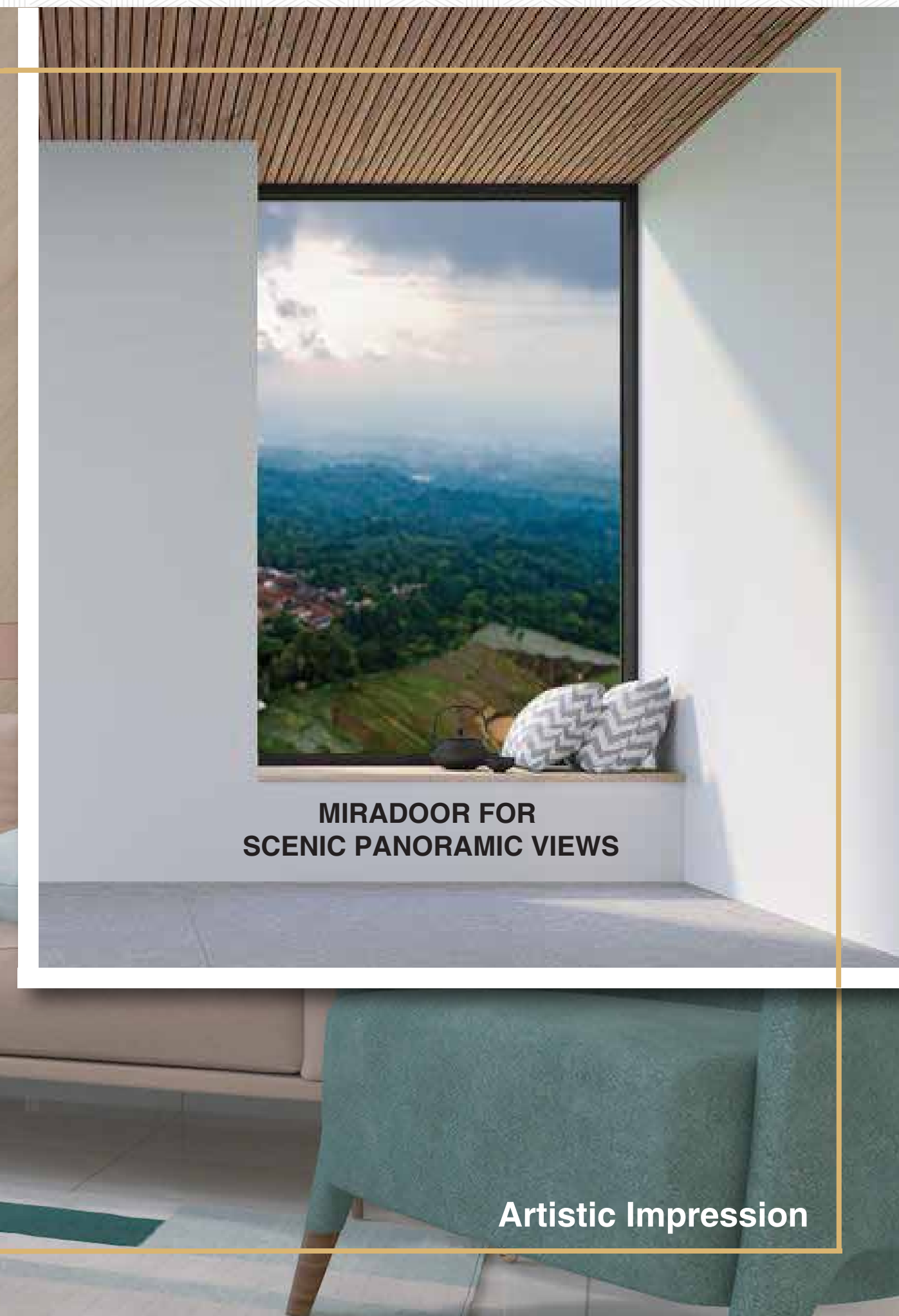

**MIRADOR FOR
SCENIC PANORAMIC VIEWS**

Artistic Impression

Specifications



STRUCTURE

- Earthquake resistant R.C.C. framed structure.



MASONRY

- External / Internal premium quality AAC block work.
- External sand faced plaster with artificial sand.
- Gypsum plaster finish to all internal walls.



LOBBY

- Elegant & Designer Entrance lobby for ground floor with name boards.
- Upper floors lobby in vitrified tiles with Skirting.
- Lobby Painted with Acrylic Paint.



ELEVATOR

- High speed Automatic lift with DG backup.



FLOORING

- 2' x 2' Vitrified Designer tiles with Skirting in all rooms.
- Anti-skid Flooring in balconies.



KITCHEN

- Granite Top Kitchen Otta with SS sink.
- Ceramic tiles dado up to 2' height.



PAINT

- Oil bond Emulsion paint for Interior walls.
- Apex Paint for External walls.



DOORS

- Both side Laminated Main door with Laminated door frame including Fixtures and rubber gasket for smooth Operation.
- M.S Railing for balconies of Living & Master Bedroom.
- Granite frame for Toilets with Both side Laminated doors & fixtures.



WINDOWS

- Powder Coated Aluminum Sliding window with Granite sill.
- Mosquito mesh for Bedroom windows.
- M S Safety Grill for all windows.



TOILETS

- Designer Tile Dado up to lintel level along with anti skid flooring.
- Concealed CP fittings along with Concealed plumbing in UPVC & CPVC Pipes.
- Good Quality Sanitary Fittings.



ELECTRICAL

- All electrical wiring is concealed with PVC fire-rated insulation wires and branded modular switches.
- Provision of TV point in common Living & Master Bedroom.
- Separate Single Phase Electrical Connection for each Flat.



PROVISIONS

- Provision for water purifier in kitchen.
- Provision for exhaust fan in kitchen and toilets.
- Provision for electrical geyser point in toilets.
- Provision for DTH and WiFi connections in living room.



SPECIAL FEATURES

- Well Gated Community
- Rain water harvesting.
- Solar Water Heating System.
- STP plant.
- Generator backup for common areas.
- CCTV cameras for Entry & Exit Areas.
- Fire fighting system.
- LED street lights for entire project.
- Organic waste controller.
- Elegant Compound Wall For Entire Community



Welcome TO THE PARADISE OF AMENITIES

With amenities and recreational facilities ensures all of life's little luxuries are right within your residential complex.

■ CLUB HOUSE

- Multipurpose Hall
- Indoor Play Area
- Toddlers Play Area/
Kids Creche
- Gymnasium
- Open Aerobics/
Yoga Area
- Sit Out Area

■ MULTIPURPOSE COURT

- Badminton Court
- Volley Ball Court
- Basketball Court

■ BABY SWIMMING POOL

■ LANDSCAPED PREMISES

■ PARGOLA SITTING

■ CRICKET PITCH

■ OPEN LAWN

■ SEATING ARENA

■ CHILDREN PLAY AREA



SHOPPING SPREES



GYMNASIUM

Artistic Impression



INDOOR GAMES



MULTIPURPOSE HALL



CRECHE



CLUBHOUSE



PERGOLA SITTING



OPEN AEROBICS/ YOGA AREA

SIT OUT AREA



BABY POOL

Artistic Impression



OPEN PARTY LAWN

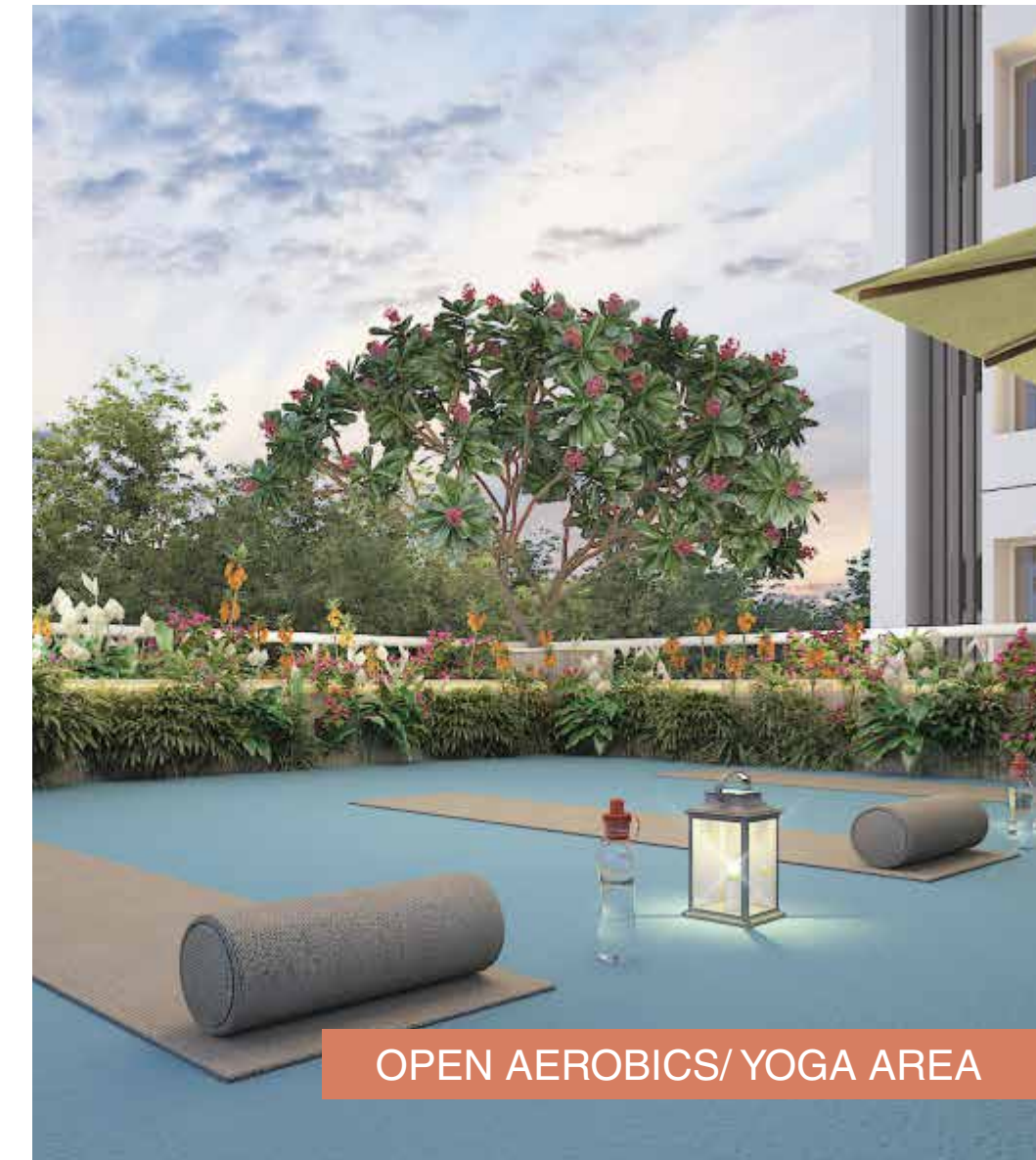

OPEN AEROBICS/ YOGA AREA



TODDLERS PLAY AREA

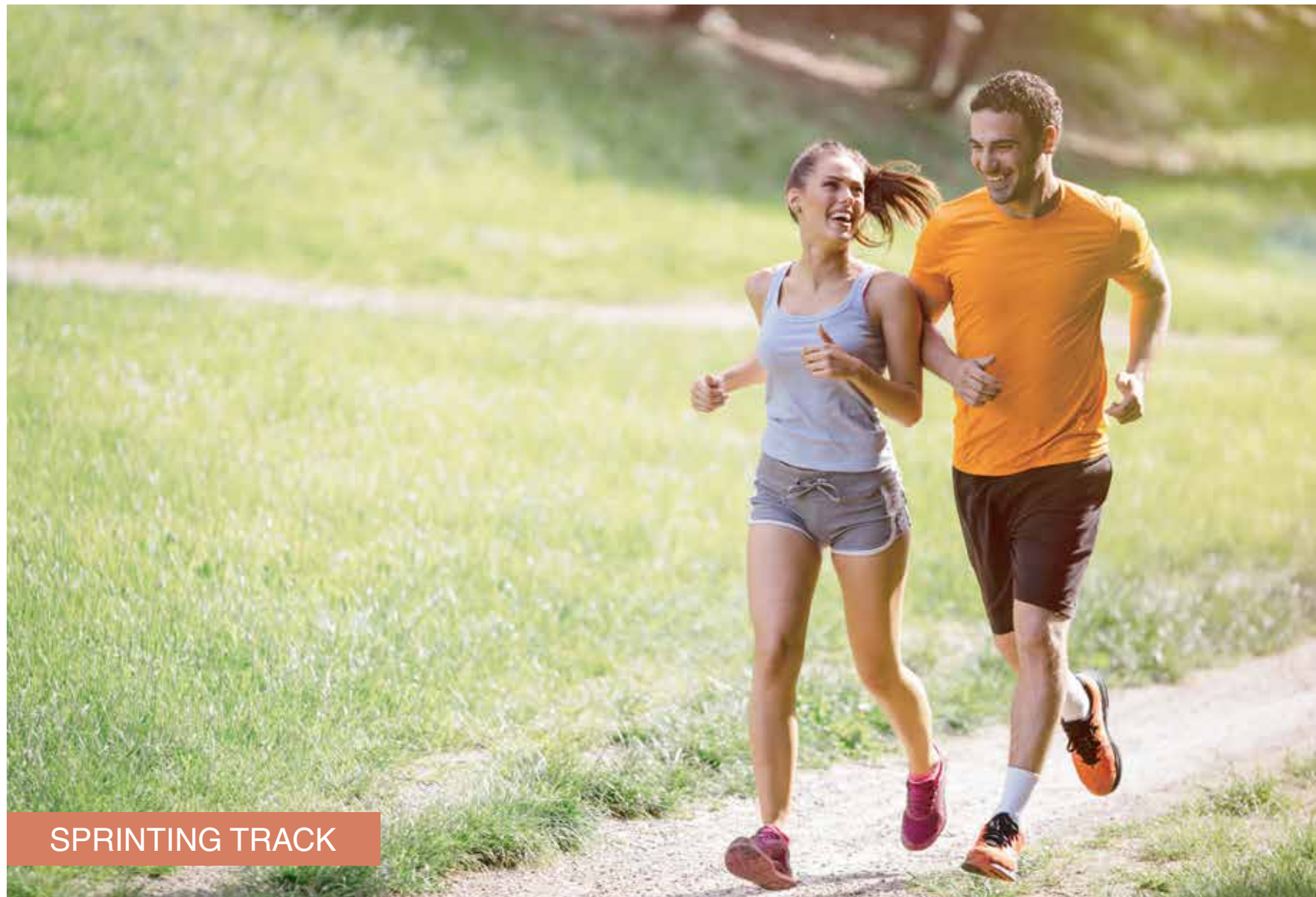

SPRINTING TRACK



CRICKET PRACTICE COURT

Artistic Impression



MULTIPURPOSE COURT



BASKETBALL COURT



BADMINTON COURT



Legends:

- 1. Club House 2. Cricket Pitch 3. Open Air Yoga 4. Baby Pool 5. Multi Purpose Court
- 6. Seating Arena 7. Jogging/Walking Track 8. Children Play Area 9. Open Lawn 10. Pergola Sitting

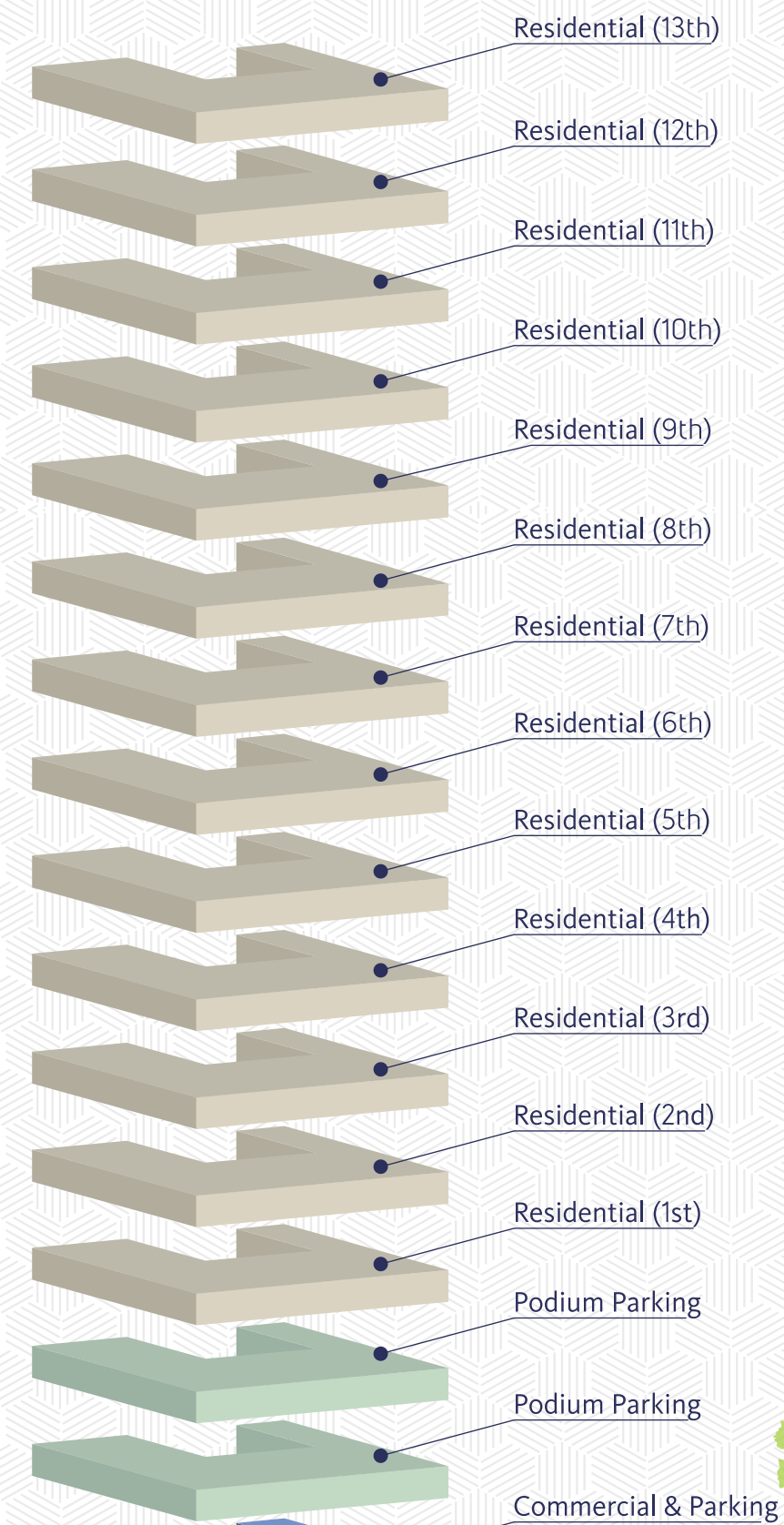

1 Commercial | 2 Podium Parking | 13 Residential Floors

Area Zoning

Established 35 years ago, Yash Promoters and Builders arose as a shining example in the construction industry. Ever since then, the victories & lessons we've lived were reborn as experiences, inspiring us to build dreams where myriads reside. Imbued with a higher purpose, we have lived up to our promise of building Dream Homes for our clients. The mystery of our success wasn't just founded on leveraging the demands, but more so in reaching out to the high-end expectations that helped us stoke a trailblazing standard. The grandeur of our ambitions & efforts entitled us to achieve the lauds of numerous people of PMC & PCMC in Pune. Being a bearer of this prestige & a proud member of CREDAI Pune, we have rendered more than 20,000 families contender. with our jubilant efforts; including our legacy in Maharashtra, includes- Yash Elina, Yash Rhythm, Yashomangal, Yashopuram, Yash Platinum, Yash Garden, Yash Classic, Yash Wisteria, Yash Sankul, Yash Orchid, Yash Bindu, Yashashri, Yashogandha, etc. with more than 5k flats all over Pune. Yash Promoters and Builders and it's sister concern, M/S Akshay Enterprises has supported reliable power while conserving resources and helping to keep our air clean by venturing into Solar power generation on 25th Nov, 2014. The installed capacity of 2MW generates approximately 36 lakh units per year at Andur, Nandurg Taluka, Osmanabad Dist. in South-Eastern part of Maharashtra.

COMPLETED / ON GOING PROJECTS

YASH ELINA (KOTHRUD)



YASH WISTERIA (WAKAD)



YASH PLATINUM (DHAYRI)



YASH RHYTHM (KONDHWA)



YASH FLORENCIA (KONDHWA)



UPCOMING PROJECTS

- 1 & 2 BHK HOMES:**
1. YASH VALENCIA (MAMURDI)
 2. NEAR HINJEWADI, PHASE-3
 3. SUS
 4. KANHE PHATA

- ROW HOUSES:**
1. TALEGAON

Artistic Impression

YASH GRECIA

Exquisite 2 & 3 BHK Homes

A PROJECT BY



Building Happiness Since 1987

CREDITS

ARCHITECT
VASTU NIRMAN CONSULTANT
AR. RAVI DANVE

RCC
SUNIL MUTALIK
& ASSOCIATES

LEGAL
LEGAL LIGHT HOUSE
ADV. RAHUL BHONDVE

LANDSCAPE
A M DESIGNS
AR. AJAY MEHTA

ELECTRICAL
VEEZ CONSULTANT

PLUMBING
APEX CONSULTANT

MEDIA
RENDERZ

FOR ENQUIRIES CALL : 9011077774

Site Office Address: Yash Grecia. S no 7/2/1, Near Ganapati temple. Next to Dhanori goathan. Dhanori. Pune

Corporate Office Address: Akshay Enterprises Off no 301-303, Yash Elina Business Bay. Behind Maruti mandir, Canal Road, Karishma chowk, Kothrud, pune. Phone No: 020-25458000/8300.

 **Maharera No.: P52100028705** www.maharera.mahaonline.gov.in

Website : www.yghomes.in Email : info@yghomes.in

Disclaimer: The information depicted herein viz., master plan, floor plans, furniture layout, fittings, illustrations, specifications, designs, dimensions, rendered views, colors, amenities & facilities etc., are subject to change without prior notification as may be required by the relevant authorities or the developer, architect, and cannot form part of an offer or contract. While every care is taken in providing this information, the developer cannot be held liable for variations. All illustrations & pictures are artist's impression only. The information are subject to variations, additions, deletions, substitutions & modifications as may be recommended by the architect or the relevant approving authorities.

