



SUCCESS
WINDSOR TOWER

2 & 3 BHK PREMIUM RESIDENCES

PRADHIKARAN



Conceptual Image

LANDMARK

Living

In Pradhikaran

A dramatic addition to the skyline of Pradhikaran, **Success Windsor Tower** is a tower of landmark residences. This 12-storeyed tower, in the buzzing neighbourhood of Pradhikaran, is the new destination of landmark living.

The project promises effortless architecture, iconic features and luxurious homes in the heart of Pradhikaran. These spaciouly planned homes are replete with contemporary specifications to help you lead a life of elegance and magnificence!

A LANDMARK *Address!*

Considered as one of the most developed western suburbs of Pune, Pradhikaran is ideally located at a commutable distance from major commercial & industrial hubs.

It is also home to some of the most reputed schools, colleges and world-class healthcare facilities. **Success Windsor Tower** is located in the close vicinity of ISKCON Temple, D Mart and next to Metro Eco Garden. This inspiring location thus provides a multitude of opportunities to explore, learn and enjoy life to the fullest.

Live at a landmark address. Live at **Success Windsor Tower!**



Lifestyle



Hospital



Work



Sports



Highway



School



Mall



Temple



Garden



A LANDMARK *Lifestyle!*

Bristling with modern conveniences and superlative amenities, **Success Windsor Tower** promises a landmark lifestyle. Enhance your living experience with our top floor recreational amenities that spark style and comfort.

From cutting-edge WFH stations to relaxing steam rooms, we present a world of luxury. Enjoy al fresco barbeque parties with the skyline views or go shopping at the integrated commercial arcade!



—
RESIDE IN
*Efficiently
Planned Homes*
—





RECREATIONAL *Amenities*

- Work From Home Station
- Lounge Area
- Gym (Indoor & Outdoor)
- Steam Room (His & Hers)
- Covered Party Area with Stage and Buffet Counter
- Indoor Games
- Multi-purpose Turf
- Meditation Area
- Children's Play Area
- Senior Citizen's Area
- Library
- Barbeque Area



Conceptual Image

LANDMARK *Energy Practices*

A landmark of green and clean living, **Success Windsor Tower** is powered by solar energy. We practice future-ready energy generation using solar energy to service the common area facilities.

Electricity generation using solar energy ensures minimum energy wastage and a sustainable way of life. Take pride in living in green and energy-efficient homes.

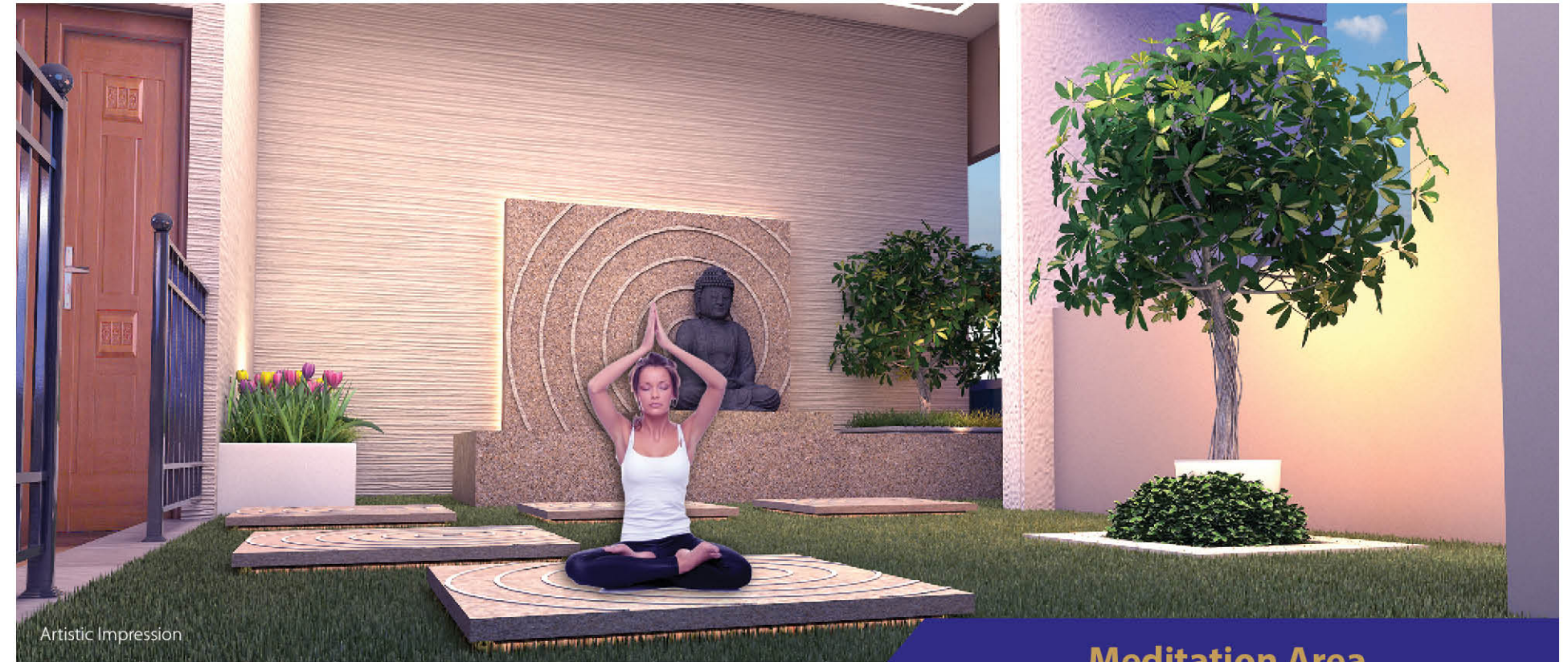

Artistic Impression

Meditation Area



Artistic Impression

Gym (Outdoor)



Library

Artistic Impression



Multi-purpose Turf

Artistic Impression



Indoor Games

Artistic Impression



Gym (Indoor)

Artistic Impression



Lounge & WFH Stations

Artistic Impression



Kid's Play Area & Senior Citizen's Area

Artistic Impression



Artistic Impression

Covered Party Area with Stage & Buffet Counter

—
**HOST
CELEBRATIONS
AL FRESCO
WITH**
Skyline Views
—





Artistic Impression

—
SHOP TILL YOU
Drop!
—



—
A GRAND
ARRIVAL TO
*Landmark
Living*
—





Artistic Impression

SPECIFICATIONS

STRUCTURE

- » Earthquake Resistant RCC Frame Structure with Specifications as per Latest Building Code

BRICK WORK

- » 4"/5"/6" Bricks (Red Brick / Equivalent)

PARKING AREA

- » Parking with Concrete Trimix / Chequered Tiles

LIFT

- » Automatic Elevators of Otis / Kone / Johnson / Equivalent
- » Power Back-up for Lift & Common Areas

PAINT (NEROLAC / BERGER / ASIAN PAINTS)

- » OBD Paint on Internal Walls
- » Weather Resistant Exterior Paint

KITCHEN

- » Black Granite Platform with Stainless Steel Sink
- » Water Purifier Connection
- » Designer Glazed Tiles Dado Up to Beam Level
- » Provision of Electrical Point for Chimney

TERRACES

- » Anti-skid Flooring
- » SS Railing with Glass

FLOORING

- » 800 X 800 mm Double Charged Vitrified Tiles in All Rooms

DOOR

- » Decorative Main Entrance Door
- » Video Door Phone
- » Safety Lock with Wooden Frame

WINDOW

- » Three Track Powder Coated Aluminium Sliding Window with Mosquito Net and Safety Grill
- » Granite Sill for Windows

TOILET / BATHROOM

- » 12" x 24" Designer Ceramic Dado Tiles
- » Sanitary Fittings (Rak Ceramics / Hindware / Jaquar / Equivalent)
- » CP Bath Fittings (Jaquar / Cera / Equivalent)
- » Provision of Electric Point for Geyser
- » Solar Heated Water

ELECTRICAL

- » Adequate Concealed Electrical Points with Polycab / Finolex / Equivalent Wires
- » Modular Switches (Anchor / Legrand / GM / Equivalent)
- » A/C Points in All Rooms
- » Electrical Point for TV in Master Bedroom & Living Room
- » Washing Machine Point in Dry Balcony
- » Provision for Inverter Point

LOBBY

- » Decorative and Spacious Entrance Lobby

STAIRCASE

- » Granite / Kota Finishing

SPECIALITY

- » Solar Electricity Generation System at Rooftop



Artistic Impression

2
BHK



Carpet Area: 752 Sq.Ft.



3
BHK
Comfort



Carpet Area: 1008 Sq.Ft.

3
BHK
Premium



Carpet Area: 1078 Sq.Ft.

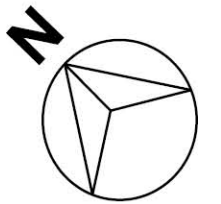
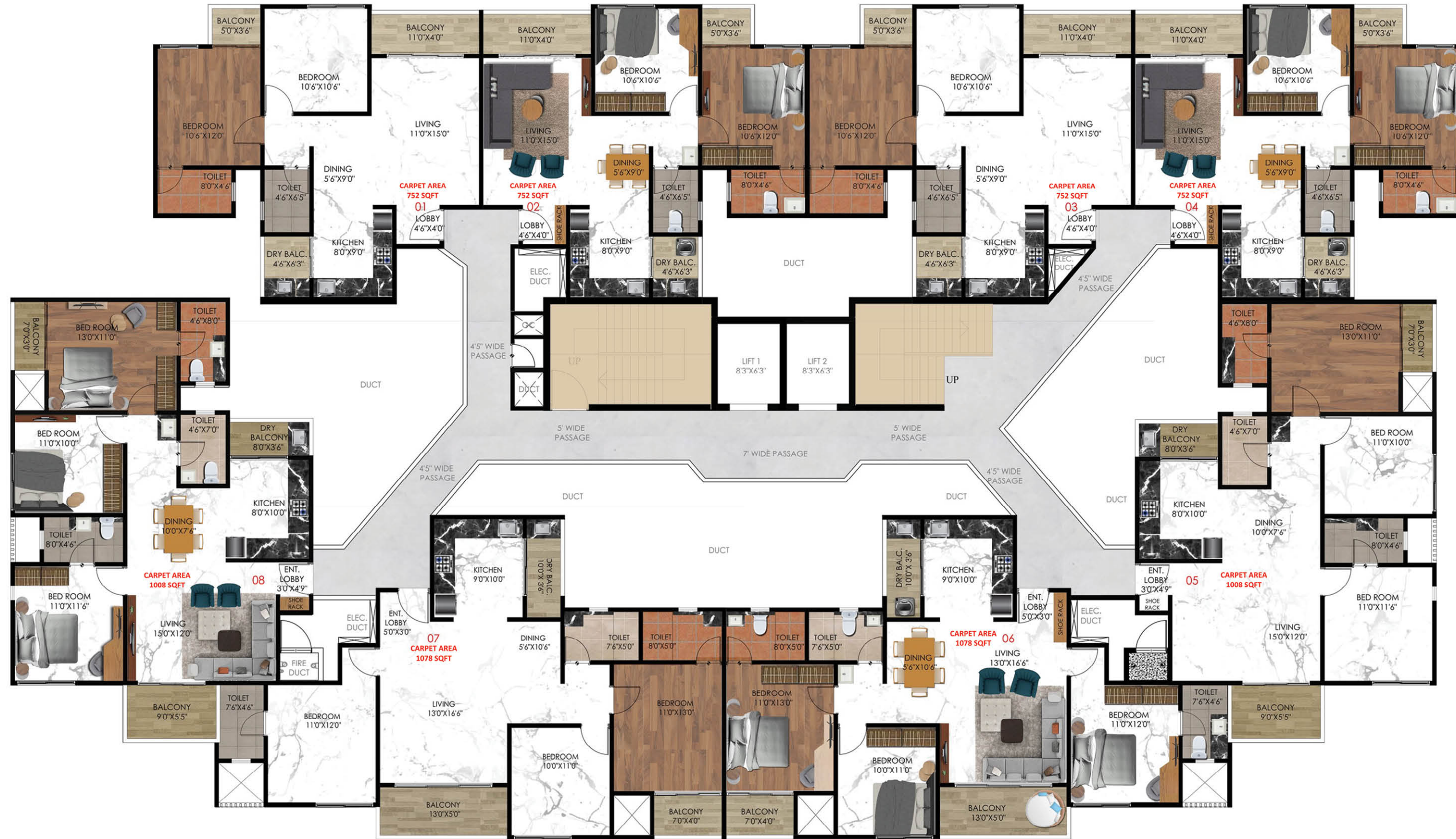

For representational purpose only

TYPICAL FLOOR PLAN



KEY DISTANCES

COLLEGES & SCHOOLS

D Y Patil College & School : 5 min
 Eurokids Pre School : 5 min
 City Pride School : 5 min
 JSPM College : 10 min
 Indira College : 15 min

RETAIL

D Mart : 2 min
 Reliance Smart : 7 min
 Big Bazaar : 15 min

RECREATIONS

G.T. Sports Club : 30 min
 Sentosa Resort : 12 min
 Vision One Mall : 14 min
 Xion Mall : 20 min

HOSPITALS

Aditya Birla Hospital : 15 min
 Lokmanya Hospital : 10 min
 Upcoming Global Multispeciality Hospital : 2 min

CONNECTIVITY

Akurdi Railway Station : 2 min
 Mumbai - Pune Exp. Way : 10 min
 Old Mumbai - Pune Highway : 10 min
 Mumbai - Bengaluru Highway : 10 min
 Pune Airport : 50 min



Build your Success, With our Experience.

ABOUT US

Specialised in the construction of premium residential and commercial projects, **Success Infra** is a trailblazing group, creating landmark spaces for all. It is a part of the prestigious Success Group of companies, with a respectable history that spans over 15 years.

Standing true to our name, we are dedicated to creating modern homes and spaces that offer the best of all worlds. Customer satisfaction is at the heart of our business and so we create spaces that offer value. Our motto is " **Build your Success with Our Experience**" and we extend the same through our offerings.

A LEGACY OF SUCCESS

Completed Projects

Kalp Residency Phase 1, Chakan

Kalptaru, Chakan

Kalp Homes, Chakan

Uma Darshan, Rajgurunagar

Jivan Upvan, Ravet

Upcoming Projects

Kalp Residency Phase 2, Chakan

Kalp Avenue, Spine Road

Vedika Homes, Ravet

Credits

ARCHITECT

LANDMARK DESIGN GROUP

RCC CONSULTANT

G.A. BHILARE CONSULTANTS PVT LTD

MEP CONSULTANT

SKYLINE MEP CONSULTANTS

LEGAL ADVISOR

TRİYAMA LEGAL

BRAND COMMUNICATION PARTNER

FILAMENT

A Project By



Build your Success. With our Experience.

Site Address:

Success Windsor Tower, Plot 10/1&10/2, Sec 29, PCNDTA, Ravet, Pradhikaran, Pimpri-Chinchwad, Pune - 411044

📞 8235 27 27 27, 7566 27 27 27 | 🌐 www.successwindsortower.com | ✉️ sales@successinfra.com

🏠 MAHARERA REG. No.: P52100029582 | <https://maharera.mahaonline.gov.in>

Disclaimer - This brochure is purely conceptual and not a legal offering. The pictures/images/elevations are for representational purposes only and are subject to change.