

AVIRAT
SHILAJ
PROJECT

काव-नो वीते वणत, ते घर...“अविरत”
ऐज्यातो होय ज्यां अवसर...“अविरत”

beyond
desire...

From a young conglomerate to an ISO 9001:2008 & ISO 14001:2004 certified company, the evolution of Avirat Group has been dotted with trail blazing success. For more than two decades, Avirat Group has carved a permanent niche for itself by adopting standards that matches the best. All thanks to its valued customers and trusted partners who have constantly reposed their confidence in them. With a rock solid foundation, a formidable past and a spirit charged with endless possibilities, Avirat Group has manoeuvred itself as an all-round performer. The company today is well entrenched in Ahmedabad with all its projects in the name of 'Silver' or 'Sopan'.

The group has always been committed to developing spaces distinctive in character and appearance, yet in total harmony with each individual environment. The group is known for taking the uphill task of going to areas that were never explored and converting them into a modern day city; the outcome today is visible to everyone. Every area that the group has stepped in has seen a change in culture and matched that to the best of areas in the city.

After making its presence felt as a leading real estate developer, Avirat Group is striving ahead for newer horizons. The vision of the company now envisages stepping into the shoes of multi-dimensional company, satisfying wider based customer needs at the same time carrying along its legacy on which it stands tall of giving everything which is beyond your desire...



www.aviratgroup.com



about the project

Silver Brook is a place where the environs are serene and will make living really exciting, keeping your taste in mind.

silver[®]
Brook
AFFORDABLE • LIVEABLE • LUXURY
2 & 3 BHK



silver
Brook
AFFORDABLE • LIVEABLE • LUXURY

AVIRAT
GROUP



silver
Brook
AFFORDABLE • LIVEABLE • LUXURY

AVIRAT
GROUP



silver Brook

AFFORDABLE • LIVEABLE • LUXURY

At Silver Brook, we balance the extremes;
giving you a well-balanced lifestyle,
matching the global standards,
offering leisure facilities and amenities;
all that stands out.



silver Brook

AFFORDABLE • LIVEABLE • LUXURY

Experience the finest in living with our 2 & 3 BHK apartments, offering both affordability and luxurious setting. A great view from every balcony that greets you to its majestic surroundings.



silver Brook

AFFORDABLE • LIVEABLE • LUXURY

At Silver Brook, we completely take care of everything, so you feel fresh and new every single day.

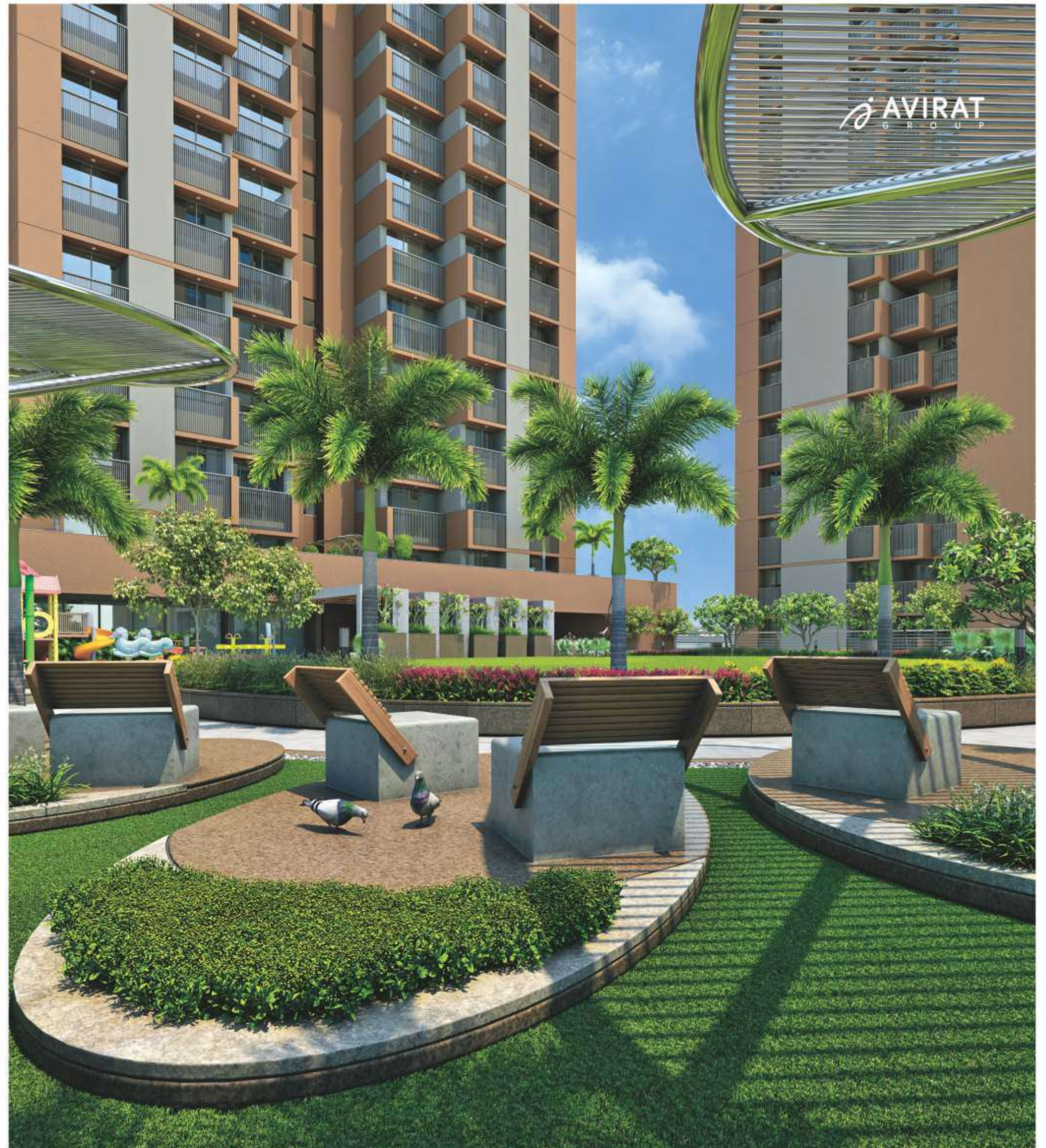



silver
Brook
AFFORDABLE • LIVEABLE • LUXURY

AVIRAT
GROUP



GROUND FLOOR COMMERCIAL

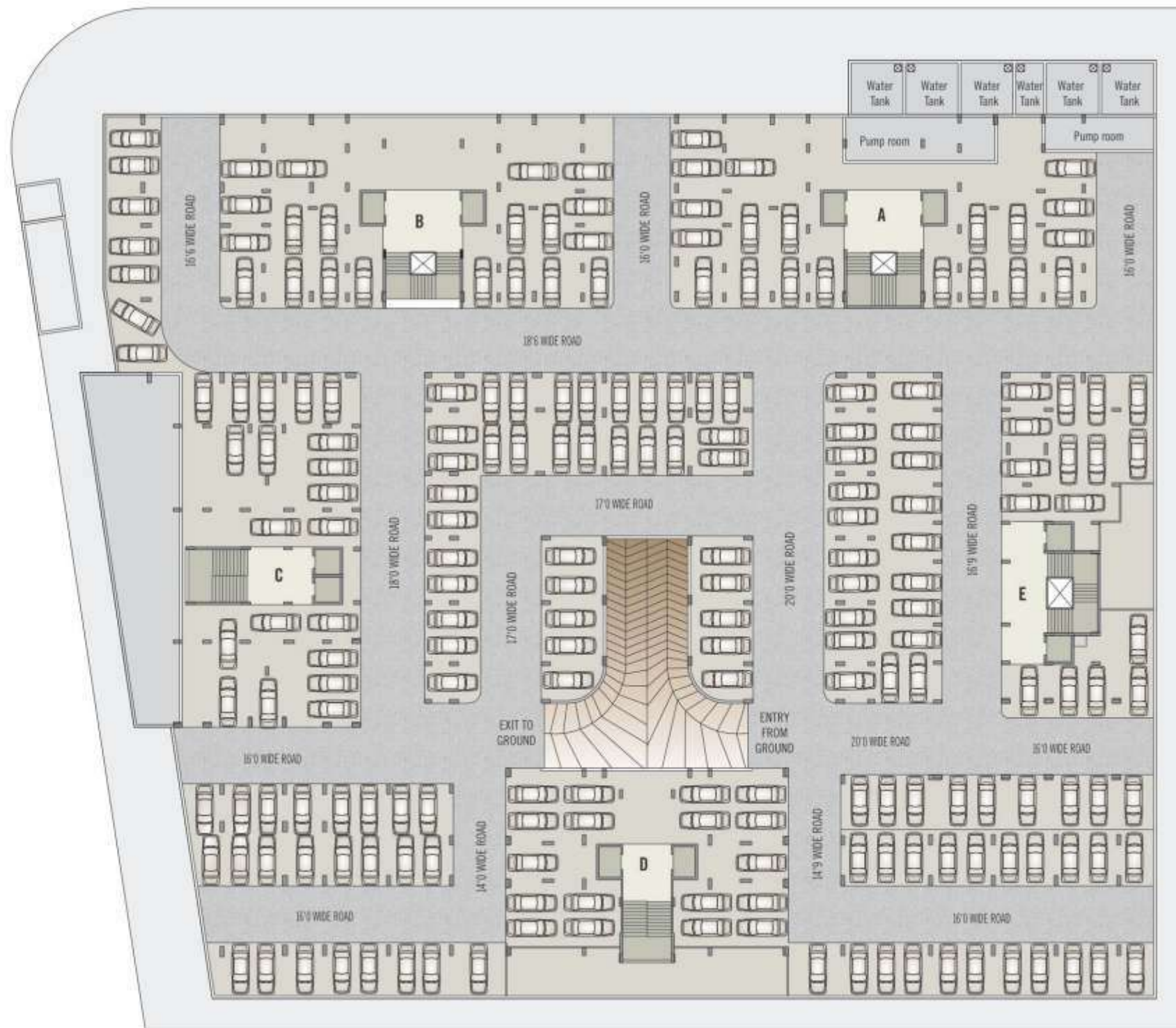

BASEMENT PLAN



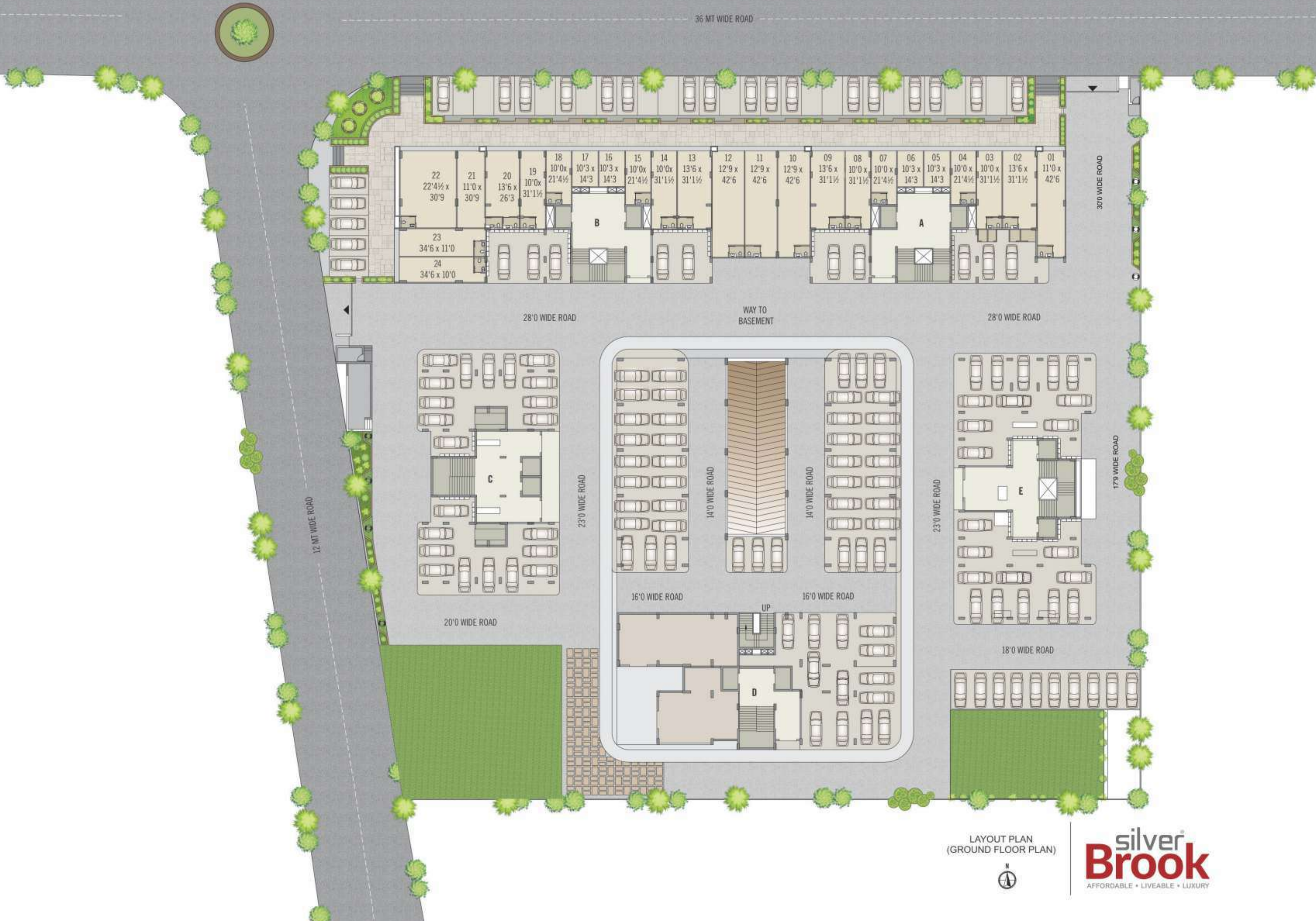

LAYOUT PLAN
(GROUND FLOOR PLAN)







2 - BHK
TYPE - A

BLOCK - D
FLAT NO.
202-1402
203-1403



2 - BHK
TYPE - B

BLOCK - D
FLAT NO.
101-1401
104-1404



Blending seamlessly with the natural landscape, living here unfolds quite perfectly as desired.

**2 - BHK
TYPE - C**

**BLOCK - E
FLAT NO.
101-1401
102-1402
104-1404
105-1405**



**2 - BHK
TYPE - D**

**BLOCK - E
FLAT NO.
103-1403**





AVIRAT
GROUP

3 - BHK UNIT PLAN

BLOCK - A, B, C
FLAT NO.
101-1401
102-1402
103-1403
104-1404



global living...



silver
Brook
AFFORDABLE • LIVEABLE • LUXURY

AVIRAT
GROUP





Entrance Gate



24 X 7 Security



CCTV



Power Backup



Landscaped Podium Garden



Waterbody



Gazebo



Gymnasium



Admin Office



Children's Creche



Library



T.V. Lounge



Driver's Sitout



General Toilets



Jogging Track



Kids Play Area



Garden Seating

silver
Brook
AFFORDABLE • LIVEABLE • LUXURY

full of unique
amenities...

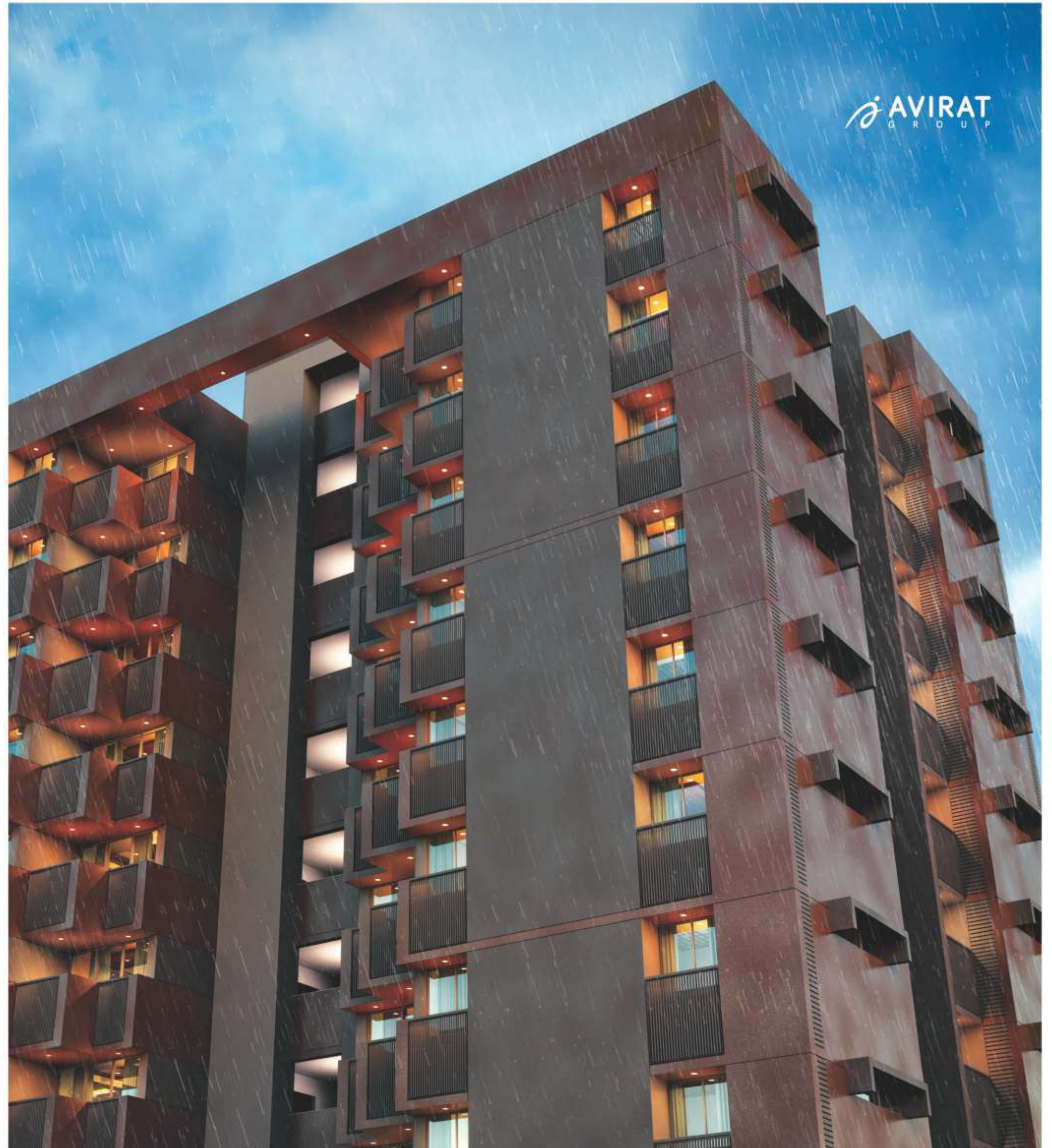

► **STRUCTURE:**

RCC frame structure with Seismic Zone III compliance.

► **FLOORING:**

Premium vitrified flooring in complete apartment. (size 2' x 2')

► **KITCHEN / STORE:**

- Mirror polished granite platform with SS sink & decorative tile up to lintel level.
- Kota stones self in store room.
- Provision for gas pipeline.
- Electric point for washing machine with water inlet-outlet point in wash area.
- Gas geyser point in wash area.

► **ELECTRIFICATION:**

- Concealed electrification with premium copper wire / cable.
- Premium modular switches and accessories with adequate number of points and all rooms.
- Distribution board with MCB & ELCB.
- Provision for split A/C.
- Provision cable for hi-speed internet in every apartment.

► **DTH:**

- Centralized DTH dish with 1 connection in each apartment.

► **DOOR:**

- Decorative main door with both side veneer.
- Other flush doors with both side laminate.

► **WINDOWS:**

Fully glazed anodized aluminium windows with stone revile.

► **WALL / PAINT:**

- Internal walls finished with wall putty.
- Weather shield acrylic emulsion paint exteriors.

► **ELEVATORS:**

- Fully automatic high speed elevators.

► **TERMITE TREATMENT:**

Anti-termite treatment shall be applied by standard materials to completed area.

► **BATHROOM:**

Wall cladding with designer tiles. Branded sanitary wares & fittings.

► **PLUMBING:**

CPVC / UPVC hot & cold water supply pipes.

► **TERRACE:**

China mosaic with required water proofing on terrace.

Please Note:

Developers reserve the rights for alteration of specifications and designs. All dimensions/area are approximate average & subject to variation. Irregular payments shall cause cancellation of booking. AMC, UOVCL, Legal Expenses, Maintenance Charge, Maintenance Deposit, Stamp Duty, Registration Charges, Taxation, GST, Legal Charges or any other kind of govt. & Semi Govt., Levies are to be borne by member as actual, as and when applicable. This brochure is not to be treated as part of the legal document and it is for the easy display of the project.

Disclaimer:

The details, facts, specifications, figures, mentioned in brochure are indicative for information purpose only and are subject to modifications / compliance required as per RERA Act, Subject to Ahmedabad Jurisdiction.



specification & features...



*avirat house *, nr. science city, sola,
 ahmedabad - 380060
 p : +91 7965101300
 m : +91 99250 13951, +91 95580 13951.
 f : +91 79 2909 9767
 e : info@aviratgroup.com



LOCATION :

36 mt road,
 s.p.ring road,
 shilaj circle towards science city road,
 shilaj, ahmedabad 380058
 contact : +91 8980 909010



PR/GJ/AHMEDABAD/AHMEDABADCITY/AUDA/MAA00616/071117
<https://gujrera.gujarat.gov.in/home>



silver
Brook
AFFORDABLE • LIVEABLE • LUXURY

An oasis of its own, Silver Brook gives you immense pleasure in owing itself. A lot of things does not come easy in life but here at Silver Brook ; living for sure will come easy..

 **AVIRAT**
GROUP

pamper yourself...