

W E L C

WELCOME TO VASAVI LAKE CITY, JUST MOMENTS FROM THE HEART  
OF HITECH CITY AND OTHER VIBRANT PARTS OF THE CITY

O M E

EXPERIENCE A RARE WATER FRONT LIFESTYLE WITH  
SWEEPING PANORAMAS OF THE HAFEEZPET LAKE

L A K E

DISCOVER THE CONVENIENCE OF EASY CONNECTION  
TO THE WORK HUBS AND EXCITING LOCATIONS WITH  
EXCLUSIVE RETAIL AND COMMERCIAL OPPORTUNITIES

C I T Y

AN ARTISTIC RENDERING OF VASAVI LAKECITY GRAND ENTRANCE



EXPERIENCE A NEW DIMENSION IN LUXURY LIVING

A  
lifestyle by  
the lake and  
the city

WHERE NOTHING BUT BEST WILL DO



LAKE CITY IS DESIGNED TO HAVE A BALANCED, BOLD, MODERN FORM WITH A RESPECT FOR LOCAL CHARACTER. WITH THE BEST ARCHITECTURE AND LIFESTYLE DESIGN, COMING UP IN THE MOST DESIRABLE AND UPLIFTING ADDRESS IN HAFEEZPET. VASAVI LAKECITY IS ONE OF OUR MOST VISIONARY LAKE SIDE LIVING COMMUNITIES, BEHIND THOSE FACADES IS A RANGE OF 2 & 3 BHK CONTEMPORARY RESIDENCES OFFERING THE ULTIMATE IN STYLISH CONTEMPORARY LIVING.





**LEGEND** 

**EAST BLOCK**

- ① Entrance Gate
- ② Connecting Walkway
- ③ Designer Landscape
- ④ Friendly Seating Zone
- ⑤ Cricket Pitch
- ⑥ Half Basketball
- ⑦ Specimen Planter
- ⑧ Stage with feature wall
- ⑨ Multipurpose Lawn
- ⑩ Connecting Pathway
- ⑪ Seating Plaza
- ⑫ Pathway
- ⑬ Children's Play Area
- ⑭ Clubhouse
- ⑮ Connecting Median
- ⑯ Connecting Pathway Around the Building

**WEST BLOCK**

- ① Entrance Gate
- ② Water Body
- ③ Connecting Walkway
- ④ Staggered Circular paving
- ⑤ Vehicular Entrance
- ⑥ Clubhouse
- ⑦ Basketball Court
- ⑧ Children's Play Area
- ⑨ Seating Zone
- ⑩ Driveway
- ⑪ Friendly Seating Zone
- ⑫ Children's Play Area 1
- ⑬ Seating Plaza
- ⑭ Pathway
- ⑮ Elder Seating
- ⑯ Amphitheatre
- ⑰ Party Lawn
- ⑱ Fitness Station

MASTER PLAN

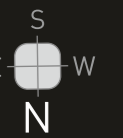

  
EXPERIENCE A NEW  
DIMENSION IN LIFESTYLE DESIGN

AN ARTISTIC RENDERING OF VASAVI LAKECITY BIRD'S EYE VIEW



East Block - 6 Towers  
West Block - 7 Towers

70%  
Open Space

G+14  
Floors  
Luxury living

2 Luxurious  
clubhouses

High end  
finishes

Desirable  
Location

EXPERIENCE A NEW DIMENSION IN THE **ULTRA LUXURY COMMUNITY**



EXPERIENCE A NEW DIMENSION IN  
THE LAKESIDE LIVING

AN ARTISTIC RENDERING OF VASAVI LAKECITY NIGHT ELEVATION VIEW







## PROJECT FEATURES



PRIME LOCATION  
CLOSE TO  
METRO STATION/  
MMTS AND  
IT COMPANIES



HI-RAISED TOWERS  
GHMC APPROVED  
G + 14 FLOORS  
1845 UNITS



FULLY LOADED  
CLUB AMENITIES  
VAASTU COMPLIANT  
RESIDENTIAL  
ENTRANCE PAVILION

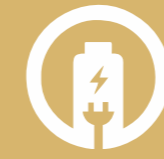

COMPLETE POWER BACKUP  
FOR COMMON AREAS & ALL FLATS  
INDIVIDUAL DUEL SOURCE  
ENERGY METERS FOR EB POWER  
AND DG POWER  
COMPLETE POWER BACKUP  
IN CLUB HOUSE  
100% POWER BACKUP



RAIN WATER  
HARVESTING AND  
RECYCLING OF  
WATER  
GAS BANK



TERRACE  
SWIMMING POOL WITH  
SEATING DECK  
AVENUE PLANTATIONS  
WITH LUSH  
GREEN LANDSCAPING  
PEST CONTROL TREATMENT  
STP



GRAND ENTRANCE  
PANIC BUTTON  
SIGNAGES &  
DIRECTIONS  
DUST BINS &  
CENTRAL GARBAGE



SECURITY & INTERCOM  
SYSTEMS WITH  
CCTV SURVEILLANCE  
MAINTENANCE OFFICE  
ROUND THE CLOCK SECURITY  
SOLAR FENCING  
VIDEO DOOR PHONE



AN ARTISTIC RENDERING OF VASAVI LAKECITY ELEVATION SIDE VIEW

VASAVI'S  
*lake city*



EXPERIENCE A NEW DIMENSION IN  
HI-RISE LIFESTYLE LIVING

# A lifestyle around the ultra luxurious club lifestyle

WHERE NOTHING BUT BEST WILL DO



AT LAKECITY WE ARE PLEASED TO INTRODUCE AN ONSITE, 2 SEPARATE CLUBHOUSES FEATURED FOR EXCLUSIVE USE OF ITS RESIDENTS. EXPERIENCE A PLUSH LIFE STYLE STARRED WITH THE BEST INTERIORS AND AMENITIES - THE TERRACE POOLS WITH LOUNGING DECKS TO ENJOY THE SUNRISE TO THE NIGHT SKIES, WELCOMING LOUNGES WITH HI-LUX SEATING AND FLAT SCREEN TVS FOR YOUR ENTERTAINMENT. AND A FULLY EQUIPPED MODERN GYMNASIUM FOR FITNESS OF THE RESIDENTS, SWEAT OUT ALL THE STRESS AND RELIVE THROUGH THE AGELESS INDOOR GAME LOUNGES FOR YOUR GAME TIMES, WI-FI AND A COFFEE SHOP FOR YOUR BROWSING. ALL TOGETHER DESIGNED TO EXPERIENCE A RESORT LIFESTYLE TO INDULGE, RELAX AND REFRESH WITH YOURSELF, SURELY IT'S A PLACE FOR YOUR FRIENDS AND NEIGHBORS TO MAKE MEMORABLE MOMENTS.





VASAVI'S  
*Lake city*

EXPERIENCE A NEW DIMENSION IN  
RELAX & LEISURE

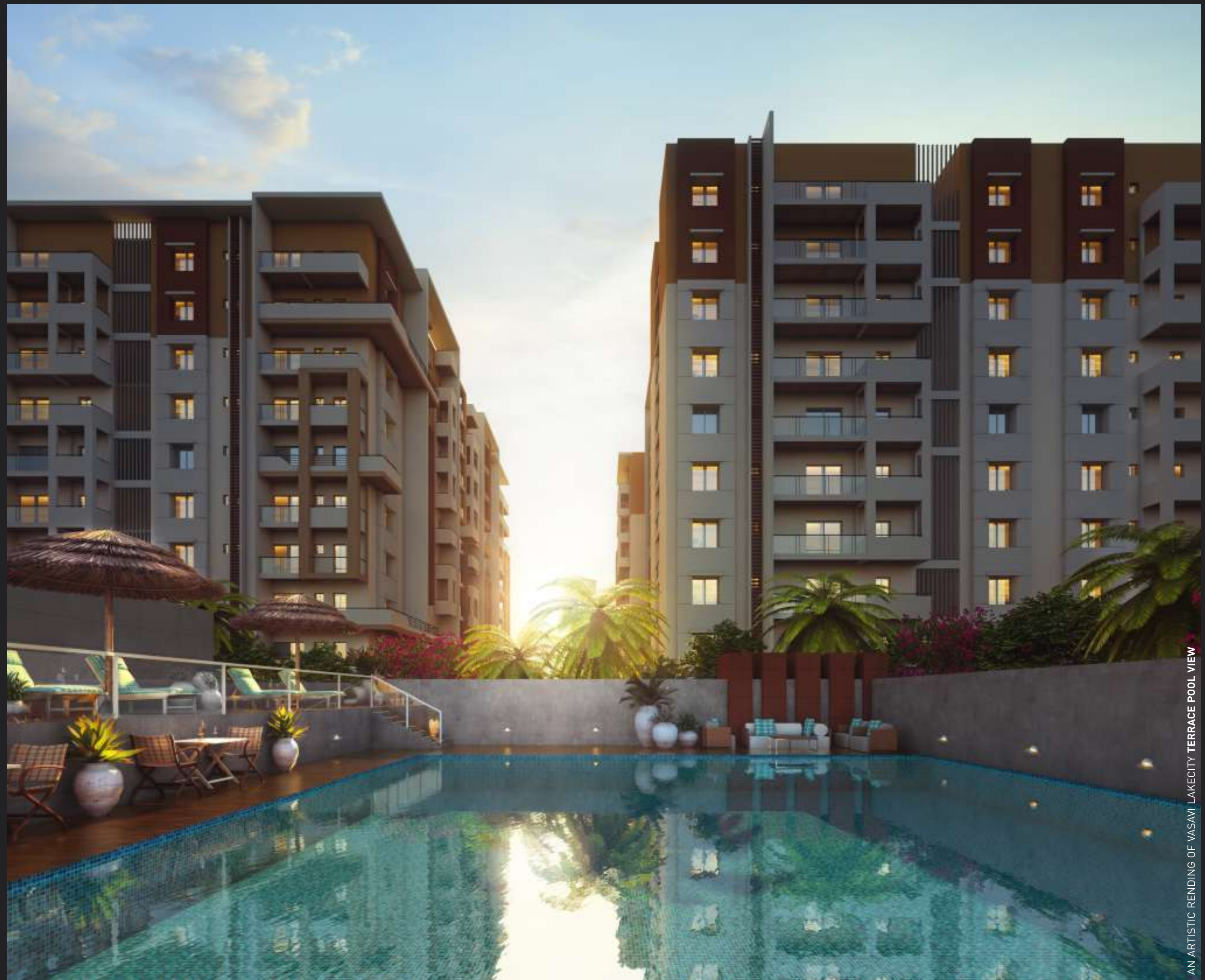



EAST BLOCK CLUB HOUSE



WEST BLOCK CLUB HOUSE



EXPERIENCE A NEW DIMENSION IN FACILITIES FOR PURE INDULGENCES

### LAKE CITY EAST - WEST CLUB FEATURES

- > Luxury Waiting Lounge
- > Fully Equipped Gymnasium
- > Games Room
- > Meditation
- > Cafeteria
- > Guest Suites
- > Conference Room / Banquet Hall
- > Spa / Salon
- > Library
- > Creche
- > Pharmacy
- > Mini Super Market
- > Indoor Games
- > Terrece Swimming Pool



A lifestyle  
around the  
green meadows  
and the flora.

WHERE NOTHING BUT BEST WILL DO



AT LAKECITY RESIDENTS WILL EXPERIENCE A MODERN VIBE WITH NATURAL FLAIR IN THE CENTRAL PARK STYLE GARDENS. LAKE CITY PROMOTES 70% OUT DOOR LIFESTYLE DESIGN TO BREATHE FRESH WHENEVER YOU FEEL LIKE TAKING A BREAK. TEAM UP TO PLAY OUT DOORS SPORTS OR ENJOY READING A BOOK IN ONE OF THE SERENE CORNERS OR LEISURELY TALK TO YOUR FRIENDS WHILE THE LITTLE ONES ROAM FREE IN THE CHILDREN'S PLAY AREA. A PARADISE FOR MORNING WALK, JOGGING OR TO SPREAD YOUR YOGA MAT ON THE LAWNS. LAKECITY PROVIDES LARGE SPACES TO SOCIALISE WITH YOUR NEIGHBORS AND CELEBRATE CULTURAL GATHERINGS AND FESTIVALS. LIVE YOURSELF TO THE FULLEST IN LAKE CITY OUTDOORS.

VASAVI'S  
*lake city*

EXPERIENCE A NEW DIMENSION IN  
CULTURE & SOCIAL LIFE



AN ARTISTIC RENDERING OF VASAVI LAKECITY AMPHITHEATER

AN ARTISTIC RENDERING OF VASAVI LAKECITY PATHWAYS



EXPERIENCE A NEW DIMENSION IN  
LARGE OPEN LANDSCAPE  
DEIGNED SPACE BETWEEN THE BLOCKS

VASAVI'S  
*lake city*



EXPERIENCE A NEW DIMENSION IN  
CENTRAL PARK AT YOUR DOOR STEP





EXPERIENCE A NEW DIMENSION IN  
OPEN LIFESTYLE AND FREEDOM



AN ARTISTIC RENDERING OF VASAVI LAKECITY WALKING PATHWAY



WATER FEATURES AND GARDENS WITH PAVED PATHS AND WALK SAND ALONG WITH A DESIGNED TRACK FOR JOGGING



SAFE AND SECURE ENVIRONMENTS FOR KIDS TO PLAY OR FOR ANY AGE GROUP TO REJUVENATE WHILE CYCLING



AN ARTISTIC RENDERING OF VASAVI LAKECITY CHILDREN'S PLAY AREA



AN ARTISTIC RENDERING OF VASAVI LAKECITY HALF BASKETBALL COURT VIEW



VASAVI'S  
*lake city*



EXPERIENCE A NEW DIMENSION IN  
ACTIVITY FEATURED COMMUNITY





~~~~~

EXPERIENCE A NEW DIMENSION IN  
A SECURED KIDS WORLD AND MORE



# PREMIUM BRANDS HIGH FINISHES AND A QUALIFIED TEAM



## **SUPER STRUCTURE**

R.C.C. framed structure to withstand wind & seismic loads.  
Super Structures Masonry work with AAC / Cement Blocks.



## **DOORS AND WINDOWS**

Main Doors : Teakwood frame with veneered flush shutter of 35 mm thickness with melamine polish.

Internal doors : Engineered wood frames with laminated flush shutter 32mm thick on both sides.

French doors : UPVC door system with sliding shutters with mosquito mesh shutter.

Windows : UPVC door system with clear float glass with suitable finishes as per design, with mosquito mesh shutter including mosquito mesh.  
All hardware of reputed make.



## **PAINTING**

External : Textured/smooth finish and two coats of exterior paint Asian make.  
Internal: Smooth putty finish with 2 coats of premium acrylic emulsion paint over a coat of primer.



## **FLOORING**

Living, Dining, Bedroom & Kitchen : Vitrified tiles  
Bathrooms : Acid resistant, Anti-skid ceramic tiles.  
Corridors : Granite  
Living Balconies: Anti-skid vitrified/ceramic tiles.  
Staircase : Granites



## **TILE CLADDING/DADOING**

Dadoing in Kitchen : Glazed ceramic tiles dado up to 2'-0" height above kitchen platform.  
Bathrooms : Glazed ceramic tiles dado up to full height / ceiling height.



## **KITCHEN**

Granite platform with Stainless Steel Sink  
Separate municipal tap (Manjeera or any other water provided by GHMC along with bore well water).  
Provision for fixing of water RO system, exhaust fan & chimney.  
Provision for geyser for hot water near the sink.  
Utilities/Wash: Dish washer & washing machine provision in utility area



## **BATHROOMS**

EWC with vertical stack flushing system.  
Single lever fixtures with wall mixer cum shower.  
Provision for geysers in all bathrooms.  
All C.P fittings are chrome plated.  
Sanitary Fittings of Standard make.



## **ELECTRICAL**

Concealed copper wiring with ISI mark.  
Provision for Power outlets for air conditioners in all bedrooms.  
Power outlets for geysers in all bathrooms.  
Power plug for cooking range chimney, refrigerator, microwave oven, Mixer/grinder in kitchen, washing machine.  
Three phase power supply for each unit & individual meter boards.  
Miniature circuit breakers (MCB) for each distribution boards of the distribution board. (Legrand)

## **TELECOM/INTERNET/CABLE TV**

Intercom facility to all the units connecting Security with video phone.  
Provision for cable connection in Master bedroom & living room.



One Internet provision in each apartment.

## **STP**

A Sewage treatment plant of adequate capacity as per norms will be provided inside the project, treated sewage water will be used for the landscaping / flushing purpose.

## **POWER BACKUP**

For Flats 100% Metered DG backup and power supply excluding AC.  
100% D.G. Backup for all common areas, Lifts, Pumps.



## **LIFT**

High speed Automatic passenger lifts of reputed brand.



## **CLUB HOUSE & AMENITIES**

Reception, Grand Lobby and Coffee Shop  
Multi – Purpose Hall, Space for Association (Facility Manager's Cabin, Management Committee Room)  
Fully Equipped GYM, Yoga/Meditation, Indoor Games (Billiards, Table Tennis, Board Games) & Library.  
Children Play area.  
Guest Suites, Doctor's, Pharmacy,Swimming Pool, Guest Rooms.

## **FIRE SAFETY**

Fire hydrant and fire sprinkler system in all apartments and basements as per fire norms.  
Fire alarm and public address system in all floors and parking areas (basements) as per fire norms.  
Control panel will be kept at main security as per fire norms.



## **LPG**

Provision for supply of gas through Gas pipeline to all individual flats with pre-paid gas meters.

## **SECURITY / BMS**

Intercom facility to all apartments connecting to security room with video door phone  
Panic button and intercom is provided in the lifts connected to the security room  
Solar power fencing around the compound.  
Surveillance cameras at the main security and entrance of each block.



## **CAR WASH FACILITY**

Car Wash facility will be provided





AN ARTISTIC RENDERING OF VASAVI LAKECITY ELEVATION NIGHT VIEW

VASAVI'S  
*lake city*



EXPERIENCE A NEW DIMENSION IN  
CITY CENTRAL LIVING

## THE LOCATION

An address like no other, Vasavi Lake City is rising close to Madeenaguda Lake and in the midst of Verdant greenery. Upon setting foot at the Hafeezpet Road, you immediately notice that this impressive location is a rarity in the urban jungle of Hyderabad. Surrounded by IT Conglomerates on all sides, the site makes walk-to-work/easy drive to office a pleasant reality. For children's education, the vicinity is marked by the presence of international schools. For the shopper in you, the neighbourhood offers the choicest of malls, multiplexes, multi-cuisine restaurants and star hotels.



### WORK SPACES

- + HITEC City
- + Financial District
- + Mindspace
- + UBS
- + Wipro
- + Deloitte
- + TCS
- + Microsoft
- + Amazon
- + Honeywell
- + Infosys
- + Google
- + Wave rock
- + Accenture
- + Cognizant
- + Genpact



### EDUCATION

- + Central University
- + The Gaudium School
- + Manthan School
- + Indus International School
- + St. Xavie's PG Collage
- + Sancta Maria School
- + Epistemo Global
- + Vista School
- + TIFR
- + ISB
- + Kendriya Vidyalaya
- + Orkridge International School
- + Delhi Public School
- + Open Minds Birla School
- + The Future Kids School
- + Unicent international school
- + Hyderabad Central University



### CONNECTIVITY

- + Lingampally MMTS
- + Financial District Ph 2
- + ORR
- + Hyatt Hyderabad (Star Hotel)
- + NIAB
- + Inorbit Mall
- + Hitech City
- + MMTS Hafeezpet
- + International Airport
- + Miyapur Metro



### HEALTH CARE

- + Archana Hospital
- + CARE Super Speciality Hospital
- + Continental Hospital
- + Citizen Hospital
- + Asian Institute of Gastroenterology
- + Pranam Hospital



EXPERIENCE A NEW DIMENSION IN COVETED  
PLATINUM LOCATION FOR GOLD LIFESTYLE





VASAVI SIGNATURE



VASAVI GP TRENDS



VASAVI SKYCITY



## BUILDING DREAMS

### CLASSIC ON THE CUTTING EDGE.

Founded in 1995, Vasavi Group endeavours to craft beautiful environments for exceptionally high-quality lifestyles. Inspired by art and reflective of their owners' aspirations, Vasavi Group residences are classic in feel but contemporary of vision, filled with experience and exuberance of life.

Our customers' refined tastes inspire us to develop architecturally compelling residences that consistently transcend fashions and trends. Vasavi Group current projects include high-rise luxury residences and multi-family communities in Hyderabad, located in the prestigious locations of Hyderabad

Where contemporary meets classic, Vasavi Group envisions a new way of living for discerning homeowners in Hyderabad and beyond.



VASAVI SOLITAIRE



VASAVI WATER FRONT



VASAVI LIFE



Vasavi Group chairman and managing director Mr. Yerram Vijay Kumar garu "Trusted Developer of the year" Award Received from Honorable Minister of state for Home affairs gov't of India G. Kishan Reddy at the Times Business Awards 2019.



VASAVI SRINILAYAM



*Corporate Office*

8-2120/86/9/A/1, 12 & 2/13, 1st Floor,  
North End, Anilath Maja Housing Society,  
Road No. 2, Opp. Park Hyatt,  
Banjara Hills, Hyderabad - 500034.

*For more details*

**Mob.: +91 8688824747, 8688824737**

**www.thevasavigroup.com**

*Site address*

Vasavi Lake City  
Hafeezpet, Hyderabad.



## TEAM

---

### Architects



**Lords**  
Ph: +919849019981  
arcinlandhyd@gmail.com

### Structural & MEP Consultants



**Design Tree**  
Bangalore.  
T: +91 80 4122 5481/4091 9417

### Landscape Architects



**Envision**  
Ph.: +91 9849168166  
www.envisionlandscapes.in

### Clubhouse Architects



**Mohan Consultants**  
Hyderabad  
Ph.: +91 40-23554450

### Project Managed by



**Tata Projects Ltd.**  
Hyderabad.  
Mob.: +91 91212 39880

### 3d Design



**Square One**  
Ph: + 91 - 9822148500  
www.squareone.co.in

### Branding



**D3 Concepts**  
Cell : +91 98491 92657

### Note

This document has been produced by the developer for advertising and general information only. The developer and its project team do not guarantee, warrant or represent that the information contained within this document is correct. Any interested party should undertake their own enquiries as to the accuracy of this information. The developer excludes unequivocally all inferred and implied terms, conditions and warranties arising out of this document and excludes all liability for loss or damage arising there from. Images shown are Artist Impression and shown for illustrative purposes only. The plans are based on the current design for this development. Changes will undoubtedly be made through development, and dimensions, fittings, finishes and specifications are subject to change without notice. The location of all architectural features on the façade including vertical panels and fins will vary on each type plan and level. Their location on the marketing material is indicative of the design intent. The information contained herein is believed to be current, but is not guaranteed. Prospective purchasers must rely on their own enquiries. Furniture is not included. This document is for guidance and does not constitute an offer of contract.